



INSTRUCTIONS PERTAINING TO RISK OF FIRE OR INJURY TO PERSONS. READ ALL INSTRUCTIONS. IMPORTANT SAFETY INSTRUCTIONS. SAVE THESE INSTRUCTIONS.

DANGER - RISK OF SHOCK - DISCONNECT POWER BEFORE INSTALLATION! Please read all instructions before installation.

- Keep these instructions for future reference.
- Must be installed by a qualified electrician in accordance with national and local standards. Designplan is not responsible for fixtures installed without regard to these standards.
- Unauthorized alterations or tampering of product voids warranty.
- The main power connection must be in accordance with local electrical codes.
- Suitable for INDOOR applications.



Electrical Connections:

- LED lights must be **connected in series** respecting polarities.
- **CHOOSE POWER SUPPLY ACCORDINGLY.** Please consider the voltage through which fixtures are fed as well as the max power consumption.
- **Connect power only after all fixtures are connected.**
- The power supplies **MUST** be installed in aerated rooms, far from heat sources. Overworking or lack of air circulation will not permit natural dissipation.
- The electronic power supply is current-stable, therefore it partially compensates the voltage-drop problems related to the cable length; we suggest not to exceed 100 ft.
- Use only Class 2 type electronic power supply.
- Never use switches on secondary circuit.

Maintenance

Scheduled maintenance must be carried out once a year on all lighting devices, regardless of appliance class and type of use. It must include the following operations:

- Periodically clean fixtures to remove dirt from gratings and screw heads.
- Check tightness of screws on various parts of the device.
- Check that all cable glands and cables are intact and tight. Check that the glass or plastic lens is intact, and replace it if broken or damaged.
- The internal components such as the ballast, driver, washers and screws must not show clear signs of oxidation or rust. Clear traces of rust and oxidation will indicate the presence of water inside the device.
- In the case of damage, the components must be replaced by original components or spare parts.

Flange Version Fixture Installation (with no housing)

DO NOT INSTALL INSULATION WITHIN 76 mm (3.0") OF ANY PART OF THE LUMINAIRE.

1

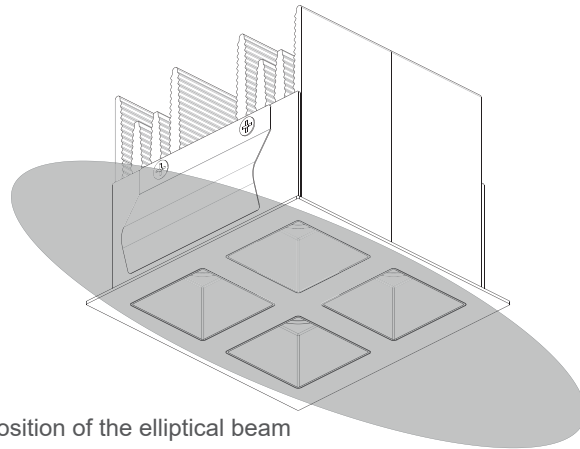
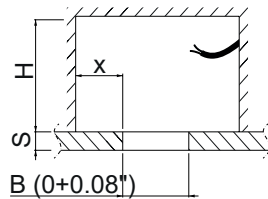
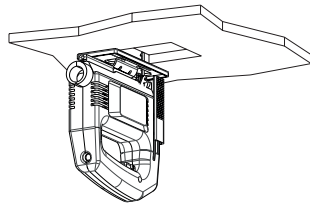

Position of the elliptical beam

B	3.23x3.23"
X	1.57" min
S	0.3 ÷ 0.78"
H min	5.12"

2

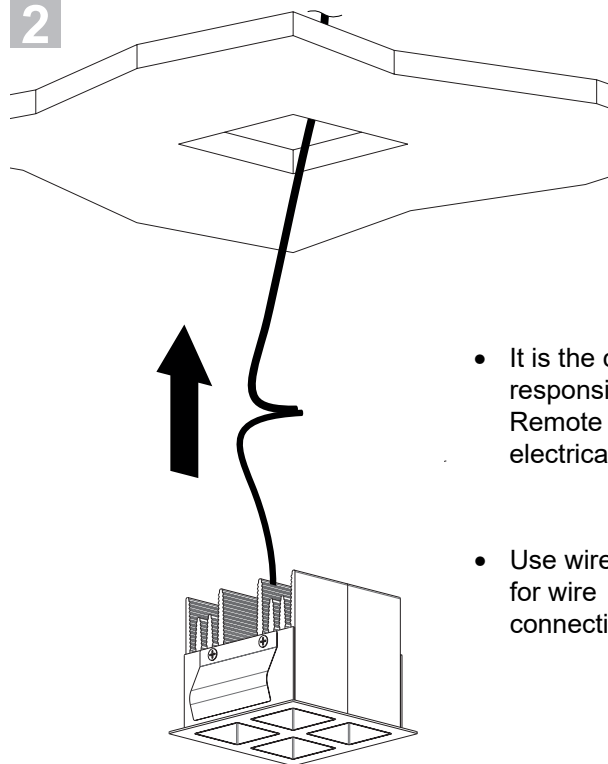

- It is the contractor's responsibility to install Remote Driver in a suitable electrical enclosure.

- Use wire-nuts for wire connections.

3

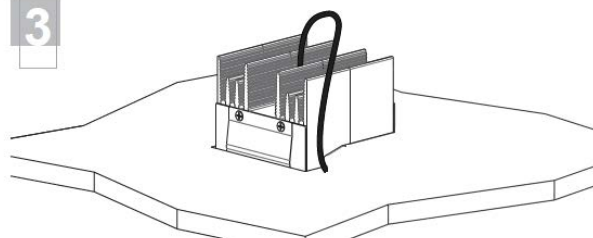

Regressed Version Installation (WC8704)

DO NOT INSTALL INSULATION WITHIN 76 mm (3.0") OF ANY PART OF THE LUMINAIRE.

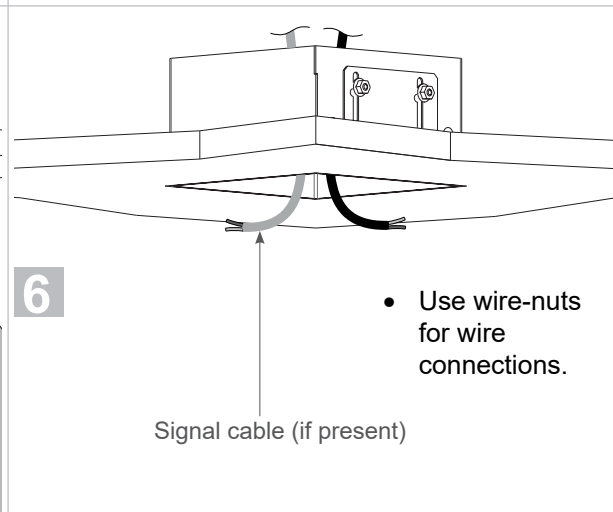
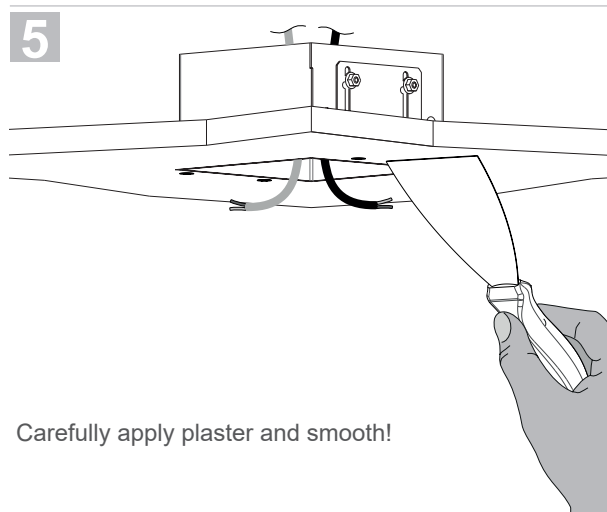
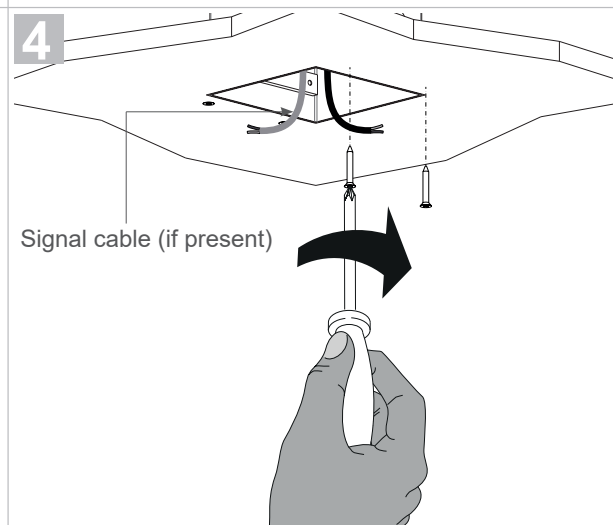
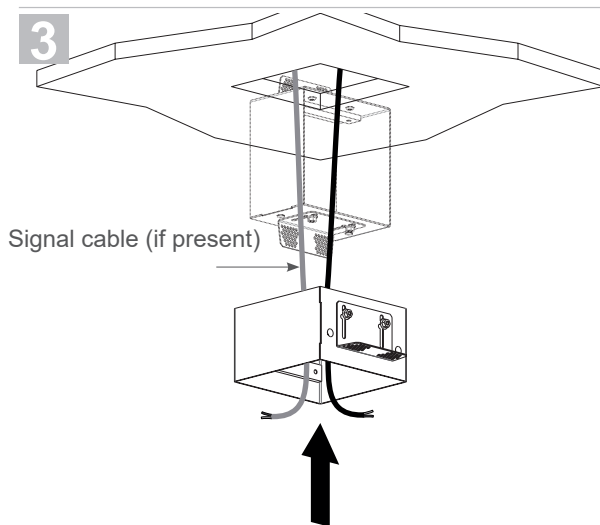
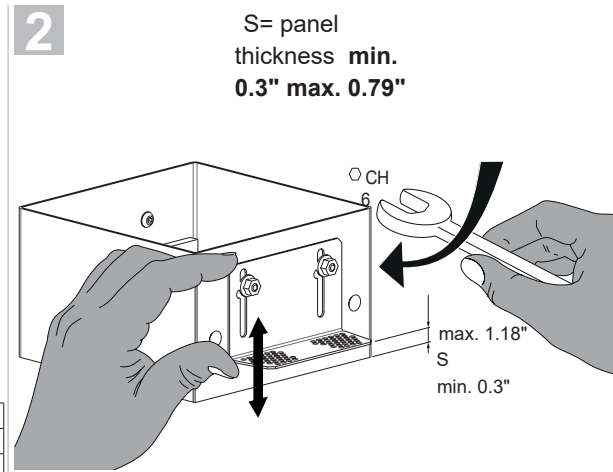
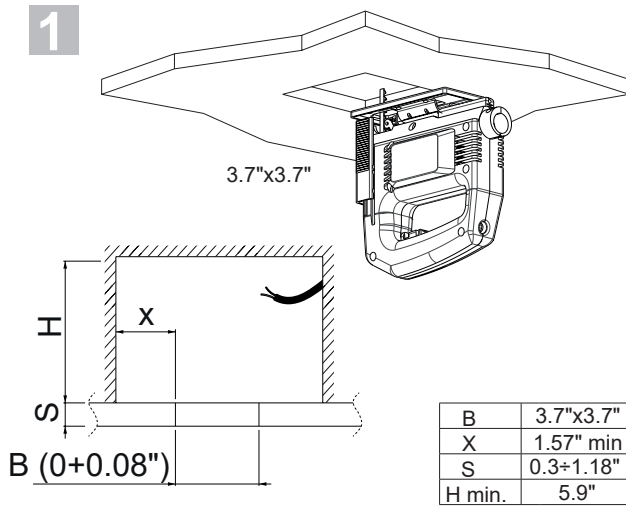

With **WC8704** **1**

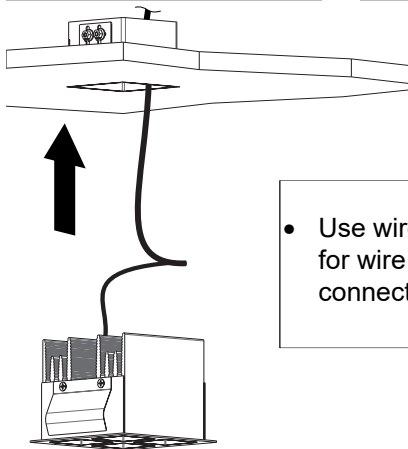

• Use wire-nuts for wire connections.

With **WC8704** **2**

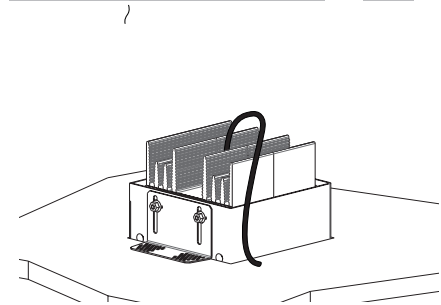

- It is the contractor's responsibility to install Remote Driver in a suitable electrical enclosure.

REMOVING THE LAMP (from the outer casing)

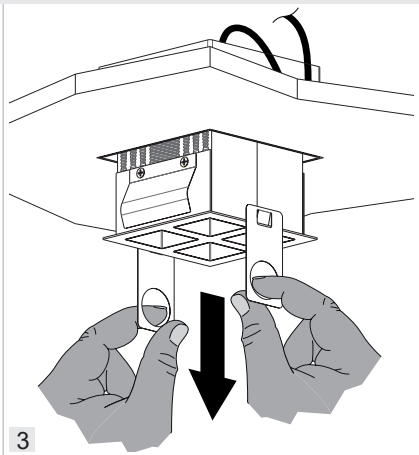
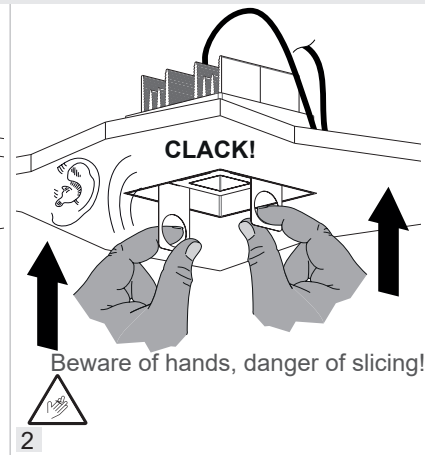
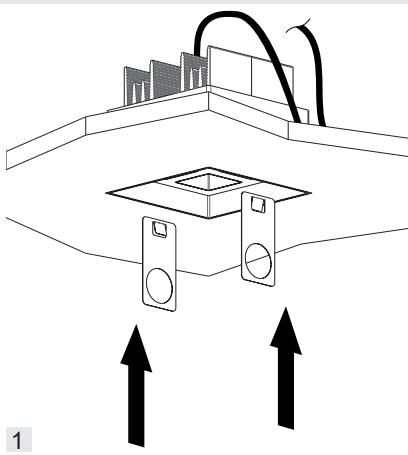

Flange Version

Housing Installation (IC/CHICAGO PLENUM)

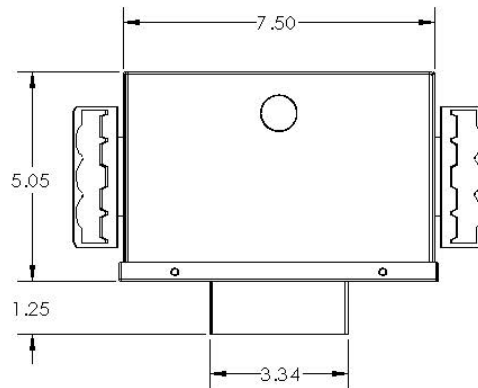
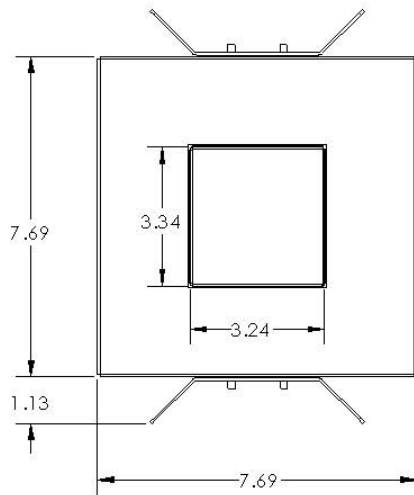

Position flush to the finished ceiling!

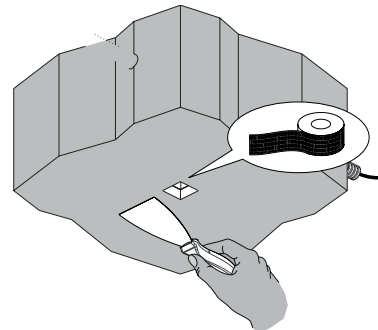
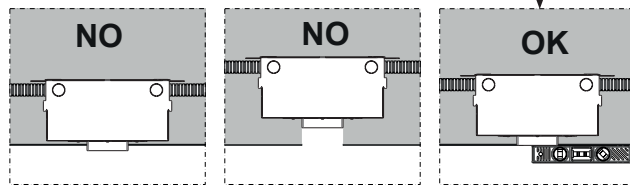

- Remove the plaster frame cover. Utilize the conduit entries on the sides for wiring. Note: This housing box is not a driver enclosure.
- It is the contractor's responsibility to install Remote Driver in a suitable electrical enclosure.
- Mount housing by utilizing the hanger bars on the sides of the body. It is the contractor's responsibility to supply proper mounting based on job condition. The fixture is suitable for a maximum 1 1/2" ceiling thickness. A 3.3125" x 3.3125" cut out hole is required for the housing neck to properly fit through the ceiling.
- carefully apply plaster (by applying the microperforated paper) and smooth over the casing. Carefully clean the inside of the casing. All plaster residue must be removed.

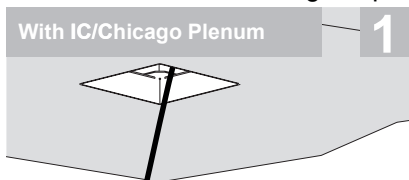

1

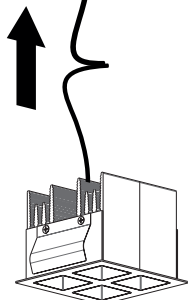

- Use wire-nuts for wire connections



Do not cut the cable provided between the EPS device and the fixture.

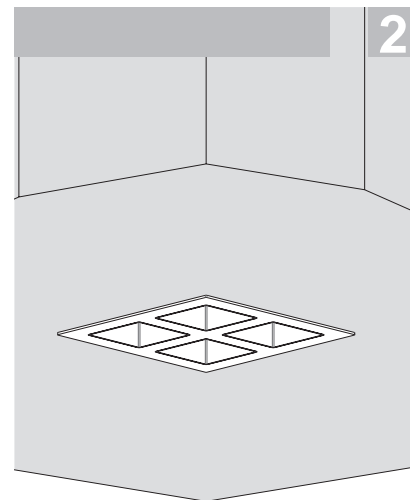

2

