

BEAM 1.0

Beam 1.0 is a low-profile recessed in-grade uplight. Available in white, blue or RGB light with 4 optical options and 2 different finishes.

TECHNICAL DATA

Wattage / Input	3W (700mA, RGB 350mA)
Power Supply	Remote, not included. See page 2.
Construction	Body: Anodized Aluminum Trim: AISI 316L Stainless Steel or Aluminum Lens: Transparent Glass (optics version) Sandblasted Glass (diffuse version)
CCT	2700K, 3000K, 4000K, 5000K, Blue, RGB
CRI	>80
BUG Rating	B0-U0-G0 (3000K)
Delivered Lumens	107 lm (3000K, 700mA, 26°); 40 lm (RGB)
Efficacy	36 lm/W (3000K); 13 lm/W (RGB)
Optics	8°, 26°, 44°, Diffuse
Finishes	Stainless Steel, Grey, Custom RAL
Fixture Dimensions	Ø2.36" x 2.09"
Cut-out Size	Ø1.77" (for ceiling or wall installations)
Fixture Weight	0.49 lbs Stainless Steel 0.44 lbs Grey Aluminum
LED Source	1 Power LED 3 Full-Color LEDs (RGB)
Lumen Maintenance	L90, B10 >50,000hrs (Ta 25°C)
Color Consistency	1/4 ANSI BIN
Operating Temp.	-4°F to +113°F
IP Rating	IP67
IK Rating	IK09
JA8	Exempt



Cut-out Dimension for Ceiling/Wall Installations = Ø 1.77"

Fixture Dimensions

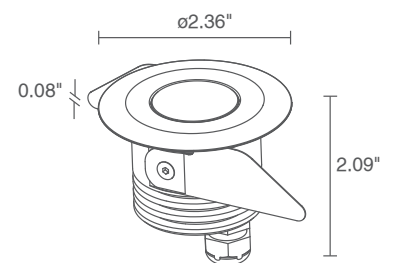

ORDERING INFORMATION

Example: CD10139MAI or CD10139MAI-2. Accessories and Power Supplies ordered separately.

Model No.	CCT	Optics	Finish	Cable Length
CD1013	F - 2700K	S - 8°	AI - Stainless Steel	4.92' standard
	5 - 3000K	M - 26°	AF - Grey	1 - 16.40'
	9 - 4000K	L - 44°	C - Custom	2 - 32.81'
	0 - 5000K	D - Diffuse	(consult factory for "C")	3 - 49.21'
	1 - Blue			4 - 65.62'
CD1011	6 - RGB			

Job Name/Date:

Fixture Type Designation:

SUGGESTED POWER SUPPLIES

700mA

Part Number	Description	Input/Output	# of Fixtures
PPLT00466-P	0-10V Dimming to 1.0%	120-277VAC to 700mA, 10W, Class 2	1-3
PPLT00498	Phase Dim (120V only)	120VAC to 700mA, 12W, Class 2	2-4
PPLT00308-P	0-10V Dimming to 0.1%	120-277VAC to 700mA, 30W, Class 2	1-10
PPLT00261	Leading / Trailing-Edge Dimming to 10% (120V only)	120-277VAC to 700mA, 32W, Class 2	8-10
PPLT00467-P	0-10V Dimming to 1.0%	120-277VAC to 700mA, 50W, Class 2	1-16
PPLT00538-P	0-10V Dimming to 0.1%	120-277VAC to 700mA, 100W, Class 2	1-32

Suggested Lutron Compatible

Part Number	Option	Lutron SKU	Dim Range	Description	Input/Output	# of Fixtures
PPLT00515	L3DAE / L3DA3W	L3DA	100%-1%	Hi-Lume™ 1% EcoSystem™ OR 1% 3-Wire LED Driver	120-277VAC to 700mA, 14W, Class 2	4-4
PPLT00517	L3DAE / L3DA3W	L3DA	100%-1%	Hi-Lume™ 1% EcoSystem™ OR 1% 3-Wire LED Driver	120-277VAC to 700mA, 27W, Class 2	6-9
PPLT00181	L3DAE / L3DA3W	L3DA	100%-1%	Hi-Lume™ 1% EcoSystem™ OR 1% 3-Wire LED Driver	120-277VAC to 700mA, 38W, Class 2	12-12

350mA - RGB

Part Number	Description	Input/Output	# of Fixtures
PPLT00244-P	DMX/RDM (Must advise DMX addresses if not using RDM)	120-277VAC to 350mA, 50W, Class 2	1-12
PPLT00129-P	DMX/RDM (Field Addressable)	120-277VAC to 350mA, 100W, Class 2	1-17

For other power supply options consult factory.

ACCESSORIES - Installation



WC1501
Outer Casing
For in-grade use

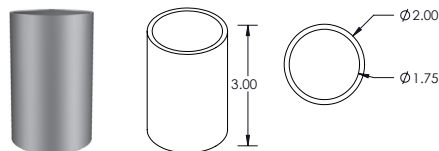

PPMP03113
Core Drilled
Application Sleeve

Job Name/Date:

Fixture Type Designation:

PHOTOMETRIC DATA

Note all Photometry is 3000K

S - 8°

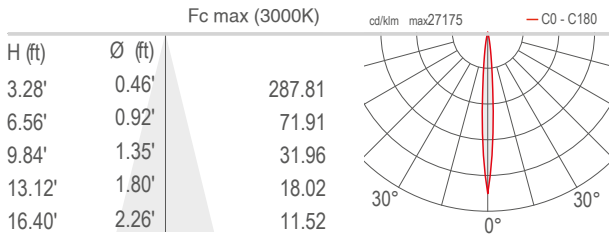

M - 26°

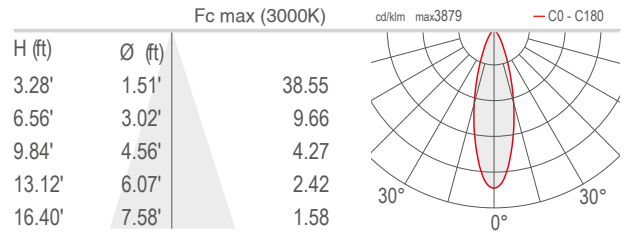

L - 44°

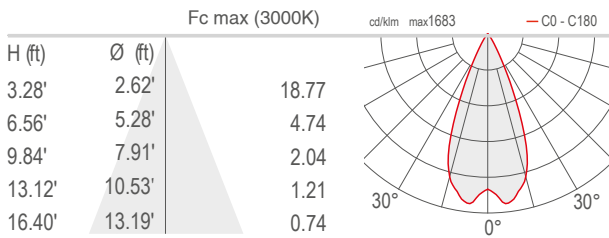

D - Diffuse

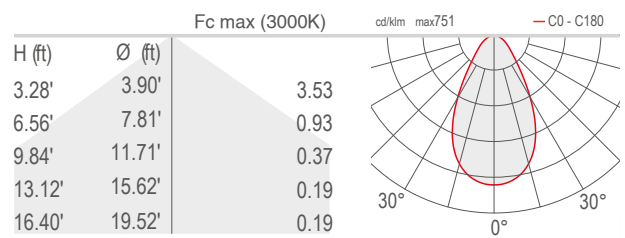

Job Name/Date:

Fixture Type Designation: