

BEAM 2.1

The Beam 2 Series is an in-grade or wall mounted accent or pathway light. Available in a rounded dome or truncated pyramid design with single or double radial beam optics with the choice of white or blue light and 3 different finishes.

TECHNICAL DATA

Wattage / Input	2W (Single Beam: 500mA, Double Beam: 350mA)
Power Supply	Remote, not included. See page 2.
Construction	Body: Stainless Steel or Anodized Aluminum Trim: Stainless Steel or Aluminum Lens: Sandblasted Plexiglass
CCT	2700K, 3000K, 4000K, 5000K, Blue
CRI	>80
BUG Rating	B0-U2-G0 (3000K, 500mA) B0-U3-G0 (3000K, 350mA)
Delivered Lumens	Single Beam: 70 lm (3000K, 500mA) Double Beam: 51 lm (3000K, 350mA) per beam
Efficacy	Single Beam: 35 lm/W (3000K, 500mA) Double Beam: 25.5 lm/W (3000K, 350mA) per beam
Optics	Radial
Finishes	Stainless Steel, Grey, Anthracite, Custom RAL
Fixture Dimensions	2.36" x 2.36" x 2.32"
Cut-out Size	Ø1.77" (for wall installations)
Fixture Weight	1.04 lbs Stainless Steel 0.55 lbs Grey Aluminum
LED Source	Single Beam: 1 Power LED Double Beam: 2 Power LEDs
Lumen Maintenance	L80, B10 >50,000hrs (Ta 25°C)
Color Consistency	1/4 ANSI BIN
Operating Temp.	-4°F to +113°F
IP Rating	IP67
IK Rating	IK09
JA8	Exempt



Cut-out Dimension for wall installations = Ø1.77"

Fixture Dimensions

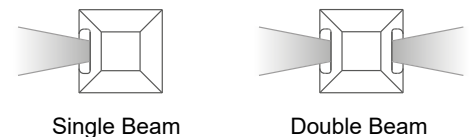
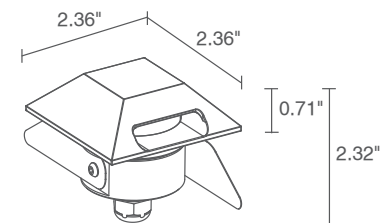

ORDERING INFORMATION

Example: CD20125DAI or CD20125DAI-2. Accessories and Power Supplies ordered separately.

Model No.	CCT	Optics	Finish	Cable Length
CD2112 (Single Beam)	F - 2700K	D - Radial	AI - Stainless Steel	4.92' standard
CD2121 (Double Beam)	5 - 3000K		AF - Grey	1 - 16.40'
	9 - 4000K		AH - Anthracite	2 - 32.81'
	0 - 5000K		C - Custom	3 - 49.21'
	1 - Blue		(consult factory for "C")	4 - 65.62'

Job Name/Date:

Fixture Type Designation:

SUGGESTED POWER SUPPLIES

500mA - Single Beam

Part Number	Description	Input/Output	# of Fixtures
PPLT00469	Phase Dim (120V only)	120VAC to 500mA, 14W, Class 2	4-7
PPLT00262	Leading / Trailing-Edge Dimming to 10% (120V only)	120-277VAC to 500mA, 32W, Class 2	8-14
PPLT00467-P	0-10V Dimming to 1.0%	120-277VAC to 500mA, 50W, Class 2	1-16
PPLT00538-P	0-10V Dimming to 0.1%	120-277VAC to 500mA, 100W, Class 2	1-48

Suggested Lutron Compatible - Single Beam

Part Number	Option	Lutron SKU	Dim Range	Description	Input/Output	# of Fixtures
PPLT00259	L3DAE / L3DA3W	L3DA	100%-1%	Hi-Lume™ 1% EcoSystem™ OR 1% 3-Wire LED Driver	120-277VAC to 500mA, 10W, Class 2	4-5
PPLT00195	L3DAE / L3DA3W	L3DA	100%-1%	Hi-Lume™ 1% EcoSystem™ OR 1% 3-Wire LED Driver	120-277VAC to 500mA, 19W, Class 2	6-9
PPLT00180	L3DAE / L3DA3W	L3DA	100%-1%	Hi-Lume™ 1% EcoSystem™ OR 1% 3-Wire LED Driver	120-277VAC to 500mA, 27W, Class 2	12-13

350mA - Double Beam

Part Number	Description	Input/Output	# of Fixtures
PPLT00496	Phase Dim (120V only)	120VAC to 350mA, 12W, Class 2	2-4
PPLT00263	Leading / Trailing-Edge Dimming to 10% (120V only)	120-277VAC to 350mA, 32W, Class 2	4-7
PPLT00538-P	0-10V Dimming to 0.1%	120-277VAC to 350mA, 100W, Class 2	1-32

Lutron Compatible - Double Beam

Part Number	Option	Lutron SKU	Dim Range	Description	Input/Output	# of Fixtures
PPLT00247	L3DAE / L3DA3W	L3DA	100%-1%	Hi-Lume™ 1% EcoSystem™ OR 1% 3-Wire LED Driver	120-277VAC to 350mA, 7W, Class 2	2-2
PPLT00516	L3DAE / L3DA3W	L3DA	100%-1%	Hi-Lume™ 1% EcoSystem™ OR 1% 3-Wire LED Driver	120-277VAC to 350mA, 13W, Class 2	3-5
PPLT00179	L3DAE / L3DA3W	L3DA	100%-1%	Hi-Lume™ 1% EcoSystem™ OR 1% 3-Wire LED Driver	120-277VAC to 350mA, 19W, Class 2	6-8

For other power supply options consult factory.

Job Name/Date:

Fixture Type Designation:

ACCESSORIES - Installation



WC1501
Outer Casing
For in-grade use

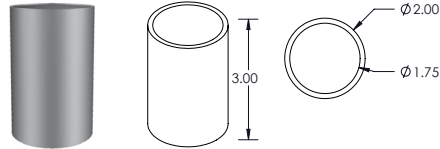

PPMP03113
Core Drilled
Application Sleeve

PHOTOMETRIC DATA

Note all Photometry is 3000K

D - Radial single beam

Isofc (3000K)

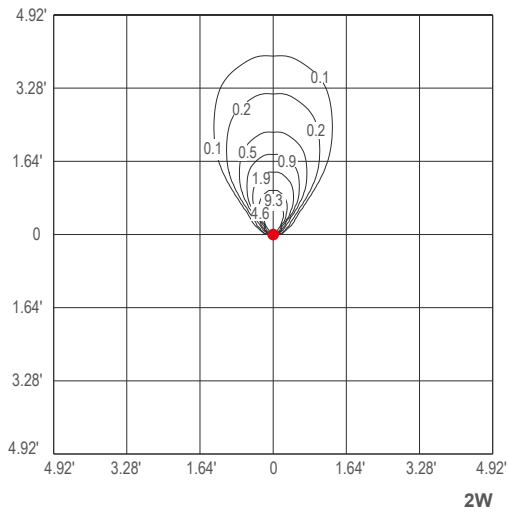

D - Radial double beam

Isofc (3000K)

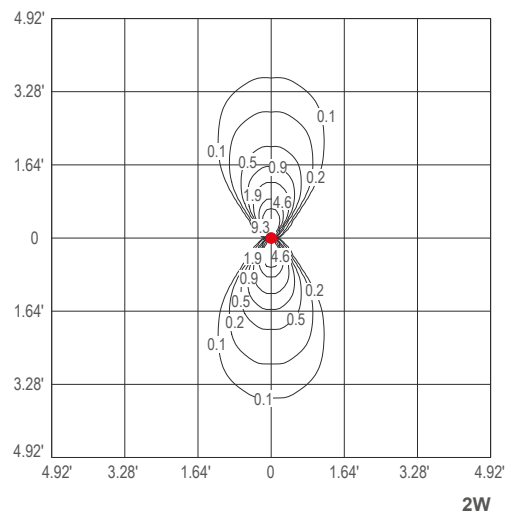

Job Name/Date:

Fixture Type Designation: