

BEAM 2.6

The Beam 2 Series is an ingrade or wall mounted accent or pathway light. Available in a rounded dome or truncated pyramid design with single or double radial beam optics with the choice of white or blue light and 3 different finishes.

TECHNICAL DATA

Wattage / Input	2W (Single or Double Beam: 24VDC)
Power Supply	Remote, not included. See page 2.
Construction	Body: Stainless Steel or Anodized Aluminum Trim: Stainless Steel or Aluminum Lens: Sandblasted Plexiglass
CCT	2700K, 3000K, 4000K, 5000K, Blue
CRI	>80
Delivered Lumens	Single Beam: 70 lm (3000K) Double Beam: 51 lm (3000K) per beam
Efficacy	Single Beam: 35 lm/W (3000K) Double Beam: 25.5 lm/W (3000K) per beam
Optics	Radial
Finishes	Stainless Steel, Grey, Anthracite, Custom RAL
Fixture Dimensions	Ø2.36" x 2.32"
Cut-out Size	Ø1.77" (for wall installations)
Fixture Weight	1.04 lbs Stainless Steel 0.55 lbs Grey Aluminum
LED Source	Single Beam: 1 Power LED Double Beam: 2 Power LEDs
Lumen Maintenance	L80, B10 >50,000hrs (Ta 25°C)
Color Consistency	1/4 ANSI BIN
Operating Temp.	-4°F to +113°F
IP Rating	IP67
IK Rating	IK09
JA8	Exempt



Cut-out Dimension for wall installations = Ø1.77"

Fixture Dimensions

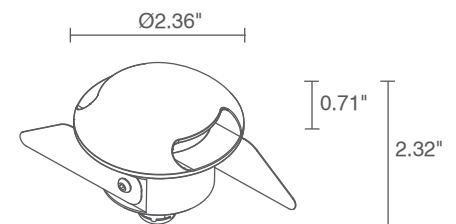

Single Beam



Double Beam

ORDERING INFORMATION

Example: CD26215DH or CD26215DH-2. Accessories and Power Supplies ordered separately.

		D		
Model No.	CCT	Optics	Finish	Cable Length
CD2612 (Single Beam)	F - 2700K	D - Radial	I - Stainless Steel	4.92' standard
CD2621 (Double Beam)	5 - 3000K		F - Grey	1 - 16.40'
	9 - 4000K		H - Anthracite	2 - 32.81'
	0 - 5000K		C - Custom	3 - 49.21'
	1 - Blue		(consult factory for "C")	4 - 65.62'

Job Name/Date:

Fixture Type Designation:

SUGGESTED POWER SUPPLIES

24VDC - Single Beam or Double Beam

Part Number	Description	Input/Output	# of Fixtures
PPLT00149	Non-Dim	120VAC to 24VDC, 10W, Class 2	1-4
PPLT00632	0-10V Dimming (Dim to Off)	120-277VAC to 24VDC, 12W, Class 2	1-4
PPLT00155	Non-Dim	120VAC to 24VDC, 30W, Class 2	1-12
PPLT00157	Non-Dim	120VAC to 24VDC, 60W, Class 2	1-24
PPLT00599	ELV / TRIAC & 0-10V Dimming (100 to 0%)	120-277VAC to 24VDC, 96W, Class 2	1-38
PPLT00543	0-10V Dimming to 15% (-40°C / -40°F cold weather start)	120-277VAC to 24VDC, 100W, Class 2	5-40

For other power supply options consult factory.

ACCESSORIES - Installation



WC1501
Outer Casing
For in-grade use

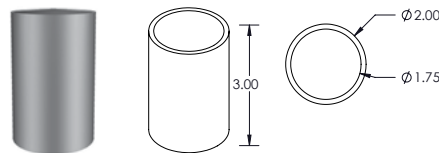

PPMP03113
Core Drilled
Application Sleeve

PHOTOMETRIC DATA

Note all Photometry is 3000K

D - Radial single beam

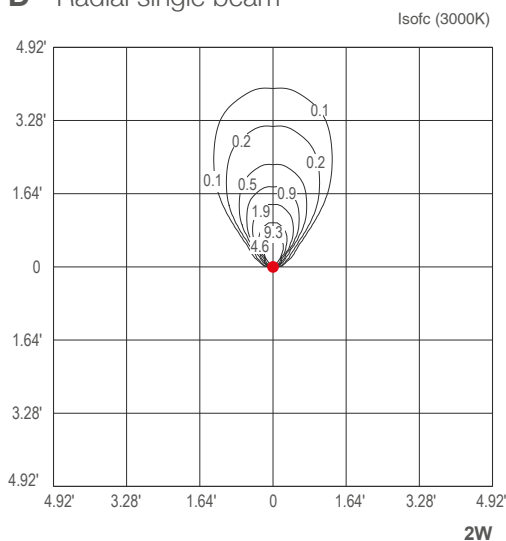

D - Radial double beam

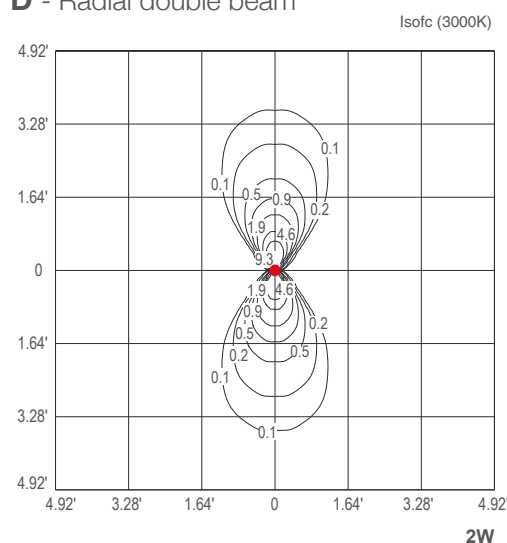

Job Name/Date:

Fixture Type Designation: