

# BEAM 2.7

Beam 2.0 is a recessed in-grade upright with a cap and lateral light emission to indicate pathways and pedestrian zones. It is offered in single or double beam in white or blue light with radial optics and 3 different finishes.

## TECHNICAL DATA

<b>Wattage / Input</b>	2W (single or double beam: 24VDC)
<b>Power Supply</b>	Remote, not included. See page 2.
<b>Construction</b>	Body: Stainless Steel or Anodized Aluminum Trim: Stainless Steel or Aluminum Lens: Sandblasted Plexiglass
<b>CCT</b>	2700K, 3000K, 4000K, 5000K, Blue
<b>CRI</b>	>80
<b>BUG Rating</b>	Single Beam: B0-U2-G0 (3000K) Double Beam: B0-U3-G0 (3000K)
<b>Delivered Lumens</b>	Single Beam: 70 lm (3000K) Double Beam: 51 lm (3000K) per beam
<b>Efficacy</b>	Single Beam: 35 lm/W (3000K) Double Beam: 25.5 lm/W (3000K) per beam
<b>Optics</b>	Radial
<b>Finishes</b>	Stainless Steel, Grey, Anthracite, Custom RAL
<b>Fixture Dimensions</b>	2.36" x 2.36" x 2.32"
<b>Cut-out Size</b>	Ø1.77" (for wall installations)
<b>Fixture Weight</b>	1.04 lbs Stainless Steel 0.55 lbs Grey Aluminum
<b>LED Source</b>	Single Beam: 1 Power LED Double Beam: 2 Power LEDs
<b>Lumen Maintenance</b>	L80, B10 >50,000hrs (Ta 25°C)
<b>Color Consistency</b>	1/4 ANSI BIN
<b>Operating Temp.</b>	-4°F to +113°F
<b>IP Rating</b>	IP67
<b>IK Rating</b>	IK09
<b>JA8</b>	Exempt



Cut-out Dimension for wall installations = Ø1.77"

Fixture Dimensions

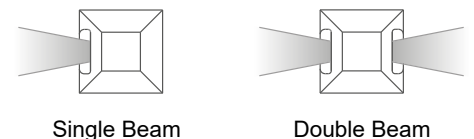
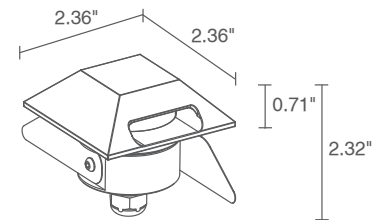

## ORDERING INFORMATION

Example: CD27215DH or CD27215DH-2. Accessories and Power Supplies ordered separately.

Model No.	CCT	Optics	Finish	Cable Length
CD2712 (single beam)	F - 2700K	D - Radial	I - Stainless Steel	4.92' standard
CD2721 (double beam)	5 - 3000K		F - Grey	1 - 16.40'
	9 - 4000K		H - Anthracite	2 - 32.81'
	0 - 5000K		C - Custom	3 - 49.21'
	1 - Blue		(consult factory for "C")	4 - 65.62'

Job Name/Date:

Fixture Type Designation:

## SUGGESTED POWER SUPPLIES

24VDC - Single Beam or Double Beam

Part Number	Description	Input/Output	# of Fixtures
<a href="#">PPLT00149</a>	Non-Dim	120VAC to 24VDC, 10W, Class 2	1-4
<a href="#">PPLT00632</a>	0-10V Dimming (Dim to Off)	120-277VAC to 24VDC, 12W, Class 2	1-4
<a href="#">PPLT00155</a>	Non-Dim	120VAC to 24VDC, 30W, Class 2	1-12
<a href="#">PPLT00157</a>	Non-Dim	120VAC to 24VDC, 60W, Class 2	1-24
<a href="#">PPLT00627</a>	ELV / TRIAC & 0-10V Dimming (100 to 0%), IP67	120-277VAC to 24VDC, 96W, Class 2	1-38
<a href="#">PPLT00543</a>	0-10V Dimming to 15% (-40°C / -40°F cold weather start)	120-277VAC to 24VDC, 100W, Class 2	5-40

For other power supply options consult factory.

## ACCESSORIES - Installation

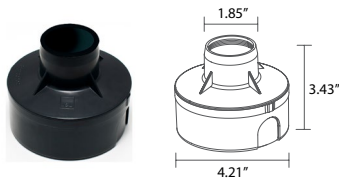

**WC1501**  
Outer Casing  
For in-grade use

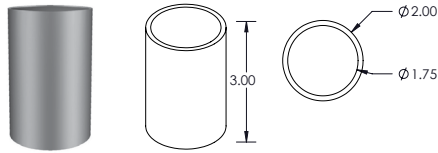

**PPMP03113**  
Core Drilled  
Application Sleeve

## PHOTOMETRIC DATA

Note all Photometry is 3000K

**D - Radial single beam**

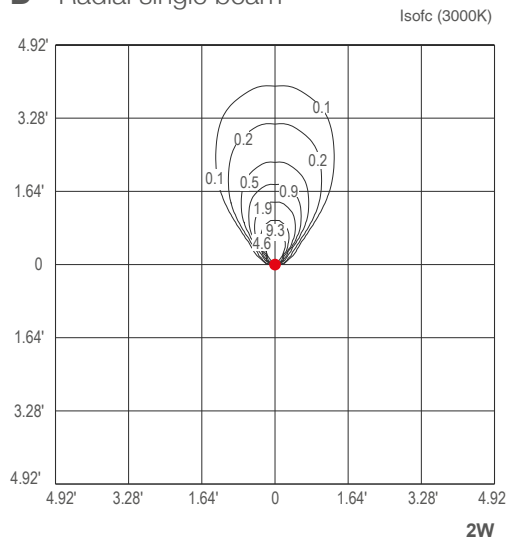

**D - Radial double beam**

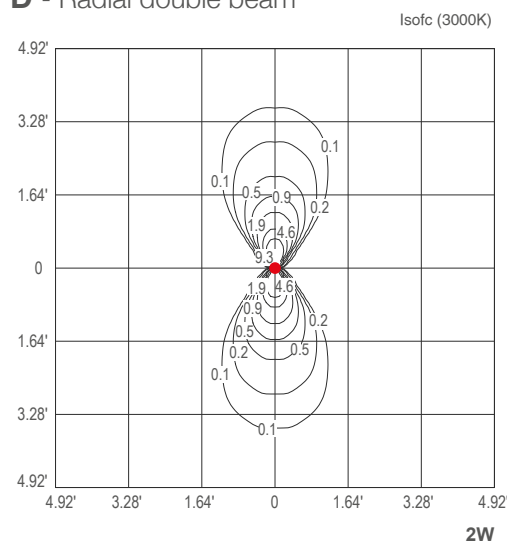

Job Name/Date:

Fixture Type Designation: