

C1-mini-DL is an LED downlight for installation in display case ceilings, suitable for showcase lighting in museum and retail settings. It is 360° rotatable, 55° swivelling and available with a variety of optics, 5 color temperatures and 3 standard finishes.



Euro coin is 0.92"



TECHNICAL DATA

Wattage / Input	2.7W (700mA)
Power Supply	Remote, not included. See page 3.
Construction	Body: Anodized Aluminum
CCT	2700K, 3000K, 3500K, 4000K, 5700K
CRI	>90
Delivered Lumens	150 lm (3000K, 30°)
Efficacy	57 lm/W (3000K, 30°)
Optics	9 Standard, See Below
Finishes	3 Standard, See Below
Fixture Dimensions	Ø0.65" x 2.20" h
Lumen Maintenance	L80,B10 >50,000hrs
IP Rating	IP20

Fixture Dimensions

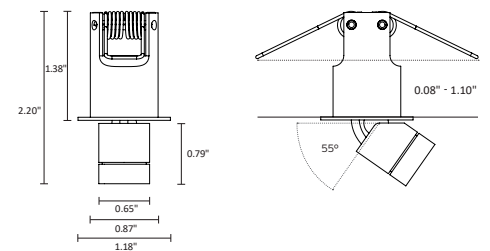

ORDERING INFORMATION

Example: C1-MINI-DL-27-40-18-G. Accessories / Power Supplies ordered separately.

C1-MINI-DL	-	27	-		-		-	
Model No.	Wattage	CCT	Optics	Finish				
C1-MINI-DL	27 - 2.7W	27 - 2700K 30 - 3000K 35 - 3500K 40 - 4000K 57 - 5700K	08 - 8° 15 - 15° 18 - 18° 26 - 26° 30 - 30° 45 - 45° 80 - 80° 47 - 47°+25° 40 - 40°+10°	B - Anodized Black S - Silver G - Gold C - Custom RAL (consult factory for "C")				

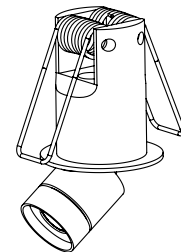

Job Name/Date:

Fixture Type Designation:

ACCESSORIES



Honeycomb Grid



Anti-Glare Tube



Inclined Tube



Snoot (8°)

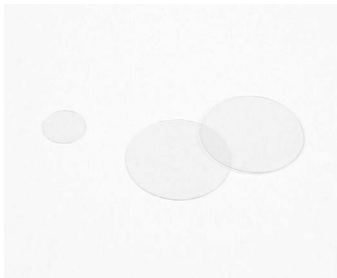

Light Diffusion Foil

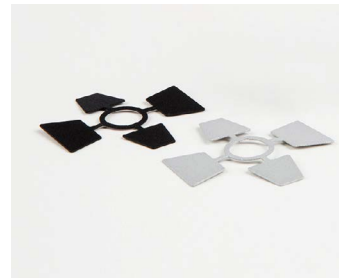

Barn Door



Zoom Optic (9°-33°)

PHOTOMETRIC DATA

for light color 3,000 K | standard lens 30° | color rendering index typ. 97, R9 > 90, R12 > 90 | color variation ≤ 3 SDCM

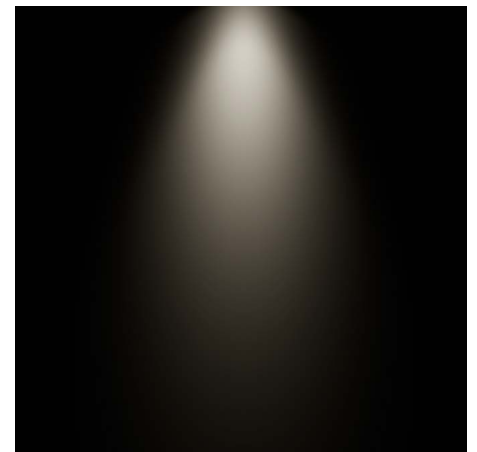
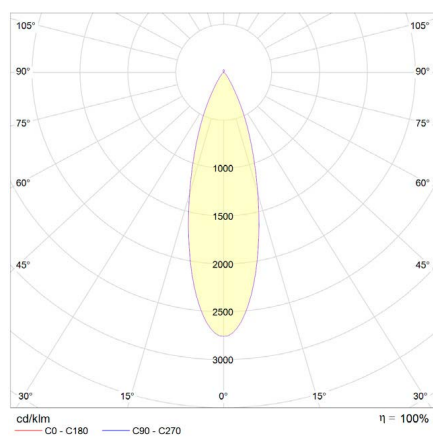
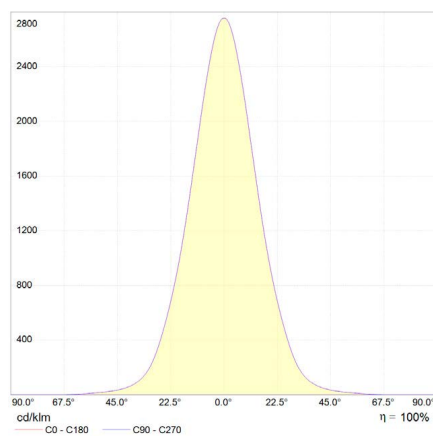

Job Name/Date:

Fixture Type Designation:

SUGGESTED POWER SUPPLIES

700mA

Part Number	Description	Input/Output	# of Fixtures
PPLT00498	Phase Dim (120V only)	120VAC to 700mA, 12W, Class 2, DAMP	2-4
PPLT00309-P	0-10V Dimming to 0.1%	120-277VAC to 700mA, 50W, Class 2, DAMP	1-14

Suggested Lutron Compatible

Part Number	Option	Lutron SKU	Dim Range	Description	Input/Output	# of Fixtures
PPLT00515	L3DAE / L3DA3W	L3DA	100%-1%	Hi-Lume™ 1% EcoSystem™ or 1% 3-Wire LED Driver	120-277VAC to 700mA, 14W, Class 2	4-4

For other power supply options consult factory.

Job Name/Date:

Fixture Type Designation: