

The Cameo 2.7 is a small adjustable recessed downlight for indoor applications. With $\pm 20^\circ$ tiltable optics and 360° rotation, the fixture is ideal for tight plenums, false ceilings and niches in plasterboard.



TECHNICAL DATA

| | |
|---------------------------|---|
| Wattage / Input | 5W (24VDC) |
| Power Supply | Remote, not included. See page 2. |
| Construction | Body/Trim: Aluminum Alloy EN AW 6026 Cable Length: 4.92' |
| CCT | 2700K, 3000K, 4000K (3500K on request, consult factory) |
| CRI | >90 |
| Delivered Lumens | 303 lm (3000K, 32°) |
| Efficacy | 60.6 lm/W (3000K, 32°) |
| Optics | 6 Standard (see below) |
| Finishes | White, Black, Custom RAL |
| Fixture Dimensions | $\varnothing 2.72"$ x 1.89" h |
| Cut-out Size | $\varnothing 2.56"$ (for ceiling installations) |
| Fixture Weight | 0.33 lbs |
| LED Source | 1 Power High Intensity LED |
| Lumen Maintenance | L95, B10 >50,000hrs (Ta 25°C) |
| Color Consistency | 3-Step MacAdam |
| Operating Temp. | 32°F to +113°F |
| IP Rating | IP40 |
| IK Rating | - |

Cutout Dimensions for ceiling installations = $\varnothing 2.56"$

Fixture Dimensions

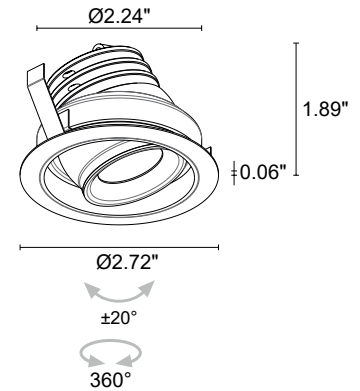

ORDERING INFORMATION

Example: CM27001000F0SN. Power Supplies / Accessories ordered separately.

| | | | |
|------------------|--|--|---|
| CM27001000 | | | |
| Model No. | CCT | Optics | Finish |
| CM27001000 | F0 - 2700K 50 - 3000K 90 - 4000K | S - 11° tiltable $\pm 20^\circ$ M - 17° tiltable $\pm 20^\circ$ P - 19° sharp tiltable $\pm 20^\circ$ L - 32° tiltable $\pm 20^\circ$ J - 65° tiltable $\pm 20^\circ$ W - 13° x 43° tiltable $\pm 20^\circ$ | E - White N - Black C - Custom RAL (Consult factory for "C") |

Job Name/Date:

Fixture Type Designation:

SUGGESTED POWER SUPPLIES

24VDC

| Part Number | Description | Input/Output | # of Fixtures |
|---------------------------|---|-------------------------------------|---------------|
| PPLT00149 | Non-Dim | 120VAC to 24VDC, 10W, Class 2, IP65 | 1-1 |
| PPLT00632 | 0-10V Dimming (Dim to Off) | 120-277VAC to 24VDC, 12W, Class 2 | 1-1 |
| PPLT00481 | Non-Dim | 120-277VAC to 24VDC, 24W, Class 2 | 1-3 |
| PPLT00586 | Non-Dim | 120-277VAC to 24VDC, 40W, Class 2 | 1-6 |
| PPLT00543 | 0-10V Dimming to 15% (-40°C / -40°F cold weather start) | 120-277VAC to 24VDC, 100W, Class 2 | 2-16 |

Suggested Lutron Compatible

| Part Number | Option | Lutron SKU | Dim Range | Description | Input/Output | # of Fixtures |
|---------------------------|----------------|------------|-----------|--|-----------------------------------|---------------|
| PPLT00273 | L3DAE / L3DA3W | L3DA | 100%-1% | Hi-Lume™ 1% EcoSystem™ or 1% 3-Wire LED Driver | 120-277VAC to 24VDC, 40W, Class 2 | 1-6 |
| PPLT00530 | L3DAE / L3D0 | L3DA/L3D0 | 100%-1% | Hi-Lume™ 0.1% EcoSystem™ or 3-Wire LED Driver | 120-277VAC to 24VDC, 96W, Class 2 | 1-15 |

For other power supply options consult factory.

ACCESSORIES - Installation

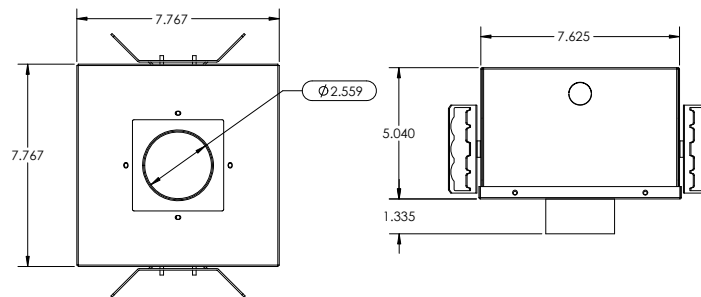
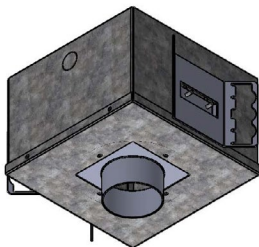

AH-00010-IC (IC Rated)

AH-00010-CP (Chicago Plenum Rated)

Housing for recessed installation in ceilings.

Job Name/Date:

Fixture Type Designation:

PHOTOMETRIC DATA

Note all Photometry is 3000K

S - 11°

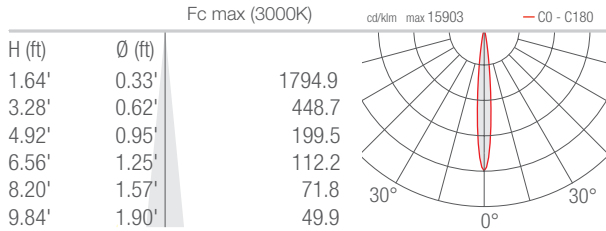

M - 17°

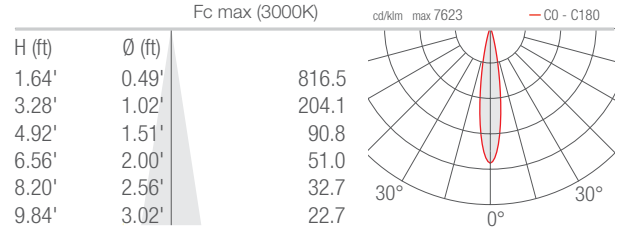

P - 19° Sharp

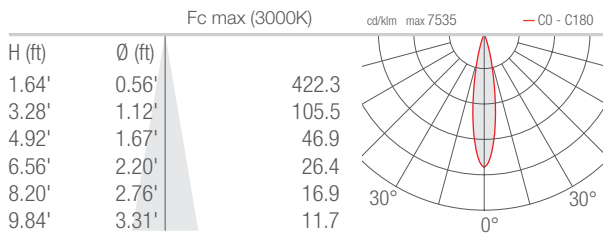

L - 32°

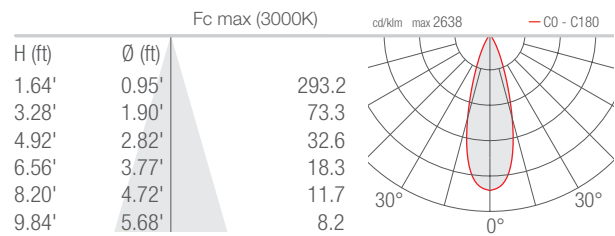

J - 65°

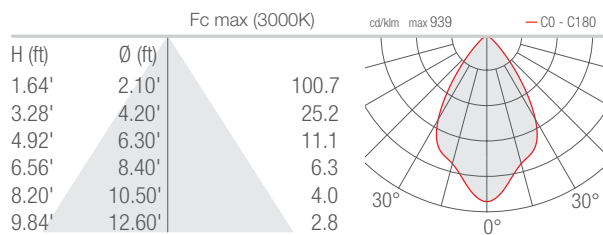

W - 13°x43°

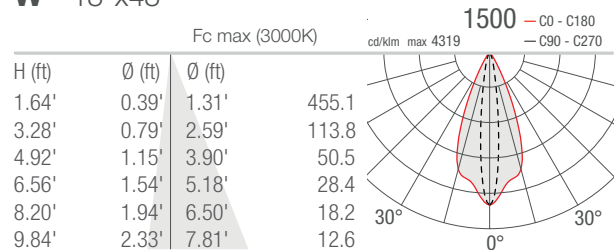

Job Name/Date:

Fixture Type Designation: