

Chromos is a semi-recessed hemisphere LED from which indirect light radiates - suitable for indoor installation on walls and ceilings. It is available in static white or RGB with 3 standard finishes.



TECHNICAL DATA

Wattage / Input	1.2W (350mA), 4W RGB (350mA)
Power Supply	Remote, not included. See page 2.
Construction	Body:
CCT	2700K, 3000K
CRI	>80
Delivered Lumens	94 lm (3000K)
Efficacy	78.3 lm/W (3000K)
Finishes	Textured White, Textured Black, Chrome
LED Source	CREE XPE LED
Fixture Dimensions	Ø2.52" x 1.65" I
Cutout Dimensions	Ø1.89" (Installation Depth: 1.77")
Fixture Weight	0.66 lbs
IP Rating	IP20

Fixture Dimensions

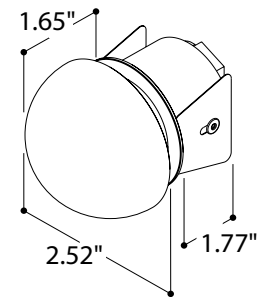

ORDERING INFORMATION

Example: T177928. Power Supplies ordered separately.

Model No.	Description
T177078	2700K, Textured White
T177076	2700K, Textured Black
T177070	2700K, Chrome
T177927	3000K, Textured White
T177928	3000K, Textured Black
T177920	3000K, Chrome

Job Name/Date:

Fixture Type Designation:

SUGGESTED POWER SUPPLIES

350mA

Part Number	Description	Input/Output	# of Fixtures
PPLT00138	0-10V Dimming to 10%	120-277VAC to 350mA, 4W, Class 2	1-3
PPLT00496	Phase Dim (120V only)	120VAC to 350mA, 12W, Class 2	2-9
PPLT00308-P	0-10V Dimming to 0.1%	120-277VAC to 350mA, 30W, Class 2	1-16
PPLT00467-P	0-10V Dimming to 1.0%	120-277VAC to 350mA, 50W, Class 2	1-16
PPLT00538-P	0-10V Dimming to 0.1%	120-277VAC to 350mA, 100W, Class 2	1-68

Suggested Lutron Compatible

Part Number	Option	Lutron SKU	Dim Range	Description	Input/Output	# of Fixtures
PPLT00252	LTEA2W	LTEA	100%-1%	Hi-Lume™ 1% 2-Wire LED Driver (120V forward phase only)	120VAC to 350mA, 7W, Class 2	3-5
PPLT00247	L3DAE / L3DA3W	L3DA	100%-1%	Hi-Lume™ 1% EcoSystem™ or 1% 3-Wire LED Driver	120-277VAC to 350mA, 7W, Class 2	3-5
PPLT00516	L3DAE / L3DA3W	L3DA	100%-1%	Hi-Lume™ 1% EcoSystem™ or 1% 3-Wire LED Driver	120-277VAC to 350mA, 13W, Class 2	5-10
PPLT00271	LTEA2W	LTEA	100%-1%	Hi-Lume™ 1% 2-Wire LED Driver (120V forward phase only)	120VAC to 350mA, 13W, Class 2	5-10
PPLT00179	L3DAE / L3DA3W	L3DA	100%-1%	Hi-Lume™ 1% EcoSystem™ or 1% 3-Wire LED Driver	120-277VAC to 350mA, 19W, Class 2	10-15
PPLT00220	LTEA2W	LTEA	100%-1%	Hi-Lume™ 1% 2-Wire LED Driver (120V forward phase only)	120VAC to 350mA, 19W, Class 2	10-15

For other power supply options consult factory.

ACCESSORIES - Installation

T177077

Installation Box for Plaster - cutout 3.62" x H 3.03"

T177097

Installation Frame for Plaster - cutout 1.89"

PHOTOMETRIC DATA

Note all Photometry is 3000K

Maximum Candela = 1.8

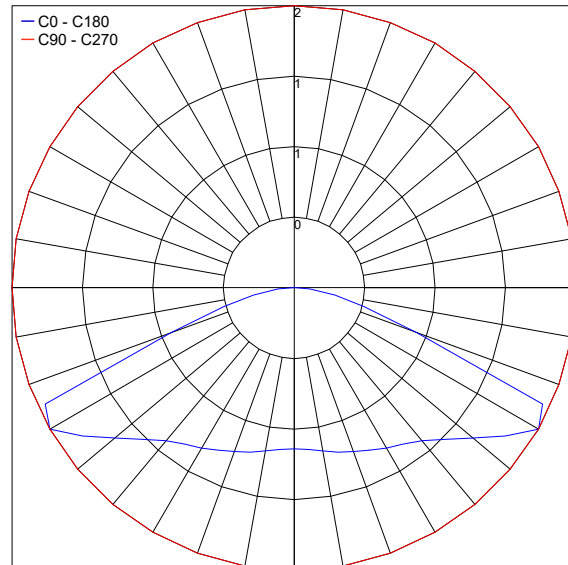

PHOTOMETRIC FILENAME : CHROMOS 3000K.IES

Job Name/Date:

Fixture Type Designation:

Job Name/Date:

Fixture Type Designation: