

With a depth of only 0.87" the Ciak 1.7 recessed adjustable downlight can accommodate the tightest of spaces. With 350° rotation and 5 optical options this fixture can be used in a wide array of applications.



Ceiling Cut-Out: Ø1.97"
 Fixture Dimensions
 Ø1.18" x 0.87" h x Ø2.17" outer rim

TECHNICAL DATA

| | |
|---------------------------|--|
| Wattage / Input | 2.5W (24VDC) |
| Power Supply | Remote, not included. See page 2. |
| Construction | Body and Trim: Aluminum Springs: AISI 301 Harmonic Steel Cable Length: 4.92' |
| CCT | 2700K, 3000K, 4000K |
| CRI | CRI>90 |
| Delivered Lumens | 144 lm (3000K, 500mA) |
| Efficacy | 57.6 lm/W |
| Optics | 17°, 29°, 48° sharp, 52°, 16°x34° |
| Finishes | White, Black, Custom RAL (see below) (4 Stage Marine Grade Finish) |
| Cut-Out Dimensions | Ø1.97" |
| Fixture Dimensions | Ø1.18" x 0.87" h x Ø2.17" outer rim |
| Fixture Weight | 0.15 lbs |
| LED Source | 1 Power LED |
| Lumen Maintenance | L90,B10 >50,000hrs (Ta 25°C) |
| Color Consistency | 1/4 ANSI BIN |
| Operating Temp. | 32°F to 113°F |
| IP Rating | IP40 |
| Impact Rating | — |

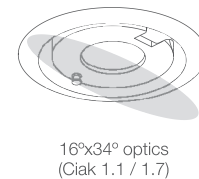
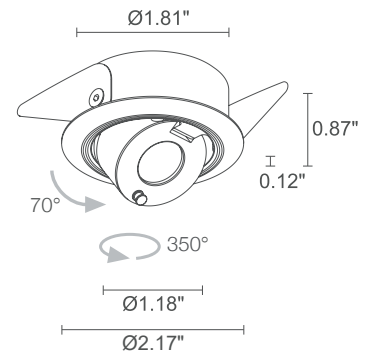

ORDERING INFORMATION

Example: CK170015SN. Accessories / Power Supplies ordered separately.

| CK17001 | | | |
|-----------|-------------------------------------|---|---|
| Model No. | CCT | Optics | Finish |
| CK17001 | F - 2700K 5 - 3000K 9 - 4000K | S - 17° M - 29° P - 48° L - 52° W - 16°x34° | B - White N - Black C - Custom RAL (consult factory for "C") |

Job Name/Date:

Fixture Type Designation:

SUGGESTED POWER SUPPLIES

24VDC

| Part Number | Description | Input/Output | # of Fixtures |
|---------------------------|---|------------------------------------|---------------|
| PPLT00284 | Non-Dim | 120-277VAC to 24VDC, 100W, Class 2 | 1-32 |
| PPLT00543 | 0-10V Dimming to 15% (-40°C / -40°F cold weather start) | 120-277VAC to 24VDC, 100W, Class 2 | 4-32 |

Suggested Lutron Compatible

| Part Number | Option | Lutron SKU | Dim Range | Description | Input/Output | # of Fixtures |
|---------------------------|--------------|------------|-----------|---|-----------------------------------|---------------|
| PPLT00530 | L3DAE / L3D0 | L3DA/L3D0 | 100%-1% | Hi-Lume™ 0.1% EcoSystem™ or 3-Wire LED Driver | 120-277VAC to 24VDC, 96W, Class 2 | 1-30 |

DRIVERS IN NEMA ENCLOSURE

Remote 24VDC - ELV / TRIAC / 0-10V



PPLT00715

| Part Number | Description | Input/Output | # of Fixtures |
|---------------------------|-------------------------------------|---|---------------|
| PPLT00715 | ELV / TRIAC / 0-10V Dimming to 0.1% | 120-277VAC to 24VDC, 96W, Class 2, WET/DAMP | 1-30 |

For other power supply options consult factory.

ACCESSORIES - Installation

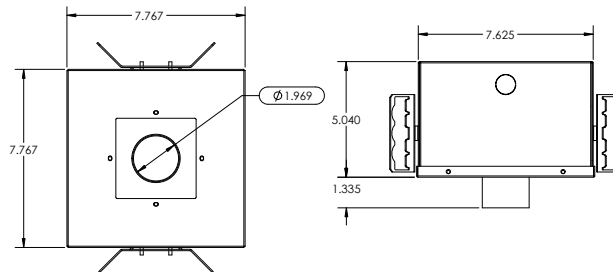
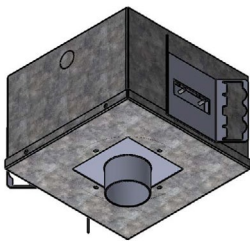

AH-00011-IC (IC Rated)

AH-00011-CP (Chicago Plenum Rated)

Housing for recessed installation in ceilings.

Job Name/Date:

Fixture Type Designation:

PHOTOMETRIC DATA

Note all Photometry is 3000K

S - 17°

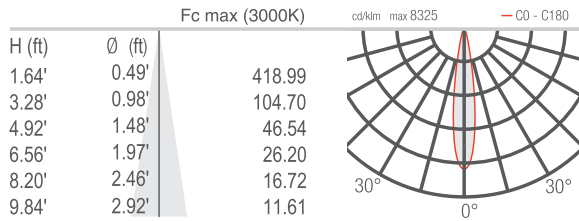

M - 29°

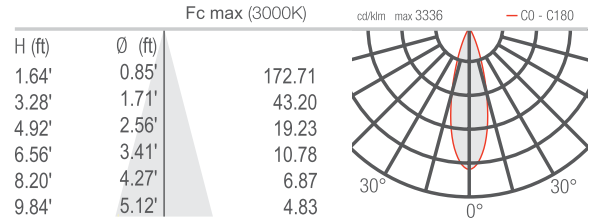

P - 48° sharp

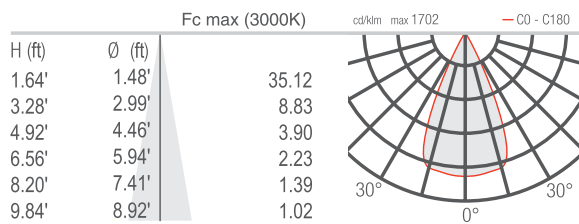

L - 52°

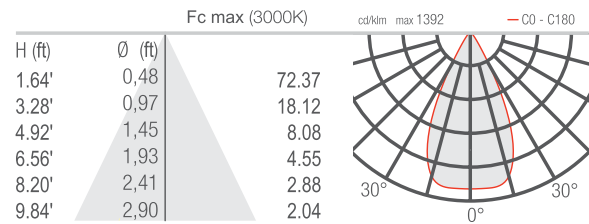

W - 16°x34°

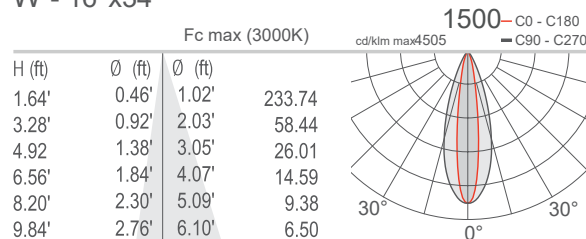

Job Name/Date:

Fixture Type Designation: