



INSTRUCTIONS PERTAINING TO RISK OF FIRE OR INJURY TO PERSONS. READ ALL INSTRUCTIONS. IMPORTANT SAFETY INSTRUCTIONS. SAVE THESE INSTRUCTIONS.

DANGER - RISK OF SHOCK - DISCONNECT POWER BEFORE INSTALLATION! Please read all instructions before installation.

- Keep these instructions for future reference.
- Must be installed by a qualified electrician in accordance with national and local standards. Designplan is not responsible for fixtures installed without regard to these standards.
- Unauthorized alterations or tampering of product voids warranty.
- The main power connection must be in accordance with local electrical codes.
- Suitable for OUTDOOR applications.



Electrical Connections:

- LED lights must be **connected in parallel** respecting polarities.
- **CHOOSE POWER SUPPLY ACCORDINGLY.** Please consider the voltage through which fixtures are fed as well as the max power consumption.
- **Connect power only if all the fixtures are connected.**
- The power supplies **MUST** be installed in aerated rooms, far from heat sources. Overworking or lack of air circulation will not permit natural dissipation.
- Use only Class 2 type electronic power supply.
- Never use switches on secondary circuit.

ATTENTION: For Wall/Ceiling - It is the contractor's responsibility to caulk around all the edges between the fixture and the mounting surface to satisfy wet label requirements.

Maintenance

Scheduled maintenance must be carried out once a year on all lighting devices, regardless of appliance class and type of use. It must include the following operations:

- Periodically clean fixtures to remove dirt from gratings and screw heads.
- Check tightness of screws on various parts of the device.
- Check that all cable glands and cables are intact and tight. Check that the glass or plastic lens is intact, and replace it if broken or damaged.
- The internal components such as the ballast, driver, washers and screws must not show clear signs of oxidation or rust. Clear traces of rust and oxidation will indicate the presence of water inside the device.
- In the case of damage, the components must be replaced by original components or spare parts.

- DOTZ PEGASUS
- DOTZ DORADO
- DOTZ TAURUS
- DOTZ CASSIOPEA
- DOTZ PICES
- DOTS TAURUS
- DOTZ HYDRA
- DOTZ URSA MAJOR

Fixture Installation

- The fixtures with springs are designed to be installed in a 1.25" diameter hole. If access is available to the back of the fixture after installation you can use a 1.0" conduit nut to secure in place.
- The fixture is supplied with 2.0' of CL3 18/4 shielded plenum rated cable. This fixture requires a 24VDC remote driver (**+/-5% at fixture**). CONNECT GREEN WIRE TO NEGATIVE 24VDC WIRE; CONNECT RED FIXTURE WIRE TO POSITIVE 24VDC WIRE; CONNECT NEGATIVE BLACK WIRE TO NEGATIVE 0-10V DIMMING SYSTEM; CONNECT POSITIVE WIRE TO 0-10V DIMMING SYSTEM.
- In order to comply to class II wiring each leg of power should not exceed 100W. If using a 24VDC power supply larger than 100W then each leg will require a 4 amp fuse. All wiring between fixtures on the same leg, to be wired in parallel.
- Make sure trim and all other screws and fittings are securely fastened and loosened from transit Make supply connections and insert the fixture into the wall. It is the contractor's responsibility to caulk around all the edges between the fixture and the mounting surface, to satisfy wet label requirements.

Wiring Diagram

Use gel-filled waterproof wire-nuts for wire connections.

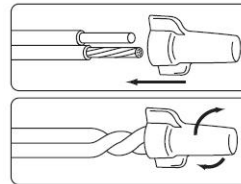

It is the contractor's responsibility to install Remote Driver in a suitable electrical enclosure.

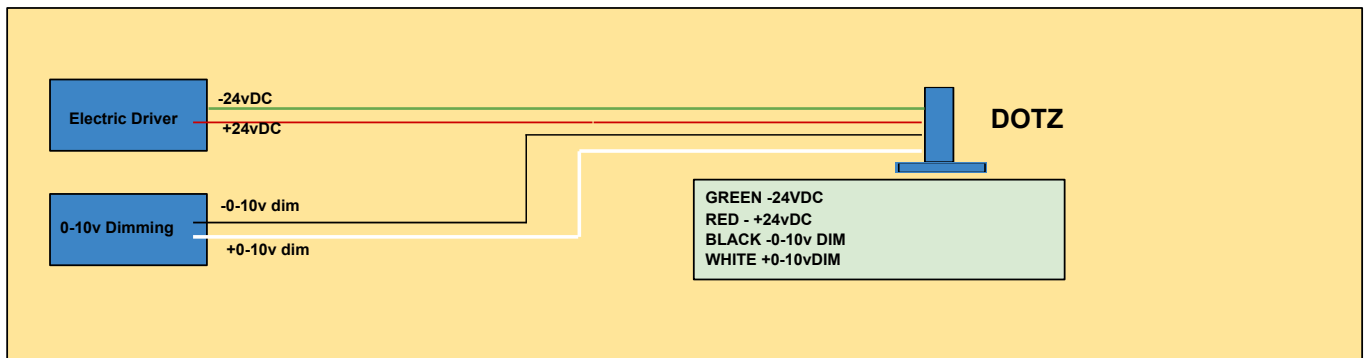

FOR 4 WIRE:

RED: +24VDC
 GREEN: -24VDC
 BLACK: -(0-10V) DIM
 WHITE: +(0-10V) DIM

FOR 5 WIRE:

RED/BROWN: +24VDC
 GREEN: -24VDC
 BLACK: -(0-10V) DIM
 WHITE: +(0-10V) DIM