



**INSTRUCTIONS PERTAINING TO RISK OF FIRE OR INJURY TO PERSONS. READ ALL INSTRUCTIONS. IMPORTANT SAFETY INSTRUCTIONS. SAVE THESE INSTRUCTIONS.**

**DANGER - RISK OF SHOCK - DISCONNECT POWER BEFORE INSTALLATION! Please read all instructions before installation.**

- Keep these instructions for future reference.
- Must be installed by a qualified electrician in accordance with national and local standards. Designplan is not responsible for fixtures installed without regard to these standards.
- The main power connection must be in accordance with local electrical codes.





**ATTENTION:** For Surface- It is the contractor's responsibility to caulk around all the edges between the fixture and the mounting surface to satisfy wet label requirements.

## Maintenance

Scheduled maintenance must be carried out once a year on all lighting devices, regardless of appliance class and type of use. It must include the following operations:

- Periodically clean fixtures to remove dirt from gratings and screw heads.
- Check tightness of screws on various parts of the device.
- Check that all cable glands and cables are intact and tight. Check that the glass or plastic screen is intact, and replace it if broken or damaged.
- The internal components such as the ballast, driver, washers and screws must not show clear signs of oxidation or rust. Clear traces of rust and oxidation will indicate the presence of water inside the device.
- In the case of damage, the components must be replaced by original components or spare parts.

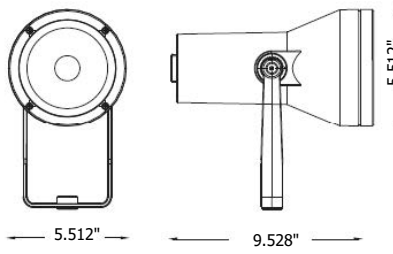
## Fixture Dimensions/Specifications

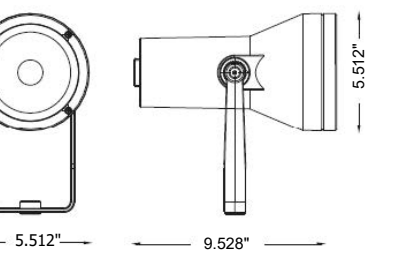
<p><b>COD. 101101</b></p> 		<p><b>HYDROFLASH MEDIUM LED</b>                  -Power consumption : 8W                  -Voltage :120VAC                  -Color Temperature : 3000K/4000K                  -Lens Type : 10° 30° 45°                  -Insulation class: 1                  -IP protection: IP65                  -Gross weight: 5.73 lbs</p>
<p><b>COD. 101102</b></p> 		<p><b>HYDROFLASH MEDIUM COB LED</b>                  -Power consumption: 18W                  -Voltage :120VAC                  -Color Temperature : 3000K                  -Lens Type : 35°                  -Insulation class: 1                  -IP protection: IP65                  -Gross weight: 5.73 lbs</p>

### Fixture Dimensions for Pole Version

#### SINGLE FLASH POLE

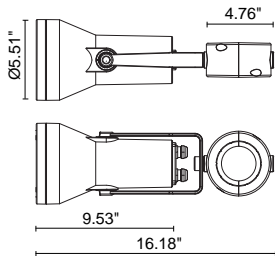

#### DOUBLE FLASH POLE

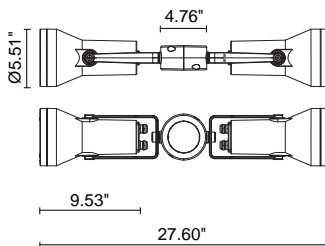

- It is the contractor's responsibility to install Remote Driver in a suitable electrical enclosure.

Use wire-nuts for wire connections.

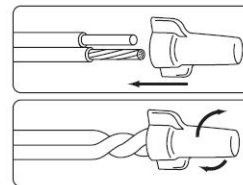

## ACCESSORIES



**AC-027P**  
Anti-Glare Visor  
*For Flash Medium  
version*

## Pole Mount Installation



- Accessory for mounting fixture to pole is provided.
- Use M5 Allen Key to unscrew all screws as shown.
- Pole mount accessory may be adjusted onto pole as shown.
- Once pole mount accessory is slid into place in desired location, screws may be put back into place.
- Fixture may be installed into pole mount accessory using the screw provided, as shown.
- Fixture angle may be adjusted either prior to or after installing it onto pole mount accessory.

