

GENIUS BRASS

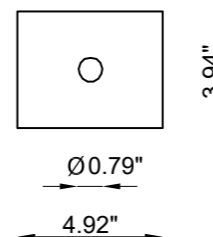

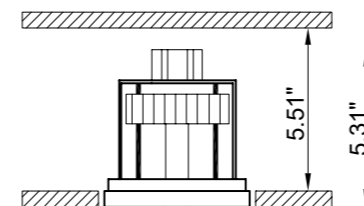
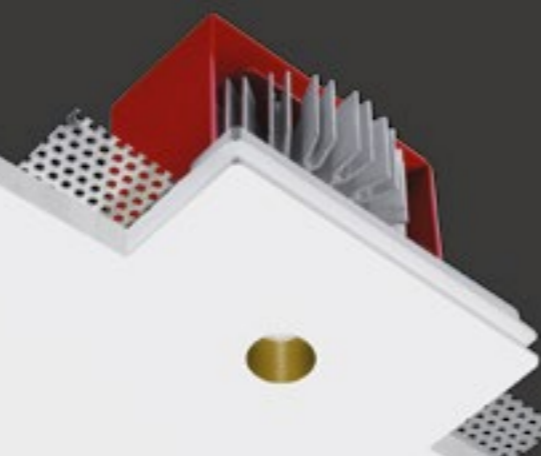

Genius Brass is a total recessed indoor luminaire made of AirCoral® and installable on plasterboards or brick ceilings. The light emission hole, only 0.79" wide, is provided with a brass cylinder which gives a precious touch to a product already extremely elegant. Genius Brass' characteristics enhance visual comfort and generates a warm light which makes the environments more welcoming.

The electrical part can be extracted directly from the emission hole with a simple hand gesture. This is possible thanks to the push-pull mechanism, which facilitates the eventual extraction and replacing of the LED source in case of maintaining.



TECHNICAL FEATURES

Code	BU1861.AC.US
Type	Downlight 90° 
Material	AC: AirCoral®
Absorption capacity*	14.96 ft ²
Weight	1.76 lbs
Mounting	Ceiling recessed
IP rating	IP20
Control gear	Remote constant current electronic driver (not included)
Cut out for plasterboard	5.31" x 4.33"
Lamp type	LED 700mA 
Lamp wattage	1 x 8.5W
Luminous efficacy	71.2 lm/W - 3000K
Light distribution	Wide beam 40°
Light color	White 3000K
Light hole	Ø 0.79"
CRI	>90



79 Trenton Avenue
Frenchtown, NJ 08825

www.designplan.com

Tel: (908) 996-7710
Fax: (908) 996-7042

* The absorption capacity per ft³ calculated by the American organization TCNA (Tile Council of North America) is measured for an average room of 8.86' in height and therefore expressed in ft²