

# GENIUS BASIC NAKED IP65

The Genius Basic Naked IP65 is an outdoor version of the Genius Basic Naked with a protection rating of IP65. It is **installed from above** by being glued on wood, cement, mirror or marble, with a thickness of from 0.16" to a maximum of 1.18". Once installed the discreet aperture of 1.0" disappears into the surround.

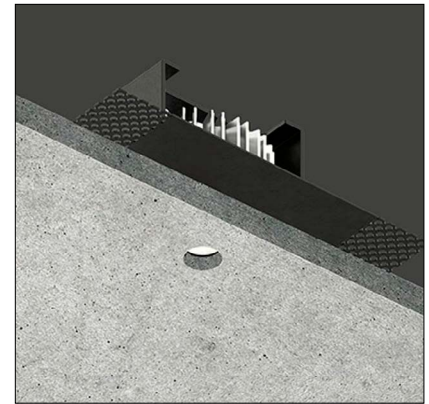

## TECHNICAL DATA

<b>Wattage / Input</b>	6W (500mA)
<b>Power Supply</b>	Remote, not included. See page 2.
<b>Construction</b>	Body: Aluminum, Steel
<b>CCT</b>	3000K (standard) (2700K, 4000K on request, consult factory)
<b>CRI</b>	>90
<b>Delivered Lumens</b>	239 lm (3000K)
<b>Efficacy</b>	59.8 lm/W
<b>Optics</b>	24°
<b>Finishes</b>	Black
<b>Fixture Dimensions</b>	5.51 l x 3.15 w x 3.15" h
<b>Aperture</b>	Ø0.98"
<b>Fixture Weight</b>	1.43 lbs
<b>LED Source</b>	1 COB Professional LED
<b>IP Rating</b>	IP65

Fixture Dimensions:

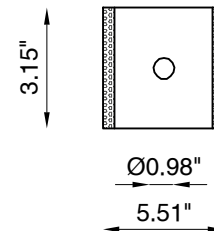
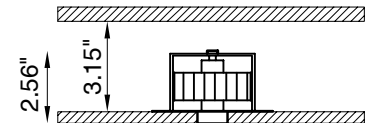

## ORDERING INFORMATION

Example: BU2071BL4R24M.30.WD.US. Power Supplies ordered separately.

BU2071BL4R24M		WD.US
<b>Model No.</b>	<b>CCT</b>	
BU2071BL4R24M	30 - 3000K (standard) 27 - 2700K (on request) 40 - 4000K (on request)	WD.US

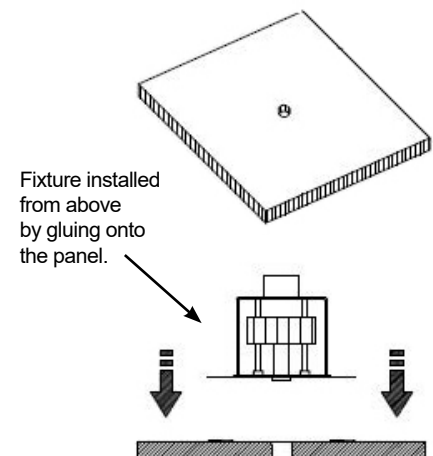

Job Name/Date:

Fixture Type Designation:

## SUGGESTED POWER SUPPLIES

500mA

Part Number	Description	Input/Output	# of Fixtures
<a href="#">PPLT00497</a>	Phase Dim (120V Only)	120VAC to 500mA, 12W, Class 2, DAMP	1-3
<a href="#">PPLT00465-P</a>	0-10V Dimming to 1.0%	120-277VAC to 500mA 20W, Class 2, DAMP	1-5
<a href="#">PPLT00262</a>	Leading / Trailing Edge Dimming to 10% (120V Only)	120-277VAC to 500mA, 32W, Class 2	4-6
<a href="#">PPLT00309-P</a>	0-10V Dimming to 1.0%	120-277VAC to 500mA, 50W, Class 2, DAMP	1-8

## Suggested Lutron Compatible Drivers

Part Number	Option	Lutron SKU	Dim Range	Description	Input/Output	Fixtures
<a href="#">PPLT00195</a>	L3DAE / L3DA3W	L3DA	100%-1%	Hi-Lume™ 1% EcoSystem™ or 1% 3-Wire LED Driver	120-277VAC, 500mA, 19W	3-4
<a href="#">PPLT00180</a>	L3DAE / L3DA3W	L3DA	100%-1%	Hi-Lume™ 1% EcoSystem™ or 1% 3-Wire LED Driver	120-277VAC, 500mA, 27W	6-6

For other power supply options consult factory.

## ACCESSORIES

### Maintenance

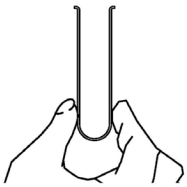

**C6916**  
LED Slug Removal Tool

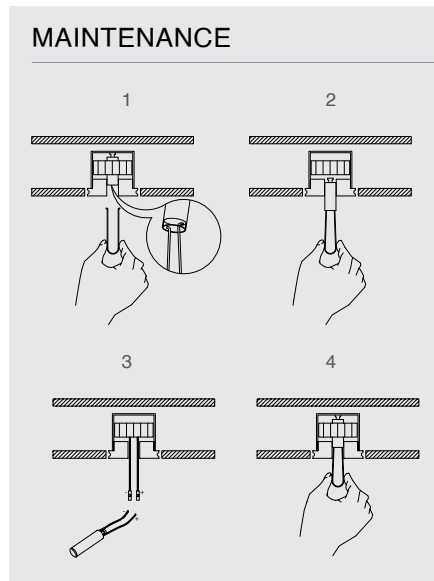

## REPLACEMENT BULBS

Example: **MBGB2-L150-30.UL.US**

### Model No.

**MBGB2-L150-27.UL.US** - Replacement Lamps - 2700K, 24°

**MBGB2-L150-30.UL.US** - Replacement Lamps - 3000K, 24°

Job Name/Date:

Fixture Type Designation:

## PHOTOMETRIC DATA

Note: All photometry is 3000K

Maximum Candela = 892.6

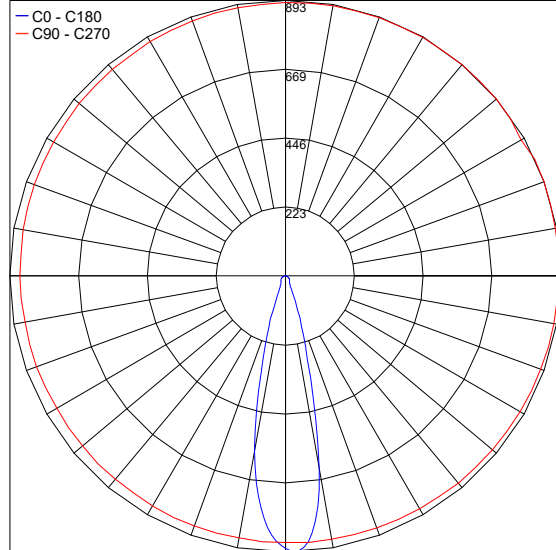

PHOTOMETRIC FILENAME : GENIUS BASIC NAKED - BU1071BL4R24M.IES

Job Name/Date:

Fixture Type Designation: