

GENIUS DIM TO WARM

Genius Dim to Warm is a small and powerful recessed LED downlight with an aperture less than 1" in diameter which allows both light intensity and color temperature, dimmable from 1800K to 3000K, to be controlled. Easy access to LED module via a unique spring loaded mechanism. Can be used in IC, Chicago Plenum, or concrete pour ceilings.

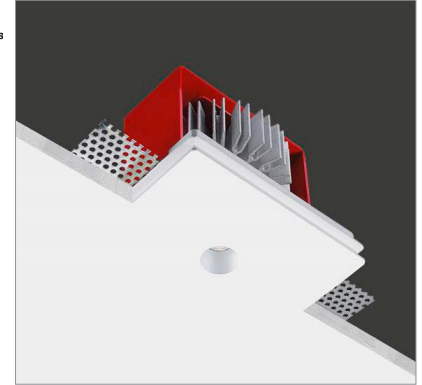

TECHNICAL DATA

Wattage / Input	6W (350mA)
Power Supply	Remote, not included. See page 2.
Construction	Body: AirCoral® Frame: Steel Aluminum Heat Sink
CCT	1800K - 3000K
CRI	CRI>95
LED Lumens	380 lm (3000K)
LED Efficacy	63 lm/W (3000K)
Optics	40° Wide Beam
Finishes	Unfinished
Cut-Out Dimensions	5.31" x 4.33"
Fixture Dimensions	4.92" x 3.94" x 5.31" h
Aperture	Ø0.79"
Fixture Weight	1.76 lbs
LED Source	Single 4 LED Module
IP Rating	IP20

Ceiling Cut-Out: 5.31" x 4.33"
Fixture Dimensions:

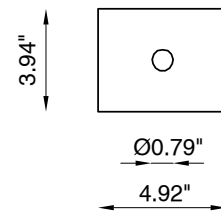
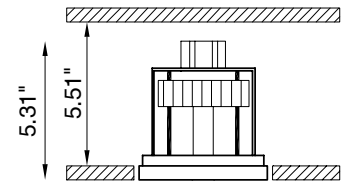

The body is made of AirCoral® a unique patented composite material that actually purifies the air. It can be calculated how many cubic feet each fixture will purify. See website for AirCoral® calculator.

Additionally, AirCoral® is:

- Antibacterial.
- Antifungal.
- Scratch-resistant.
- Dust-resistant.
- Suitable for painting.
- LEED recognized material.

ORDERING INFORMATION

Example: BU1875.AC.7R40M98WD.US. Accessories / Power Supplies ordered separately.

BU1875	AC	7R40M98WD.US
Model No.		
BU1875	AC - AirCoral®	7R40M98WD.US

Job Name/Date:

Fixture Type Designation:

SUGGESTED POWER SUPPLIES

350mA

Part Number	Description	Input/Output	# of Fixtures
PPLT00468	Phase Dim (120V only)	120VAC to 350mA, 14W, Class 2	1-2
PPLT00465-P	0-10V Dimming to 1.0%	120-277VAC to 350mA, 20W, Class 2	1-2
PPLT00263	Leading / Trailing-Edge Dimming to 10% (120V only)	120-277VAC to 350mA, 32W, Class 2	2-2
PPLT00309-P	0-10V Dimming to 0.1%	120-277VAC to 350mA, 50W, Class 2	1-2
PPLT00538-P	0-10V Dimming to 0.1%	120-277VAC to 350mA, 100W, Class 2	1-12

Suggested Lutron Compatible Drivers

Part Number	Option	Lutron SKU	Dim Range	Description	Input/Output	Fixtures
PPLT00247	L3DAE / L3DA3W	L3DA	100%-1%	Hi-Lume™ 1% EcoSystem™ or 1% 3-Wire LED Driver	120-277VAC, 7W	1-1
PPLT00516	L3DAE / L3DA3W	L3DA	100%-1%	Hi-Lume™ 1% EcoSystem™ / 1% 3-Wire LED Driver	120-277VAC, 13W	1-2
PPLT00179	L3DAE / L3DA3W	L3DA	100%-1%	Hi-Lume™ 1% EcoSystem™ or 1% 3-Wire LED Driver	120-277VAC, 19W	2-2

For other power supply options consult factory.

ACCESSORIES - Installation

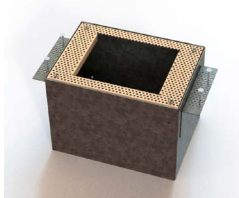

BR1855 - ___
Back Box
Include one of the below options:
LT - IC Rated
LT-C - Chicago Plenum

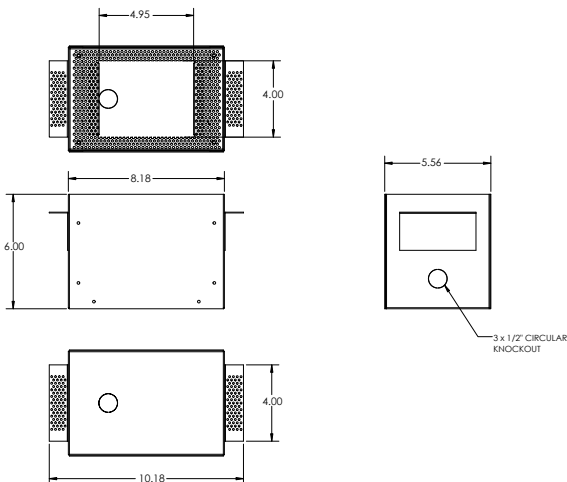

PHOTOMETRIC DATA

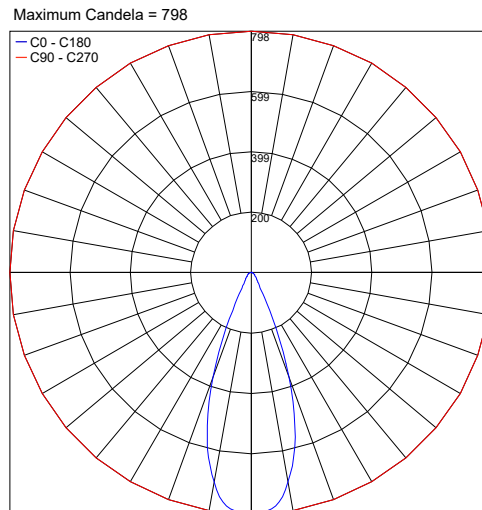

Job Name/Date:

Fixture Type Designation: