



**INSTRUCTIONS PERTAINING TO RISK OF FIRE OR INJURY TO PERSONS. READ ALL INSTRUCTIONS. IMPORTANT SAFETY INSTRUCTIONS. SAVE THESE INSTRUCTIONS.**

**DANGER - RISK OF SHOCK - DISCONNECT POWER BEFORE INSTALLATION! Please read all instructions before installation.**

- Keep these instructions for future reference.
- Must be installed by a qualified electrician in accordance with national and local standards. Designplan is not responsible for fixtures installed without regard to these standards.
- Unauthorized alterations or tampering of product voids warranty.
- The main power connection must be in accordance with local electrical codes.
- Suitable for OUTDOOR applications.



MINI 01



MINI 02



**IP65**

**ATTENTION: For Wall/Ceiling** - It is the contractor's responsibility to caulk around all the edges between the fixture and the mounting surface to satisfy wet label requirements.

## Maintenance

Scheduled maintenance must be carried out once a year on all lighting devices, regardless of appliance class and type of use. It must include the following operations:

- Periodically clean fixtures to remove dirt from gratings and screw heads.
- Check tightness of screws on various parts of the device.
- Check that all cable glands and cables are intact and tight. Check that the glass or plastic lens is intact, and replace it if broken or damaged.
- The internal components such as the ballast, driver, washers and screws must not show clear signs of oxidation or rust. Clear traces of rust and oxidation will indicate the presence of water inside the device.
- In the case of damage, the components must be replaced by original components or spare parts.

COD. 402401

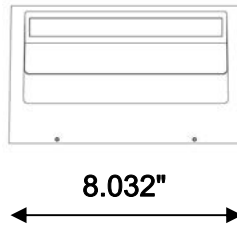

**HYDROHORIZON MINI 01 LED**  
-Power consumption : 7W  
-Voltage :120VAC 50-60Hz  
-Color Temperature : 3000K  
-Lens Type : Mono directional diffused  
-Insulation class: I  
-IP protection: IP65  
-Gross weight: 1.5kg

COD.402402

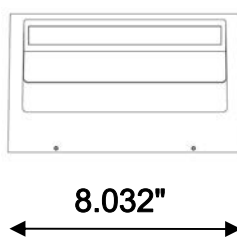

**HYDROHORIZON MINI 02 LED**  
-Power consumption : 14W  
-Voltage :120VAC 50-60Hz  
-Color Temperature : 3000K  
-Lens Type : Bi-directional diffused  
-Insulation class: I  
-IP protection: IP65  
-Gross weight: 1.5kg

- It is the contractor's responsibility to caulk around all the edges between the fixture and the mounting surface, to satisfy wet label requirements.

Use gell filled wire-nuts for wire connections.

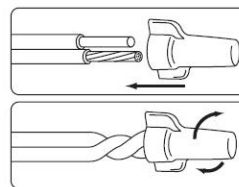

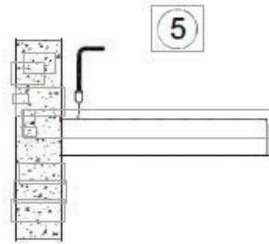
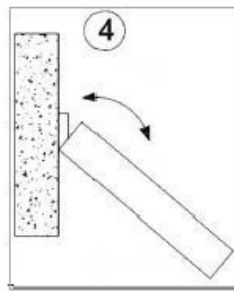
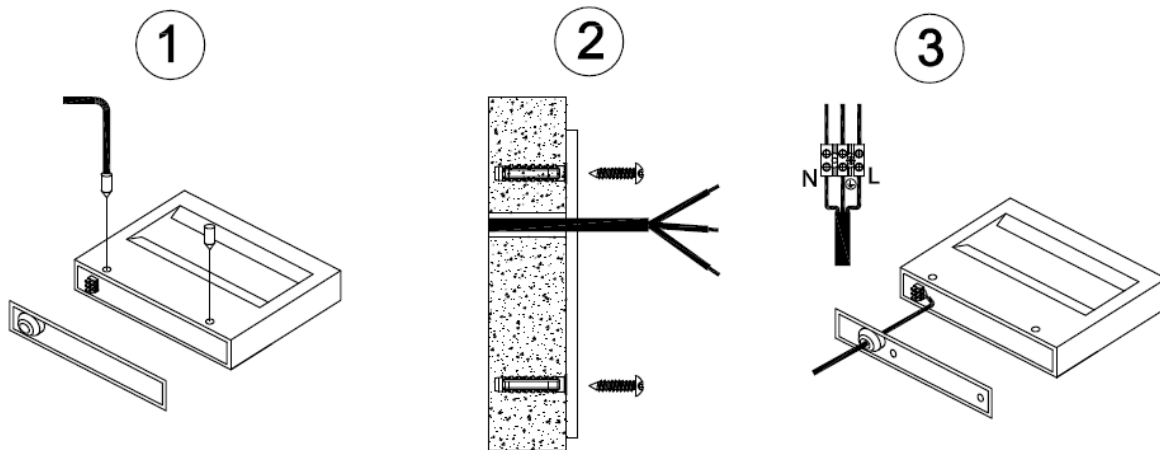

HOLES COD 402401 402402

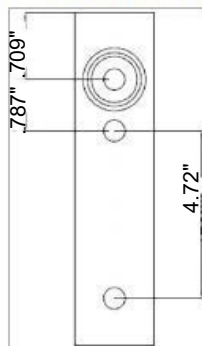

## SWITCH-OFF THE POWER SUPPLY BEFORE CARRYING OUT ANY MAINTENANCE OPERATION

- Remove the fixing bracket by unscrewing the two head screws (using the hexagonal tool included) (pic 1)
- Drill holes and place plugs type "fischer" (not included in the package)
- Fix the bracket to the wall, referring to the dimensions above (pic 2)
- Make the electrical connection to the luminaire (L-N-PE) (pic3)
- Place the luminaire directly to the fixing bracket (pic4)
- Fix the luminaire to the bracket using the hexagonal tool (included in the package) and tighten the fixing screw (pic5)