



**INSTRUCTIONS PERTAINING TO RISK OF FIRE OR INJURY TO PERSONS. READ ALL INSTRUCTIONS. IMPORTANT SAFETY INSTRUCTIONS. SAVE THESE INSTRUCTIONS.**

**DANGER - RISK OF SHOCK - DISCONNECT POWER BEFORE INSTALLATION! Please read all instructions before installation.**

- Keep these instructions for future reference.
- Must be installed by a qualified electrician in accordance with national and local standards. Designplan is not responsible for fixtures installed without regard to these standards.
- Unauthorized alterations or tampering of product voids warranty.
- The main power connection must be in accordance with local electrical codes.
- Suitable for OUTDOOR applications.



Kocca 1.1, 1.2



Kocca 1.3, 1.4



**IP65 IK07**

**ATTENTION:** For Wall/Ceiling - It is the contractor's responsibility to caulk around all the edges between the fixture and the mounting surface to satisfy wet label requirements.

## Maintenance

Scheduled maintenance must be carried out once a year on all lighting devices, regardless of appliance class and type of use. It must include the following operations:

- Periodically clean fixtures to remove dirt from gratings and screw heads.
- Check tightness of screws on various parts of the device.
- Check that all cable glands and cables are intact and tight. Check that the glass or plastic lens is intact, and replace it if broken or damaged.
- The internal components such as the ballast, driver, washers and screws must not show clear signs of oxidation or rust. Clear traces of rust and oxidation will indicate the presence of water inside the device.
- In the case of damage, the components must be replaced by original components or spare parts.

# KOCCA 1.1, 1.2, 1.3, 1.4

4W/8.5W, 7W/15W, 10W, 13W, INTEGRAL 120VAC

designplan®

installation instructions

## FIXTURE DIMENSIONS:

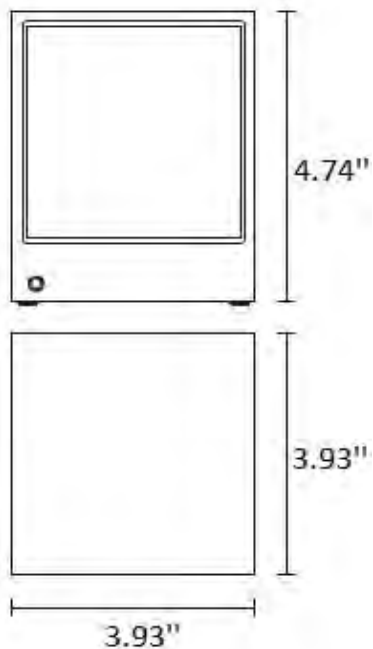

## FIXTURE INSTALLATION

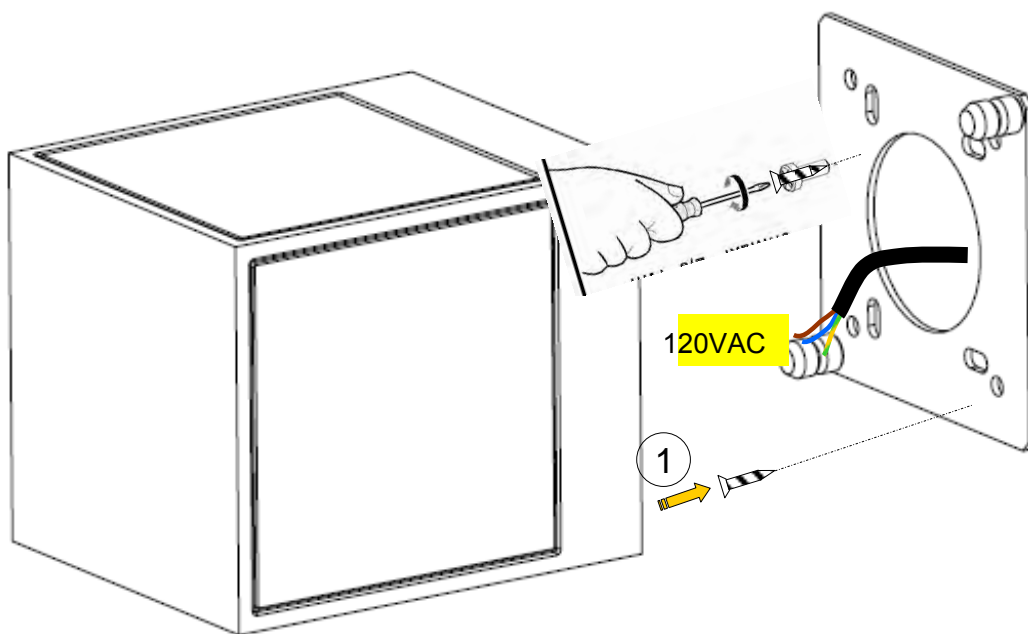
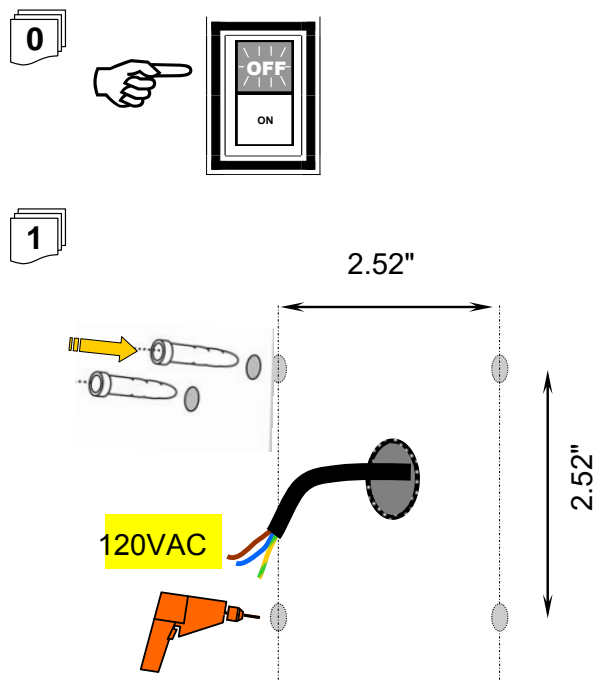

# KOCCA 1.1, 1.2, 1.3, 1.4

4W/8.5W, 7W/15W, 10W, 13W, INTEGRAL 120VAC

designplan®

installation instructions

3

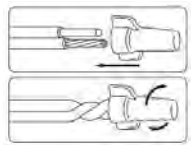
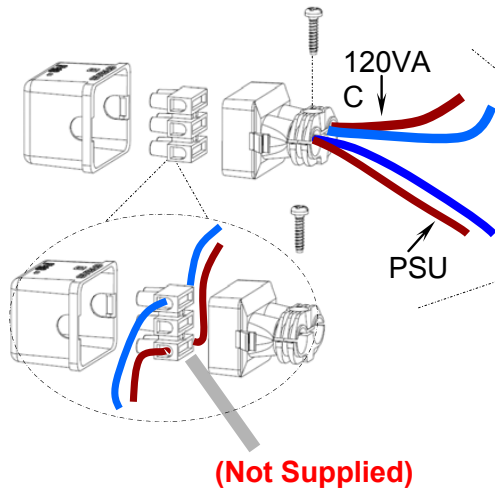

Use gel-filled waterproof wire-nuts for wire connections.

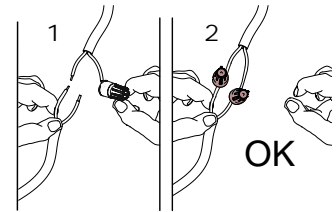

- It is the contractor's responsibility to caulk around the edges between the fixture and the mounting surface, to satisfy wet label requirements.

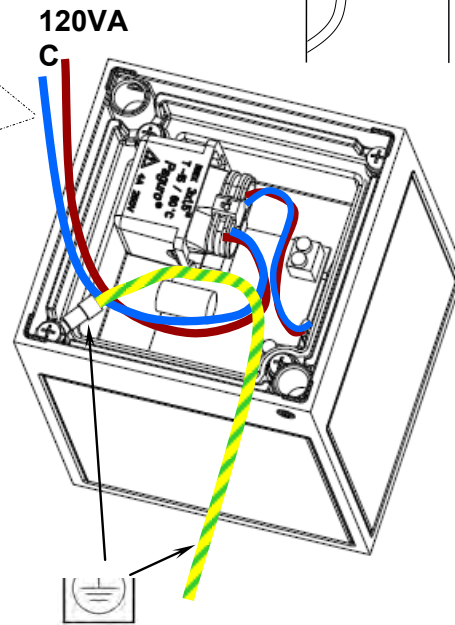

4

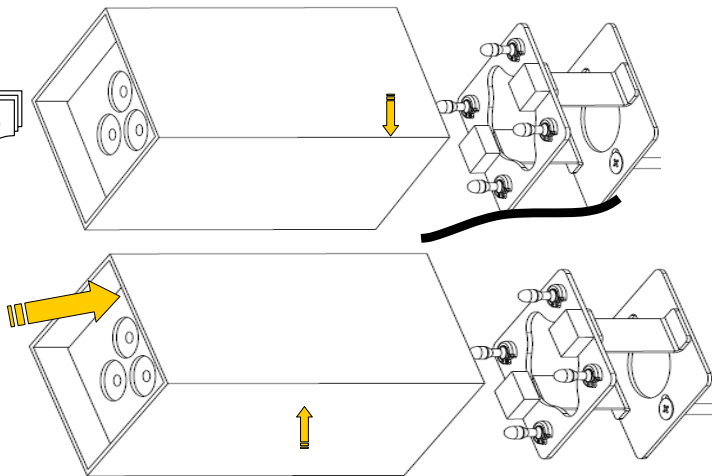

5

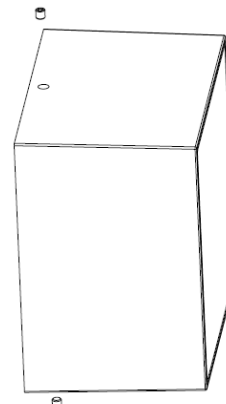
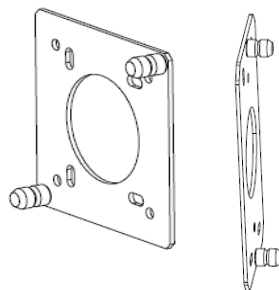
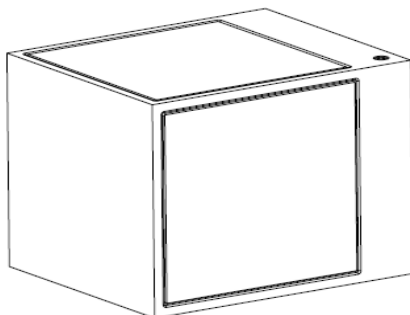
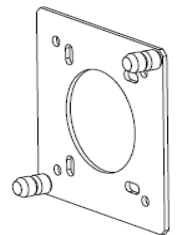
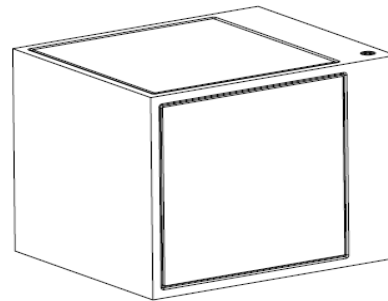

# KOCCA 1.1, 1.2, 1.3, 1.4

4W/8.5W, 7W/15W, 10W, 13W, INTEGRAL 120VAC

designplan®

installation instructions

1. For installation the railing must be modified according to drawing. Ensure center hole is properly positioned along the railing by using the center plate to outline a height that allows the fixture to be mounted without interference.

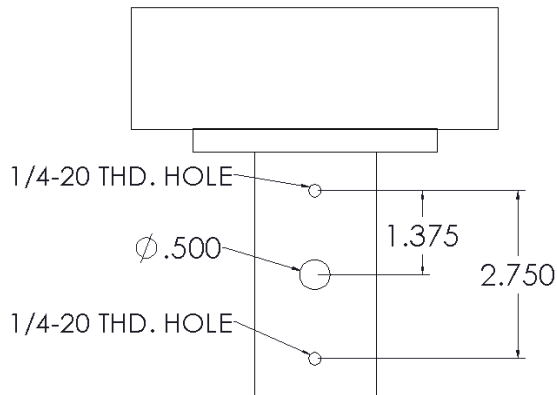

2. Attach the mounting plate to the railing using 2x 1/4-20 screw.

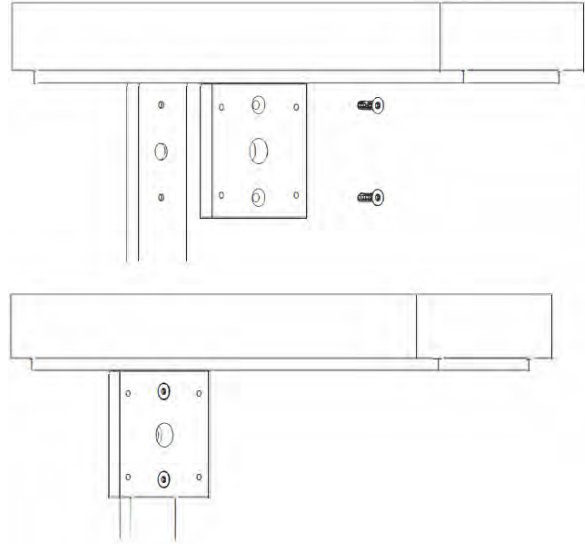

3. Secure support plate to fixture using 2x set screws.

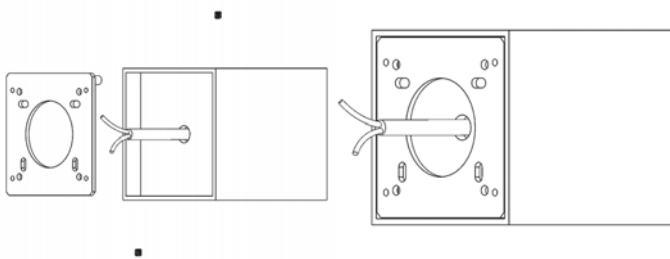

4. Splice fixture and power wires to form connection using silicone filled wire nuts. (provided by others)

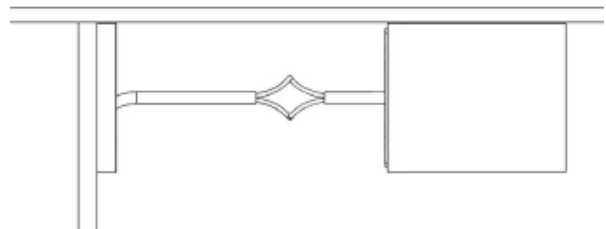

5. Stow away wires and use 4x 1/4-20 screws to secure fixture and support plate to mounting plate.

