

KUBOID 90

KUBOID is an adjustable, hexahedron cube luminaire that comes in 3 sizes and is suitable for outdoor installation on ceilings, walls, floors or in ground using steel stakes. KUBOID 90 is the smallest version at 3.5" cubed and offers 4 light beam options and 4 standard finishes.



TECHNICAL DATA

| | |
|---------------------------|--|
| Wattage | 8W |
| Power Supply | Remote 24VDC, not included. See page 2. |
| Construction | Body: Die-Cast Aluminum Lens: Opal Glass (diffuse version) Silk-screened Printed Glass (optics versions) |
| CCT | 2700K, 3000K |
| BUG Rating | B0-U1-G0 (diffuse) B1-U1-G0 (optics) |
| CRI | >90 |
| Delivered Lumens | 590 lm (30°, 3000K) |
| Efficacy | 73.8 lm/W |
| Optics | Diffuse, Spot, Medium, Flood (see below) Adjustable ±120° - horizontal axis Adjustable 90° on the vertical one |
| Finishes | 5 Standard, See Below |
| Fixture Dimensions | 3.5" x 3.5" |
| Fixture Weight | 2.43 lbs |
| Lumen Maintenance | L80, B15 >60,000hrs (Ta 40°C) |
| Color Consistency | 3-Step MacAdam |
| IP Rating | IP67 |
| Impact Resistance | IK08 |

Fixture Dimensions

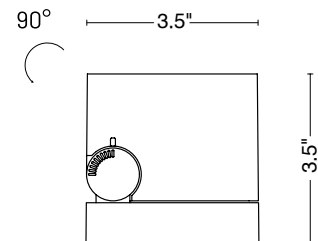

ORDERING INFORMATION

Example: **LNKB50PROMHBBZV.US**. Accessories / Power Supplies ordered separately.

| | | | | | |
|------------------|--|--------------------------------------|------------|--|-----------|
| | | | BBZ | | US |
| Model No. | Optics | CCT | | Finish | |
| LNKB50PRO | S - 14° Spot M - 30° Medium F - 45° Flood | Y - 2700K H - 3000K | BBZ | L - Graphite V - Oxide G - Black U - White H - Gray | US |
| LNKB51PRO | D - Diffuse | | | | |

Job Name/Date:

Fixture Type Designation:

SUGGESTED POWER SUPPLIES

24VDC

| Part Number | Description | Input/Output | # of Fixtures |
|---------------------------|---|---|---------------|
| PPLT00149 | Non-Dim | 120VAC to 24VDC, 10W, Class 2, IP65 | 1-1 |
| PPLT00632 | 0-10V Dimming (Dim to Off) | 120-277VAC to 24VDC, 12W, Class 2 | 1-1 |
| PPLT00155 | Non-Dim | 120VAC to 24VDC, 30W, Class 2 | 1-4 |
| PPLT00586 | Non-Dim | 120-277VAC to 24VDC, 40W, Class 2 | 1-5 |
| PPLT00709 | ELV / TRIAC & 0-10V Dimming | 120-277VAC to 24VDC, 96W, Class 2, DAMP | 1-12 |
| PPLT00543 | 0-10V Dimming to 15% (-40°C / -40°F cold weather start) | 120-277VAC to 24VDC, 100W, Class 2 | 2-13 |

Suggested Lutron Compatible

| Part Number | Option | Lutron SKU | Dim Range | Description | Input/Output | # of Fixtures |
|---------------------------|----------------|------------|-----------|--|-----------------------------------|---------------|
| PPLT00273 | L3DAE / L3DA3W | L3DA | 100%-1% | Hi-Lume™ 1% EcoSystem™ or 1% 3-Wire LED Driver | 120-277VAC to 24VDC, 40W, Class 2 | 1-5 |
| PPLT00530 | L3D0 | L3D0 | 100%-0.1% | Hi-Lume™ Premier 0.1% or Ecosystem 3-Wire LED Driver | 120-277VAC to 24VDC, 96W, Class 2 | 1-12 |

For other power supply options consult factory.

ACCESSORIES - Installation



00AKB50
Steel fixing spike kit

ROTATION



Horizontal



Vertical

Job Name/Date:

Fixture Type Designation:

PHOTOMETRIC DATA

Note: All photometric data is 3000K

Maximum Candela = 8599

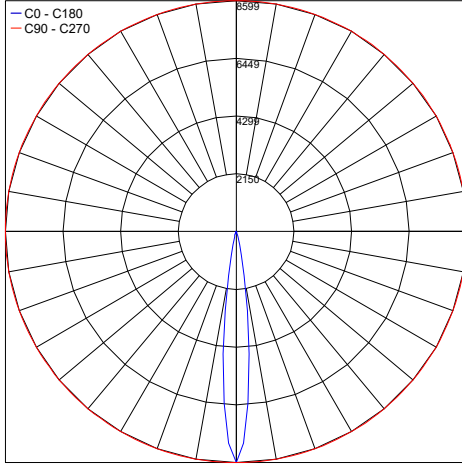

PHOTOMETRIC FILENAME : KUBOID 90 SPOT 30K - KB50PROSXB10X.IES

Maximum Candela = 1631.7

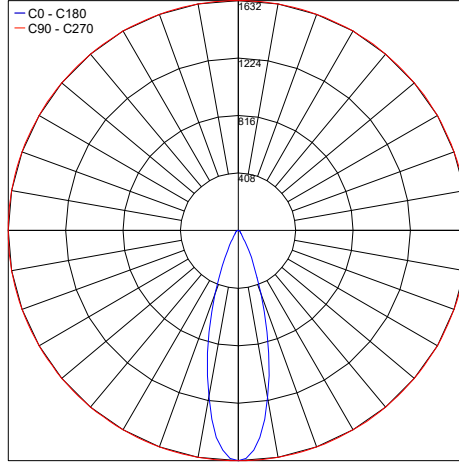

PHOTOMETRIC FILENAME : KUBOID 90 MEDIUM 30K - KB50PROMXB10X.IES

Maximum Candela = 923.5

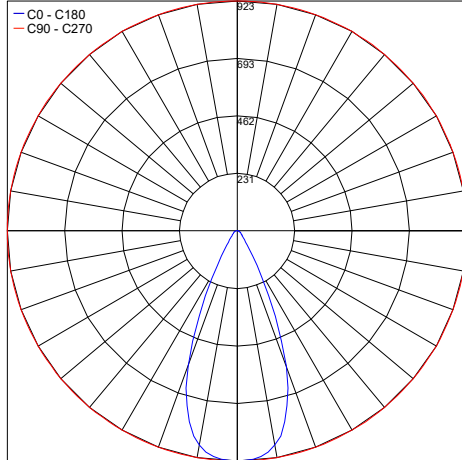

PHOTOMETRIC FILENAME : KUBOID 90 FLOOD 30K - KB50PROFXB10X.IES

Maximum Candela = 108.2

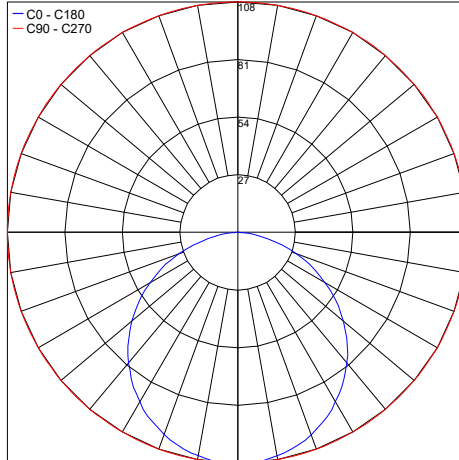

PHOTOMETRIC FILENAME : KUBOID 90 DIFFUSE 30K - KB51PRODXB10X.IES

Job Name/Date:

Fixture Type Designation: