

Klak is an outdoor LED bollard offered in 3 different heights, 1-foot, 2-foot or 3-foot. It is offered in static white, dim to warm or RGB. Dark Sky compliant for output below 80°.

## TECHNICAL DATA

<b>Wattage</b>	6W (Dim to Warm) 12W (Static White) 13W (RGB)
<b>Power Supply</b>	Integral 120VAC (Static White only) Remote, not included - See page 2 (350mA RGB, 350mA Dim to Warm, 350mA Static White)
<b>Dimming</b>	Dimming based on remote power selected. 0-10V Dimming - Integral (Static White Only)
<b>Construction</b>	Body: Aluminum Lens: Clear
<b>CCT</b>	2700K, 3000K, 4000K (static white) 3000K-1800K (dim to warm) RGB
<b>BUG Rating</b>	B0-U1-G0
<b>CRI</b>	>80
<b>Delivered Lumens</b>	172 lm (Static 3000K - 2 foot version) Dark Sky compliant, output below 80°
<b>Efficacy</b>	14.3 lm/W (Static 3000K - 2 foot version)
<b>Optics</b>	180°
<b>Finishes</b>	5 Standard, Custom RAL on request
<b>Fixture Dimensions</b>	2.5" w x 2.2" or 12.0", 24.0" or 36.0" h
<b>IP Rating</b>	IP65



**MADE IN THE U.S.A.**

### Fixture Dimensions

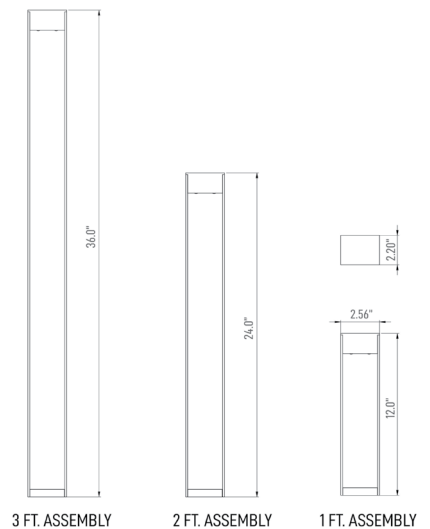

## ORDERING INFORMATION

*Example: KLK-L-1-40-02-C-0. Accessories / Power Supplies ordered separately.*

KLK-L	-		-		-		-	0
-------	---	--	---	--	---	--	---	---

Model #	Height	CCT	Finish	Dimming	Options
KLK-L	1 - 1 ft. 2 - 2 ft. 3 - 3 ft.	27 - 2700K 30 - 3000K 40 - 4000K RG - RGB DW - Dim Warm (3000K-1800K)	11 - White Suede 02 - Black Suede 03 - Gray 18 - Tex. Bronze TS - Silver C - Custom	<b>R</b> - <u>Remote</u> Driver (for Dim to Warm, RGB & Static White 1 ft. version)  <b>L</b> - Lutron Dimming <u>Remote</u> Driver (Static White)  <b>C</b> - Integral 120VAC - 0-10V Dimming For Static White Only (Not Available on 1 ft.)	0 - None

See page 2 for remote power supply options

Job Name/Date:

Fixture Type Designation:

## SUGGESTED POWER SUPPLIES

### Dim to Warm - 350mA Remote Drivers

Part Number	Description	Input/Output	# of Fixtures
<a href="#">PPLT00466-P</a>	0-10V Dimming (to 1.0%)	120-277VAC to 350mA, 10W, Class 2	1-1
<a href="#">PPLT00468</a>	Phase Dim (120V only)	120VAC to 350mA, 12W, Class 2	1-2
<a href="#">PPLT00214</a>	0-10V Dimming (to 10%)	120-277VAC to 350mA, 30W, Class 2	3-4
<a href="#">PPLT00538-P</a>	0-10V Dimming (to 0.1%) (4 channels)	120-277VAC to 350mA, 100W, Class 2	1-3 (1-12)

### Lutron Compatible - Dim to Warm - 350mA Remote Driver

Part Number	Option	Lutron SKU	Dim Range	Description	Input/Output	# of Fixtures
<a href="#">PPLT00247</a>	L3DAE / L3DA3W	L3DA	100%-1%	Hi-Lume™ 1% EcoSystem™ or 1% 3-Wire LED Driver	120-277VAC to 350mA , 7W, Class 2	1-1
<a href="#">PPLT00516</a>	L3DAE / L3DA3W	L3DA	100%-1%	Hi-Lume™ 1% EcoSystem™ or 1% 3-Wire LED Driver	120-277VAC to 350mA, 13W, Class 2	2-2

### RGB - 350mA Remote Drivers

Part Number	Description	Input/Output	# of Fixtures
<a href="#">PPLT00244-P</a>	DMX / RDM (Must advise DMX addresses if not using RDM)	120-277VAC to 350mA, 50W, Class 2	1-4
<a href="#">PPLT00129-P</a>	DMX / RDM (Field Addressable)	120-277VAC to 350mA, 100W, Class 2	1-4

### Static White - 350mA Remote Drivers

Part Number	Description	Input/Output	# of Fixtures
<a href="#">PPLT00139</a>	0-10V Dimming to 10%	120-277VAC to 350mA, 12W, Class 2	1-1
<a href="#">PPLT00468</a>	Phase Dim (120V only)	120-277VAC to 350mA, 14W, Class 2	1-1
<a href="#">PPLT00465-P</a>	0-10V Dimming to 1.0%	120-277VAC to 350mA, 20W, Class 2	1-1
<a href="#">PPLT00263</a>	Leading / Trailing Edge Dimming to 10% (120V only)	120-277VAC to 350mA, 32W, Class 2	1-1
<a href="#">PPLT00168-P</a>	0-10V Dimming to 1.0%	120-277VAC to 350mA, 50W, Class 2	1-2
<a href="#">PPLT00538-P</a>	0-10V Dimming to 0.1%	120-277VAC to 350mA, 100W, Class 2	1-4

### Lutron Compatible - Static White - 350mA Remote Driver

Part Number	Option	Lutron SKU	Dim Range	Description	Input/Output	# of Fixtures
<a href="#">PPLT00516</a>	L3DAE / L3DA3W	L3DA	100%-1%	Hi-Lume™ 1% EcoSystem™ or 1% 3-Wire LED Driver	120-277VAC to 350mA , 13W, Class 2	1-1

For other power supply options consult factory.

Job Name/Date:

Fixture Type Designation:

## ACCESSORIES - Installation

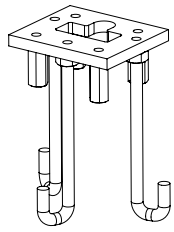

**AM-0008**  
Mounting Base  
Assembly

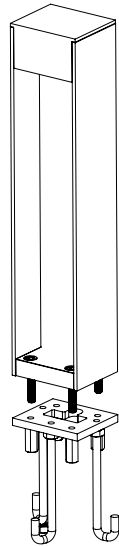

## PHOTOMETRIC DATA

Note: Photometry is 3000K

Maximum Candela = 368.1

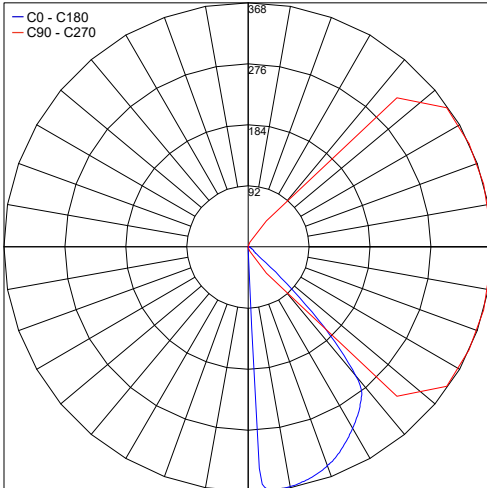

PHOTOMETRIC FILENAME : KLAK - 3000K 2FT INTEGRAL 120VAC.IES

Job Name/Date:

Fixture Type Designation: