

Lentil is a rectangular recessed luminaire with a convex light emission hole. It is made of AirCoral® and is suitable for indoor installation on walls or ceilings where it becomes an integral part of the wall. It is available in 3000K with a 120° optic.



TECHNICAL DATA

Wattage / Input	2W (500mA)
Power Supply	Remote, not included. See page 2.
Construction	Body: AirCoral®
CCT	3000K (2700K on request)
CRI	>90
Delivered Lumens	150 lm (3000K)
Efficacy	75 lm/W
Optics	120°
Finishes	AirCoral® - suitable for painting
LED Source	Professional COB LED
Fixture Dimensions	4.33" w x 7.48" l x 7.48" h
Cut-out Dimension	4.72" x 6.10"
Aperature	1.97" x 3.94"
Fixture Weight	2.20 lbs
IP Rating	IP40

The body is made of AirCoral® a unique patented composite material that actually purifies the air. It can be calculated how many cubic feet each fixture will purify. See website for AirCoral® calculator.

Additionally, AirCoral® is:

- Antibacterial.
- Antifungal.
- Scratch-resistant.
- Dust-resistant.
- Suitable for painting.
- LEED recognized material.

Fixture Dimensions

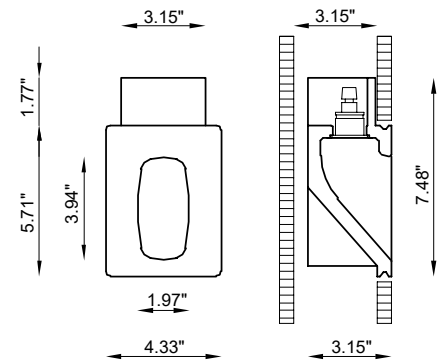

ORDERING INFORMATION

Example: BU6358.AC.US. Power Supplies ordered separately.

BU6358	AC	US
Model No.	Finish	
BU6358	AC - AirCoral®	US

Job Name/Date:

Fixture Type Designation:

SUGGESTED POWER SUPPLIES

500mA

Part Number	Description	Input/Output	# of Fixtures
PPLT00187	0-10V Dimming to 10%	120-277VAC to 500mA, 10W, Class 2	3-5
PPLT00469	Phase Dim (120V only)	120VAC to 500mA, 14W, Class 2	3-7
PPLT00467-P	0-10V Dimming to 1.0%	120-277VAC to 500mA, 50W, Class 2	1-15
PPLT00538-P	0-10V Dimming to 0.1%	120-277VAC to 500mA, 100W, Class 2	1-48

Suggested Lutron Compatible

Part Number	Option	Lutron SKU	Dim Range	Description	Input/Output	# of Fixtures
PPLT00259	L3DAE / L3DA3W	L3DA	100%-1%	Hi-Lume™ 1% EcoSystem™ or 1% 3-Wire LED Driver	120-277VAC to 500mA, 10W, Class 2	3-5
PPLT00195	L3DAE / L3DA3W	L3DA	100%-1%	Hi-Lume™ 1% EcoSystem™ or 1% 3-Wire LED Driver	120-277VAC to 500mA, 19W, Class 2	5-9
PPLT00180	L3DAE / L3DA3W	L3DA	100%-1%	Hi-Lume™ 1% EcoSystem™ or 1% 3-Wire LED Driver	120-277VAC to 500mA, 27W, Class 2	9-13

For other power supply options consult factory.

PHOTOMETRIC DATA

Note all Photometry is 3000K

Maximum Candela = 63

— C0 - C180
— C90 - C270

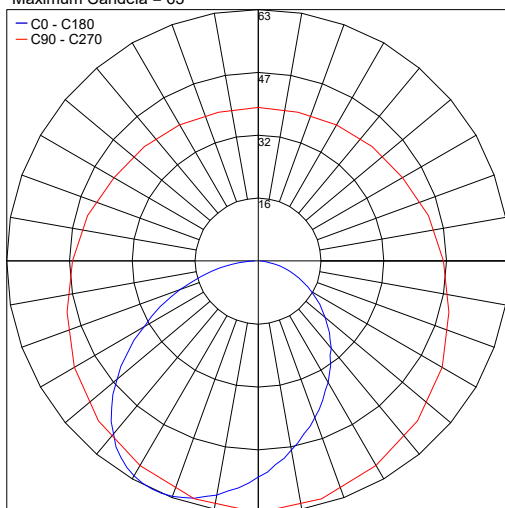

Job Name/Date:

Fixture Type Designation: