

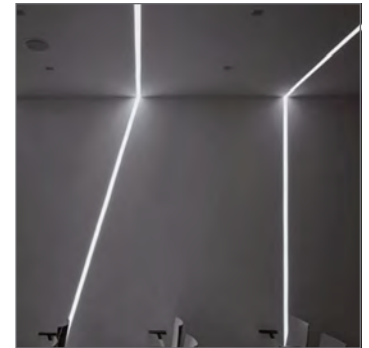

INSTRUCTIONS PERTAINING TO RISK OF FIRE OR INJURY TO PERSONS. READ ALL INSTRUCTIONS. IMPORTANT SAFETY INSTRUCTIONS. SAVE THESE INSTRUCTIONS.

DANGER - RISK OF SHOCK - DISCONNECT POWER BEFORE INSTALLATION! Please read all instructions before installation.

- Keep these instructions for future reference.
- Must be installed by a qualified electrician in accordance with national and local standards. Designplan is not responsible for fixtures installed without regard to these standards.
- The main power connection must be in accordance with local electrical codes.
- Unauthorized alterations or tampering of product voids warranty.
- Suitable for OUTDOOR applications.



IP40

Electrical Connections:

- LED lights must be **connected in parallel** respecting polarities.
- **CHOOSE POWER SUPPLY ACCORDINGLY.** Please consider the voltage through which fixtures are fed as well as the max power consumption.
- **Connect power only if all the fixtures are connected.**
- The power supplies **MUST** be installed in aerated rooms, far from heat sources. Overworking or lack of air circulation will not permit natural dissipation.
- Use only Class 2 type electronic power supply.
- Never use switches on secondary circuit.

ATTENTION: For Wall/Ceiling - It is the contractor's responsibility to caulk around all the edges between the fixture and the mounting surface to satisfy wet label requirements.
Contractor **MUST** use gel-filled wire nuts.

Maintenance

Scheduled maintenance must be carried out once a year on all lighting devices, regardless of appliance class and type of use. It must include the following operations:

- Periodically clean fixtures to remove dirt from gratings and screw heads.
- Check tightness of screws on various parts of the device.
- Check that all cable glands and cables are intact and tight. Check that the glass or plastic lens is intact, and replace it if broken or damaged.
- The internal components such as the ballast, driver, washers and screws must not show clear signs of oxidation or rust. Clear traces of rust and oxidation will indicate the presence of water inside the device.
- In the case of damage, the components must be replaced by original components or spare parts.

Fixture Dimensions

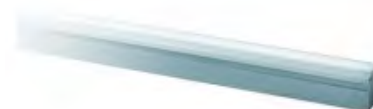
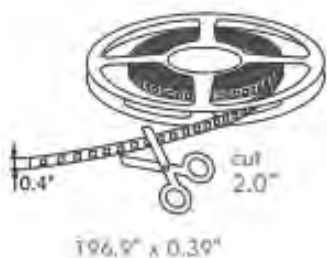

Fixture Installation

ACCESSORIES - Installation



SOLD INDIVIDUALLY
Order 2 per fixture

LM30.104670

Metal single closing
end cap



LM30.104671

90° flat single metal joint



LM30.104672

Pair of 90° horizontal-vertical
metal joint



LM20.101433

Lighting source
extraction tool



LM30.104673

Pair of linear metal joint.



LM30.104676

Pair of "L" metal plates
suitable for 0.5" to 0.8"
plasterboard or masonry
application.



LM30.104677

Single "Omega" metal plate
suitable for 0.5" plasterboard
and masonry application.



LM30.104678

Micro-perforated metal
U-plate for profile hang-
ing.

Installation



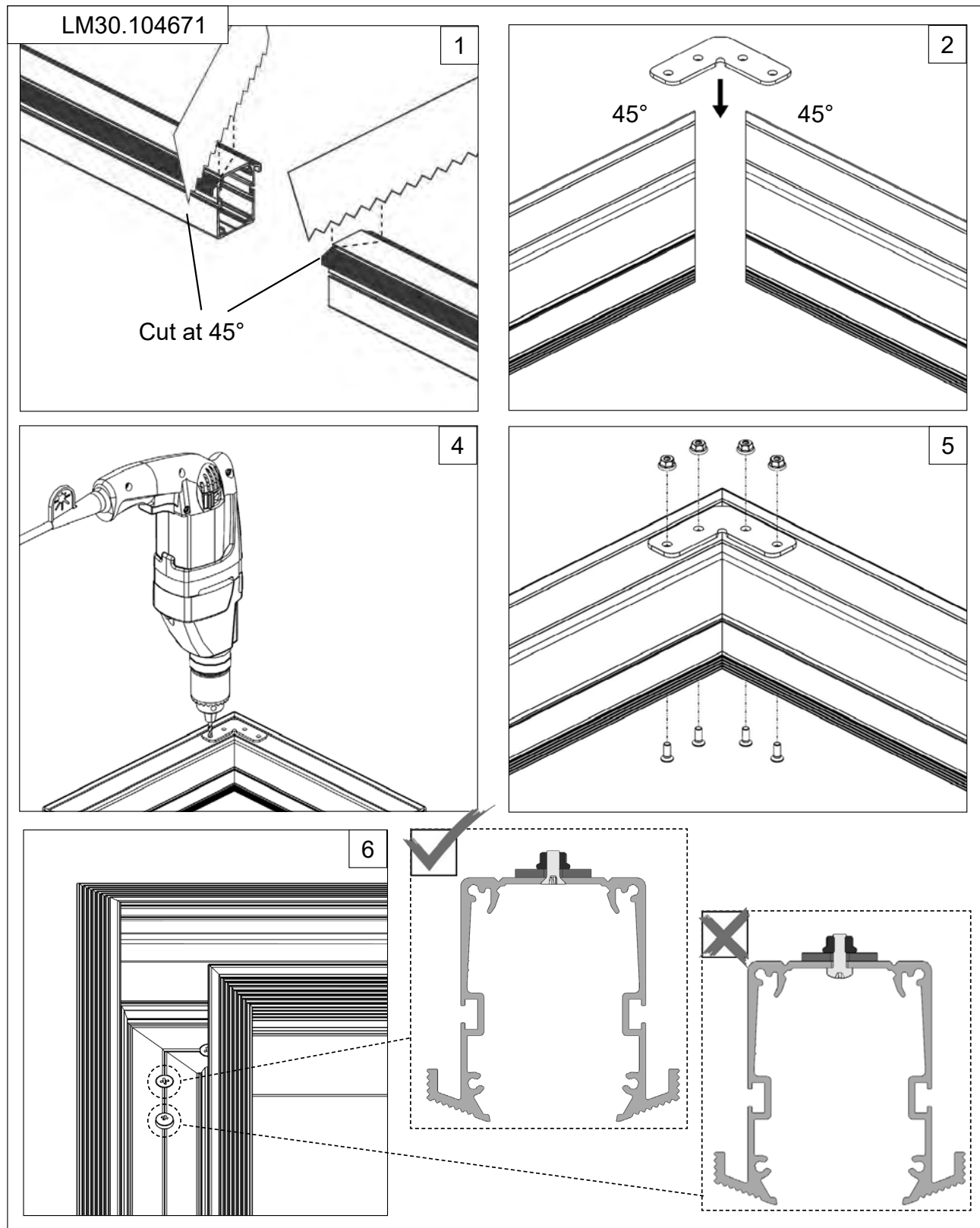

LM30.104672

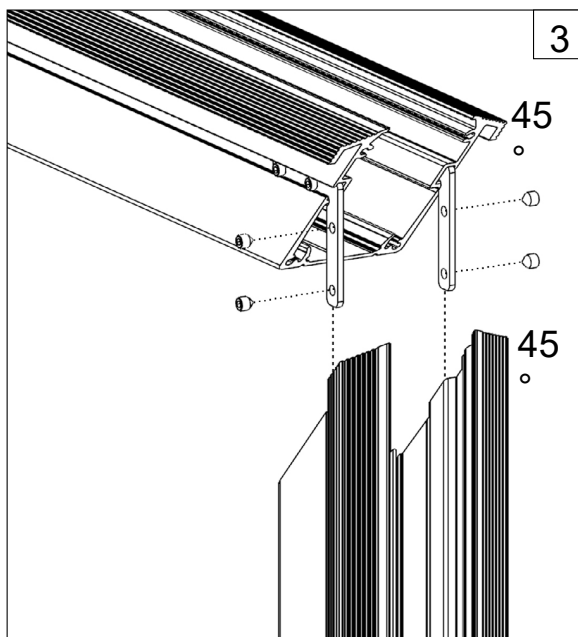
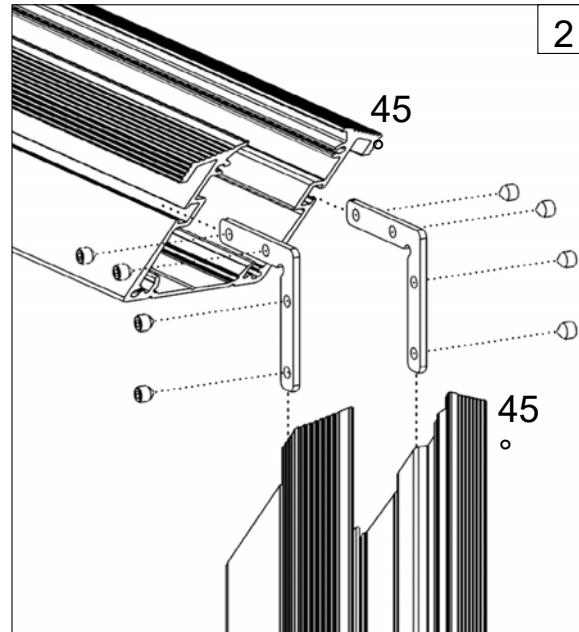
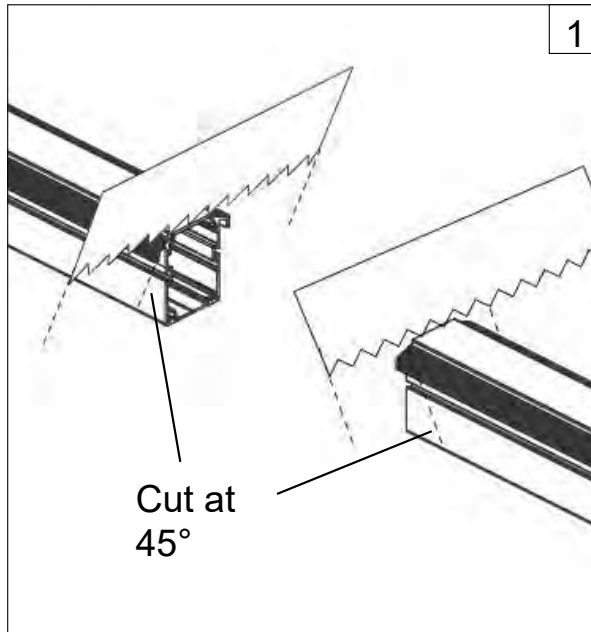

LM30.104673

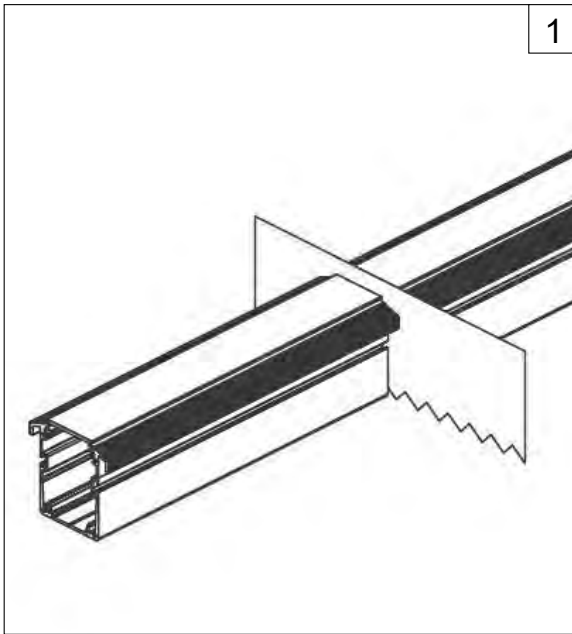

1

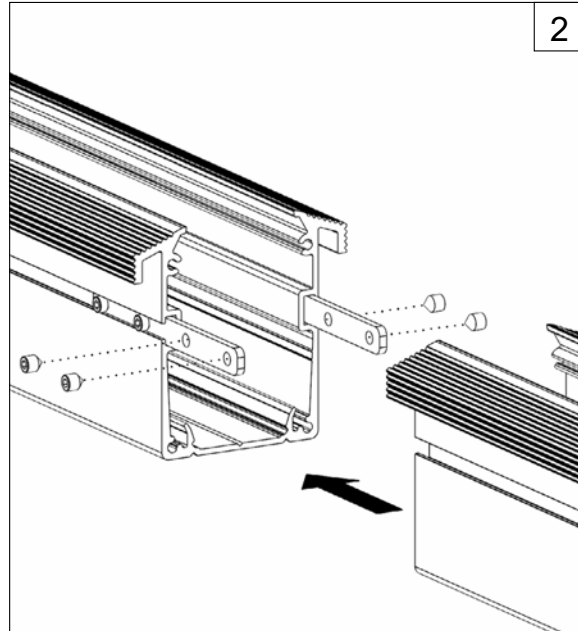

2

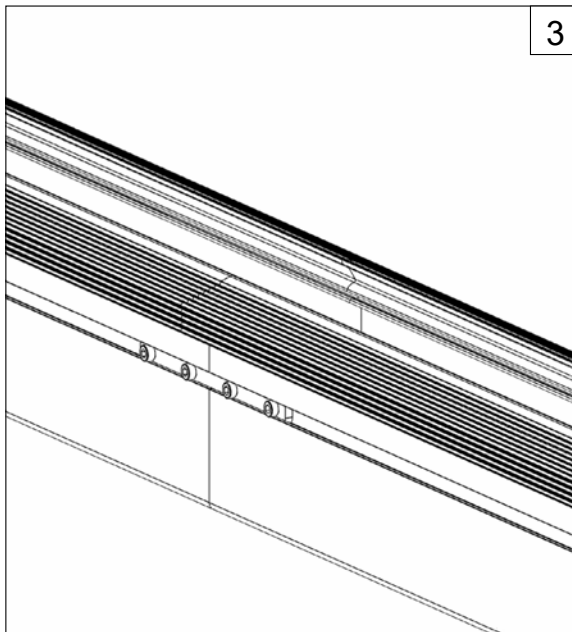

3

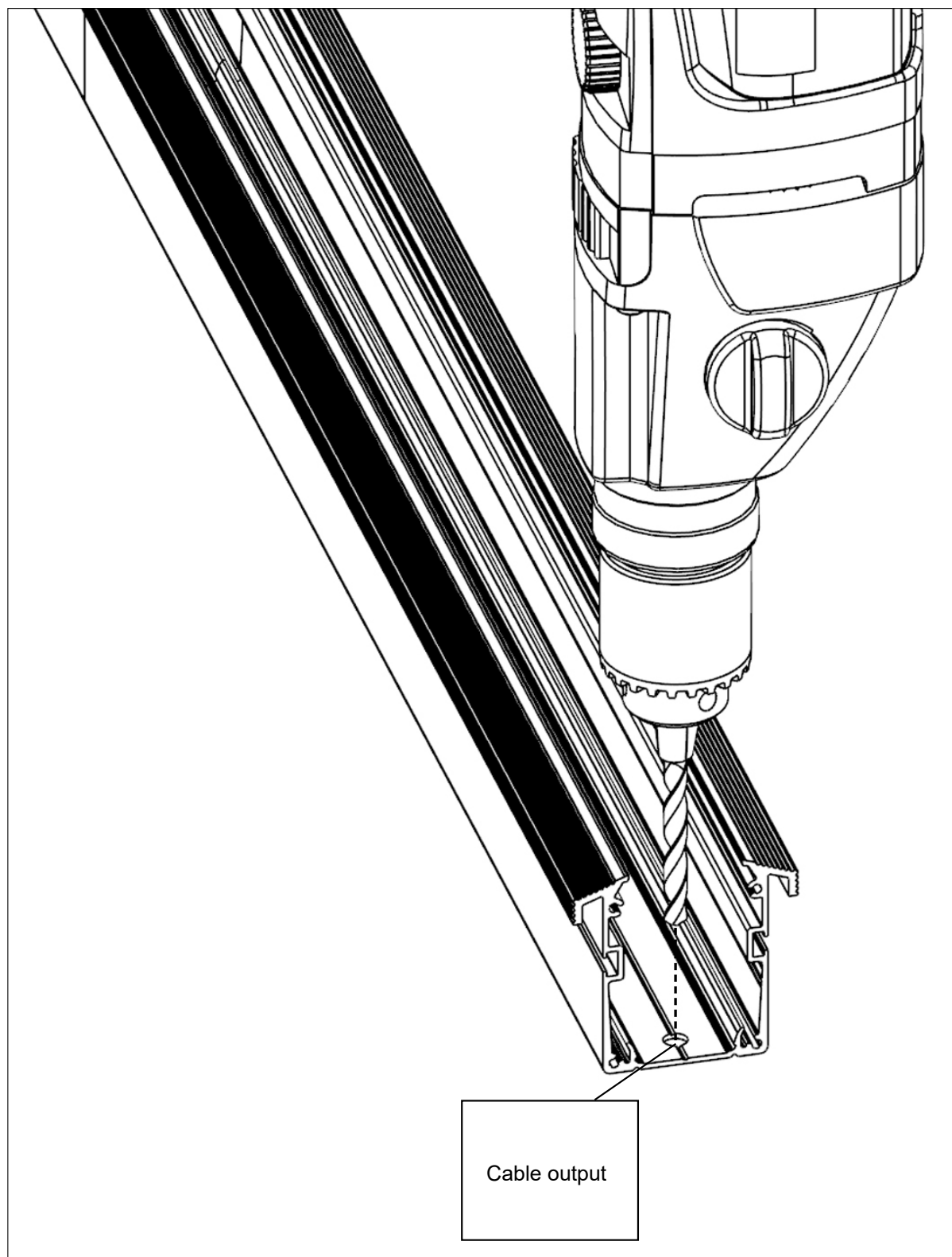

A) - INSTALLATION AS A SUPPORTING SYSTEM FOR FALSE CEILING.

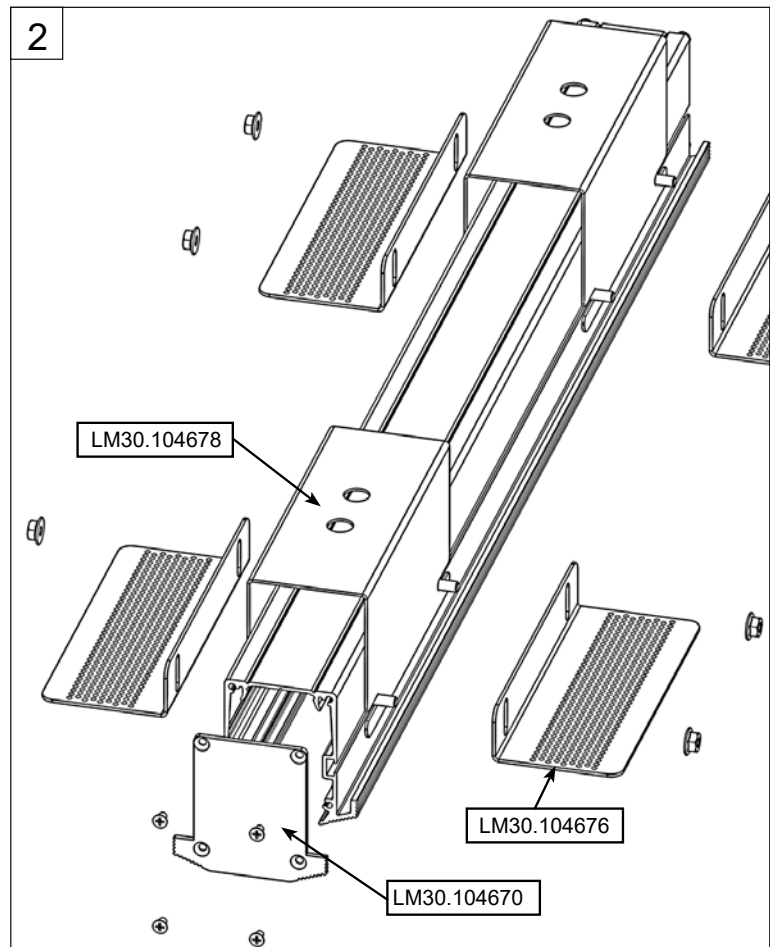
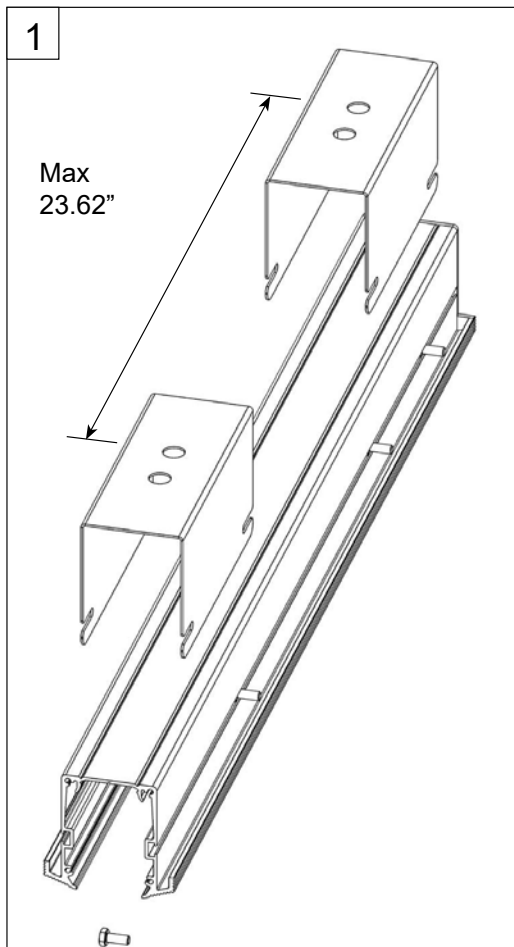

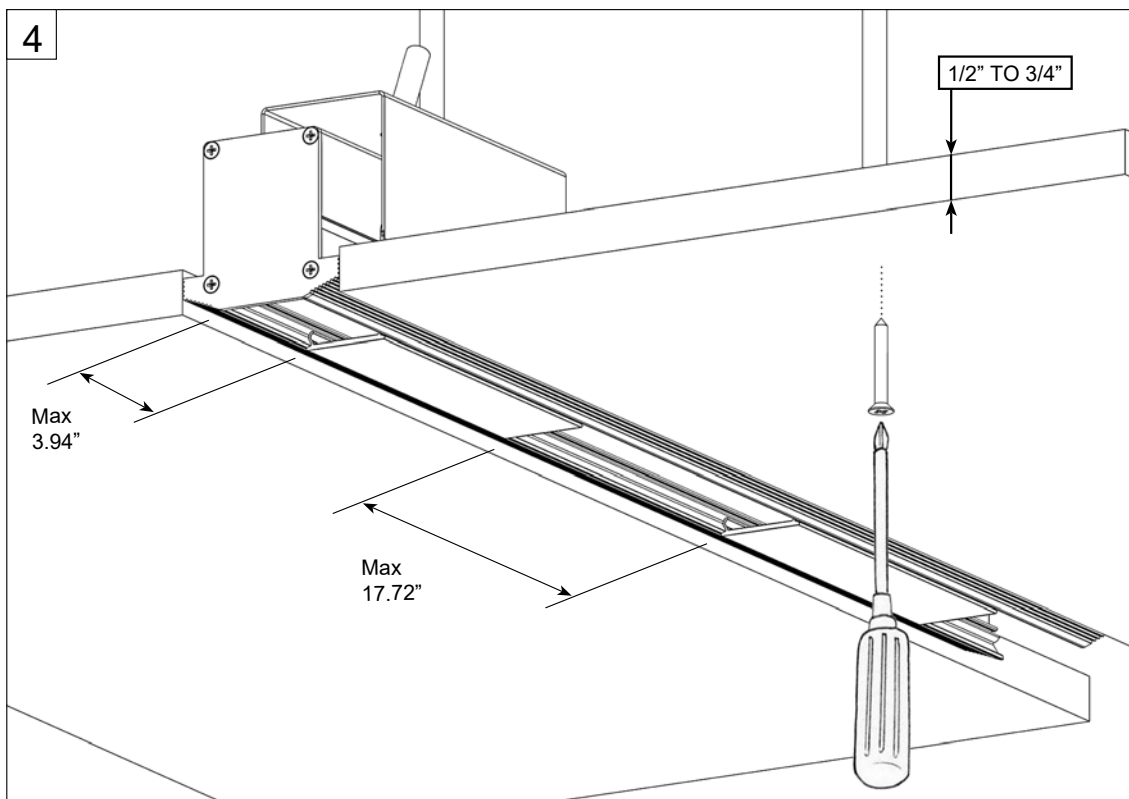
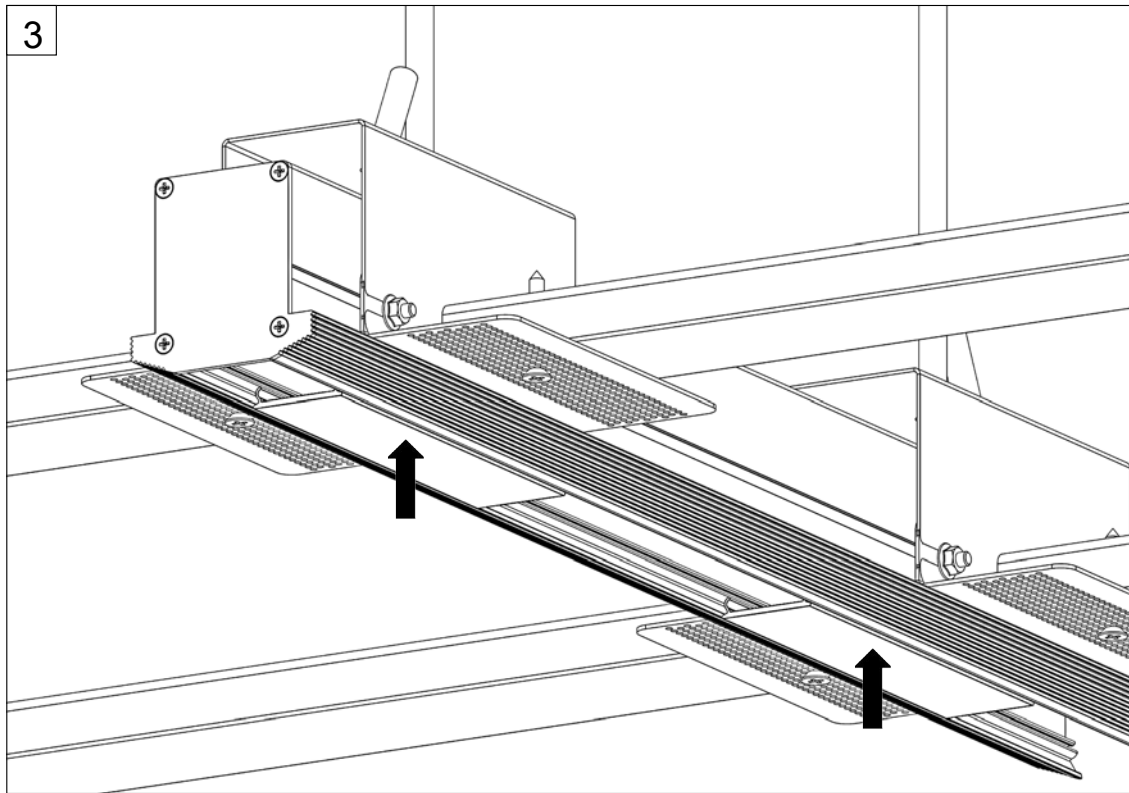

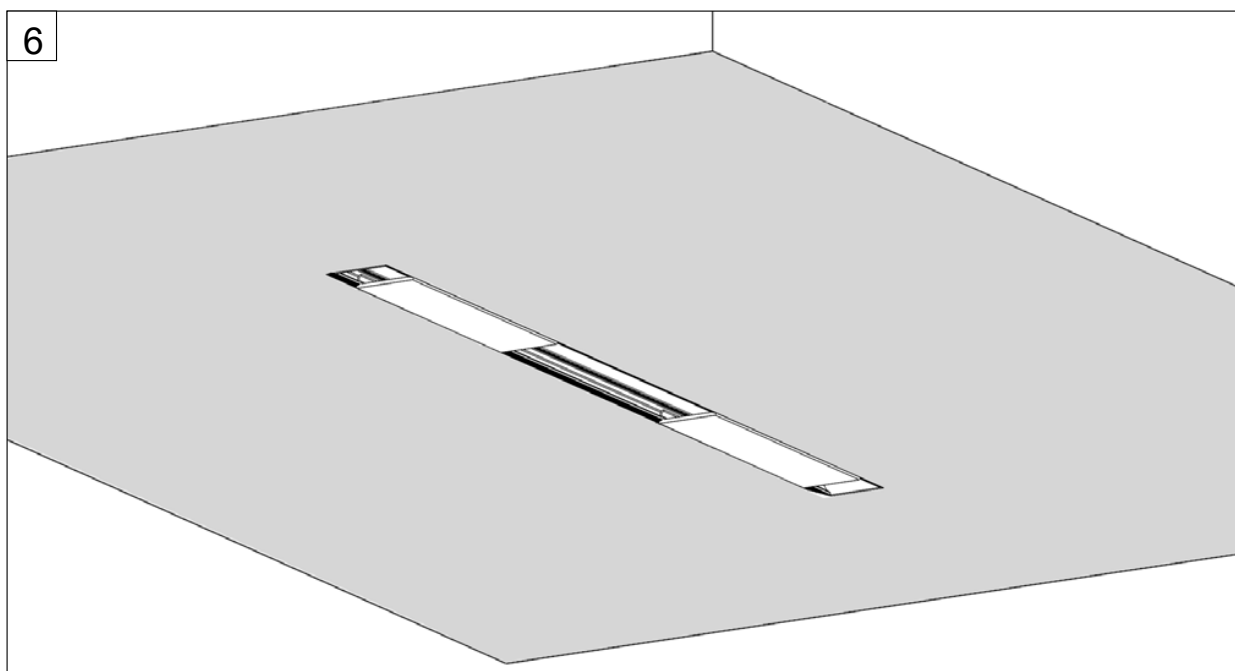
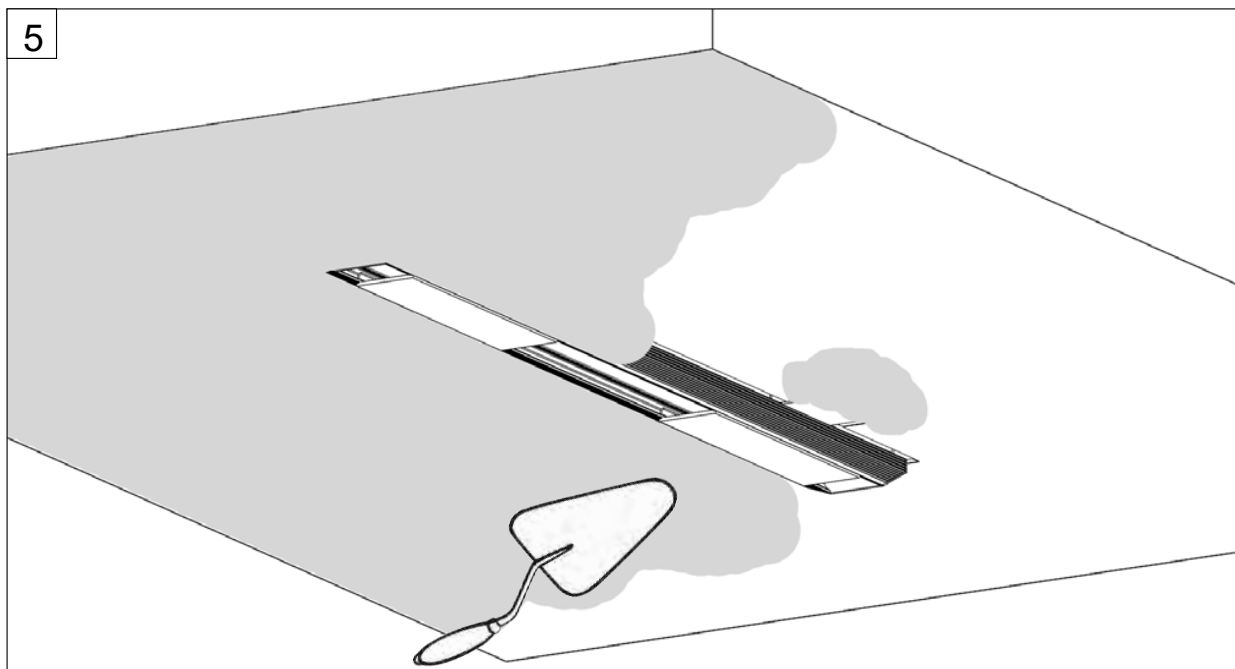

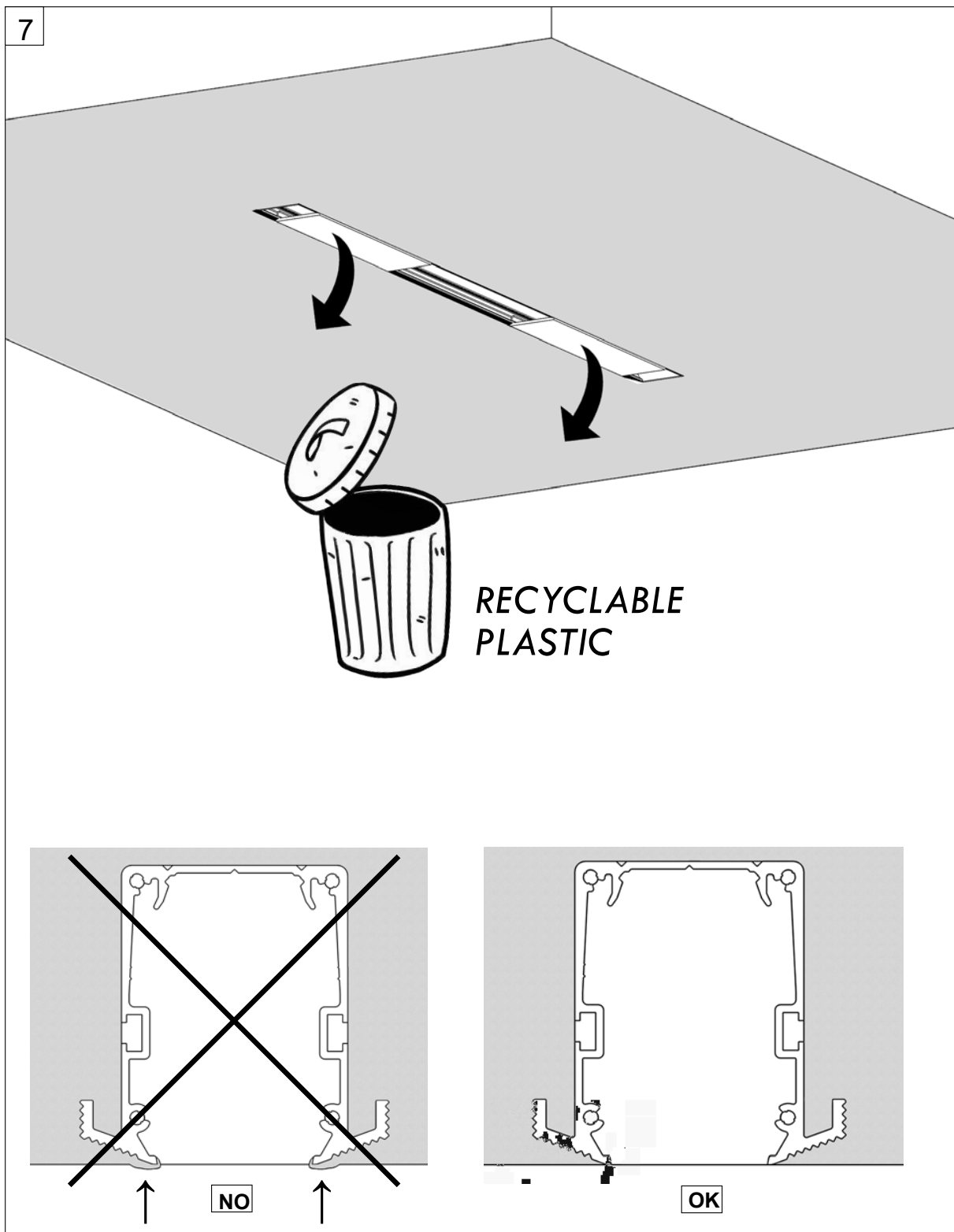

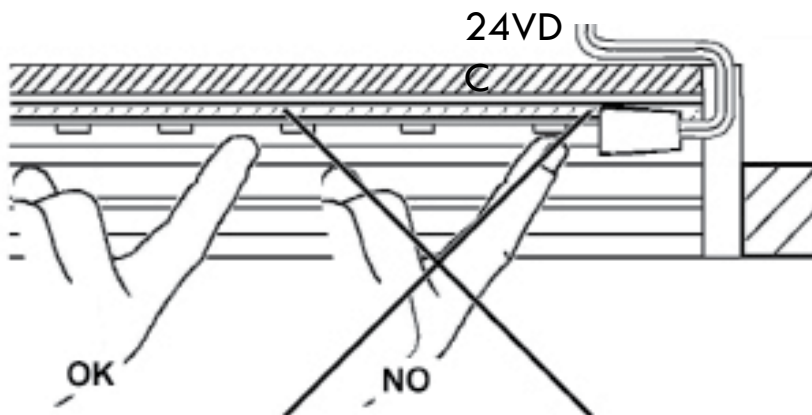
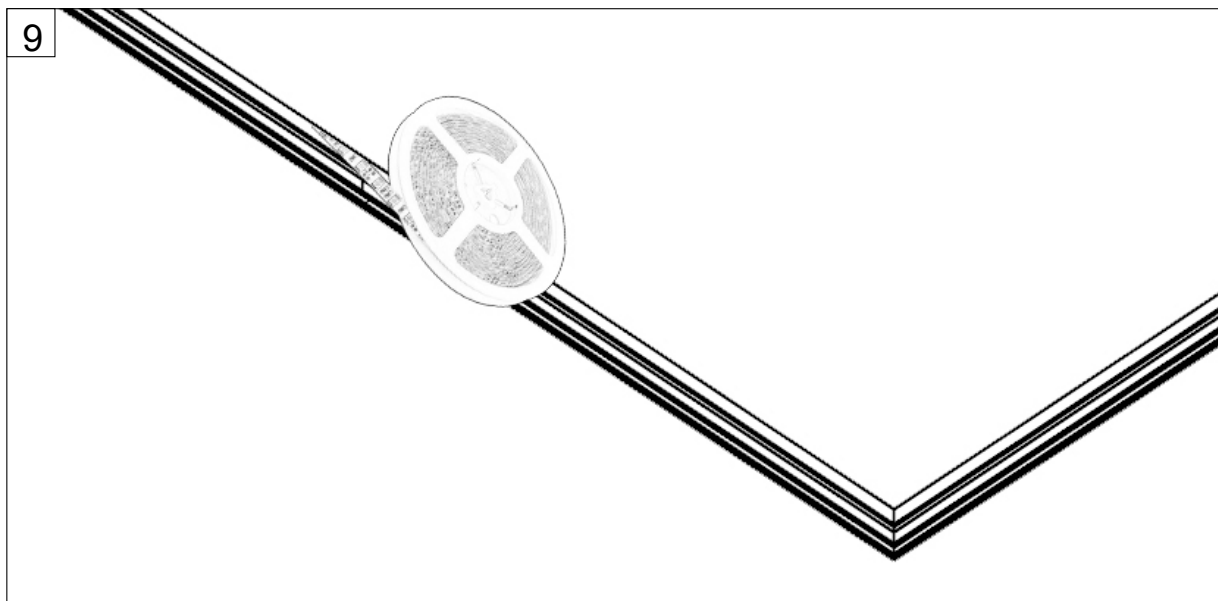
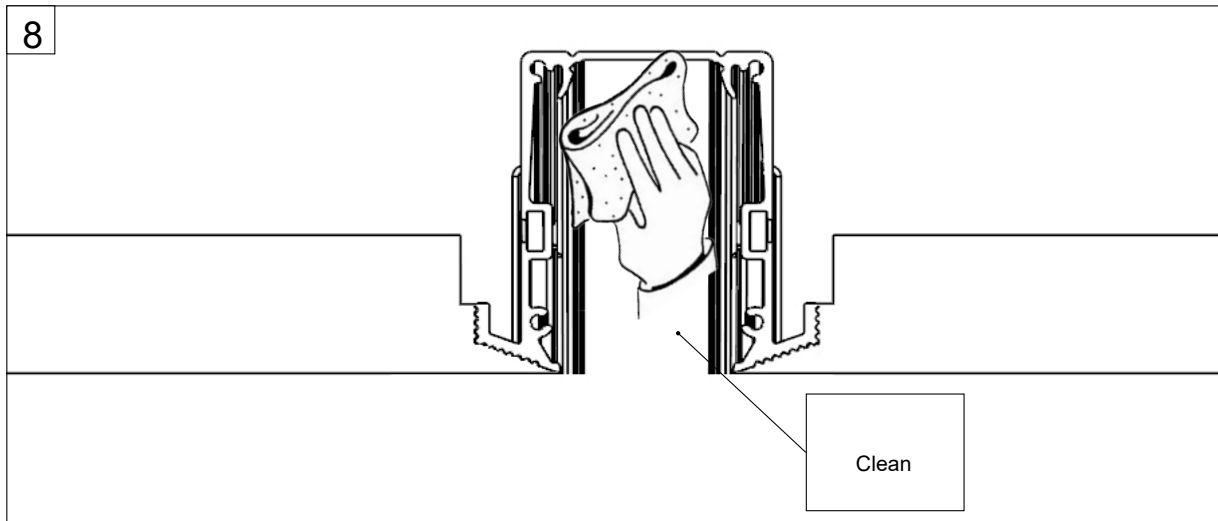

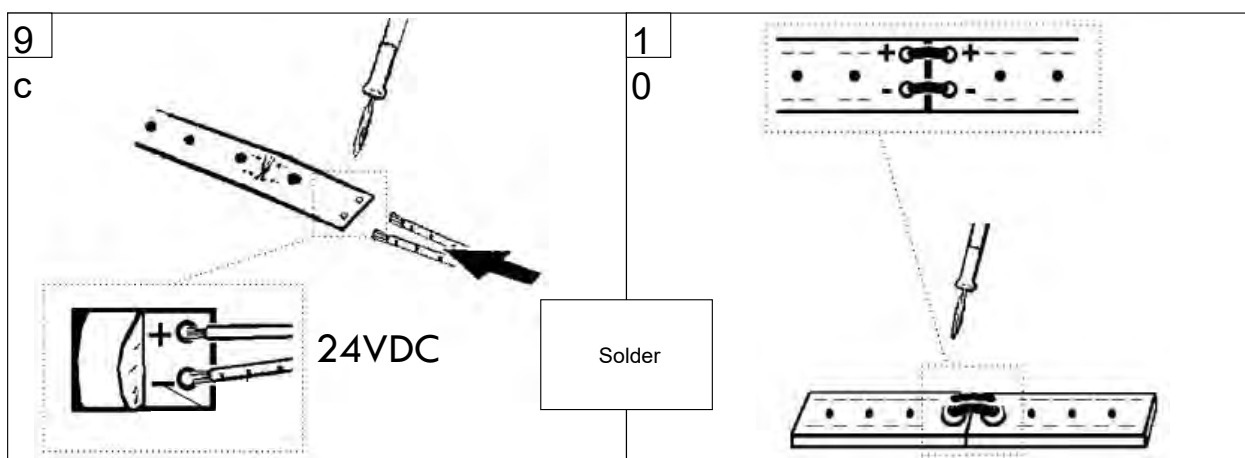
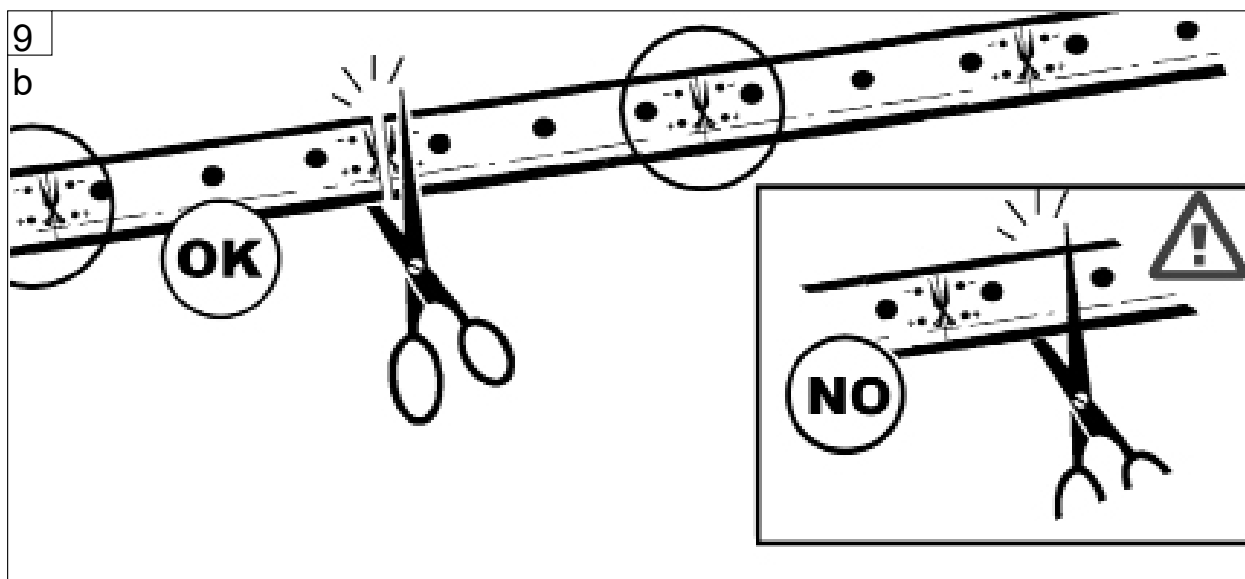
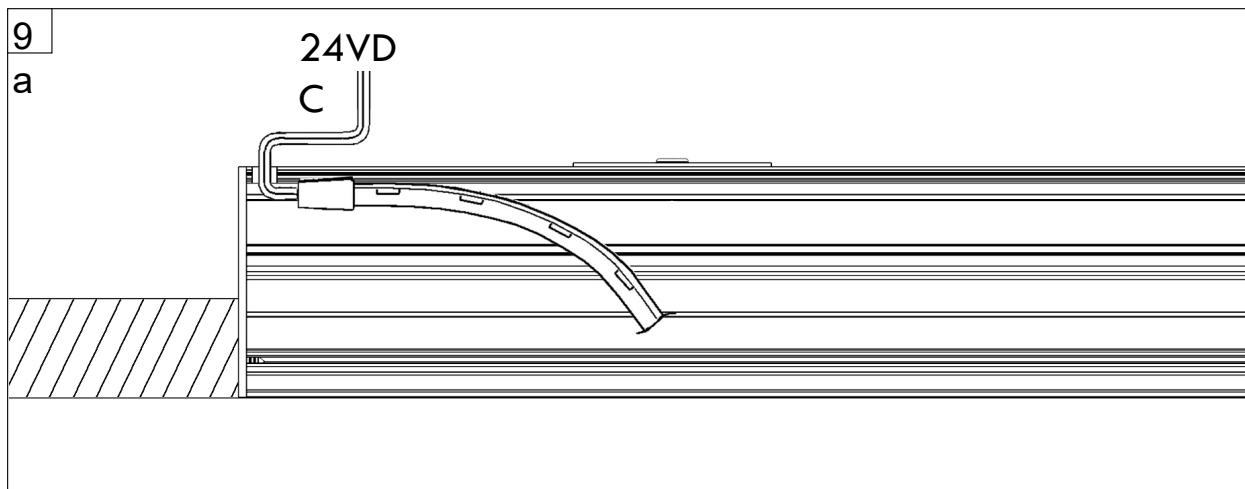

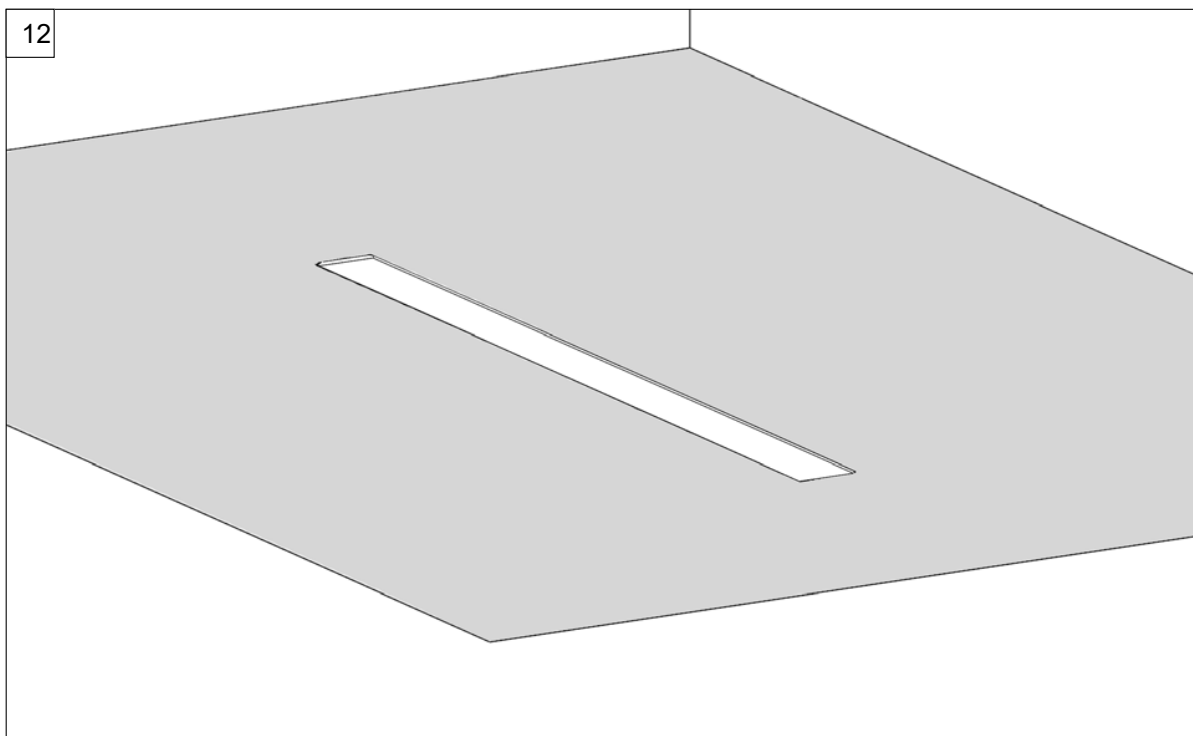
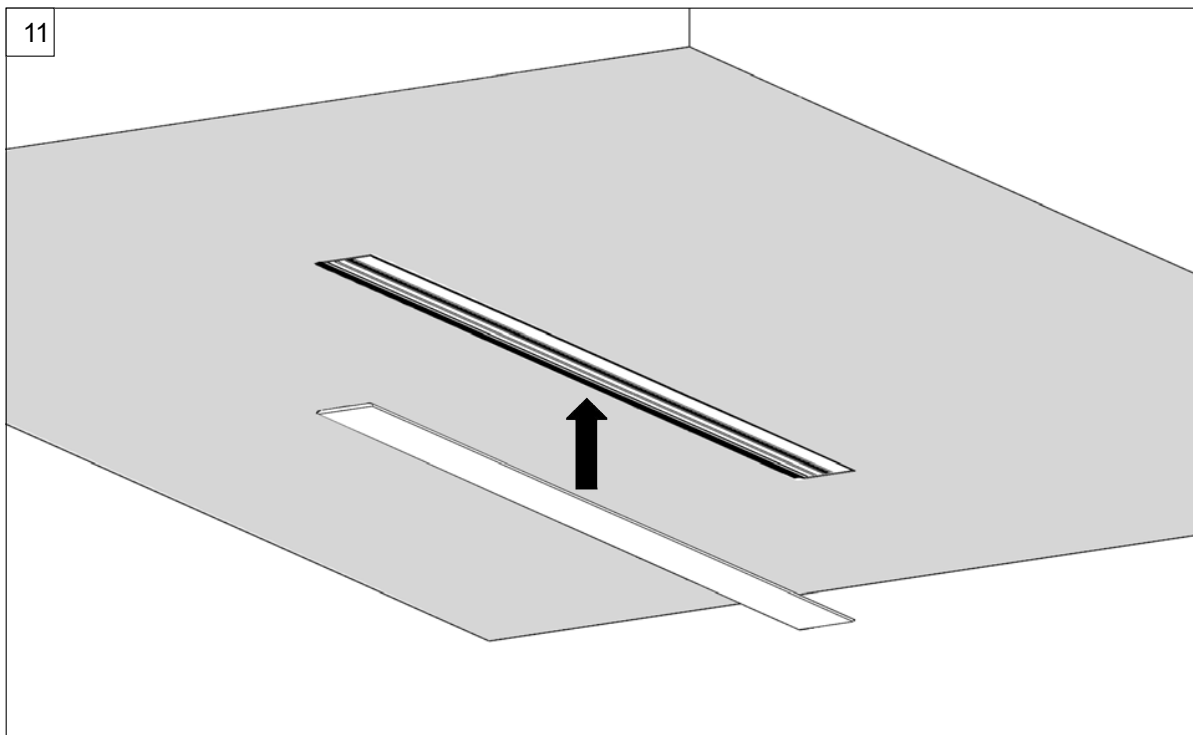

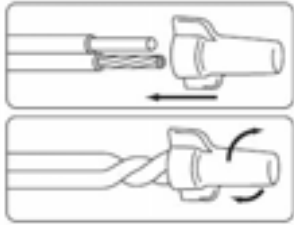

- Use gel-filled waterproof wire-nuts for wire connections.

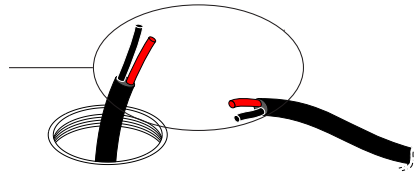

- It is the contractor's responsibility to caulk around the edges between the fixture and the mounting surface, to satisfy wet label requirements.
- It is the contractor's responsibility to install Remote Driver in a suitable electrical enclosure.



B) - INSTALLATION ON ALREADY BUILT FALSE
CEILINGS AND WALLS WITH A DEPTH FROM 2.36"
TO 3.37"

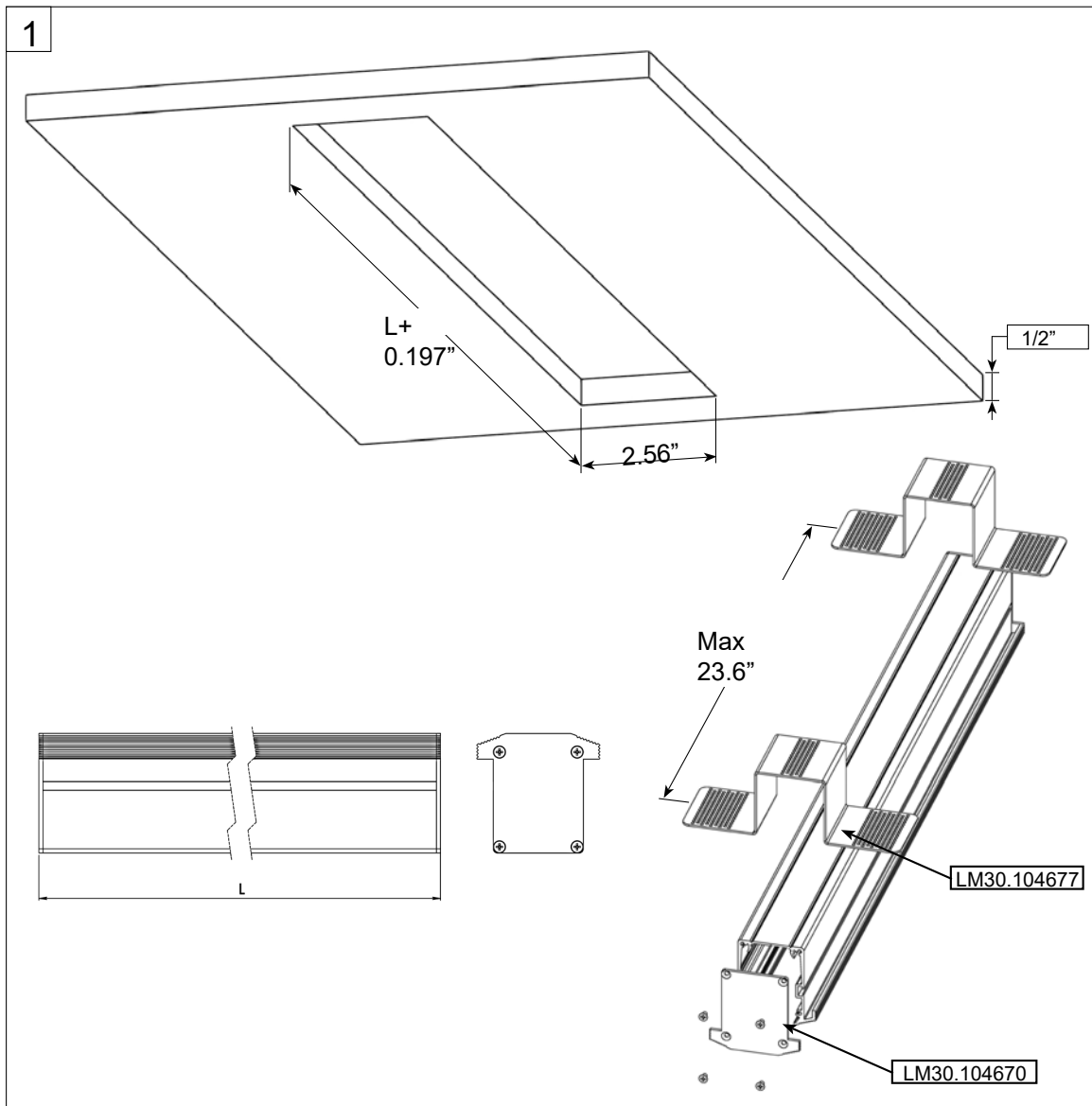

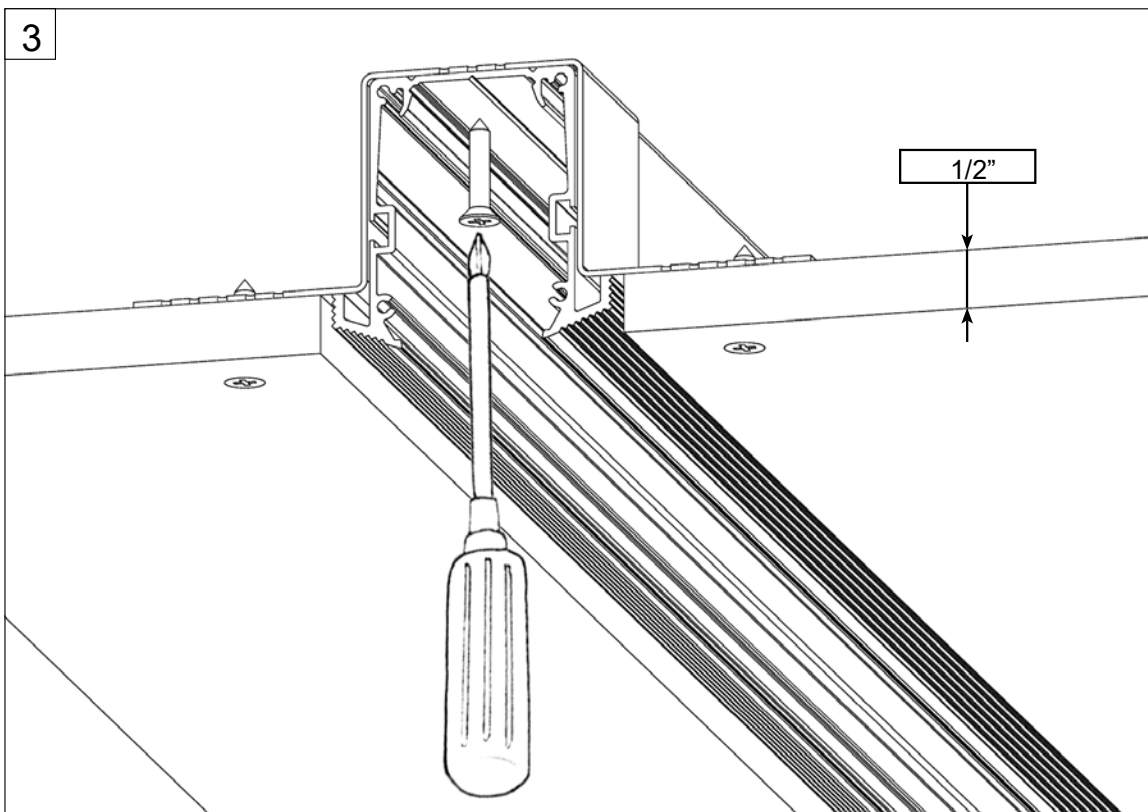
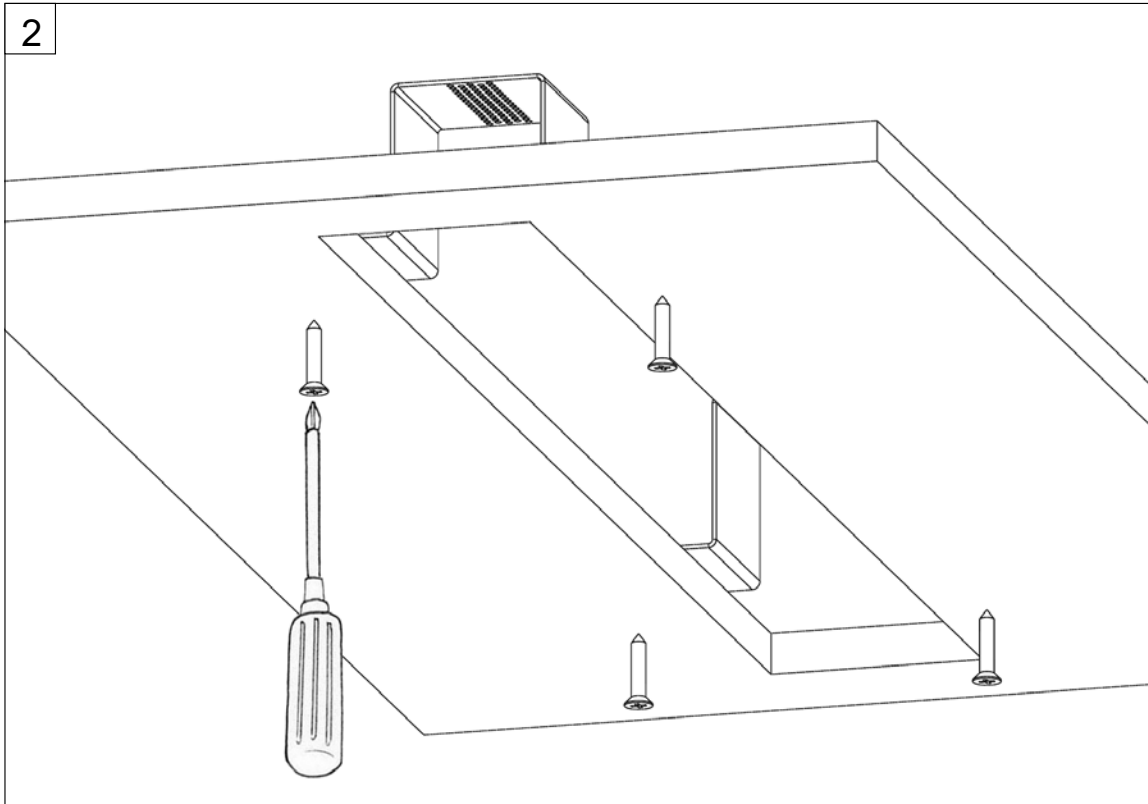

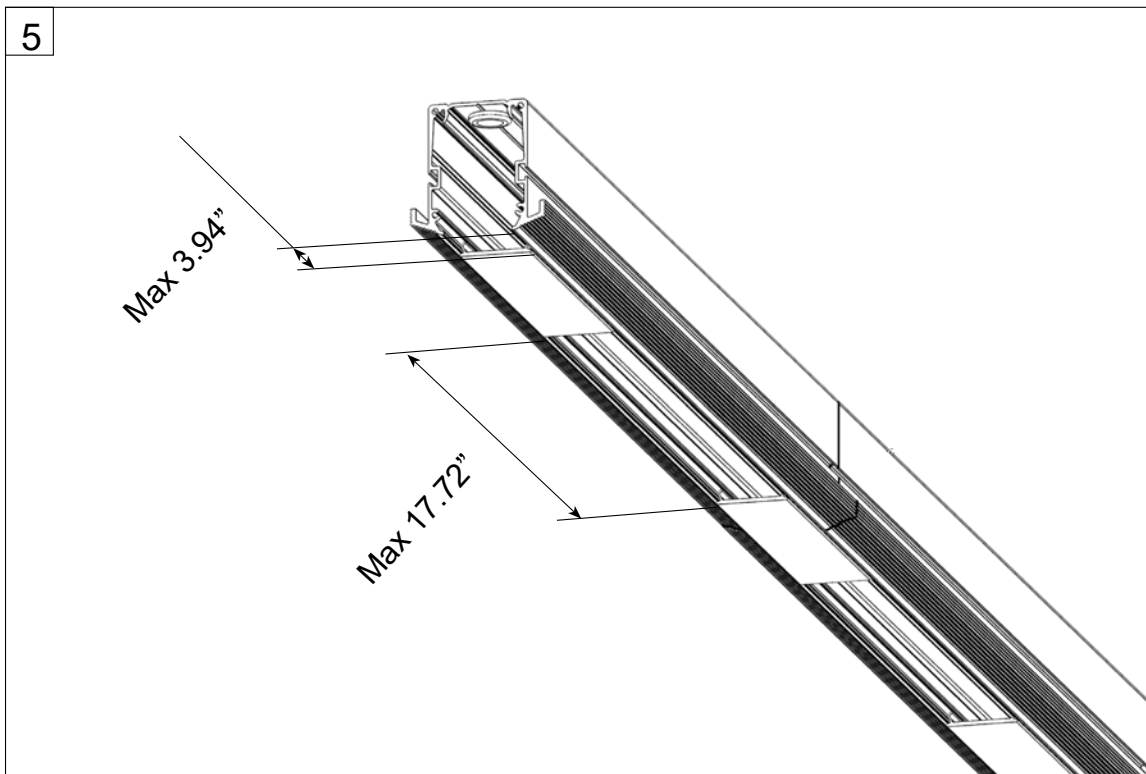
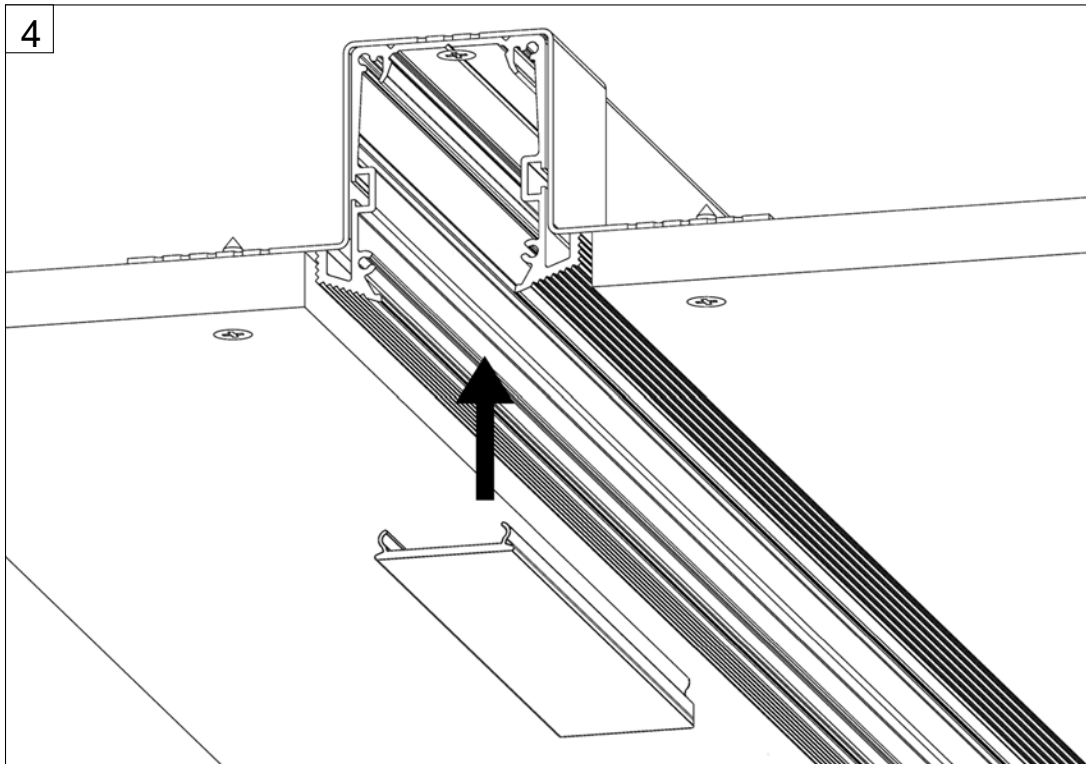

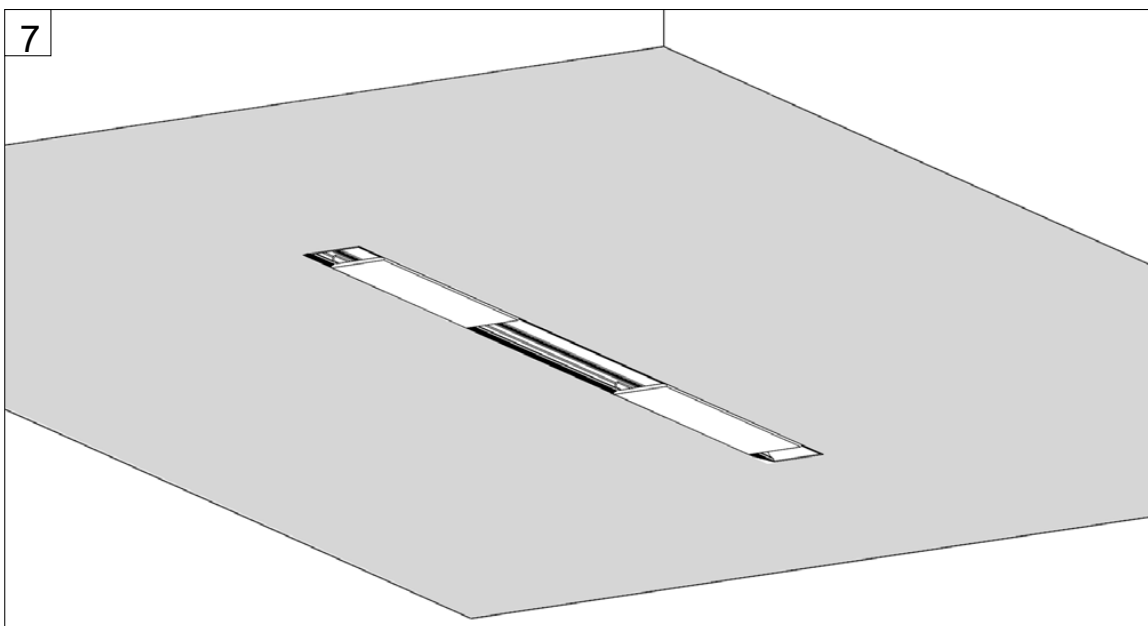
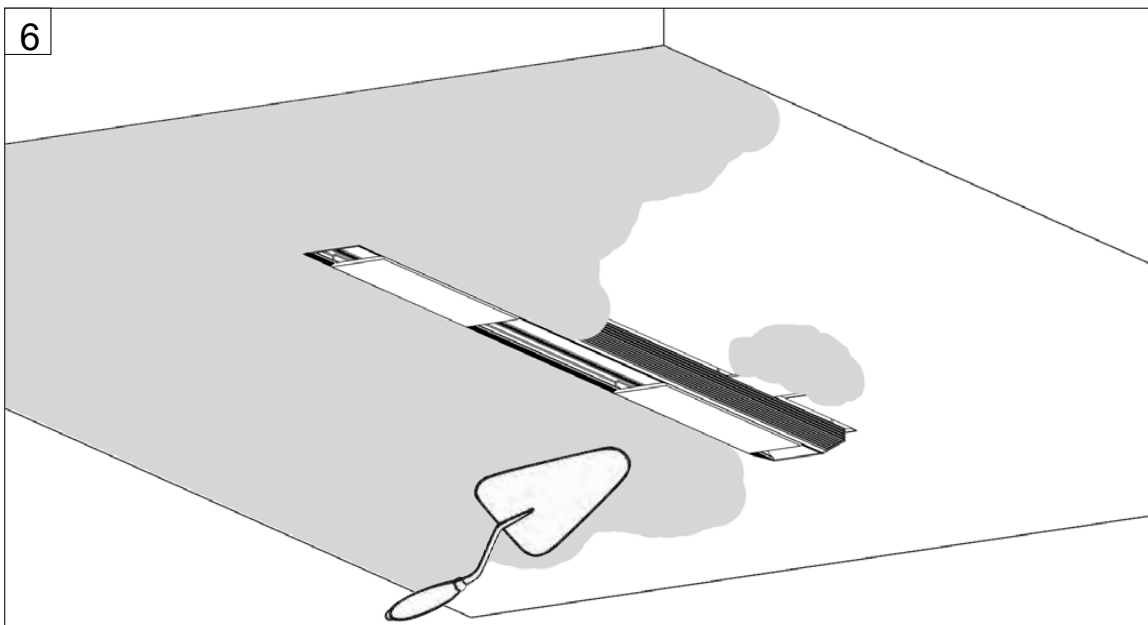

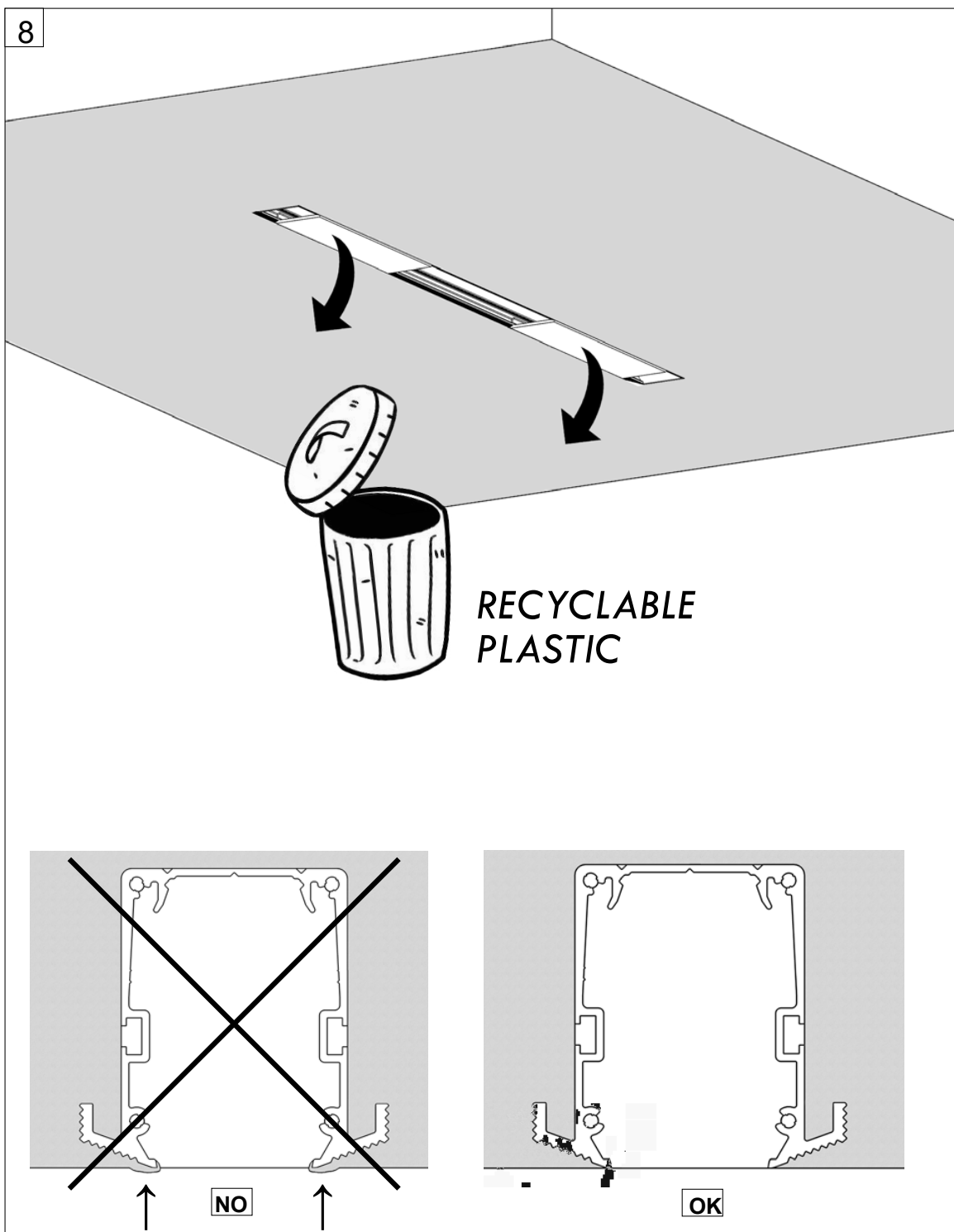

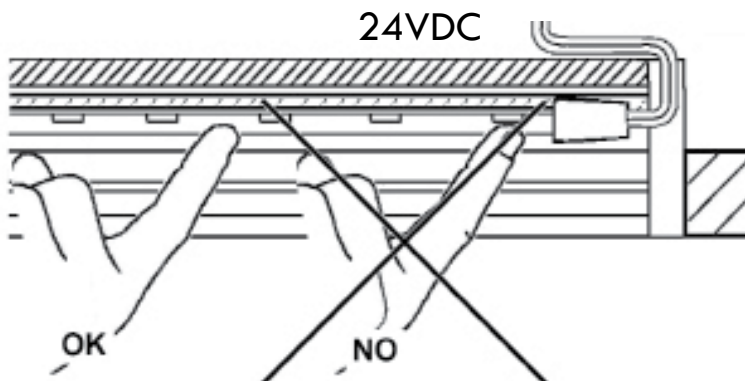
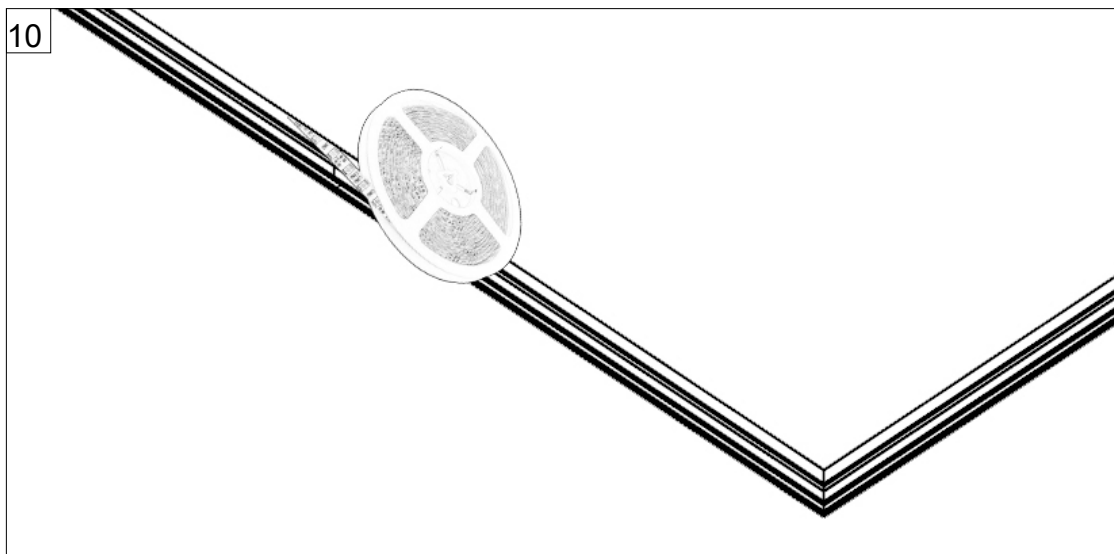
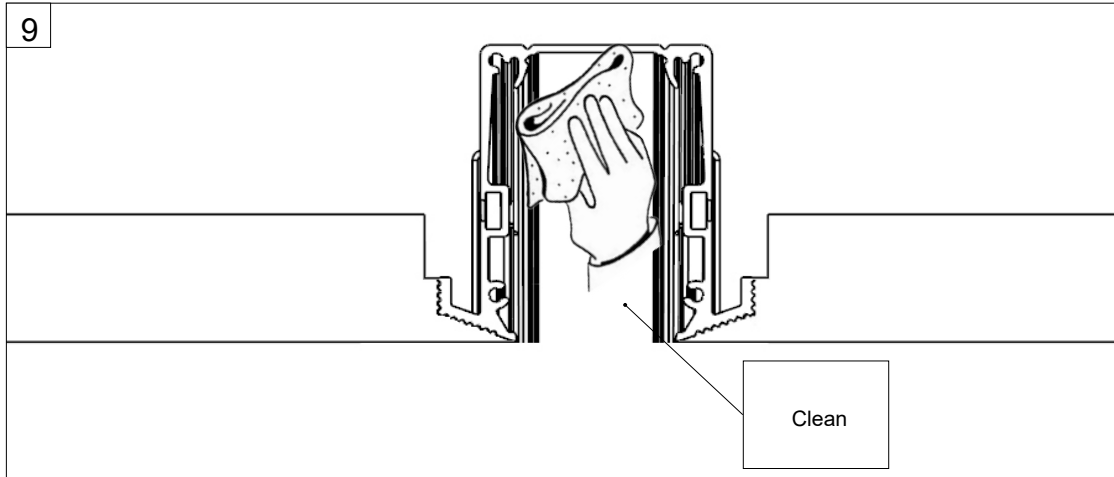

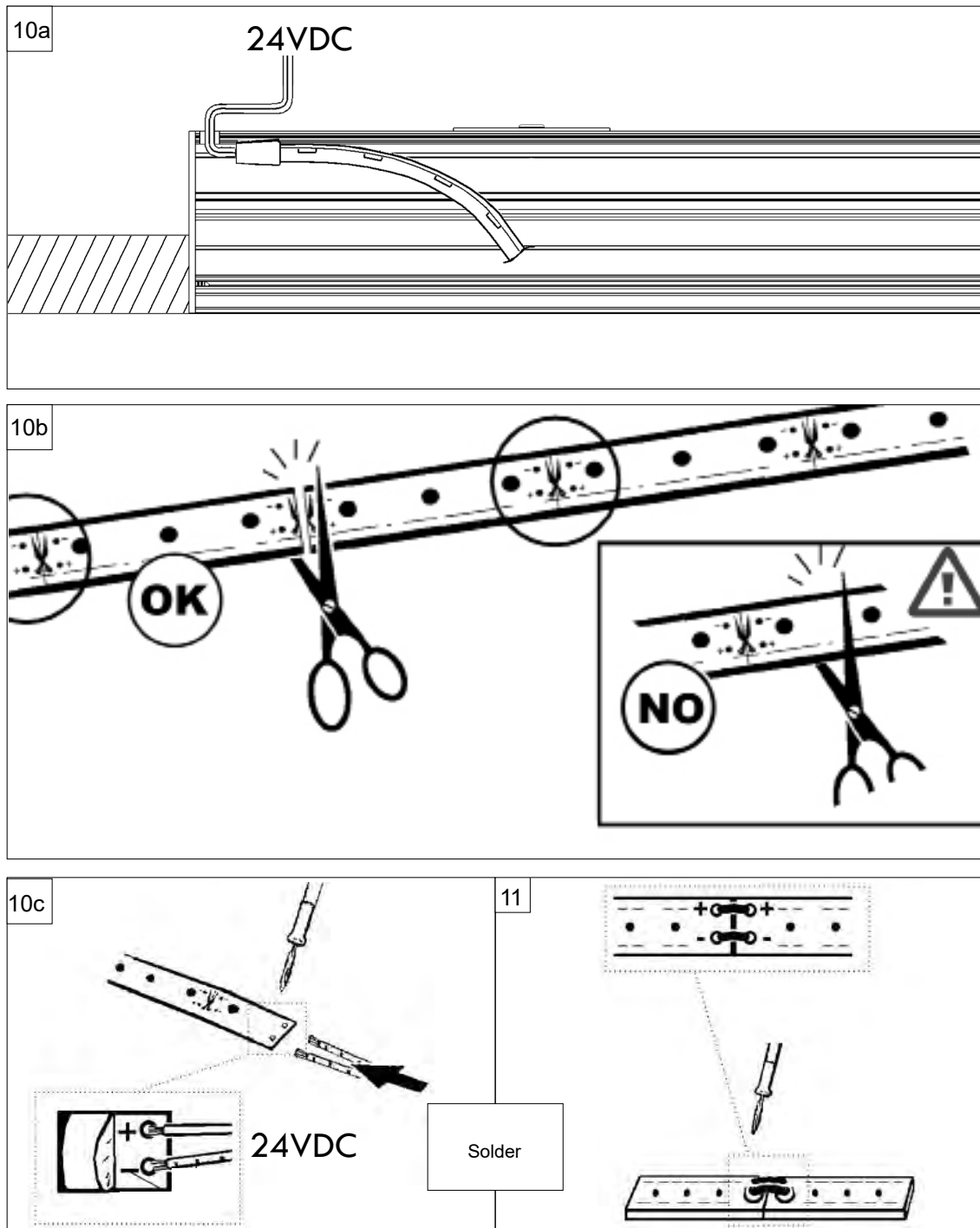

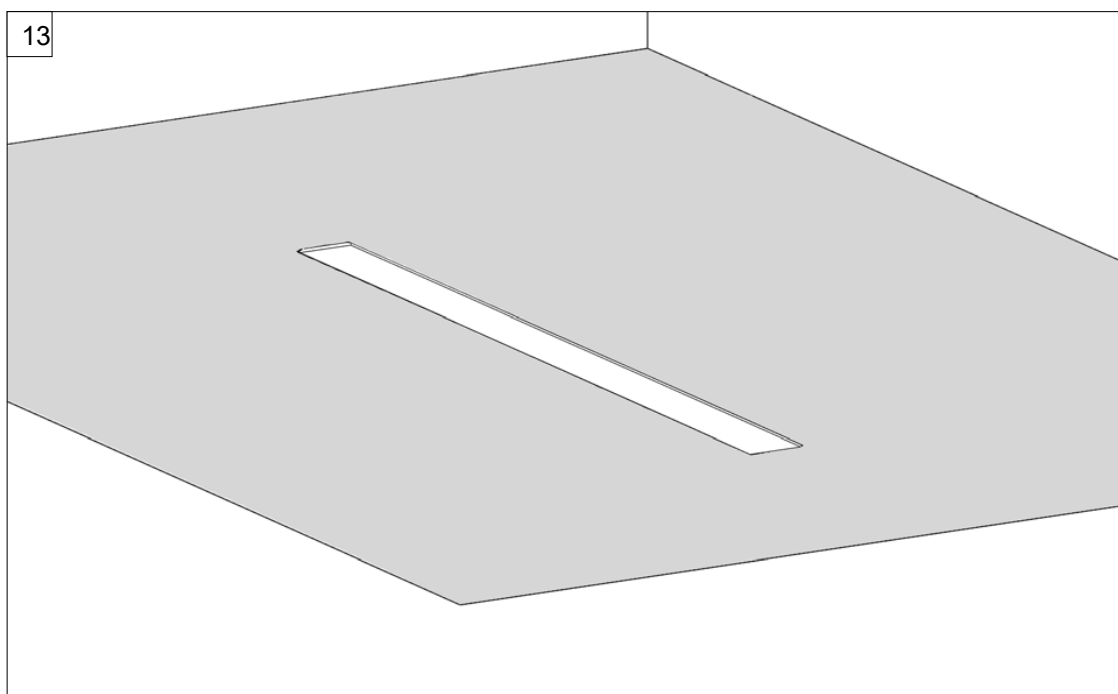
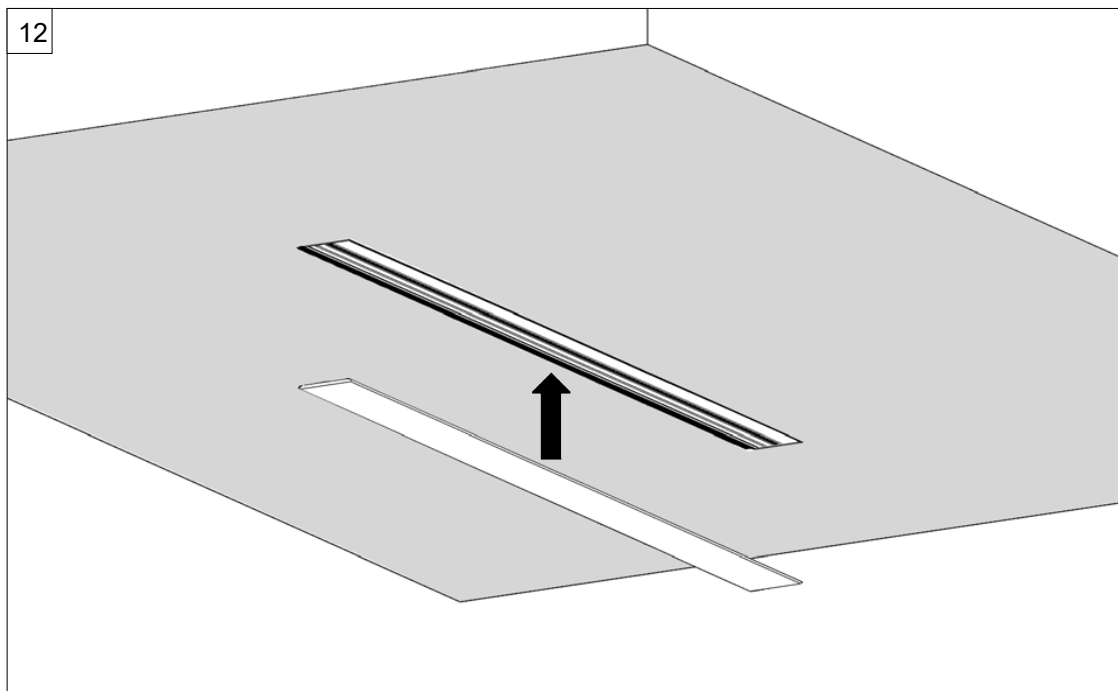

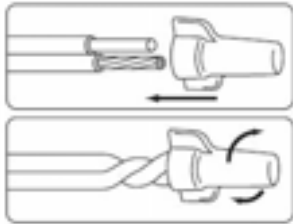

- Use gel-filled waterproof wire-nuts for wire connections.

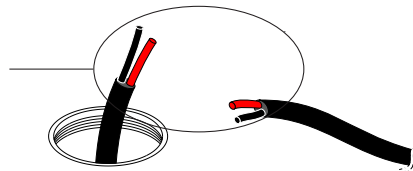

- It is the contractor's responsibility to caulk around the edges between the fixture and the mounting surface, to satisfy wet label requirements.
- It is the contractor's responsibility to install Remote Driver in a suitable electrical enclosure.



- C) - INSTALLATION ON ALREADY BUILT FALSE CEILINGS AND WALLS WITH A MINIMUM DEPTH OF 3.54".

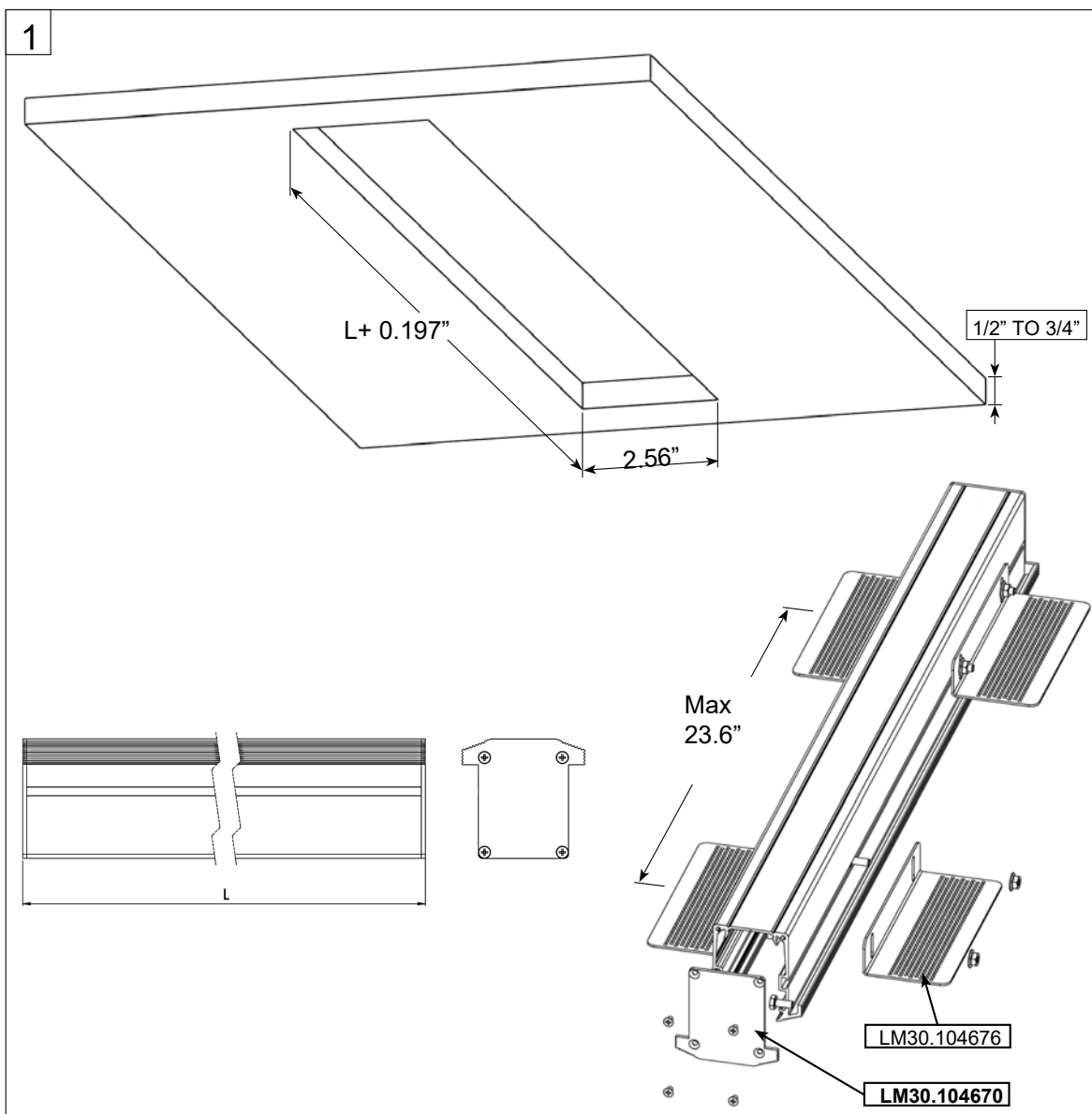

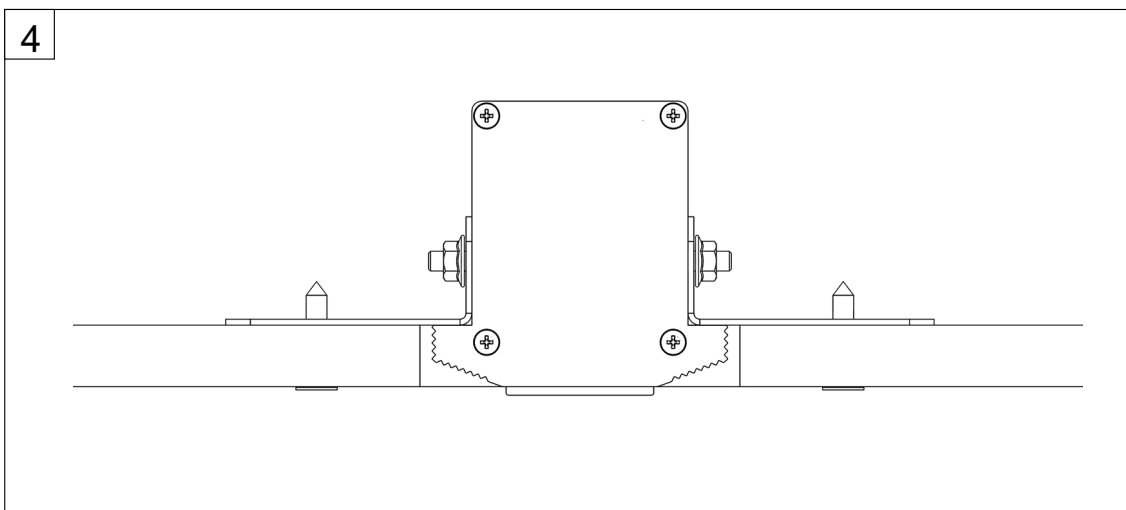
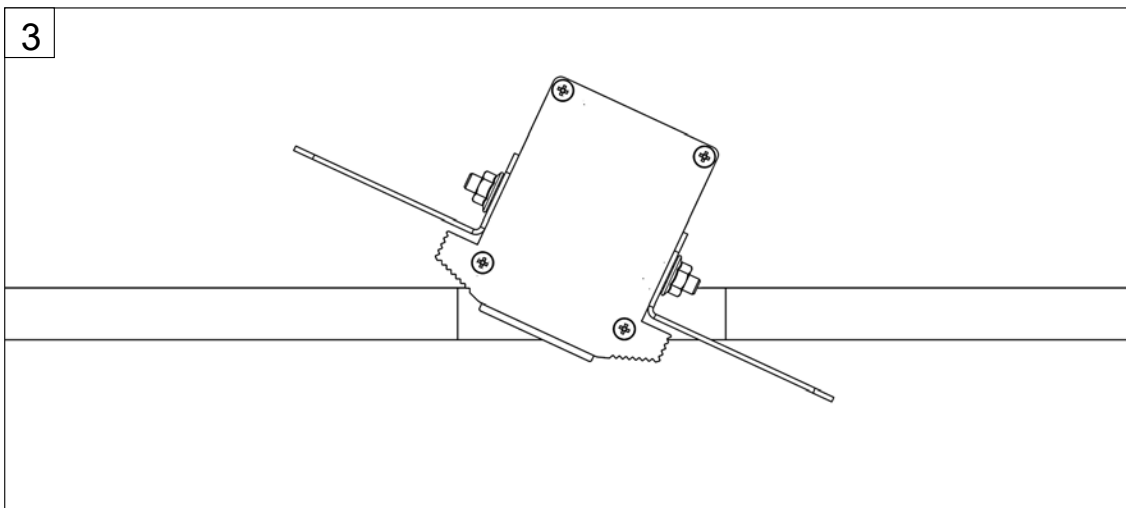
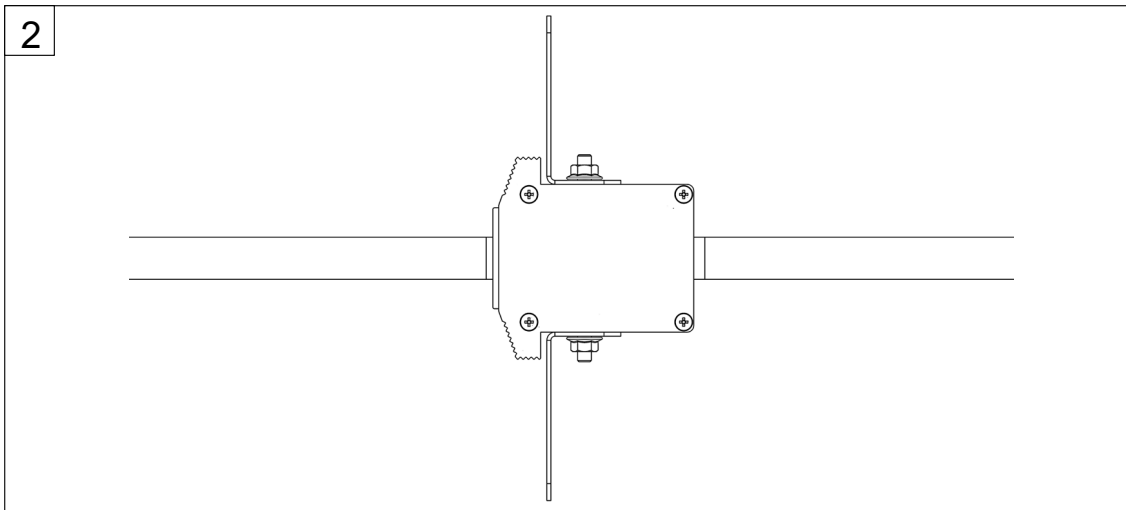

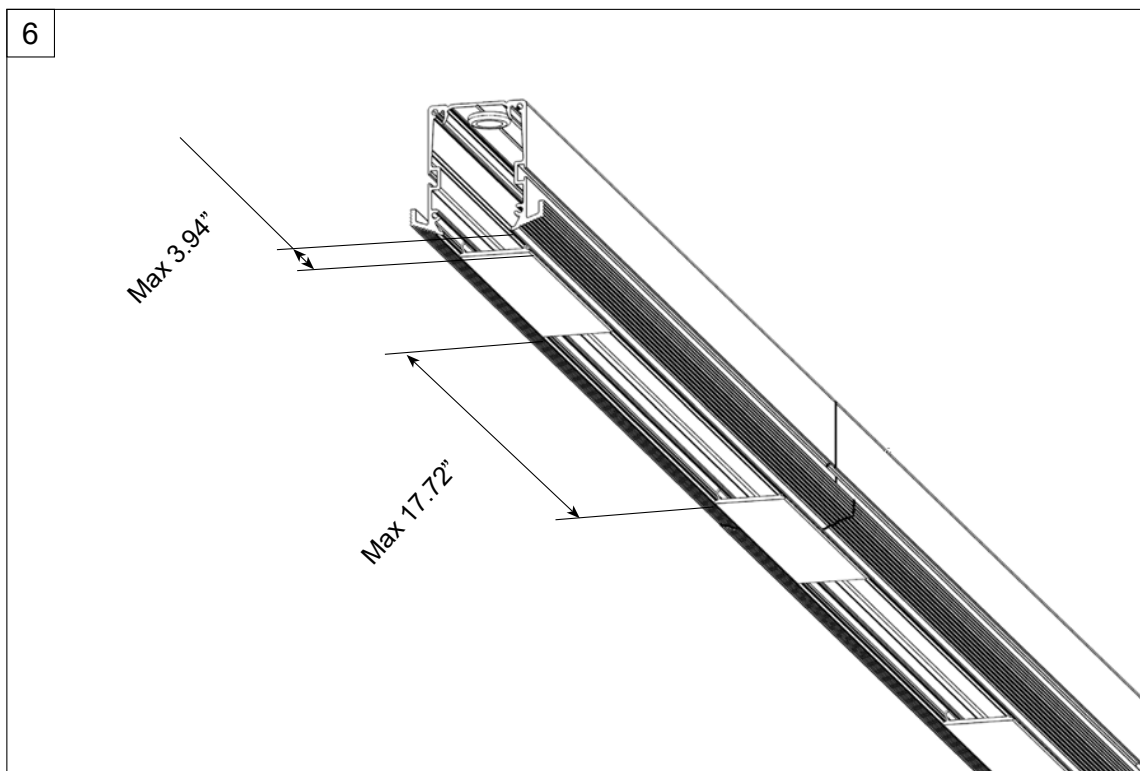
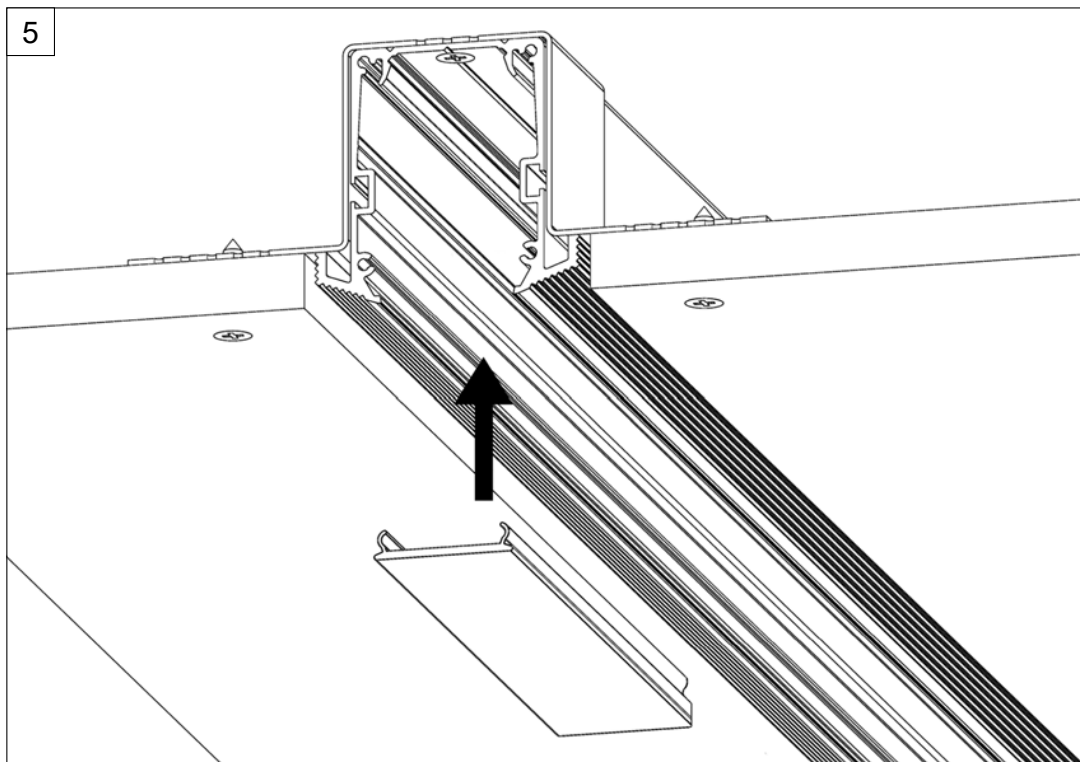

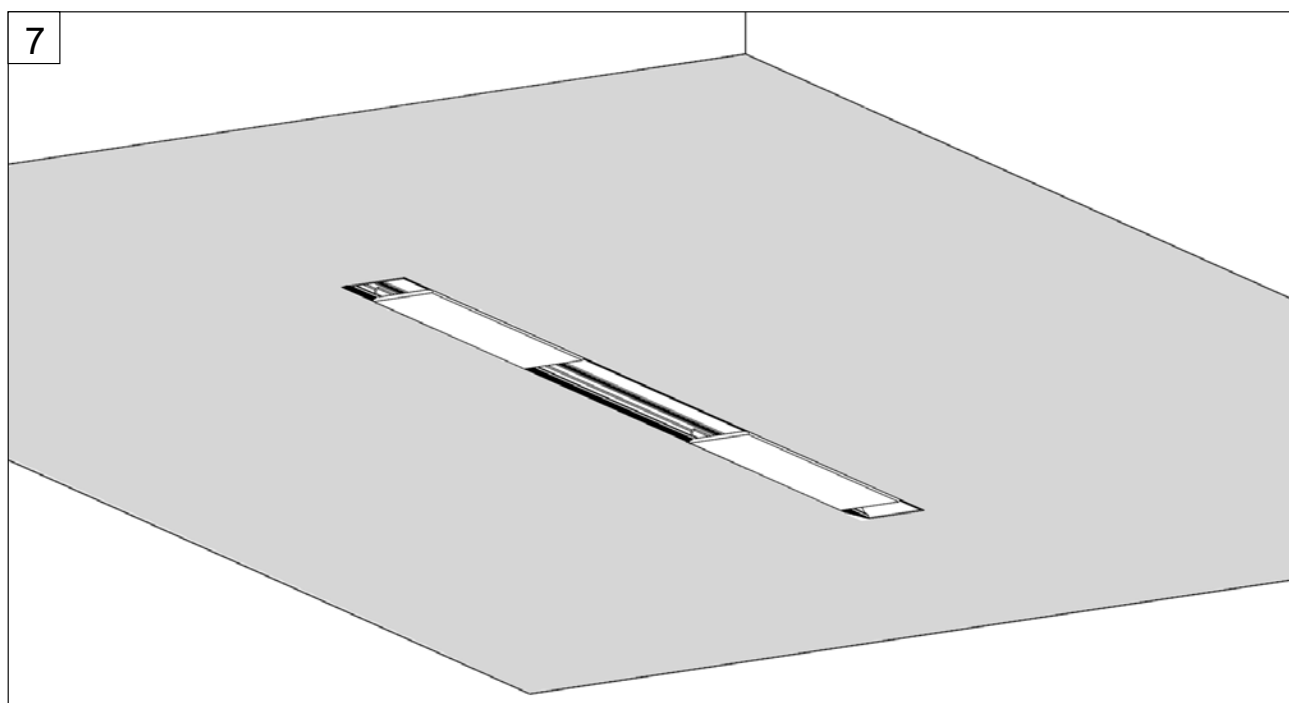
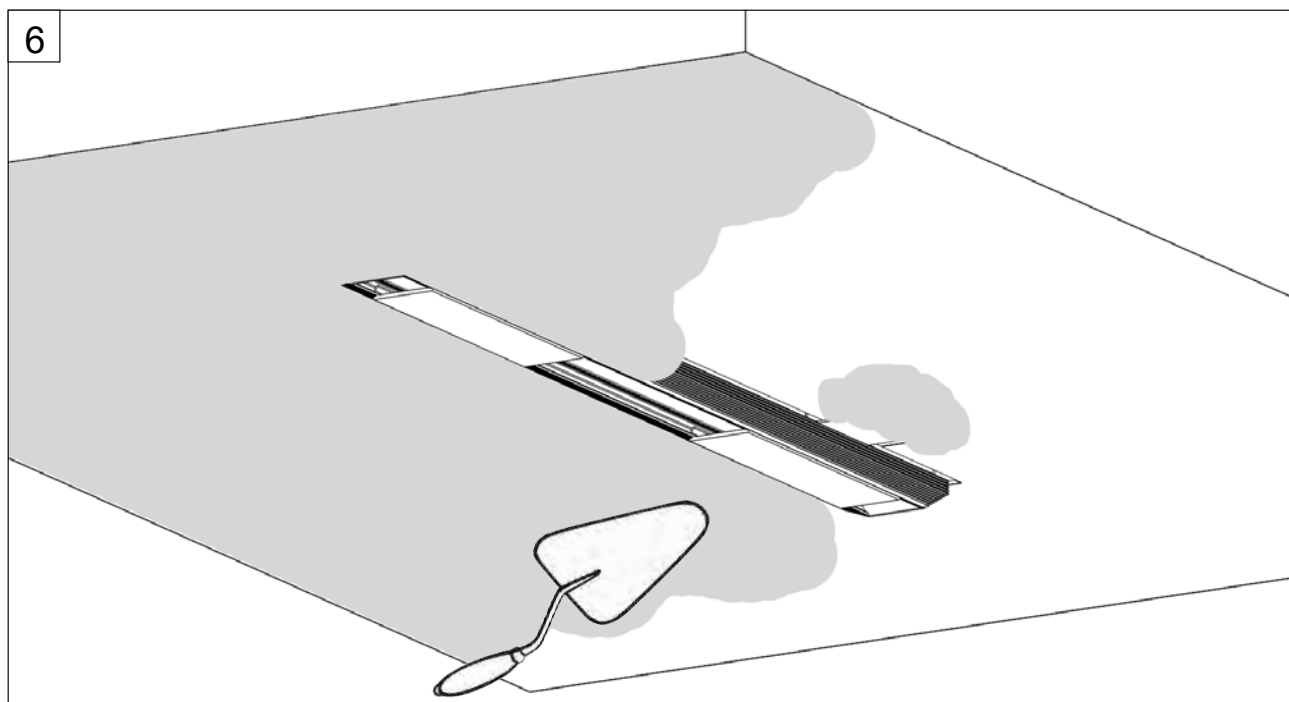

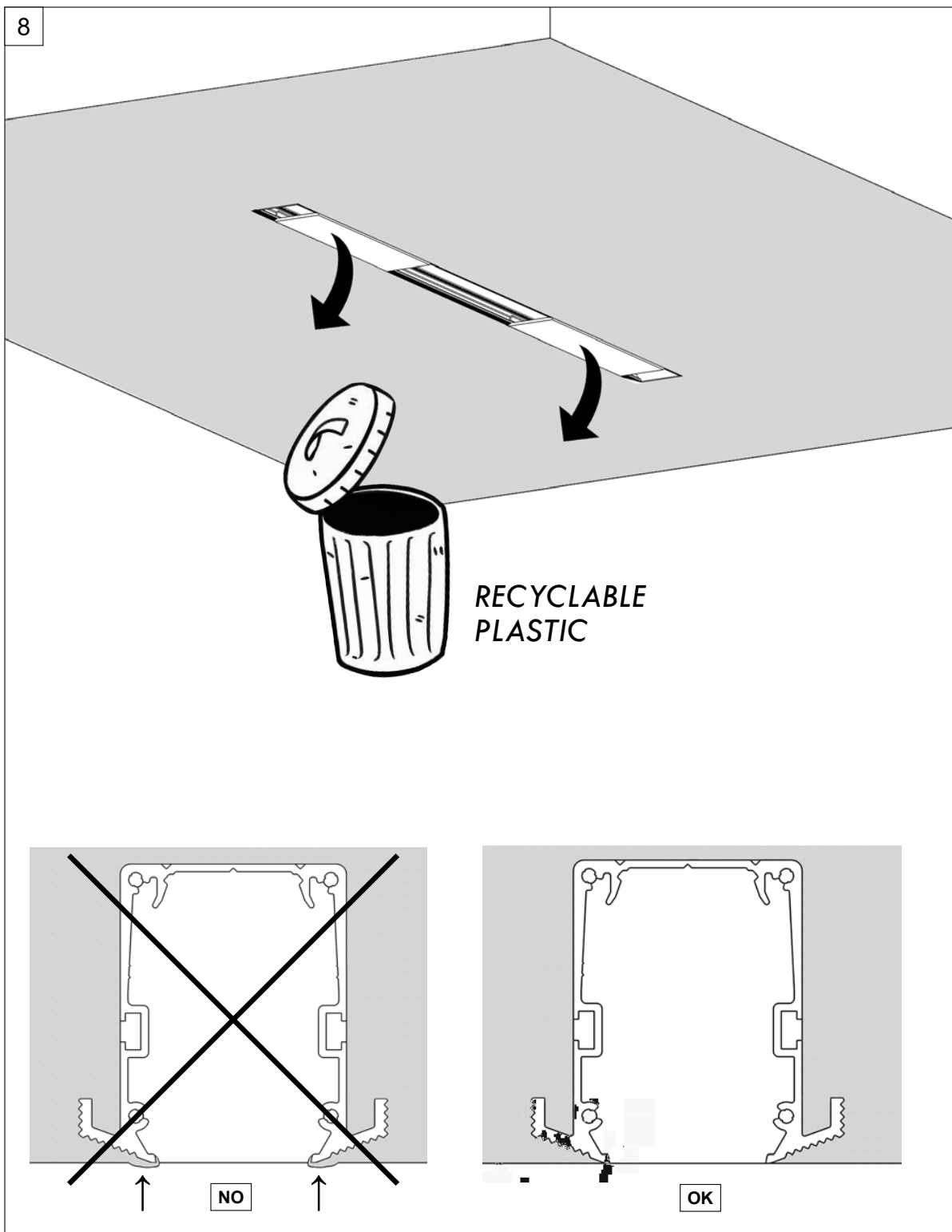

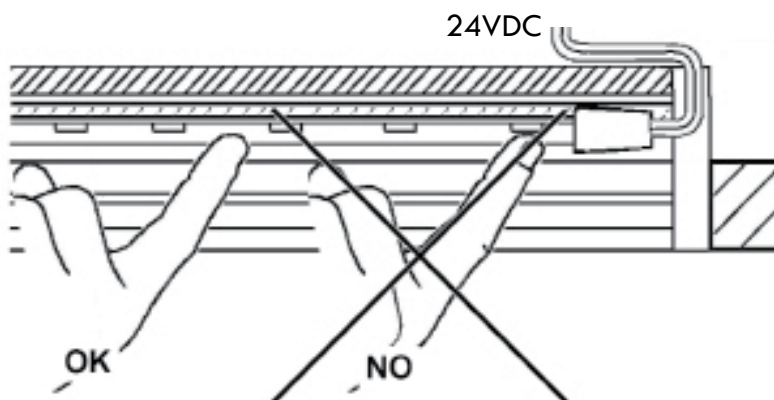
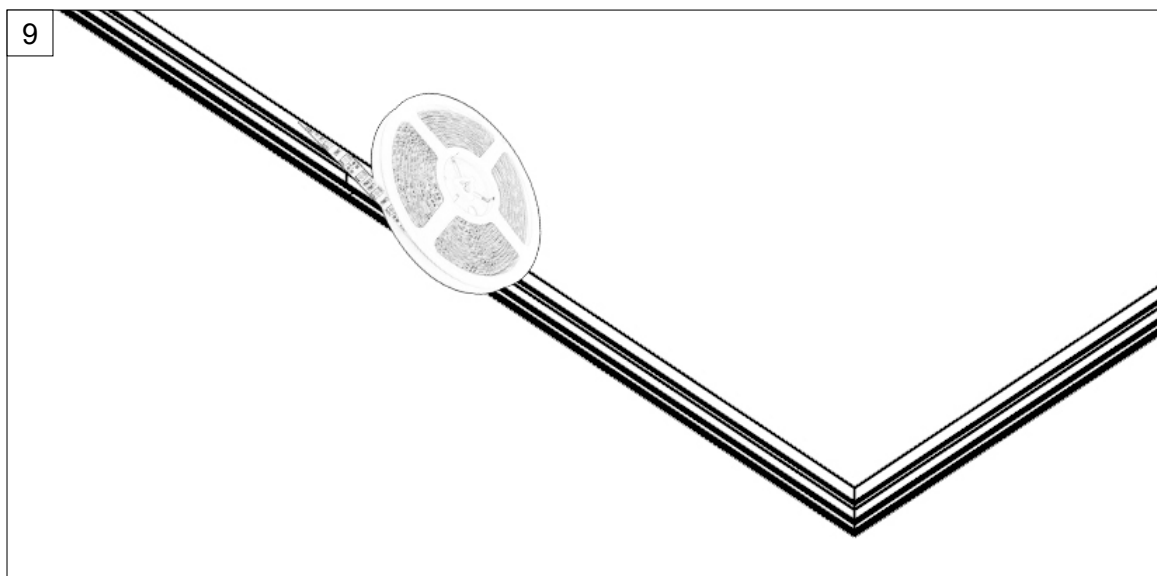
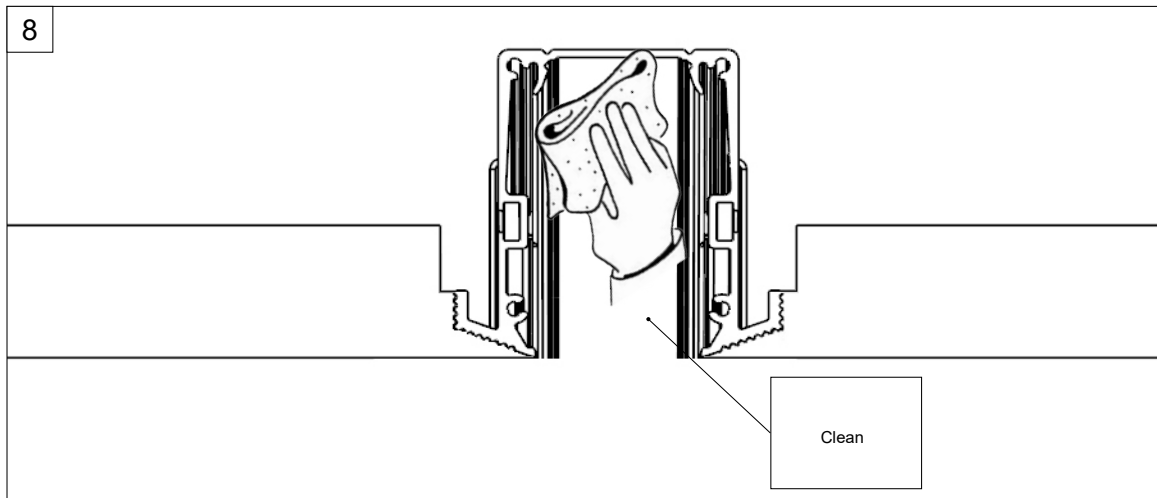

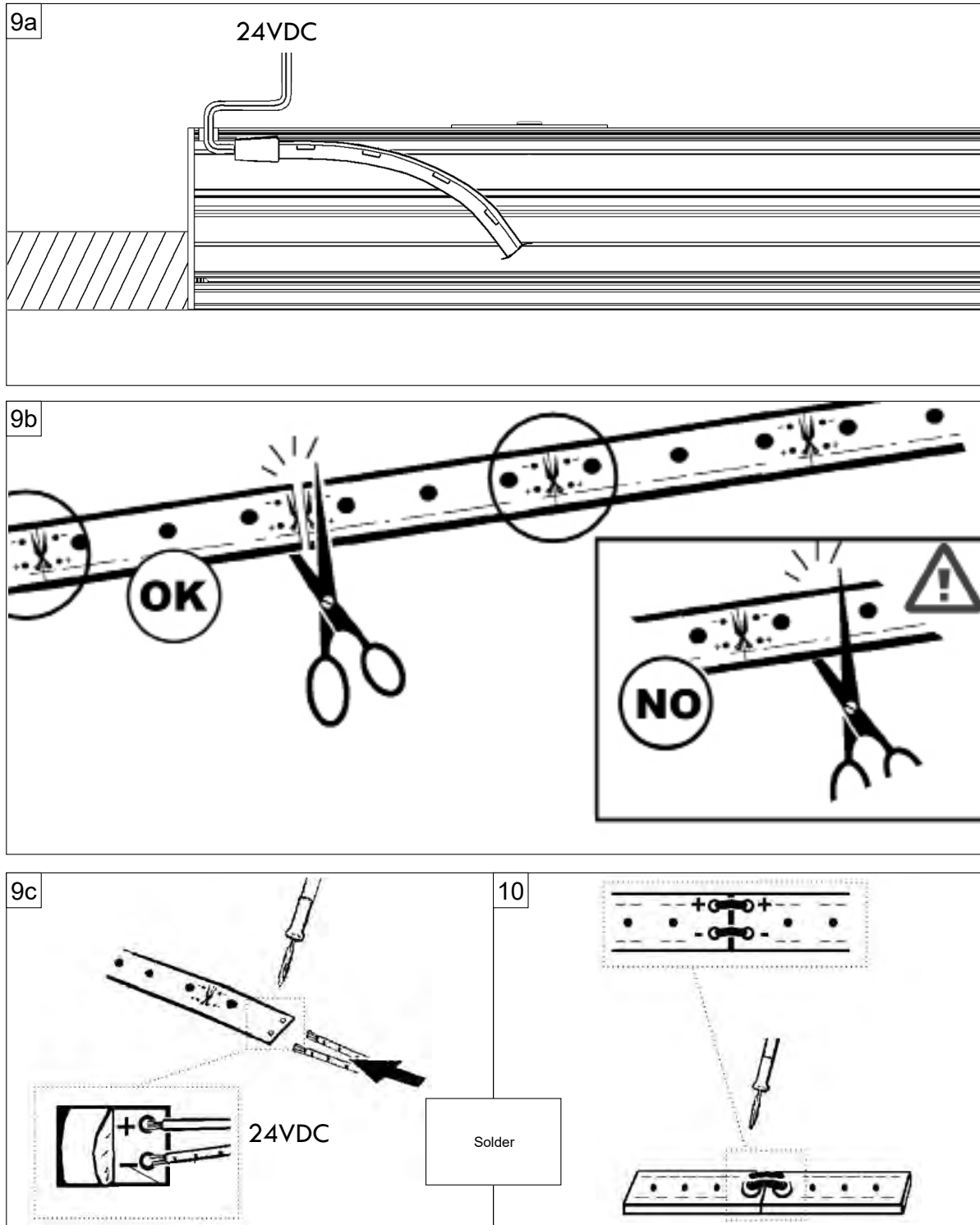

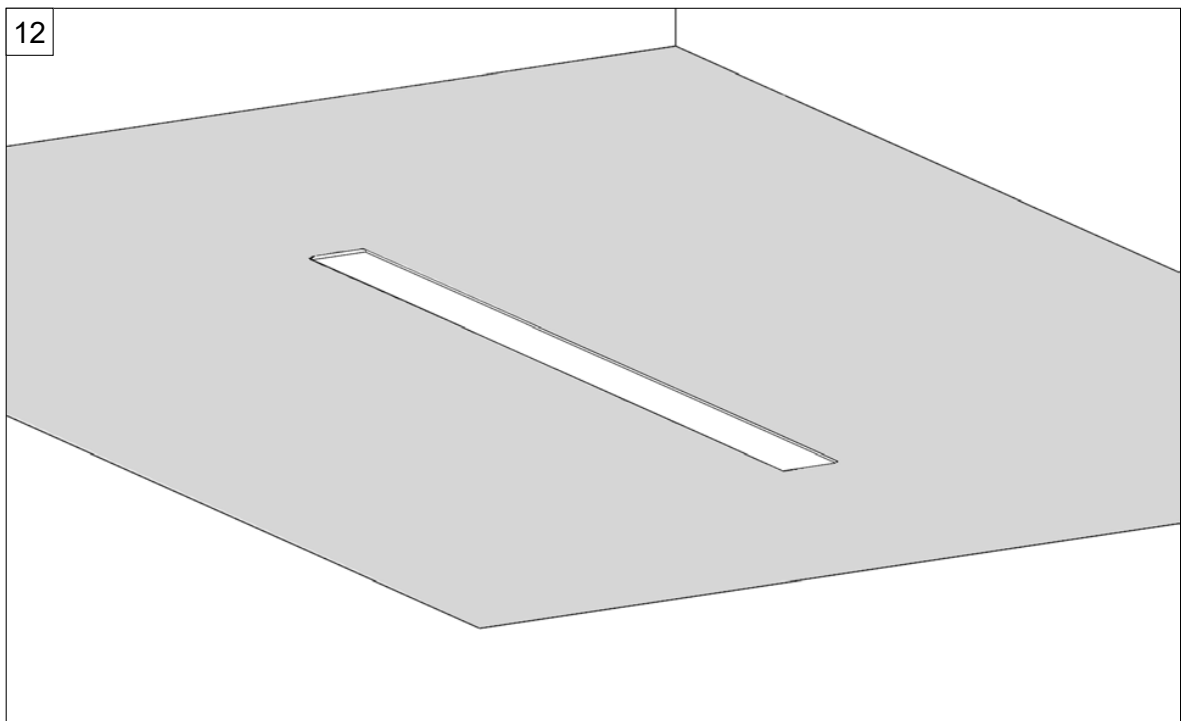
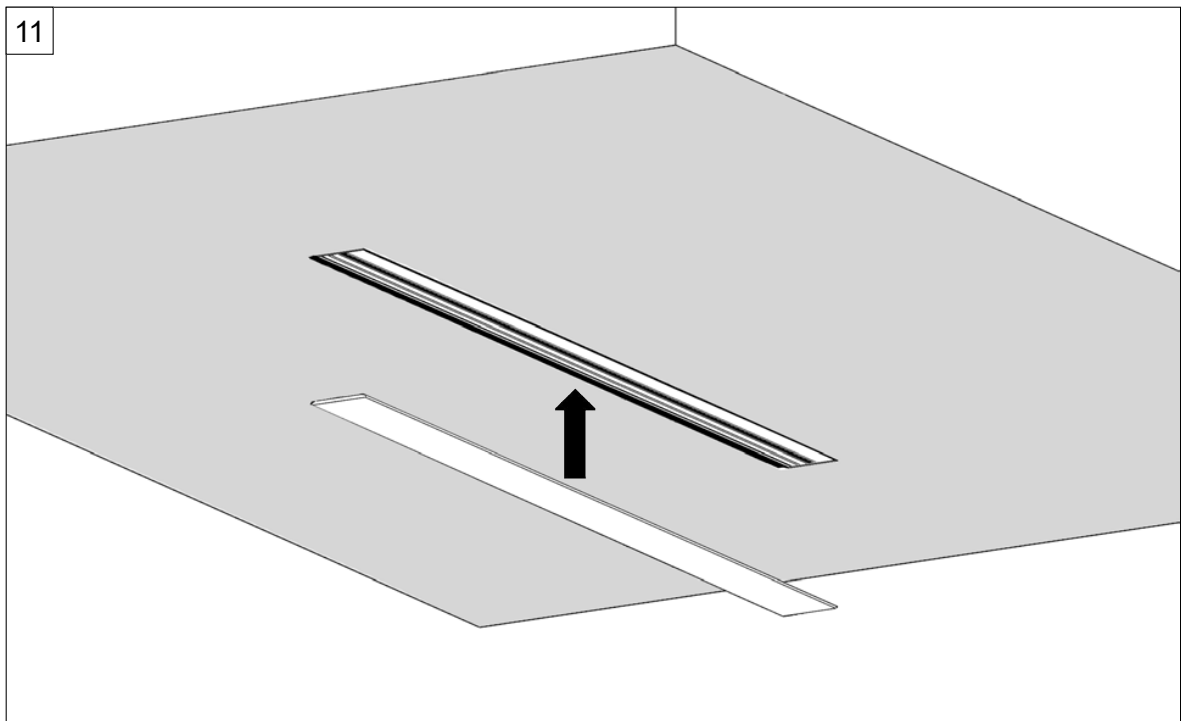

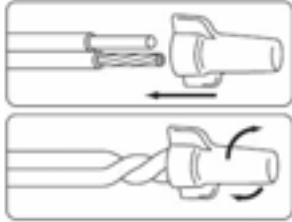

- Use gel-filled waterproof wire-nuts for wire connections.

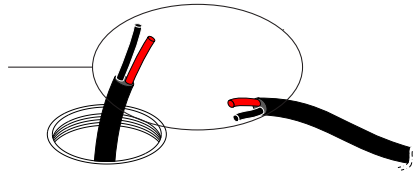

- It is the contractor's responsibility to caulk around the edges between the fixture and the mounting surface, to satisfy wet label requirements.
- It is the contractor's responsibility to install Remote Driver in a suitable electrical enclosure.



D) - INSTALLATION ON MASONRY WALLS BY MAKING A GROOVE WITH DIMENSION 2.36" x 2.36".

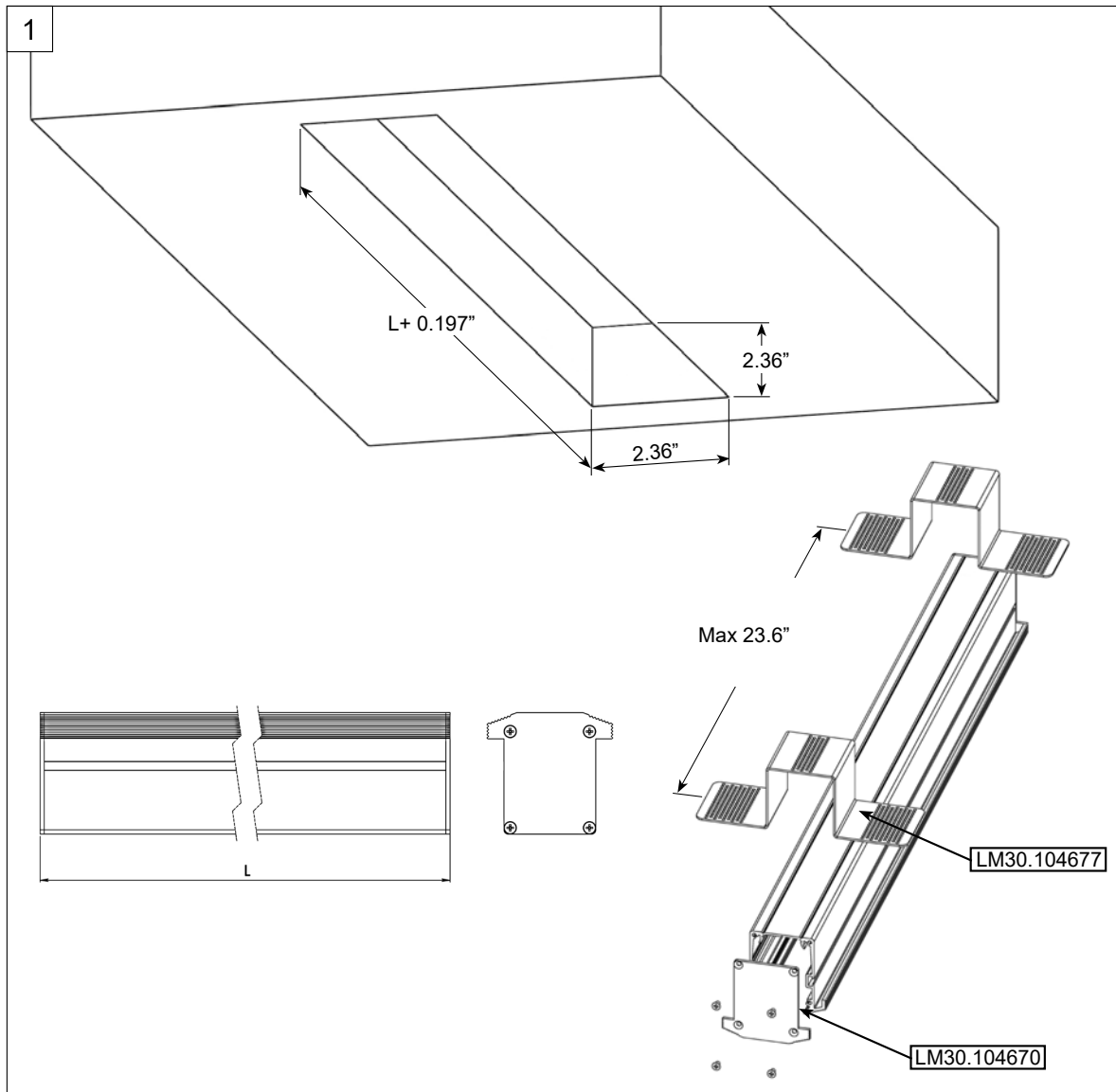

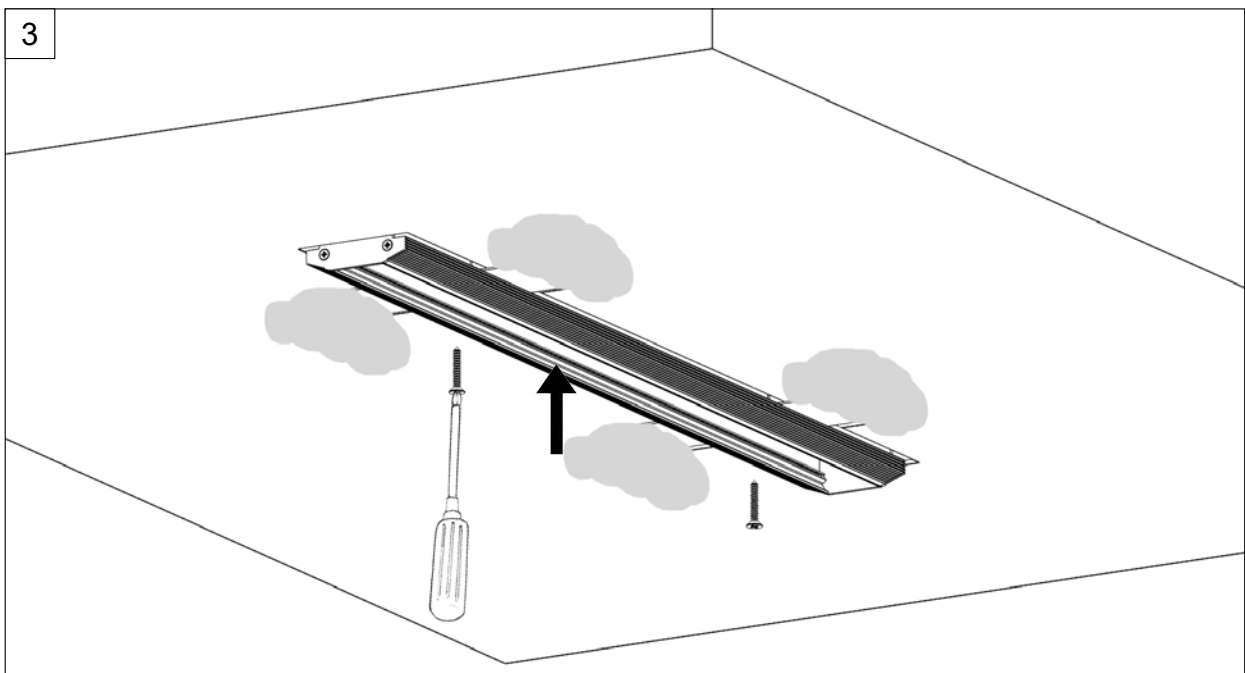
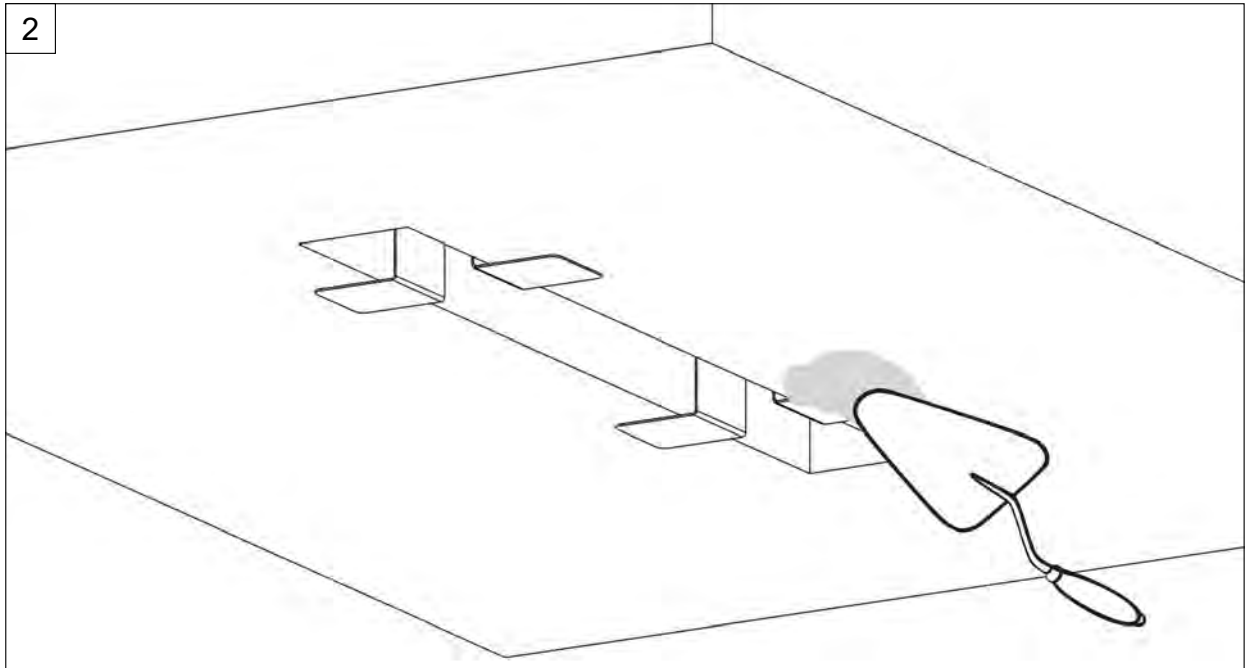

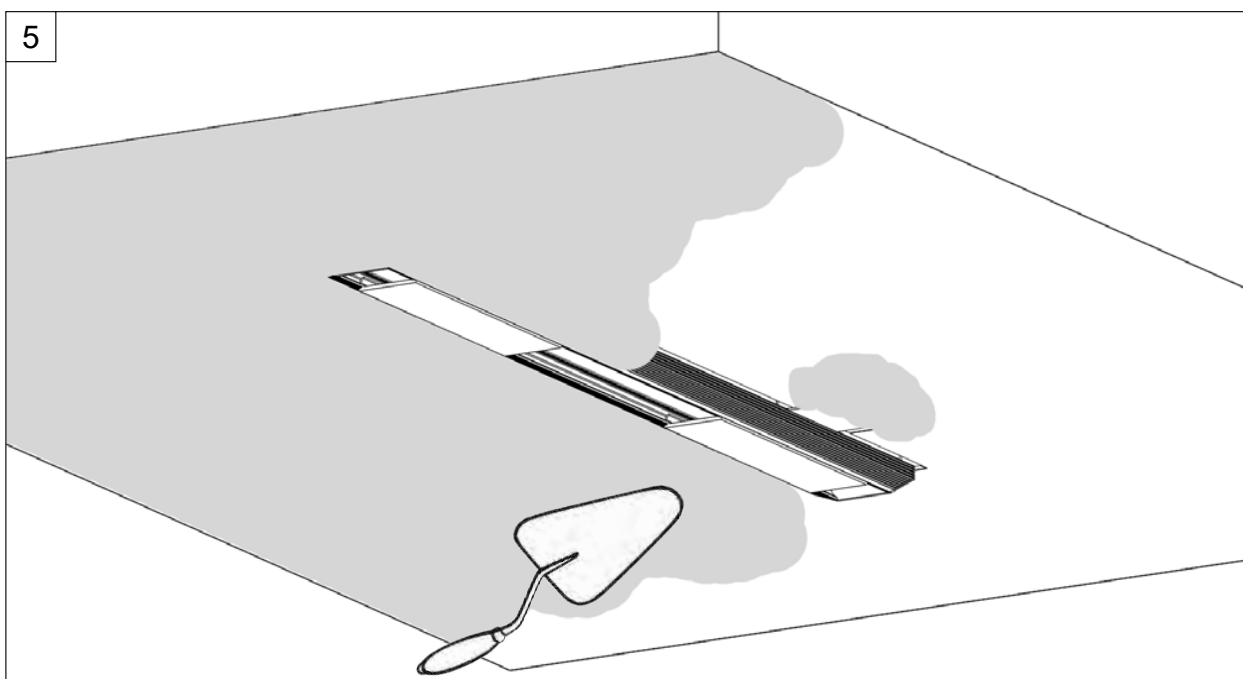
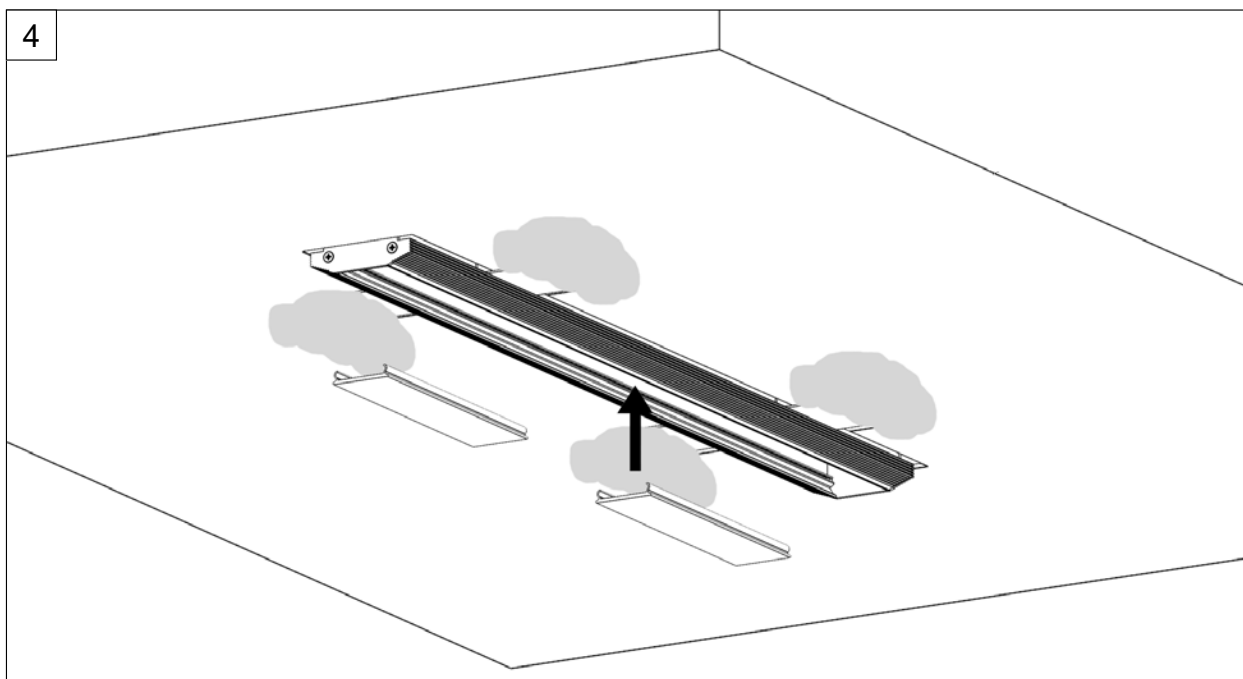

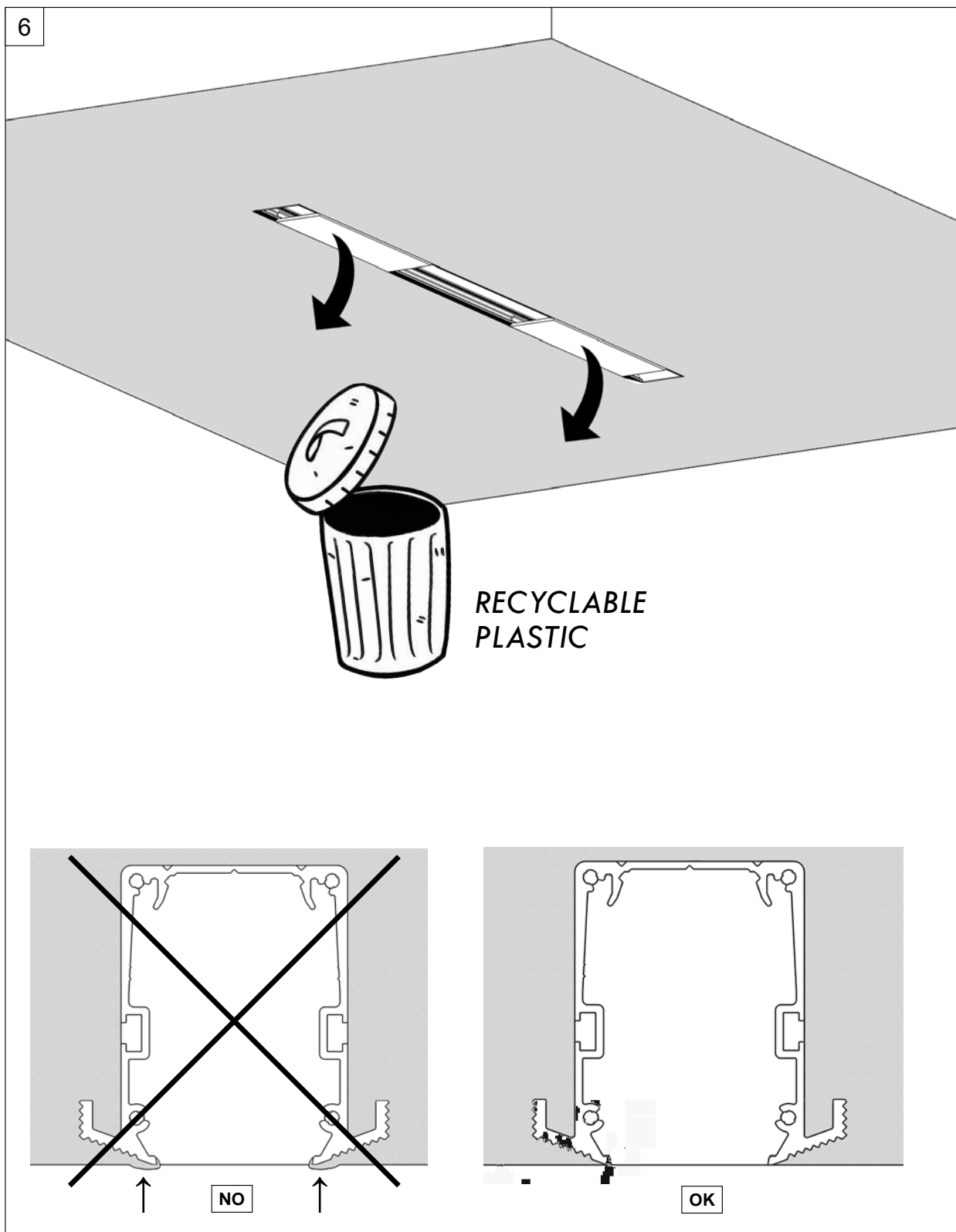

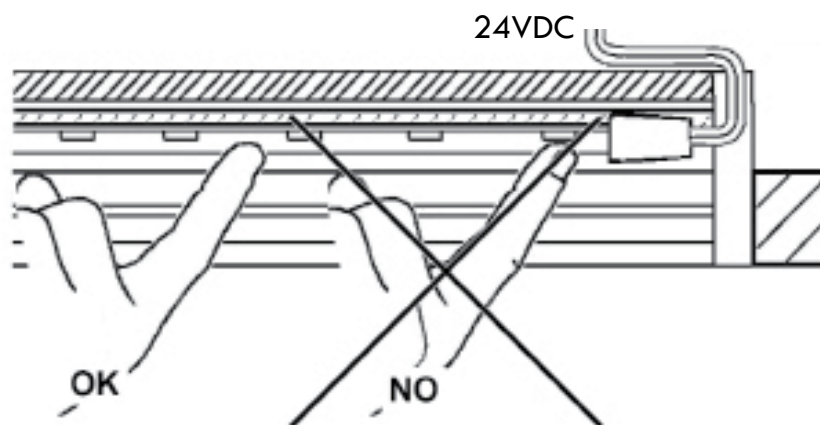
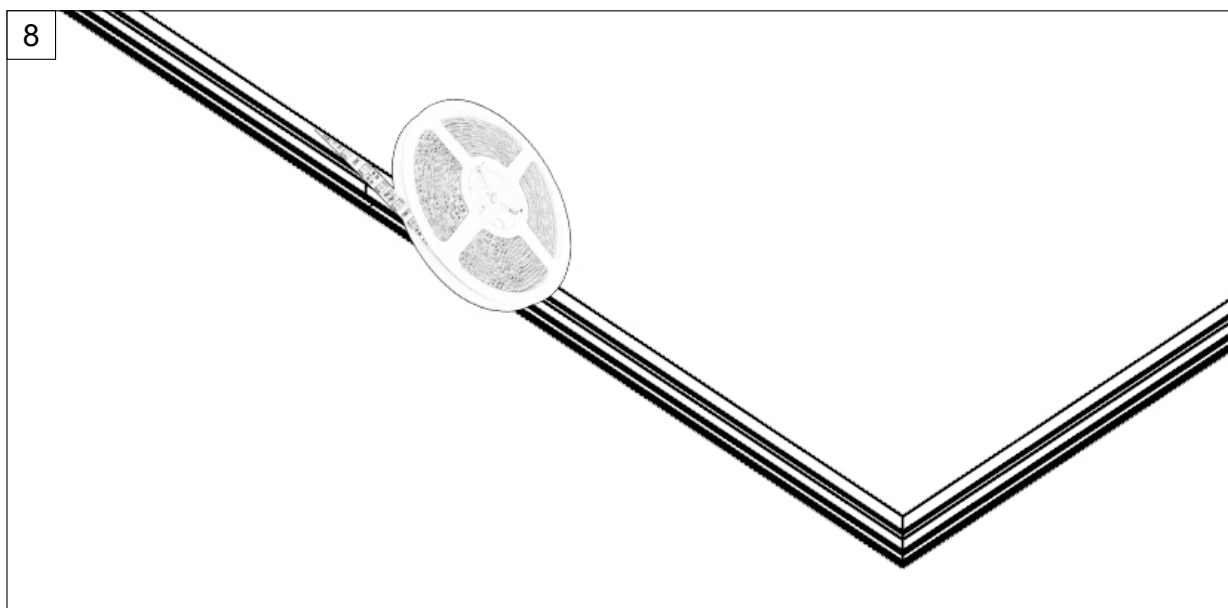
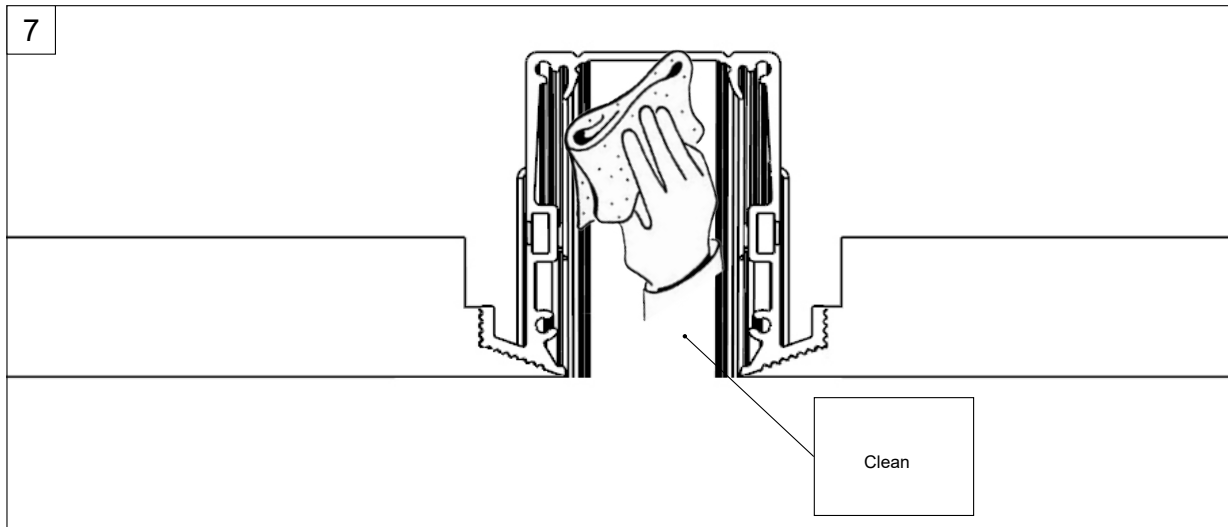

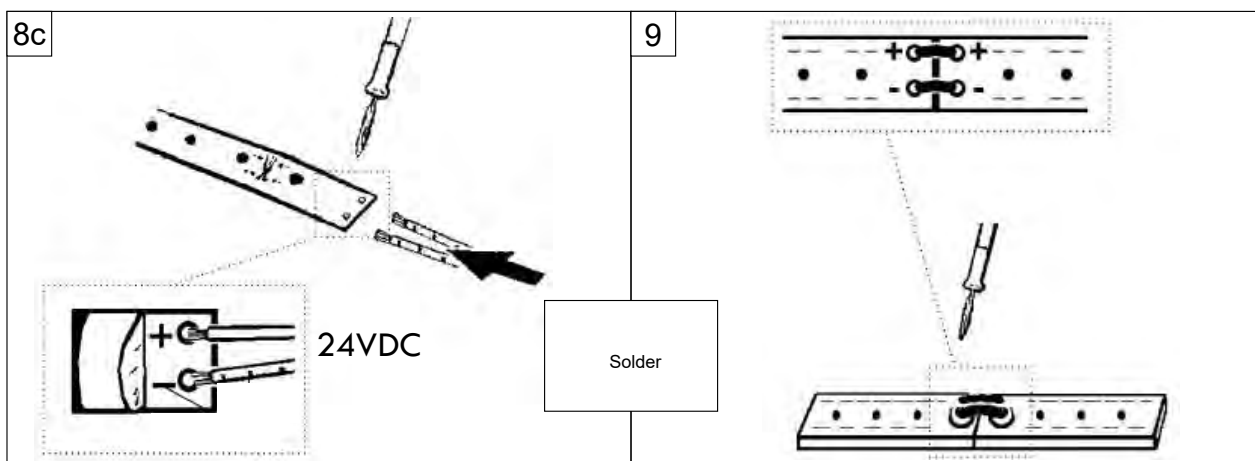
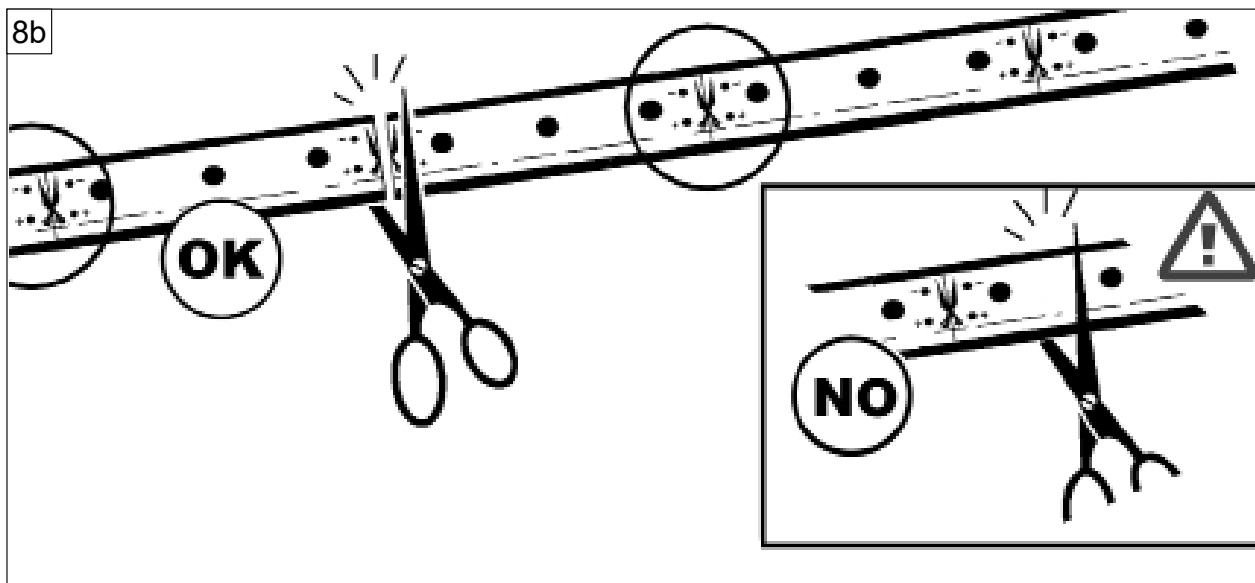
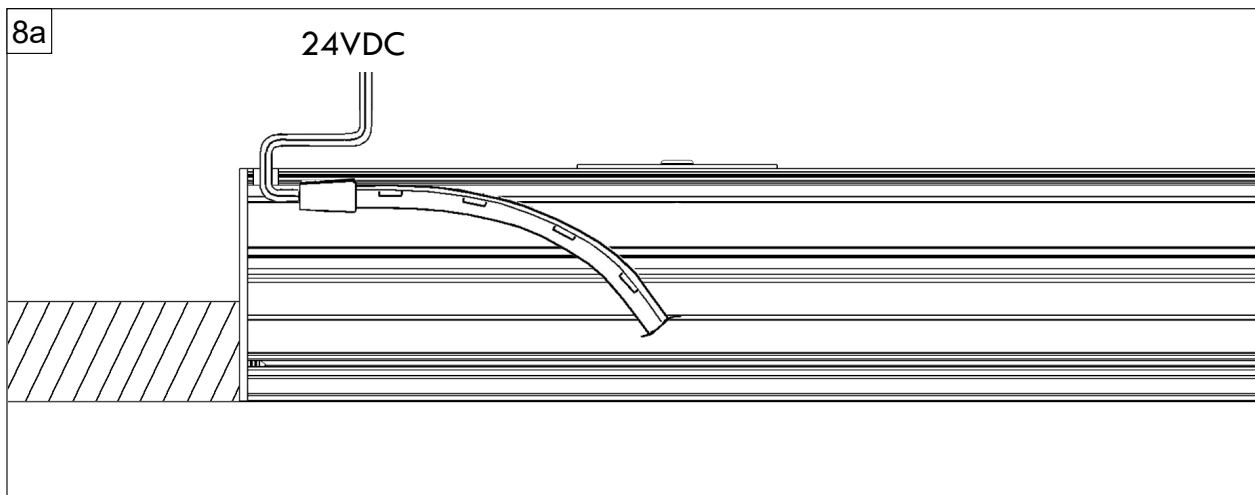

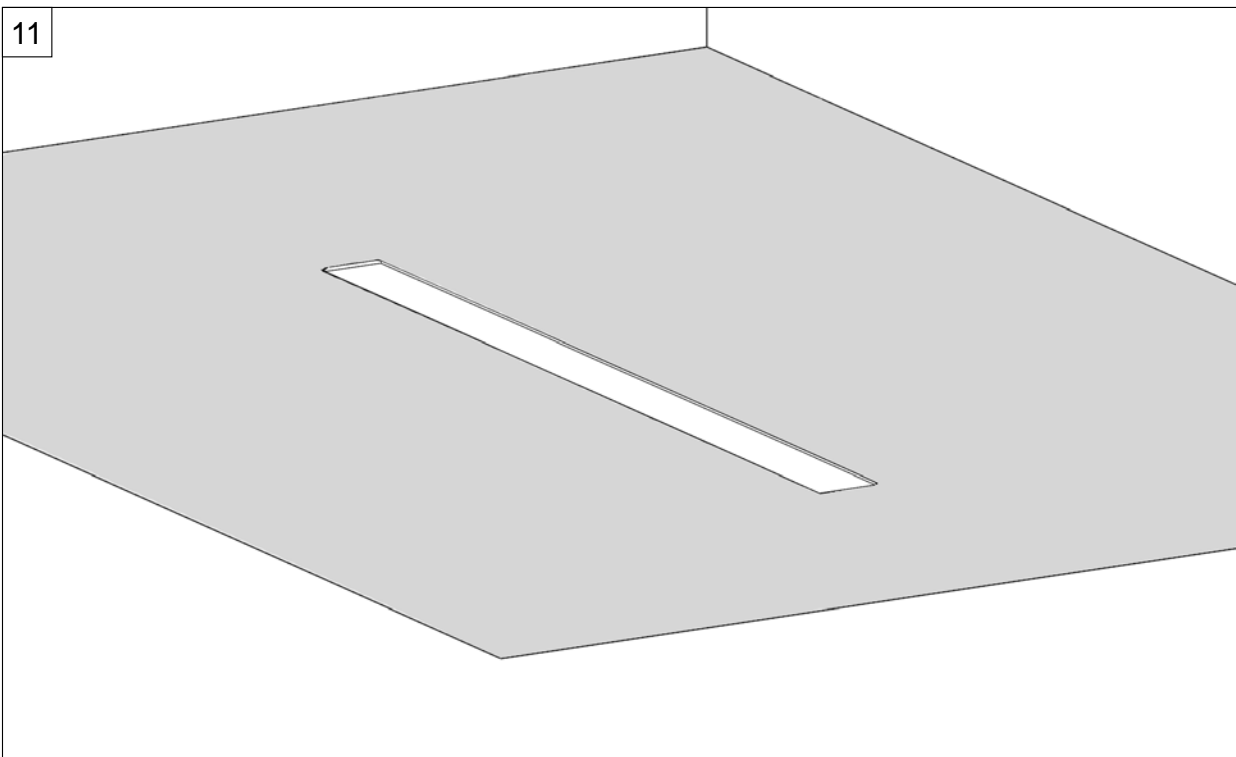
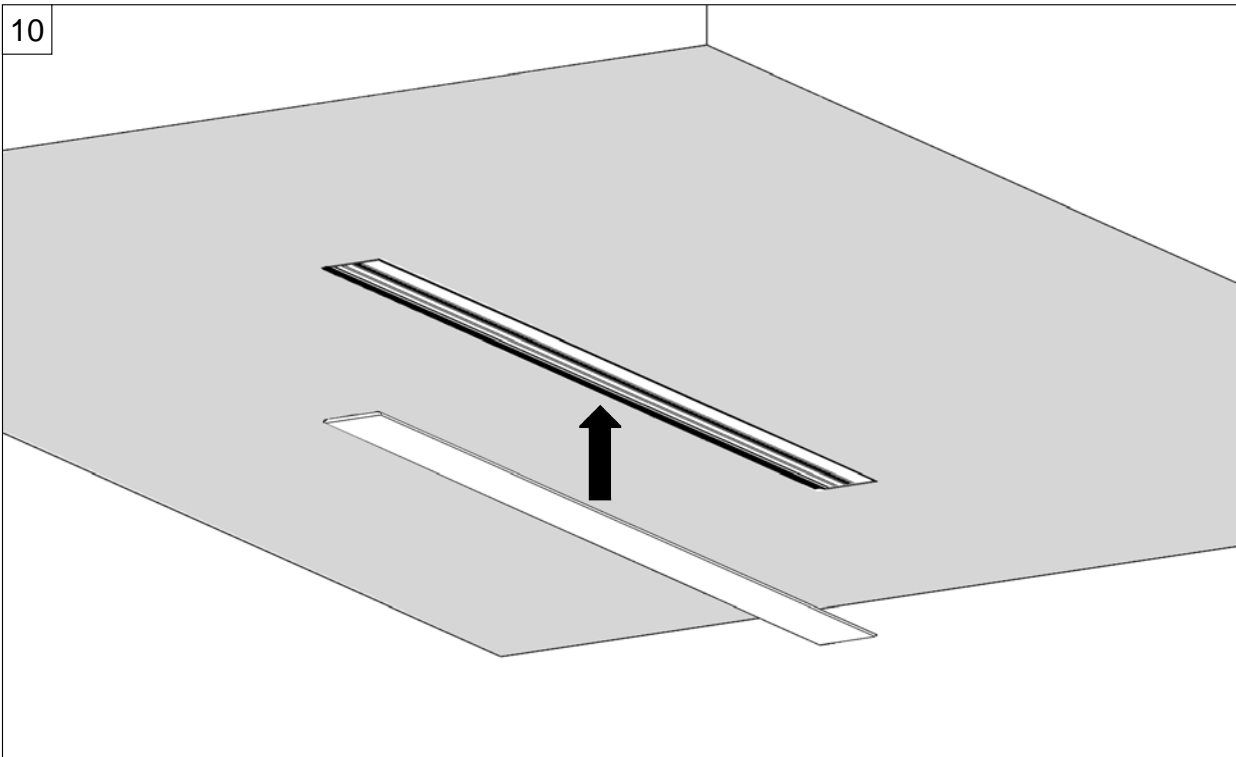

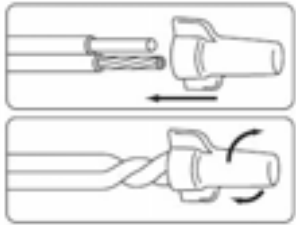

- Use gel-filled waterproof wire-nuts for wire connections.

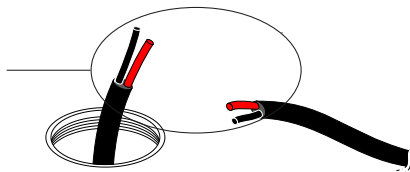

- It is the contractor's responsibility to caulk around the edges between the fixture and the mounting surface, to satisfy wet label requirements.
- It is the contractor's responsibility to install Remote Driver in a suitable electrical enclosure.



Wiring Diagram

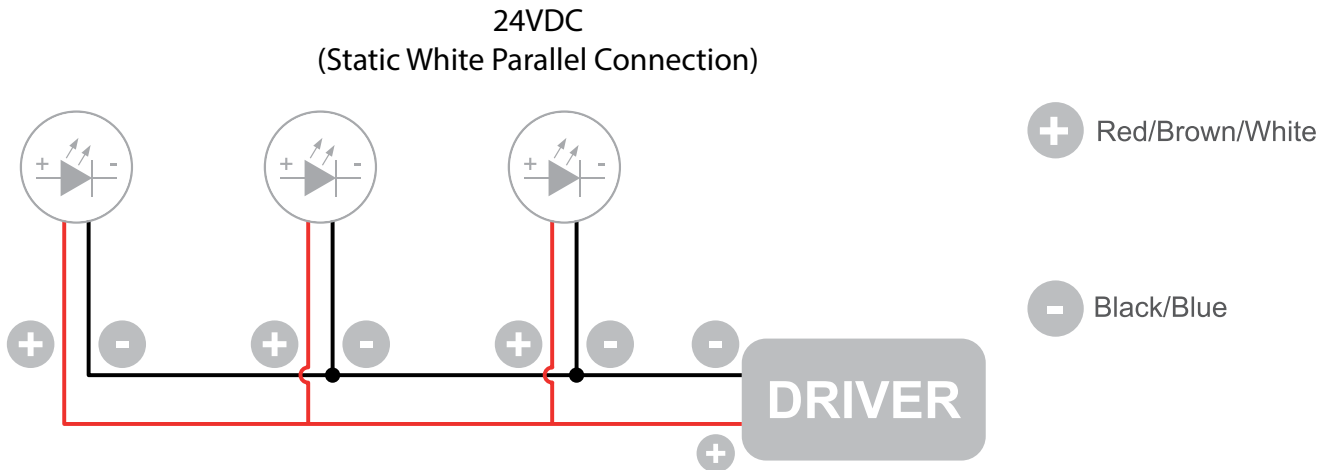

The individual lamps must be connected in parallel. Only power up the system once all the lamps have being connected.

- Only power up the system once all the lamps are connected. Connecting an individual lamp to an active power supply may cause the lamp to break due to over-voltage.
- Lamps and power supply units must be installed in well ventilated boxes or locations to allow a natural heat diffusion and avoid the devices overheating.
- On the power system, install a surge protection device to reduce the intensity of any voltage spikes to protect the lighting fixtures from the risk of damage.
- Fixture NOT suitable for covering with thermally insulating material.