

Technical features

|      |      |
|------|------|
| IP65 | IK09 |
|------|------|

Technical data

|                |  |
|----------------|--|
| Wattage        | 14W  |
| IP Rating      | IP65   |
| IK Rating      | IK09   |
| Material       | High corrosion resistance die-cast copper-free aluminum body |
| Coating        | Polyester powder coating with phosphochromating pre-finish   |
| Light source   | NR. 5 CREE "XP-L" LED down                                   |
| Screws         | Stainless steel  |
| Transformer    | Electronic power supply 120VAC 50-60Hz built-in              |
| Gasket         | Silicone rubber  |
| Rubber grommet | M20 Rutaseal® in EPDM  |
| Glass          | Tempered   |
| Gross weight   | 6.6 lbs  |

401017P

TECH MEDIUM 01  
ROUND PRO

Round wall mounted luminaire for outdoor installation on a facade/wall, with light distribution downward only. Phospho-chromatized and polyester powder coated die-cast copper-free aluminum body, tempered safety glass, molded silicone gasket and stainless steel screws. Built-in LED driver 120VAC 50-60Hz, with 5 CREE XP-L LED. IP65 rating.

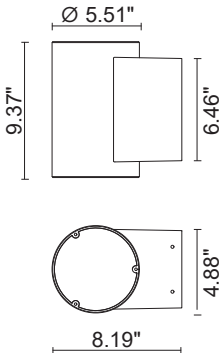

| light source*            | light beam options | lumen output (lm) | lumin. efficacy (lm/w) |
|--------------------------|--------------------|-------------------|------------------------|
| <b>3000°K warm-white</b> |                    |                   |                        |
| high-power led           | 10°                | 1,300             | 92.86                  |
| high-power led           | 30°                | 1,230             | 87.86                  |
| high-power led           | 45°                | 1,170             | 83.57                  |

\* Other light colors available on request: Neutral-white

Finish color options:

|  |   |   |
|--|---|---|
|  Textured Gray<br>RAL 9006 |  Anthracite Gray<br>RAL 7016 |  Matte Black<br>(on request) |
|--|---|---|

