

Zen is a suspended indoor pendant made of AirCoral® with a white surface mounted or recessed ceiling box. It is available in 3000K with 120° optic.

TECHNICAL DATA

Wattage / Input	30W (120-277VAC, 24VDC)
Power Supply	Integral - 120-277VAC (Surface Box) Remote - 24VDC (Recessed Box)
Construction	Body: AirCoral® Lens: Frosted Satin Glass Ceiling Box: Surface or Recessed Cable: Max length 6.56'
CCT	3000K
CRI	>80
Delivered Lumens	3150 lm (3000K)
Efficacy	105 lm/W
Optics	120°
Finishes	AirCoral®
Fixture Dimensions	40.16" l x 1.97" w x 2.76" h
Cut-out Dimension	Ø6.30" for BU1452.AC (fig. B)
Fixture Weight	9.26 lbs
IP Rating	IP40

The body is made of AirCoral® a unique patented composite material that actually purifies the air. It can be calculated how many cubic feet each fixture will purify. See website for AirCoral® calculator.

Additionally, AirCoral® is:

- Antibacterial.
- Antifungal.
- Scratch-resistant.
- Dust-resistant.
- Suitable for painting.
- LEED recognized material.

ORDERING INFORMATION

Example: BU1451.AC.US.

	AC	US
Model No.	Finish	
BU1451 - with white ceiling box - integral driver	AC - AirCoral®	US
BU1452 - with recessed box - remote driver		

Job Name/Date:

Fixture Type Designation:



Fixture Dimensions

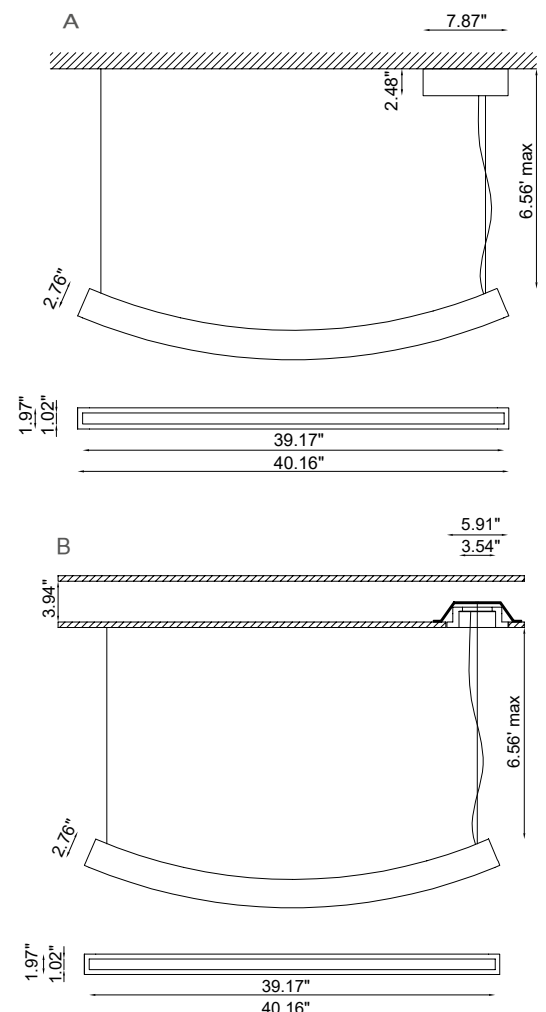

SUGGESTED POWER SUPPLIES

24VDC Remote Driver - For use with recessed ceiling box

Part Number	Description	Input/Output	# of Fixtures
PPLT00158	Non-Dim	120VAC to 24VDC, 100W, Class 2	1-2
PPLT00543	0-10V Dimming to 15% (-40°F / -40°C Cold Weather Start)	120-277VAC to 24VDC, 100W, Class 2	1-2

DRIVERS IN NEMA ENCLOSURE

Remote 24VDC - ELV / TRIAC / 0-10V



PPLT00715

Part Number	Description	Input/Output	# of Fixtures 30W
PPLT00715	ELV / TRIAC / 0-10V Dimming to 0.1%	120-277VAC to 24VDC, 96W, Class 2, WET/DAMP	1-2

*For other power supply options consult factory.***PHOTOMETRIC DATA***Note all Photometry is 3000K*

Maximum Candela = 700.4

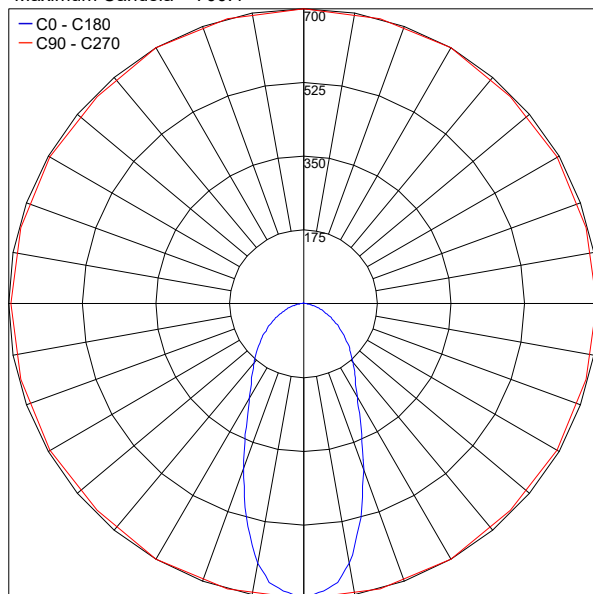
*Job Name/Date:**Fixture Type Designation:*