



INSTRUCTIONS PERTAINING TO RISK OF FIRE OR INJURY TO PERSONS. READ ALL INSTRUCTIONS. IMPORTANT SAFETY INSTRUCTIONS. SAVE THESE INSTRUCTIONS.

DANGER - RISK OF SHOCK - DISCONNECT POWER BEFORE INSTALLATION! Please read all instructions before installation.

- Keep these instructions for future reference.
- Must be installed by a qualified electrician in accordance with national and local standards. Designplan is not responsible for fixtures installed without regard to these standards.
- Unauthorized alterations or tampering of product voids warranty.
- The main power connection must be in accordance with local electrical codes.
- Suitable for OUTDOOR applications.



ATTENTION: For Wall/Ceiling - It is the contractor's responsibility to caulk around all the edges between the fixture and the mounting surface to satisfy wet label requirements.
For In-Grade - It is the contractor's responsibility to seal the conduit with "Great Stuff" aerosol seal that prevents water and moisture penetration for ultimate protection. Contractor **MUST** use gel-filled wire nuts.

Maintenance

Scheduled maintenance must be carried out once a year on all lighting devices, regardless of appliance class and type of use. It must include the following operations:

- Periodically clean fixtures to remove dirt from gratings and screw heads.
- Check tightness of screws on various parts of the device.
- Check that all cable glands and cables are intact and tight. Check that the glass or plastic lens is intact, and replace it if broken or damaged.
- The internal components such as the ballast, driver, washers and screws must not show clear signs of oxidation or rust. Clear traces of rust and oxidation will indicate the presence of water inside the device.
- In the case of damage, the components must be replaced by original components or spare parts.

Anchor Cage Mounting

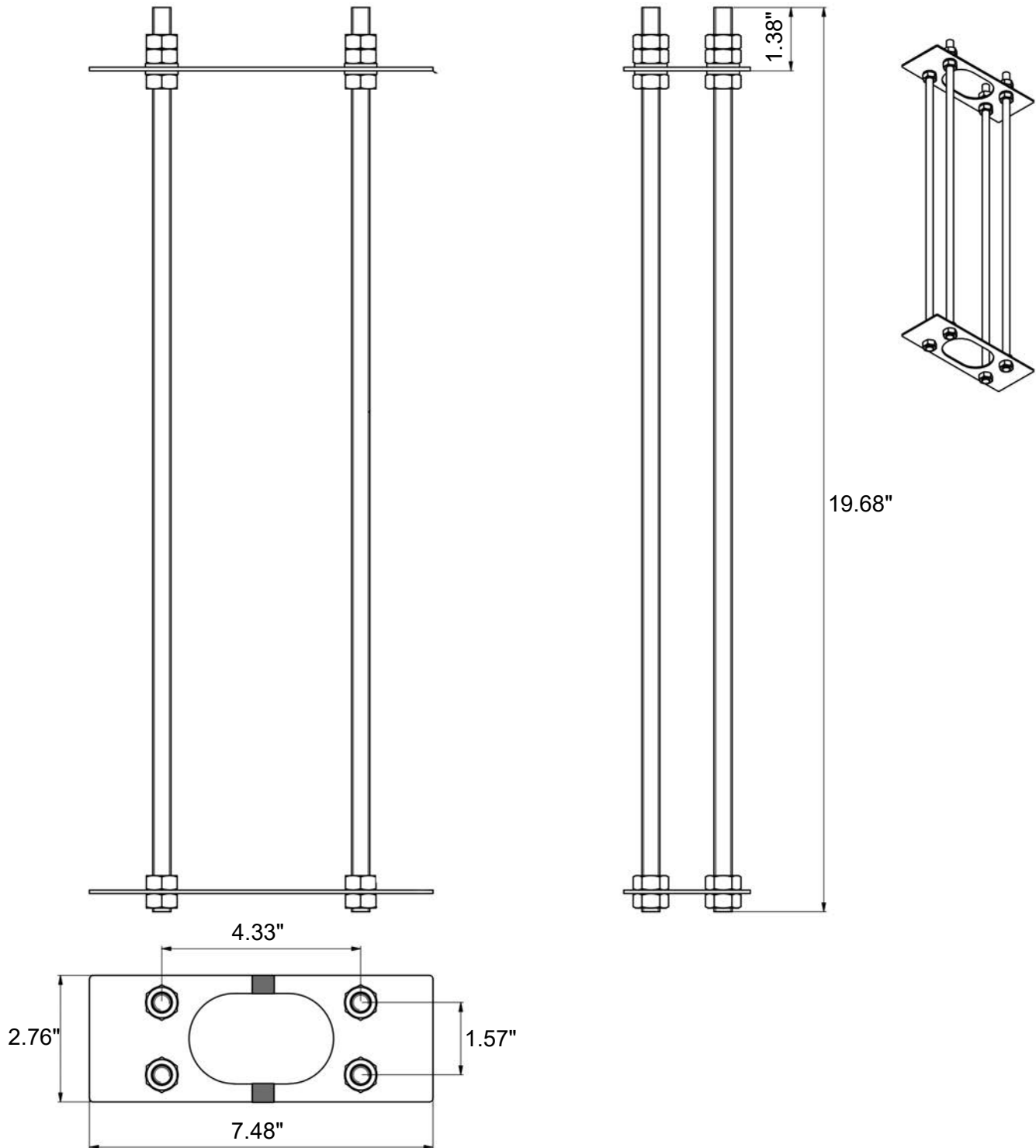

Anchor Cage Mounting

installation instructions

Attention!! When mounting anchor bolts:
 The red line indicates direction of the luminaire.
 Alingment of the luminaire depends on the positioning
 and proper assembly of the anchor bolts

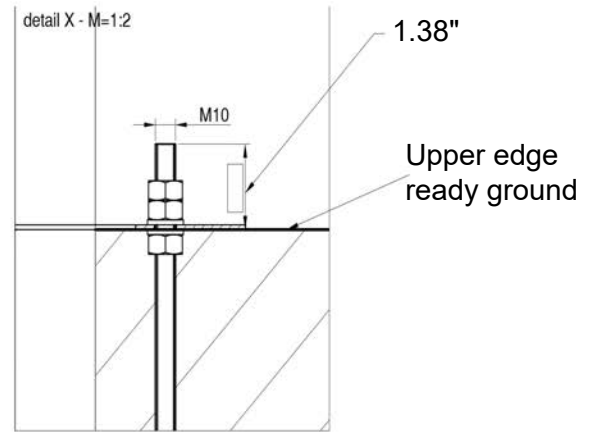
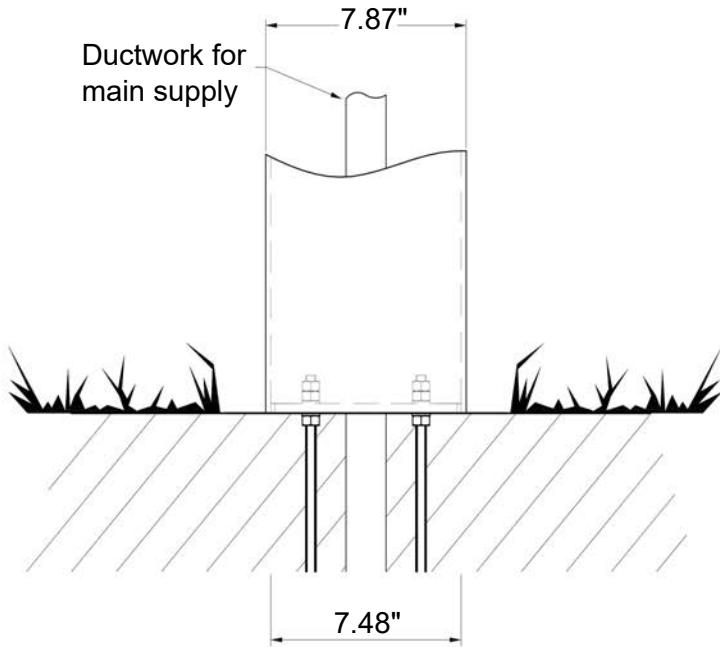

Flange Plate

Installation Template

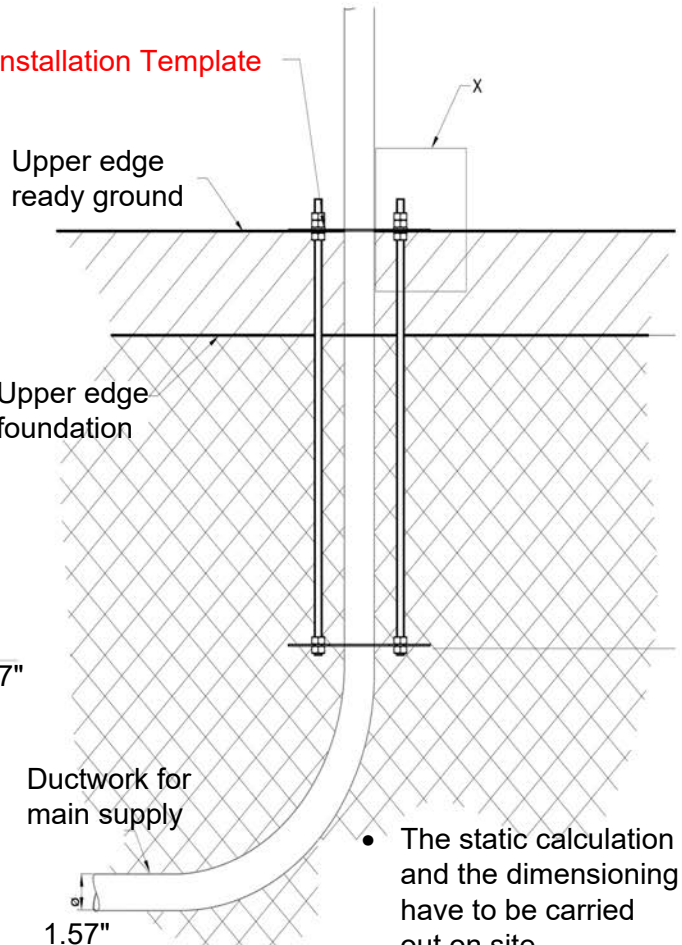

Installation Template

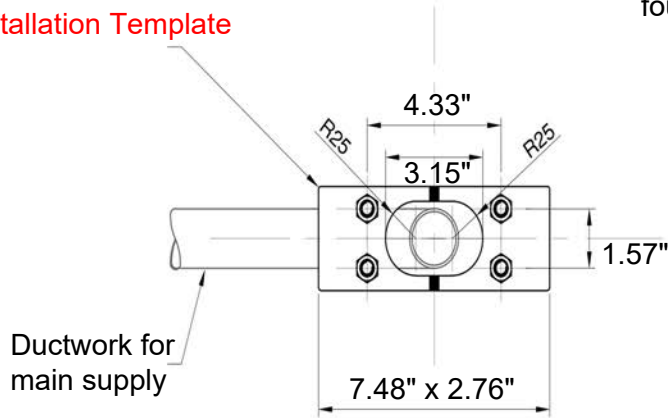

- The static calculation and the dimensioning have to be carried out on site.

Fixture Installation (Using Anchor Cage Mounting)

Bollard = 3.28 ft. (1 Meter)

- It is the contractor's responsibility to caulk around all seams of fixture to satisfy wet label requirements.

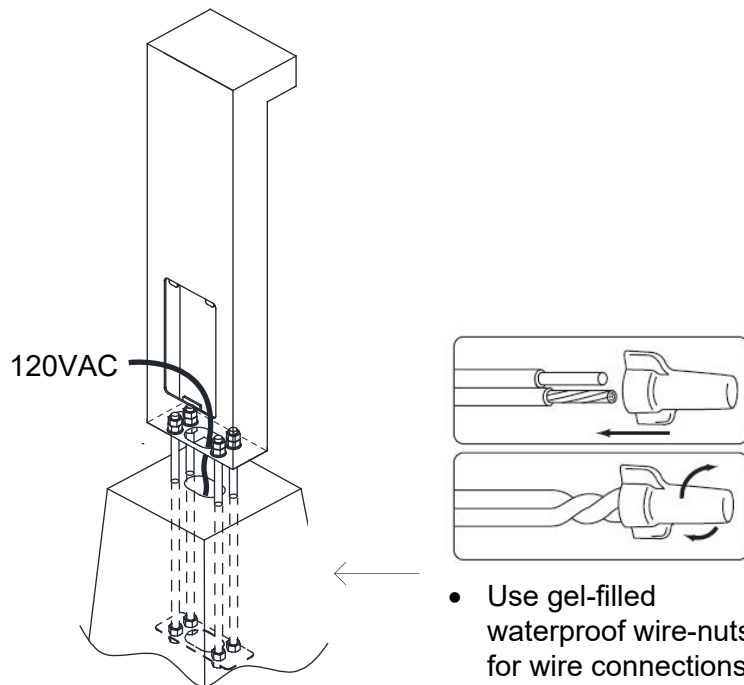
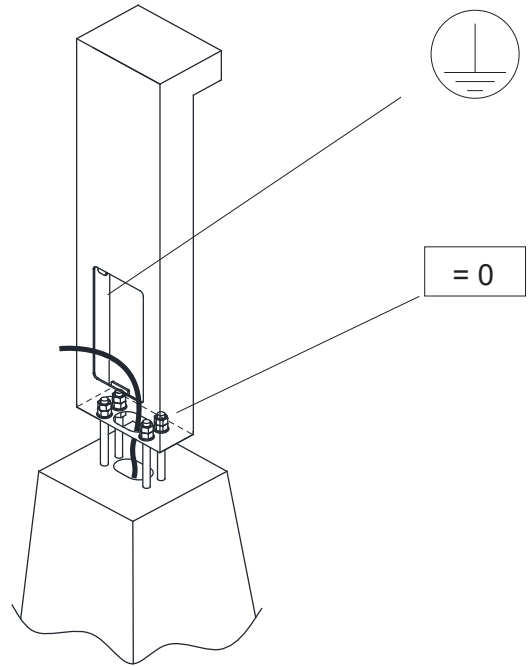
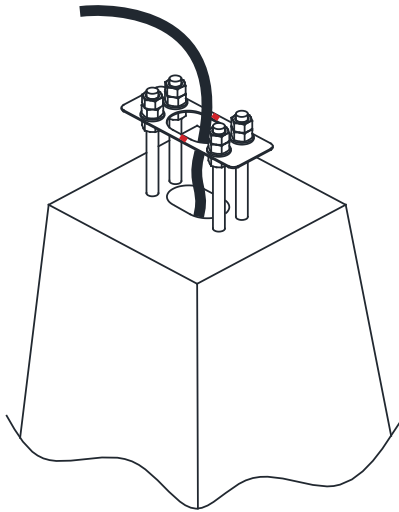

- Use gel-filled waterproof wire-nuts for wire connections.

Wiring

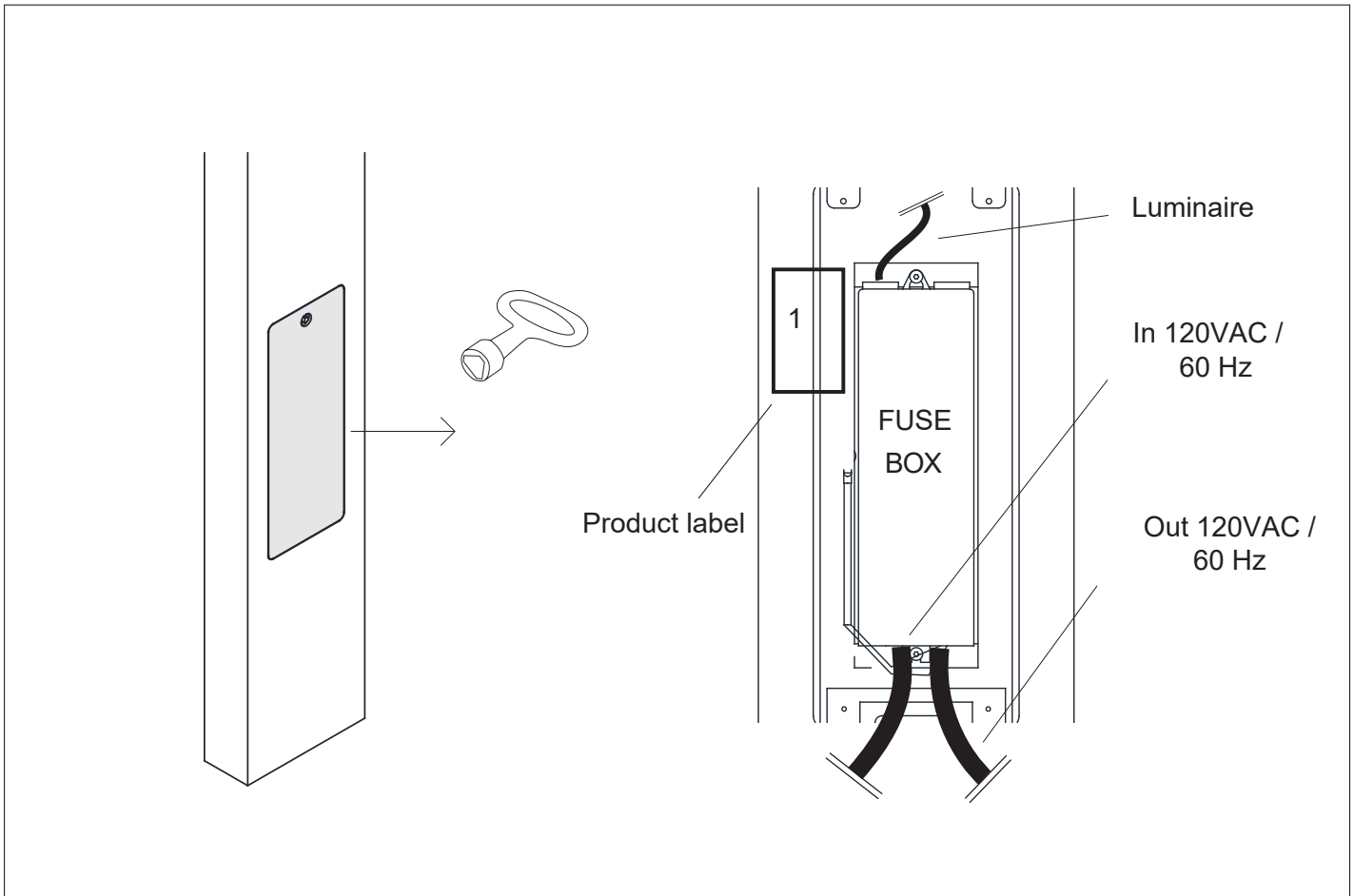

Connect the power supply cable and the lamp cable to the terminal board.

It is only necessary to connect the power cord to the Bollard version.

The product label is located on the clamping plate of the terminal board.

Clamp includes 2x6 A fuses (D01). The fuses are to be tested by an electrician and replaced if necessary.