



INSTRUCTIONS PERTAINING TO RISK OF FIRE OR INJURY TO PERSONS. READ ALL INSTRUCTIONS. IMPORTANT SAFETY INSTRUCTIONS. SAVE THESE INSTRUCTIONS.

DANGER - RISK OF SHOCK - DISCONNECT POWER BEFORE INSTALLATION! Please read all instructions before installation.

- Keep these instructions for future reference.
- Designplan is not responsible for fixtures installed without regard to these standards.
- Unauthorized alterations or tampering of product voids warranty.
- The main power connection must be in accordance with local electrical codes.
- Suitable for INDOOR applications.



Maintenance

Scheduled maintenance must be carried out once a year on all lighting devices, regardless of appliance class and type of use. It must include the following operations:

- Periodically clean fixtures to remove dirt from gratings and screw heads.
- Check tightness of screws on various parts of the device.
- Check that all cable glands and cables are intact and tight. Check that the glass or plastic lens is intact, and replace it if broken or damaged.
- The internal components such as the ballast, driver, washers and screws must not show clear signs of oxidation or rust. Clear traces of rust and oxidation will indicate the presence of water inside the device.
- In the case of damage, the components must be replaced by original components or spare parts.

USER MANUAL

This product is for lighting purposes only and:

- must not be exposed to heavy mechanical loads or severe contamination.
- must only be installed after checking its condition if the product is dirty or if it has become damp during storage.

Contains:



Technical data (FLAI lighting module):

Power: 4W — Volt: 5V — Rating voltage: 520 lumen — Lithium non replaceable battery included 18650 2600mAh*2
Charge: 5h — Battery life: 5h-10h — Class: III — Protection rating: IP54 — Net weight: 0.88 lbs
Color temperature: 2700K

CHARGE:

To correctly charge the product, place the charger on the magnetic concavity of the lighting module. Both the pins must be connected with the golden plates on the lighting module. If it is correctly charging, a red LED will turn on on the module screen. Once fully recharged, the LED will turn green.

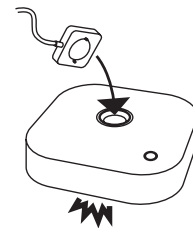

red light - charging
green light - fully charged

To correctly charge the lamp, we recommend that you:

1. Connect the USB to the adapter.
2. Magnetically attach the charger head to the concavity on the lighting module, placing the two pins on the golden plates.
3. Put the plug into the electrical socket.
4. When fully charged, disconnect the plug from the electrical socket and remove the charger.
Included: INPUT AC110-240V 50/60Hz - OUTPUT 5V 2A

INSTRUCTIONS:

Charge the battery before initial use. To turn the light ON and OFF, touch the circular mark on the edge of the module. The maximum load held by the magnetic joint is equivalent to 2.20 lbs. The magnetic elements in this product cannot be used for purposes other than the original one. Do not approach the magnetic element to products easily demagnetizable.

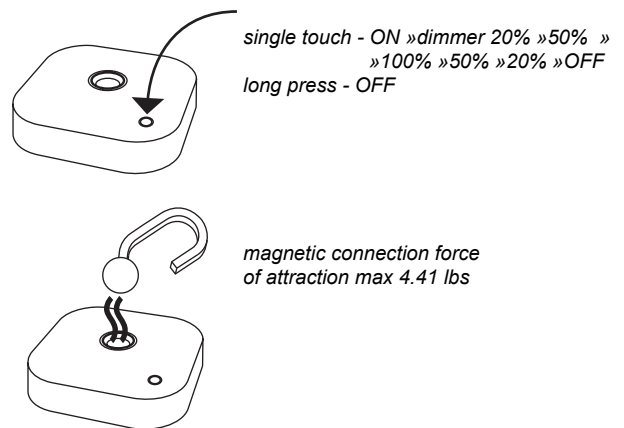

IMPORTANT:

The integrated battery has an overload protection function. Please refer to local laws for the proper disposal and recycling of the battery. The light source for this fitting must only be replaced by the manufacturer or its technical team.

MAINTENANCE:

Use a slightly-wet cotton cloth for cleaning. In case of defective charge, clean the golden plates with a soft cloth (do not use hard or abrasive materials). In case of malfunction or damage, please contact your supplier directly.

SUPPORTS:

Lantern cod. D9032



The support is suitable for outdoor use.
Material: painted steel.
The support surface for the lamp must not exceed a 15° tilt or it will fall.
Assembly instructions: fix the base with the supplied screws.

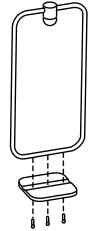

Floor cod. D9029



The support is suitable for outdoor use.
Material: painted steel.
The support surface for the lamp must not exceed a 15° tilt or it will fall.
Assembly instructions: insert the iron rod in the base and fix it with the supplied screw.

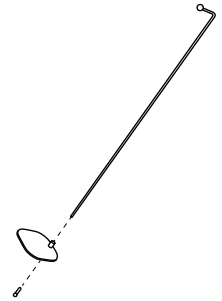

Multiple cod. D9035



The support is suitable for outdoor use.
Material: painted steel.
The support surface for the lamp must not exceed a 15° tilt or it will fall.
Assembly instructions: insert the iron rod in the base and fix it with the supplied screw. Check Rope Support (cod. D9031) information to set them on the rod.

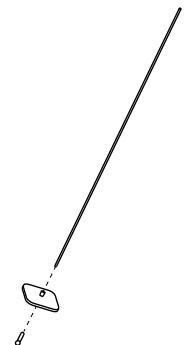

SUPPORTS:

Table cod. D9028

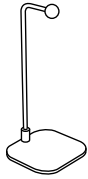

The support is suitable for outdoor use.
Material: painted steel.
The support surface for the lamp must not exceed a 15° tilt or it will fall.
Assembly instructions: insert the iron rod in the base and fix it with the supplied screw.



Central cod. D9027

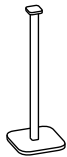

The support is suitable for outdoor use.
Material: painted steel.
The support surface for the lamp must not exceed a 15° tilt or it will fall.
Assembly instructions: fix the rod to the base with the supplied screw.

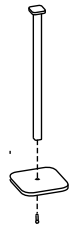

Rope cod. D9031



Screw coupling system for ropes and rod up to max 0.39" diameter.
Suitable for rigid and flexible structures.
Tighten and secure the grip before use.

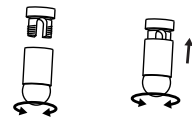

SUPPORTS:

Pendant cod. D9030



The support is suitable for outdoor use.
Designed for hanging lighting systems.
Material: painted steel.
Assembly: fix the canopy to the ceiling. Adjust cable length and clip it. Cut the exceeding cable length and close the canopy.
Provided cable length: 59.06"

Wall cod. D9034

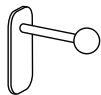

Assembly: fix the metal plate on the wall,
apply the cover and screw the rod with the
magnetic sphere.
Caution: Do not use it to hang things other
than FLAI lighting module.

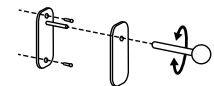

CAUTION:

We recommend reading the manual before using the product. Keep these instructions for future reference. Do not disassemble, modify or try to repair this fitting. Any change or modification to the light fitting can null the manufacturer's guarantee. Do not place this fitting on warm or hot surfaces such as ovens, microwaves, heaters or radiators. The battery can explode if overheated. Avoid exposure to either very high or very low temperatures. Use the device between temperatures of -20°C and 40°C. Extreme temperatures can cause deformations and reduce the charging capacity and life of the battery. Neither is it recommended to expose the light fitting to direct sunlight for long periods. Avoid charging the battery for periods of week or longer, over-charging can reduce its useful life. Over time an unused battery will loose its charge and must be recharged to power the light fitting. Disconnect the charger from the mains when not in use.

The symbol on the lighting module indicates that the product should not be placed in municipal waste. The lighting source cannot be substituted by the customer.