



INSTRUCTIONS PERTAINING TO RISK OF FIRE OR INJURY TO PERSONS. READ ALL INSTRUCTIONS. IMPORTANT SAFETY INSTRUCTIONS. SAVE THESE INSTRUCTIONS.

DANGER - RISK OF SHOCK - DISCONNECT POWER BEFORE INSTALLATION! Please read all instructions before installation.

- Keep these instructions for future reference.
- Must be installed by a qualified electrician in accordance with national and local standards. Designplan is not responsible for fixtures installed without regard to these standards.
- Unauthorized alterations or tampering of product voids warranty.
- The main power connection must be in accordance with local electrical codes.
- Suitable for OUTDOOR applications.



Electrical Connections:

- LED lights must be **connected in parallel** respecting polarities.
- **CHOOSE POWER SUPPLY ACCORDINGLY.** Please consider the voltage through which fixtures are fed as well as the max power consumption.
- **Connect power only if all the fixtures are connected.**
- The power supplies **MUST** be installed in aerated rooms, far from heat sources. Overworking or lack of air circulation will not permit natural dissipation.
- Use only Class 2 type electronic power supply.
- Never use switches on secondary circuit.

ATTENTION: For Wall/Ceiling - It is the contractor's responsibility to caulk around all the edges between the fixture and the mounting surface to satisfy wet label requirements.

Maintenance

Scheduled maintenance must be carried out once a year on all lighting devices, regardless of appliance class and type of use. It must include the following operations:

- Periodically clean fixtures to remove dirt from gratings and screw heads.
- Check tightness of screws on various parts of the device.
- Check that all cable glands and cables are intact and tight. Check that the glass or plastic lens is intact, and replace it if broken or damaged.
- The internal components such as the ballast, driver, washers and screws must not show clear signs of oxidation or rust. Clear traces of rust and oxidation will indicate the presence of water inside the device.
- In the case of damage, the components must be replaced by original components or spare parts.

Fixture Installation

installation instructions

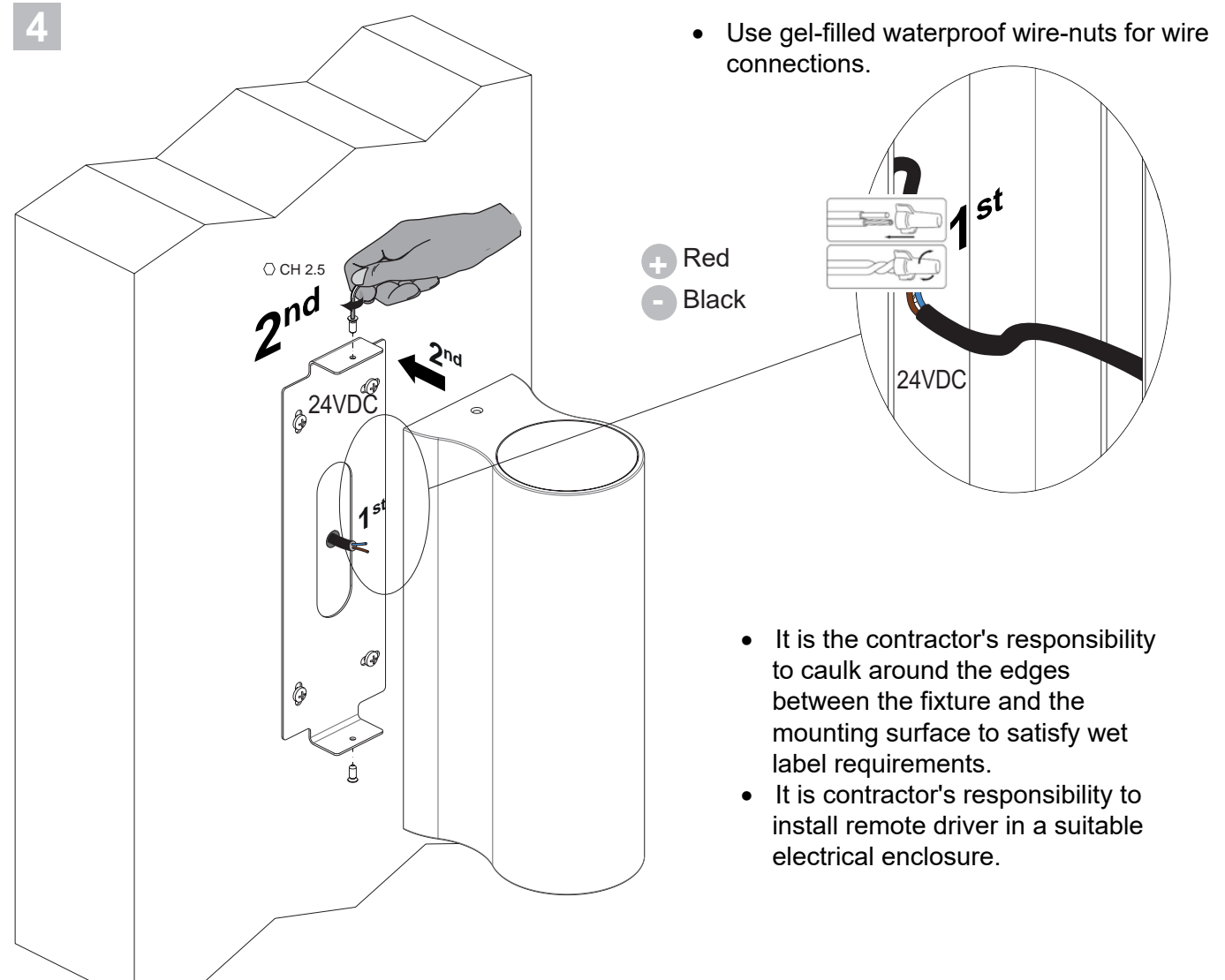
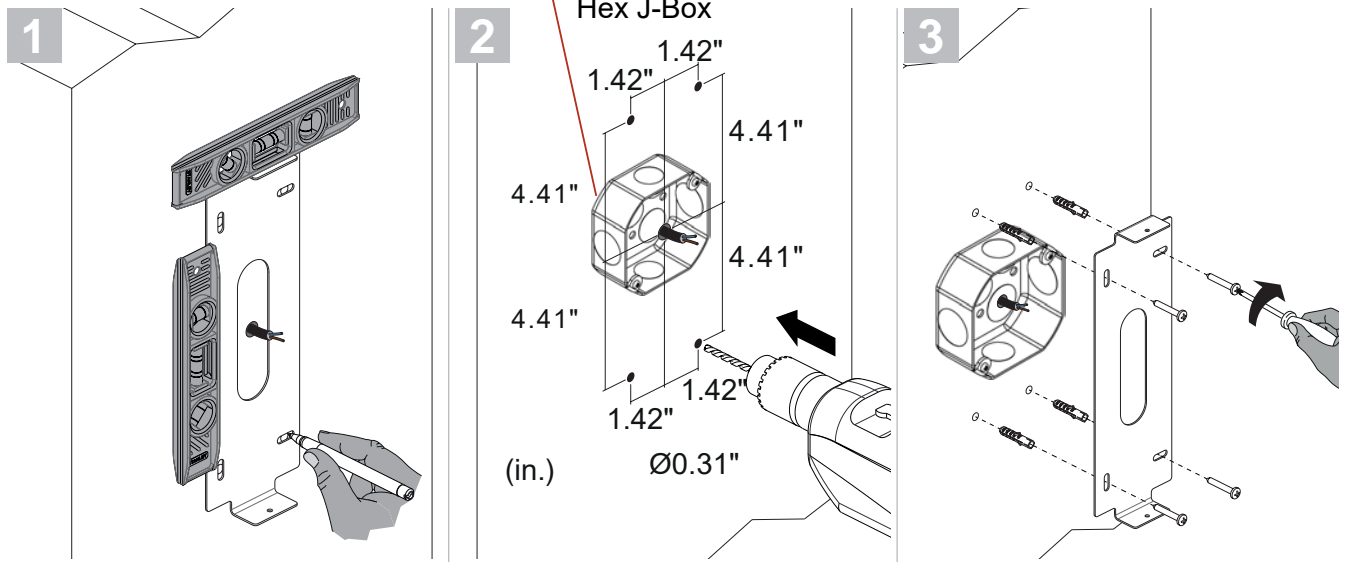

- It is the contractor's responsibility to caulk around the edges between the fixture and the mounting surface to satisfy wet label requirements.
- It is contractor's responsibility to install remote driver in a suitable electrical enclosure.

5

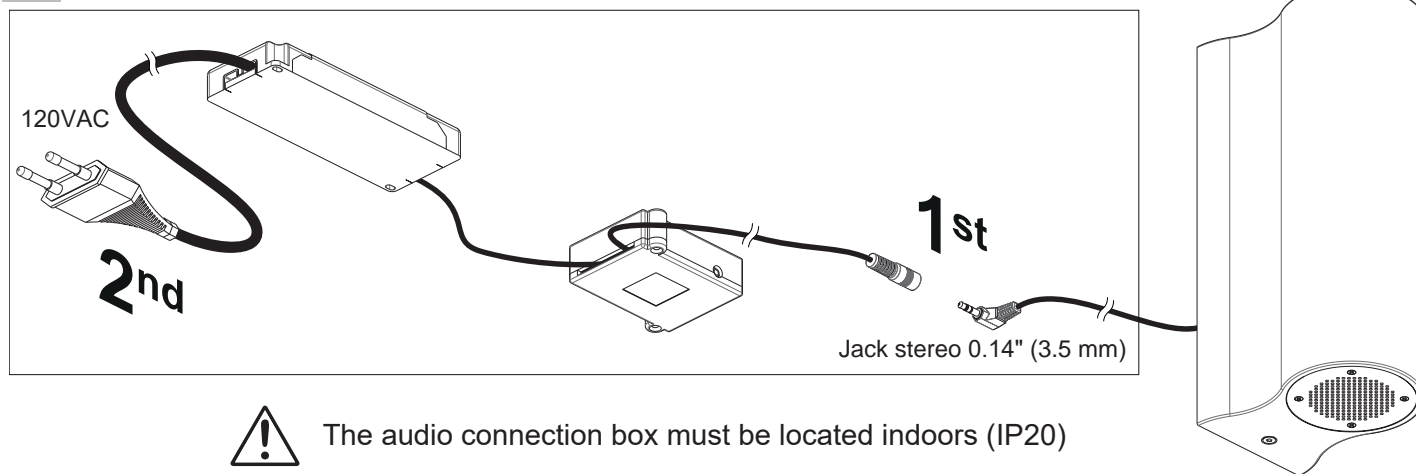

BLUETOOTH 3.0 AUDIO CONTROL KIT WITH POWER SUPPLY UNIT AND AMPLIFIER (for Alexa and Google voice-control systems)

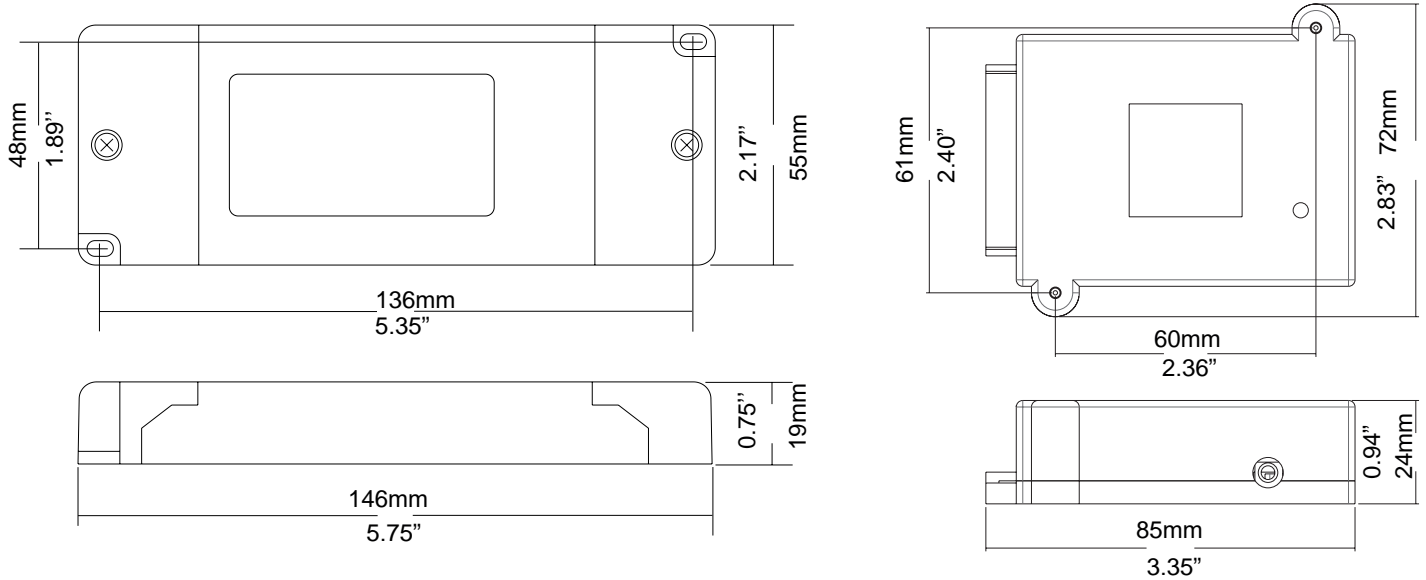

- Rated voltage: 120VAC
- Frequency: 60 Hz

Powerful stereo amplifier module based on integrated Texas Instruments TPA3118 class D capable of delivering up to 30W per channel. The wide power range (8–26VDC) makes it extremely versatile for multiple installations. It has a linear analog input on a 3.5-mm jack plug and Bluetooth connectivity, allowing audio streaming from devices such as smartphones, tablets, and PCs.

Technical specifications:

- Type: Stereo Bluetooth Digital Amplifier Board (Bluetooth version 4.2)
- Integrated circuit: TPA3118
- Output power: 2x30W
- Impedance: 4, 6, 8 Ohm
- Input voltage: 8 -26 VDC constant current

As soon as the TPA3118 module is powered on for the first time, Bluetooth is active on it. A high-brightness blue LED at the top of the circuit indicates that the Bluetooth is operating.

The LED flashes quickly (>1s) while the module searches for the Bluetooth source; it stays solid blue once the connection is established; it flashes slowly (<1s) during the audio playback in Bluetooth streaming mode.

The TPA3118 module is recognised under the name “Xpecial Audio”; the connection is confirmed by the LED’s change of state from flashing to solid.

The auxiliary input on the jack is always active, even during Bluetooth streaming; we therefore recommend disassociating the device connected via Bluetooth (and vice versa) to avoid overlaps and unwanted audio distortions.

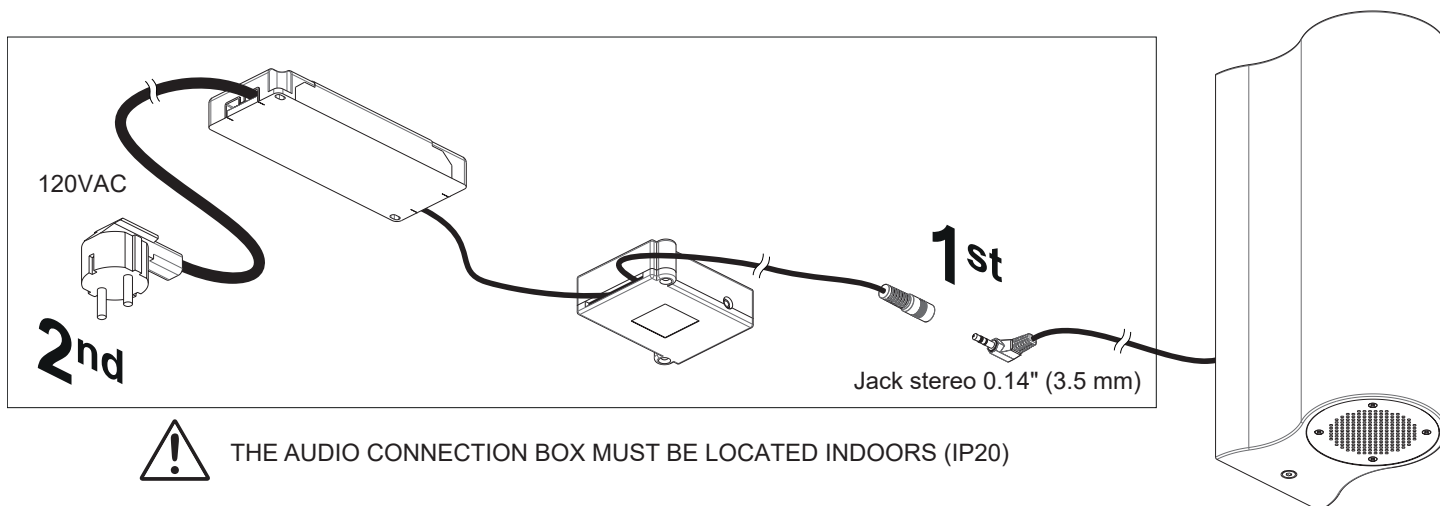

Wiring Diagram

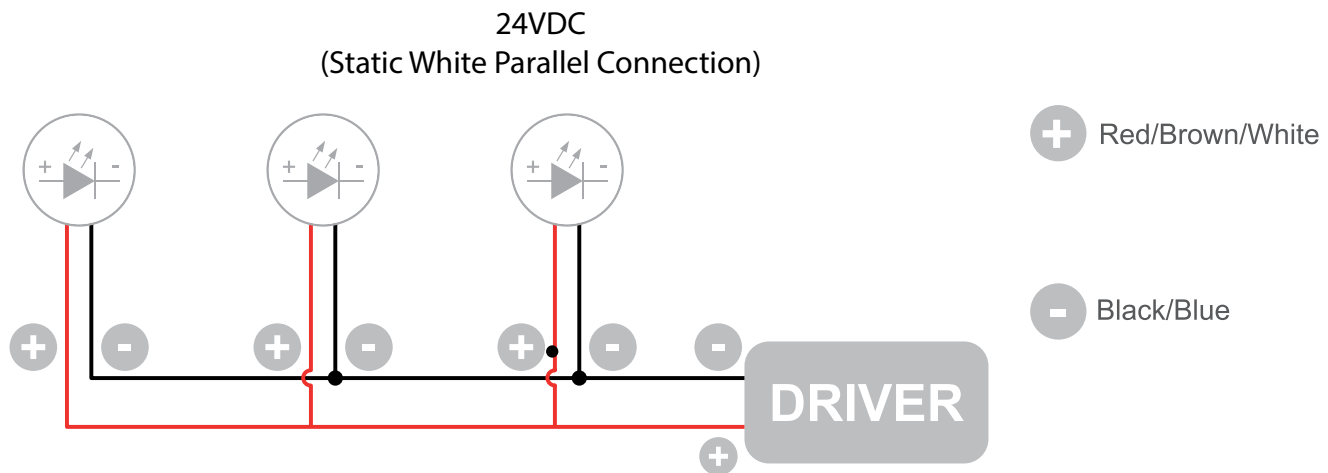

The individual lamps must be connected in parallel. Only power up the system once all the lamps have being connected.

- Only power up the system once all the lamps are connected. Connecting an individual lamp to an active power supply may cause the lamp to break due to over-voltage.
- Lamps and power supply units must be installed in well-ventilated boxes or locations to allow a natural heat diffusion and avoid the devices overheating.
- On the power system, install a surge protection device to reduce the intensity of any voltage spikes to protect the lighting fixtures from the risk of damage.
- Fixture NOT suitable for covering with thermally insulating material.