

Kasandra is an outdoor LED bollard with a 9.8" long slanted head that is offered in 2 different heights: nominal 20.0" or 35.5". It is offered in static white, tunable white or RGB with 5 standard finishes.

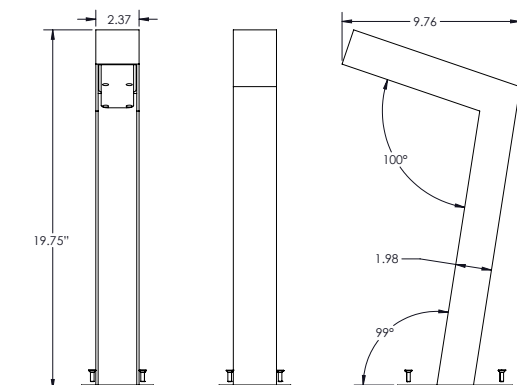

MADE IN THE U.S.A.

Fixture Dimensions



TECHNICAL DATA

Wattage	12W (Static White, Tunable White) 13W (RGB)
Power Supply	Integral 120VAC (Static White only) Remote, not included - See page 2 (350mA RGB, 500mA Tunable, 350mA Static White)
Dimming	Dimming based on remote power selected. 0-10V Dimming - Integral (Static White Only)
Construction	Body: Aluminum Lens: Clear
CCT	2700K, 3000K, 4000K (static white) 2700K-5000K (tunable white) RGB
BUG Rating	B0-U1-G0
CRI	>80
Delivered Lumens	1000 lm (Static 3000K)
Efficacy	83.3 lm/W (Static 3000K)
Optics	180°
Finishes	6 Standard, Custom RAL on request
Fixture Dimensions	2.4" w x 9.8" head length x 19.8" or 35.4" pole h
IP Rating	IP65

ORDERING INFORMATION

Example: AL-L-19-40-02-C-0. Accessories / Power Supplies ordered separately.

AL-L	-		-		-		-	0
Model #	Height	CCT	Finish	Dimming	Options			
AL-L	19 - 19.8" 35 - 35.4"	27 - 2700K 30 - 3000K 40 - 4000K RG - RGB TW - Tunable White (2700K-5000K)	11 - White Suede 02 - Black Suede 03 - Gray 18 - Tex. Bronze TS - Silver DH - Anthracite C - Custom	R - <u>Remote</u> Driver (for Tunable White, RGB & Static White) L - Lutron Dimming <u>Remote</u> Driver (Static White) C - Integral 120VAC - 0-10V Dimming For Static White Only <div>See page 2 for remote power supply options</div>	0 - None BL - Blade Louvre			

Job Name/Date:

Fixture Type Designation:

SUGGESTED POWER SUPPLIES

Tunable White - 500mA Remote Drivers

Part Number	Description	Input/Output	# of Fixtures
PPLT00548-P	0-10V Dimming (to 10%)	120-277VAC to 500mA, 50W, Class 2	1-2

RGB - 350mA Remote Drivers

Part Number	Description	Input/Output	# of Fixtures
PPLT00244-P	DMX / RDM (Must advise DMX addresses if not using RDM)	120-277VAC to 350mA, 50W, Class 2	1-4
PPLT00129-P	DMX / RDM (Field Addressable)	120-277VAC to 350mA, 100W, Class 2	1-4

Lutron Compatible - Static White - 350mA Remote Driver

Part Number	Option	Lutron SKU	Dim Range	Description	Input/Output	# of Fixtures
PPLT00516	L3DAE / L3DA3W	L3DA	100%-1%	Hi-Lume™ 1% EcoSystem™ or 1% 3-Wire LED Driver	120-277VAC to 350mA, 13W, Class 2	1-1
PPLT00271	LTEA2W	LTEA	100%-1%	Hi-Lume™ 1% 2-Wire LED Driver (120V forward phase only)	120VAC to 350mA, 13W, Class 2	1-1

For other power supply options consult factory.

ACCESSORIES - Installation**PHOTOMETRIC DATA**

Coming Soon

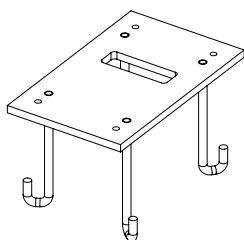

AM-00014
Mounting Base
Assembly

Job Name/Date:

Fixture Type Designation: