

MIN / MAX - CURVA IP68



datasheet

SUITABLE FOR USE IN FOUNTAINS or POOLS

MIN / MAX Curva is a circular, IP68-rated LED luminaire for flush installation in fountains or swimming pools, both indoors or outdoors - submersible to 1 m (3.28'). It is available in 5 different diameter sizes with sandblasted or antislip glass. Pressure switch on request. Can be ordered in aluminum IP67 version for in-grade non-fountain use.



Fixture Dimensions - See page 2

TECHNICAL DATA

Wattage / Input	20W (24VDC)
Power Supply	Remote, not included. See page 2.
Construction	Body: Stainless Steel Lens: Extra Clear Tempered Glass Cable Length: 1.64'
CCT	2700K, 3000K, 4000K (RGBW or Tunable White on request)
BUG Rating	
Delivered Lumens	1520-1760 lm (3000K)
Efficacy	76-88 lm/W (3000K)
Optics	Diffuse
Finishes	Sandblasted or Antislip Glass
Fixture Dimensions	46.4" l x 3.94" w x 1.57" h (various curvatures)
Color Consistency	3-Step MacAdam
IP Rating	IP68 - Submersible to 5 m (16.4')
Impact Resistance	IK10
Driveover Capacity	Up to 11,000 lbs

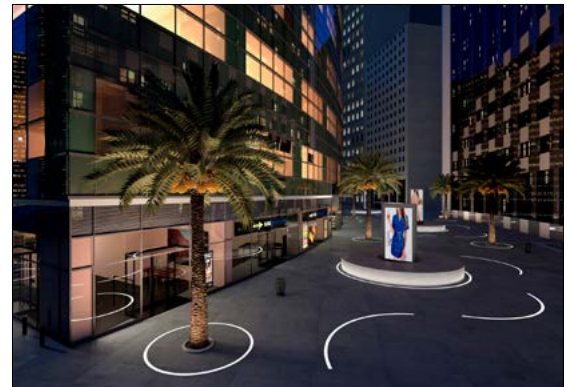

ORDERING INFORMATION

Example: LM07.104891.US.60.DI.BP. Accessories / Power Supplies ordered separately.

<input type="text"/>	<input type="text"/>	<input type="text"/>	<input type="text"/>
Model No.	Finish	Optic	CCT
LM07.104849.US (CU1)	60 - Sandblasted	DI - Diffuse	BC - 2700K
LM07.104851.US (CU2)	A1 - Antislip		BP - 3000K
LM07.104853.US (CU3)			BF - 4000K
LM07.104855.US (CU4)			
LM07.104889.US (CU5)			
LM07.104891.US (CU6)			

Job Name/Date:

Fixture Type Designation:

MIN / MAX - CURVA IP68



SUITABLE FOR USE IN FOUNTAINS or POOLS

datasheet

FIXTURE DIMENSIONS

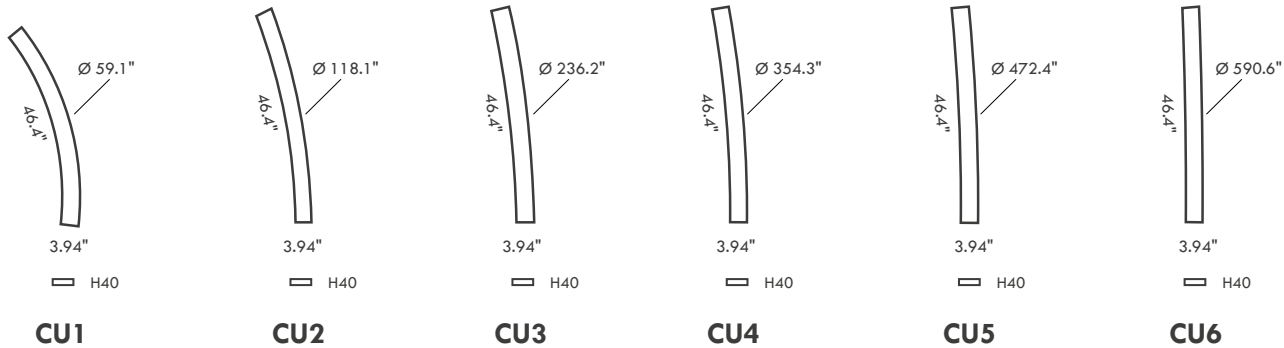

SUGGESTED POWER SUPPLIES

24VDC - FOR USE WITH FOUNTAIN / WATER FEATURES

Part Number	Description	Input/Output	# of Fixtures					
			CU1	CU2	CU3	CU4	CU5	CU6
FPV-100000024	Non-Dim	120-277VAC to 24VDC, 100W, Class 2, NEMA 4	1-4	1-4	1-4	1-4	1-4	1-4
FPV-100100024	0-10V Dimming to 1.0%	120-277VAC to 24VDC, 100W, Class 2, NEMA 4	1-4	1-4	1-4	1-4	1-4	1-4

For other power supply options consult factory.

ACCESSORIES - Installation



LM20.104866 (CU1)
 LM20.104868 (CU2)
 LM20.104870 (CU3)
 LM20.104872 (CU4)
 LM20.104881 (CU5)
 LM20.104883 (CU6)
 IP68 Housing



LM20.104879
 Pair of Closing End Caps



LM20.104464
 Light Source Extraction Tool Kit



LM20.104813
 Pair of joints for Curva to Curva continuous line

LM20.104873
 Pair of joints for Curva to Linea continuous line

Job Name/Date:

Fixture Type Designation:

MIN / MAX - CURVA IP68



SUITABLE FOR USE IN FOUNTAINS or POOLS

datasheet

PHOTOMETRIC DATA

Job Name/Date:

Fixture Type Designation: