

# MIN / MAX - CURVA IP68

## SUITABLE FOR USE IN FOUNTAINS or POOLS

MIN / MAX Curva is a circular, IP68-rated LED luminaire for flush installation in fountains or swimming pools, both indoors or outdoors - submersible to 1 m (3.28'). It is available in 5 different diameter sizes with sandblasted or antislip glass. Pressure switch on request. Can be ordered in aluminum IP67 version for in-grade non-fountain use.



Fixture Dimensions - See page 2

### TECHNICAL DATA

<b>Wattage / Input</b>	20W
<b>Power Supply</b>	Remote, not included. Consult Factory.
<b>Construction</b>	Body: Stainless Steel Lens: Extra Clear Tempered Glass Cable Length: 1.64'
<b>CCT</b>	2700K, 3000K, 4000K (RGBW or Tunable White on request)
<b>BUG Rating</b>	
<b>Delivered Lumens</b>	1520-1760 lm (3000K)
<b>Efficacy</b>	76-88 lm/W (3000K)
<b>Optics</b>	Diffuse
<b>Finishes</b>	Sandblasted or Antislip Glass
<b>Fixture Dimensions</b>	46.4" l x 3.94" w x 1.57" h (various curvatures)
<b>Color Consistency</b>	3-Step MacAdam
<b>IP Rating</b>	IP68 - Submersible to 5 m (16.4')
<b>Impact Resistance</b>	IK10
<b>Driveover Capacity</b>	Up to 11,000 lbs

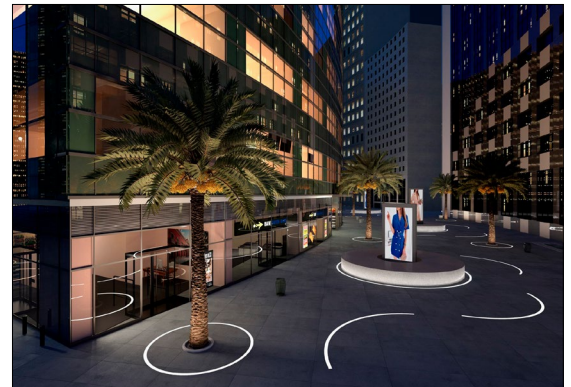

### ORDERING INFORMATION

Example: LM07.104891.US.60.DI.BP. Accessories / Power Supplies ordered separately.

<input type="text"/>	<input type="text"/>	<input type="text"/>	<input type="text"/>
<b>Model No.</b>	<b>Finish</b>	<b>Optic</b>	<b>CCT</b>
LM07.104849.US (CU1)	60 - Sandblasted	DI - Diffuse	BC - 2700K
LM07.104851.US (CU2)	A1 - Antislip		BP - 3000K
LM07.104853.US (CU3)			BF - 4000K
LM07.104855.US (CU4)			
LM07.104889.US (CU5)			
LM07.104891.US (CU6)			

Job Name/Date:

Fixture Type Designation:

# MIN / MAX - CURVA IP68

LIGHT ATMOTION  
LAMBDA  
IDEAS BECOMING LIGHT

MINIMA  
MAXIMUM

designplan®

SUITABLE FOR USE IN FOUNTAINS or POOLS

datasheet

## FIXTURE DIMENSIONS

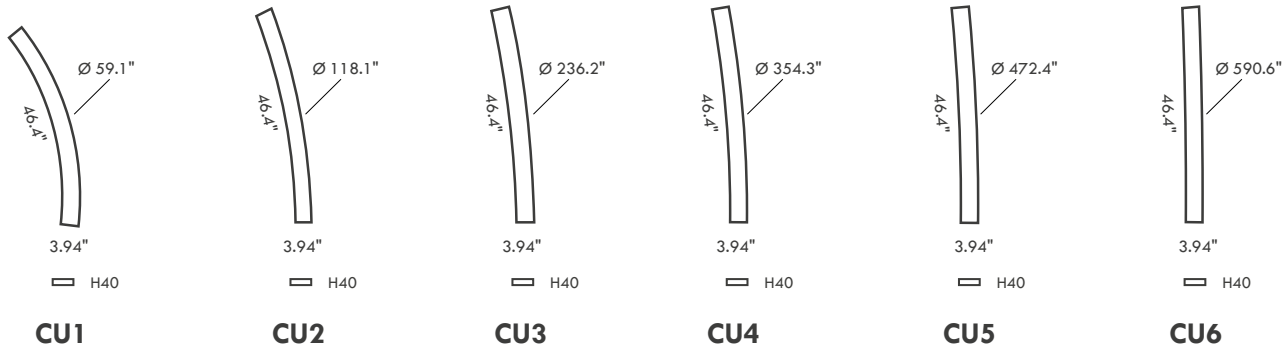

## SUGGESTED POWER SUPPLIES

Consult Factory

## ACCESSORIES - Installation



LM20.104866 (CU1)  
LM20.104868 (CU2)  
LM20.104870 (CU3)  
LM20.104872 (CU4)  
LM20.104881 (CU5)  
LM20.104883 (CU6)  
IP68 Housing



LM20.104879  
Pair of Closing End Caps



LM20.104464  
Light Source Extraction Tool Kit



LM20.104813  
Pair of joints for Curva to  
Curva continuous line

LM20.104873  
Pair of joints for Curva to  
Linea continuous line

Job Name/Date:

Fixture Type Designation:

# MIN / MAX - CURVA IP68

LIGHTATTMOTION  
LAMBDA minima MAXIMUM  
IDEAS BECOMING LIGHT

designplan®

SUITABLE FOR USE IN FOUNTAINS or POOLS

datasheet

## PHOTOMETRIC DATA

*Job Name/Date:*

*Fixture Type Designation:*