

MIN / MAX Triangolo 2 are triangular, IP67-rated LED luminaire for flush installation on floors in indoor or outdoor areas. Triangolo is available in 2 different triangle shapes - 5 sizes each with antislip or sandblasted glass. Driveover rated up to 11,000 lbs. Pressure switch on request. Can be ordered in IP68 stainless steel version suitable for fountains - see Fountain Lighting section.

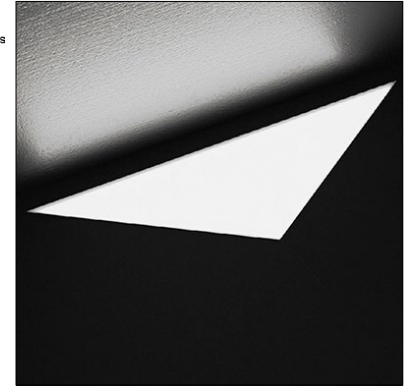

Fixture Dimensions - See page 2

TECHNICAL DATA

Wattage / Input	9.6W, 27W, 40W, 54W, 67W
Power Supply	Remote, not included. Consult Factory.
Construction	Body: Anticorodal Aluminum Protected by 25 Micron Lens: Extra Clear Tempered Glass Cable Length: 1.64'
CCT	2700K, 3000K, 4000K (RGBW or Tunable White on request)
BUG Rating	B0-U0-G0
Delivered Lumens	1360-5600 lm (3000K)
Efficacy	83-92 lm/W (3000K)
Optics	Diffuse
Finishes	Antislip or Sandblasted Glass
Fixture Dimensions <i>(all are 1.6" h)</i>	9.8" x 9.8" x 15.9" (T6) 19.7" x 19.7" x 31.9" (T7) 29.5" x 29.5" x 47.3" (T8) 39.4" x 39.4" x 63.8" (T9) 49.2" x 49.2" x 79.7" (T10)
Color Consistency	3-Step MacAdam
IP Rating	IP67
Impact Resistance	IK10
Driveover Capacity	Up to 11,000 lbs

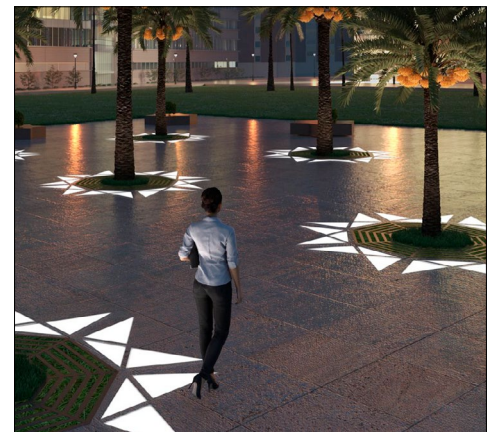

ORDERING INFORMATION

Example: LM07.103826.A1.DI.BP.US. Accessories / Power supplies sold separately.

<input type="text"/>	<input type="text"/>	<input type="text" value="DI"/>	<input type="text"/>
Model No.	Finish	Optic	CCT
LM07.103826.US (T6 - 9.6W)	A1 - Antislip Glass	DI - Diffuse	BC - 2700K
LM07.103827.US (T7 - 27W)	60 - Sandblasted Glass		BP - 3000K
LM07.103828.US (T8 - 40W)			BF - 4000K
LM07.103887.US (T9 - 54W)			
LM07.103888.US (T10 - 67W)			

Job Name/Date:

Fixture Type Designation:

FIXTURE DIMENSIONS

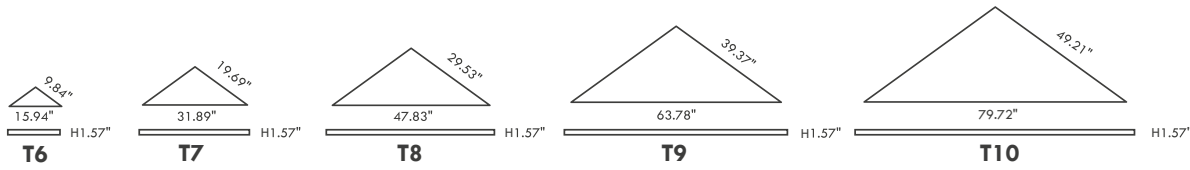

SUGGESTED POWER SUPPLIES

Consult Factory

Job Name/Date:

Fixture Type Designation:

ACCESSORIES - Installation



H 3.94"



- LM20.103947** (T6 - 10.2" x 16.3" x 3.9" h)
 - LM20.103948** (T7 - 20.0" x 32.2" x 3.9" h)
 - LM20.103949** (T8 - 29.8" x 48.1" x 3.9" h)
 - LM20.103950** (T9 - 39.7" x 64.1" x 3.9" h)
 - LM20.103951** (T10 - 49.5" x 80.0" x 3.9" h)
- IP67 Housing

- LM20.104765**
Light Source Extraction Tool Kit
(For T1, T2, T6, T7)

- LM20.104812**
Light Source Extraction Tool Kit
(For T3, T4, T5, T8, T9, T10)

PHOTOMETRIC DATA

T1-T10

Maximum Candela = 268.3

— C0 - C180
— C90 - C270

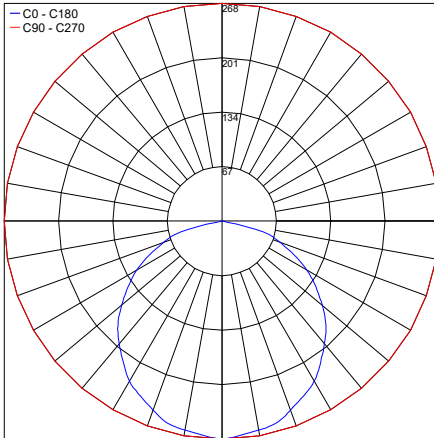

PHOTOMETRIC FILENAME : T1-T10-all the same.IES

Job Name/Date:

Fixture Type Designation: