

# MORPHIS 1 WALL

Morphis 1 Wall is a wall mounted LED lamp that creates the perfect solution for many situations and environments. It comes with a transparent or opal polycarbonate lens with diffuse optics and is available in 6 standard finishes.



## TECHNICAL DATA

<b>Wattage</b>	18W
<b>Power Supply</b>	Remote 500mA, not included. See page 2.
<b>Construction</b>	Body: Die-Cast Aluminum Lens: Extra-Clear or Opal Polycarbonate
<b>CCT</b>	2700K, 3000K, 4000K
<b>BUG Rating</b>	B1-U2-G1 (Extra Clear) B0-U3-G1 (Opal)
<b>CRI</b>	>90
<b>Delivered Lumens</b>	750 lm (3000K, Extra Clear Diffuser) 600 lm (3000K, Opal Diffuser)
<b>Efficacy</b>	42 lm/W (3000K, Extra Clear Diffuser) 34 lm/W (3000K, Opal Diffuser)
<b>Optics</b>	Diffuse
<b>Finishes</b>	6 Standard, See Below
<b>Fixture Dimensions</b>	14.5" l x 11.0" w x 7.7"
<b>Lumen Maintenance</b>	L80, B15 >60,000hrs (Ta 40°C)
<b>Color Consistency</b>	3-Step MacAdam
<b>IP Rating</b>	IP65
<b>Impact Resistance</b>	IK08

Fixture Dimensions

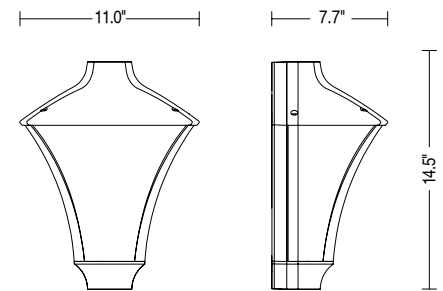

## ORDERING INFORMATION

Example: LNMO30PARDHBBZP.US. Accessories / Power Supplies ordered separately.

LNMO3			BBZ		US
<b>Model No.</b>	<b>Optics</b>	<b>CCT</b>	<b>BBZ</b>	<b>Finish</b>	<b>US</b>
LNMO3	0PARD - Extra Clear Diffuse 3PARD - Opal Diffuse	Y - 2700K H - 3000K N - 4000K	BBZ	G - Black S - Black/Copper P - Black/Green R - Black/Silver L - Graphite V - Oxide	US

Job Name/Date:

Fixture Type Designation:

## SUGGESTED POWER SUPPLIES

500mA

Part Number	Description	Input/Output	# of Fixtures
<a href="#">PPLT00465-P</a>	0-10V Dimming (to 1.0%)	120-277VAC to 500mA, 20W, Class 2, DAMP	1-1
<a href="#">PPLT00527</a>	Phase Dim (120V only)	120VAC to 500mA, 25W, Class 2, IP66	1-1
<a href="#">PPLT00262</a>	Leading / Trailing Edge Dimming to 10% (120V only)	120-277VAC to 500mA, 32W, Class 2	1-1
<a href="#">PPLT00309-P</a>	0-10V Dimming (to 0.1%)	120-277VAC to 500mA, 50W, Class 2	1-1
<a href="#">PPLT00538-P</a>	0-10V Dimming (to 0.1%)	120-277VAC to 500mA, 100W, Class 2	1-1 (1-4)

For other power supply options consult factory.

## ACCESSORIES - Installation

**00596**

Corner bracket

## PHOTOMETRIC DATA

Note: All photometric data is 3000K

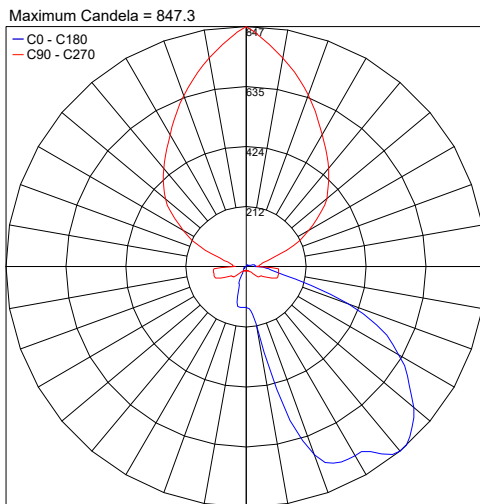

PHOTOMETRIC FILENAME : MORPHIS 1 EXTRA CLEAR MO30PARD\_B10.IES

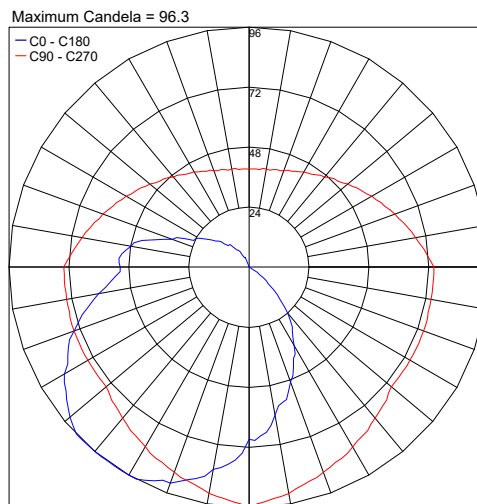

PHOTOMETRIC FILENAME : MORPHIS 1 OPAL MO33PARD\_B10.IES

Job Name/Date:

Fixture Type Designation: