



INSTRUCTIONS PERTAINING TO RISK OF FIRE OR INJURY TO PERSONS. READ ALL INSTRUCTIONS. IMPORTANT SAFETY INSTRUCTIONS. SAVE THESE INSTRUCTIONS.

DANGER - RISK OF SHOCK - DISCONNECT POWER BEFORE INSTALLATION! Please read all instructions before installation.

- Suitable for **INDOOR** applications **ONLY**.



Maintenance

Scheduled maintenance must be carried out once a year on all lighting devices, regardless of appliance class and type of use. It must include the following operations:

- Periodically clean fixtures to remove dirt from gratings and screw heads.
- Check tightness of screws on various parts of the device.
- Check that all cable glands and cables are intact and tight. Check that the glass or plastic lens is intact, and replace it if broken or damaged.
- The internal components such as the ballast, driver, washers and screws must not show clear signs of oxidation or rust. Clear traces of rust and oxidation will indicate the presence of water inside the device.
- In the case of damage, the components must be replaced by original components or spare parts.

(ALL ABOVE IF APPLICABLE)

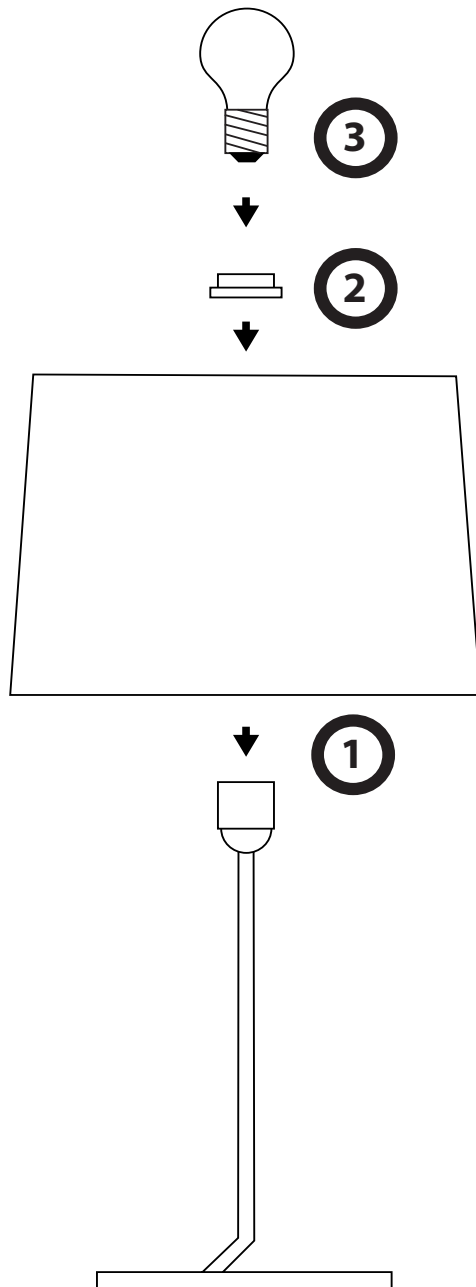

Safety Instructions The lamp is for domestic interior use only. Do not install the lamp on damp surfaces or anywhere else that might conduct current and cause electric shock. Always use the recommended bulb. The manufacturer declines all responsibilities in case of bad use of the lamp.

Technical Characteristics AX021 Material: metal+fabric
-145x145x400 - E14 inc - max 1x60w

Technical Characteristics AX022 Material: metal+fabric
-220x220x600 - E27 inc - max 1x150w

Technical Characteristics AX023 Material: metal+fabric
-220x220x1700 - E27 inc - max 1x150w