

# MIRA 45 LT WALL

MIRA 45 LT Wall is a recessed wall projector suitable for outdoor installation of patios and areas with walls. It is available with spot or flood optics, warm or cold light, and a gray or graphite finish. In-ground installation also available.



## TECHNICAL DATA

|                           |  |
|---------------------------|--|
| <b>Wattage</b>            | 2W   |
| <b>Power Supply</b>       | Remote 24VDC, not included. See page 2.                                |
| <b>Construction</b>       | Body: Extruded Aluminum<br>Lens: Extra Clear or Frosted Tempered Glass |
| <b>CCT</b>                | 3000K, 4000K   |
| <b>BUG Rating</b>         | B0-U0-G0   |
| <b>CRI</b>                | >90  |
| <b>Delivered Lumens</b>   | 118 lm (3000K, Spot)<br>102 lm (3000K, Flood)                          |
| <b>Efficacy</b>           | 59 lm/W (3000K, Spot)<br>51 lm/W (3000K, Flood)                        |
| <b>Optics</b>             | Spot 12°, Flood 35°  |
| <b>Finishes</b>           | Gray, Graphite   |
| <b>Fixture Dimensions</b> | Ø1.7" x 2.8"   |
| <b>Lumen Maintenance</b>  | L70 >50,000hrs (Ta 40°C)   |
| <b>Color Consistency</b>  | 3-Step MacAdam   |
| <b>IP Rating</b>          | IP66   |
| <b>Impact Resistance</b>  | IK06   |

Fixture Dimensions

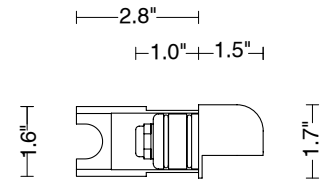

## ORDERING INFORMATION

Example: LNMI20000FHB7Z2W.US.

|                  |                               |                        |     |                          |          |    |
|------------------|-------------------------------|------------------------|-----|--------------------------|----------|----|
| LNMI20000        |                               |                        | B7Z |                          | W        | US |
| <b>Model No.</b> | <b>Optics</b>                 | <b>CCT</b>             |     | <b>Finish</b>            |          |    |
| LNMI20000        | S - Spot 12°<br>F - Flood 35° | H - 3000K<br>N - 4000K | B7Z | H - Gray<br>L - Graphite | W - Wall | US |

Job Name/Date:

Fixture Type Designation:

## SUGGESTED POWER SUPPLIES

24VDC

| Part Number               | Description   | Input/Output                                  | # of Fixtures |
|---------------------------|---|---|---------------|
| <a href="#">PPLT00128</a> | Non-Dim   | 120VAC to 24VDC, 6W, Class 2, DAMP            | 1-1           |
| <a href="#">PPLT00632</a> | 0-10V Dimming (Dim to Off)                              | 120-277VAC to 24VDC, 12W, Class 2, DAMP       | 1-4           |
| <a href="#">PPLT00056</a> | Non-Dim   | 120-277VAC to 24VDC, 26W, Class 2, DAMP, IP66 | 1-10          |
| <a href="#">PPLT00627</a> | ELV / TRIAC & 0-10V dimming (100 to 0%)                 | 120-277VAC to 24VDC, 96W Class 2, IP67        | 1-38          |
| <a href="#">PPLT00543</a> | 0-10V Dimming to 15% (-40°C / -40°F cold weather start) | 120-277VAC to 24VDC, 100W Class 2, IP67       | 1-40          |

For other power supply options consult factory.

## ACCESSORIES - Installation

(included)

3.28' (1 m) length cable -05RN-F

Housing Box

Also available: Single Connection IP68

## PHOTOMETRIC DATA

Note: All photometric data is 3000K

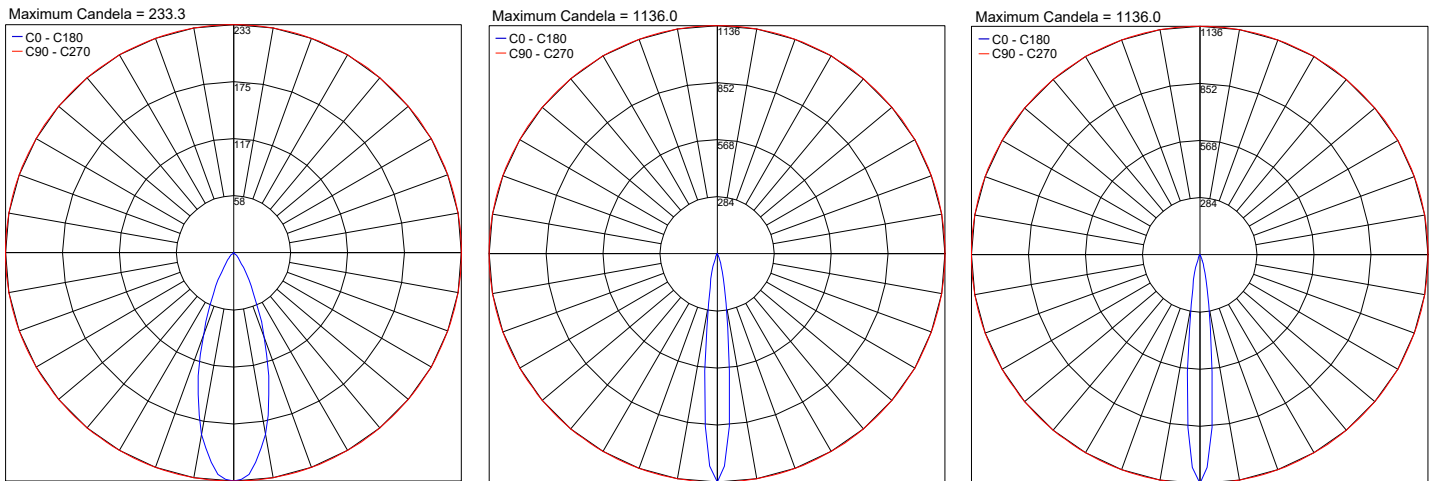

Job Name/Date:

Fixture Type Designation: