

MIRA 45 LT WALL

MIRA 45 LT Wall is a recessed wall projector suitable for outdoor installation of patios and areas with walls. It is available with spot or flood optics, warm or cold light, and a gray or graphite finish. In-ground installation also available.



TECHNICAL DATA

Wattage	2W
Power Supply	Remote 24VDC, not included. See page 2.
Construction	Body: Extruded Aluminum Lens: Extra Clear or Frosted Tempered Glass
CCT	3000K, 4000K
BUG Rating	B0-U3-G0
CRI	>90
Delivered Lumens	118 lm (3000K, Spot) 102 lm (3000K, Flood)
Efficacy	59 lm/W (3000K, Spot) 51 lm/W (3000K, Flood)
Optics	Spot 12°, Flood 35°
Finishes	Gray, Graphite
Fixture Dimensions	Ø1.7" x 2.8"
Lumen Maintenance	L70 >50,000hrs (Ta 40°C)
Color Consistency	3-Step MacAdam
IP Rating	IP66
Impact Resistance	IK06

Fixture Dimensions

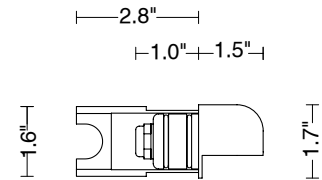

ORDERING INFORMATION

Example: LNMI20000FHB7Z2W.US.

LNMI20000			B7Z		W	US
Model No.	Optics	CCT		Finish		
LNMI20000	S - Spot 12° F - Flood 35°	H - 3000K N - 4000K	B7Z	H - Gray L - Graphite	W - Wall	US

Job Name/Date:

Fixture Type Designation:

SUGGESTED POWER SUPPLIES

24VDC

Part Number	Description	Input/Output	# of Fixtures
PPLT00128	Non-Dim	120VAC to 24VDC, 6W, Class 2, DAMP	1-1
PPLT00632	0-10V Dimming (Dim to Off)	120-277VAC to 24VDC, 12W, Class 2, DAMP	1-4
PPLT00056	Non-Dim	120-277VAC to 24VDC, 26W, Class 2, DAMP, IP66	1-10
PPLT00543	0-10V Dimming to 15% (-40°C / -40°F cold weather start)	120-277VAC to 24VDC, 100W Class 2, IP67	1-40

For other power supply options consult factory.

ACCESSORIES - Installation

(included)

3.28' (1 m) length cable -05RN-F

Housing Box

Also available: Single Connection IP68

PHOTOMETRIC DATA

Note: All photometric data is 3000K

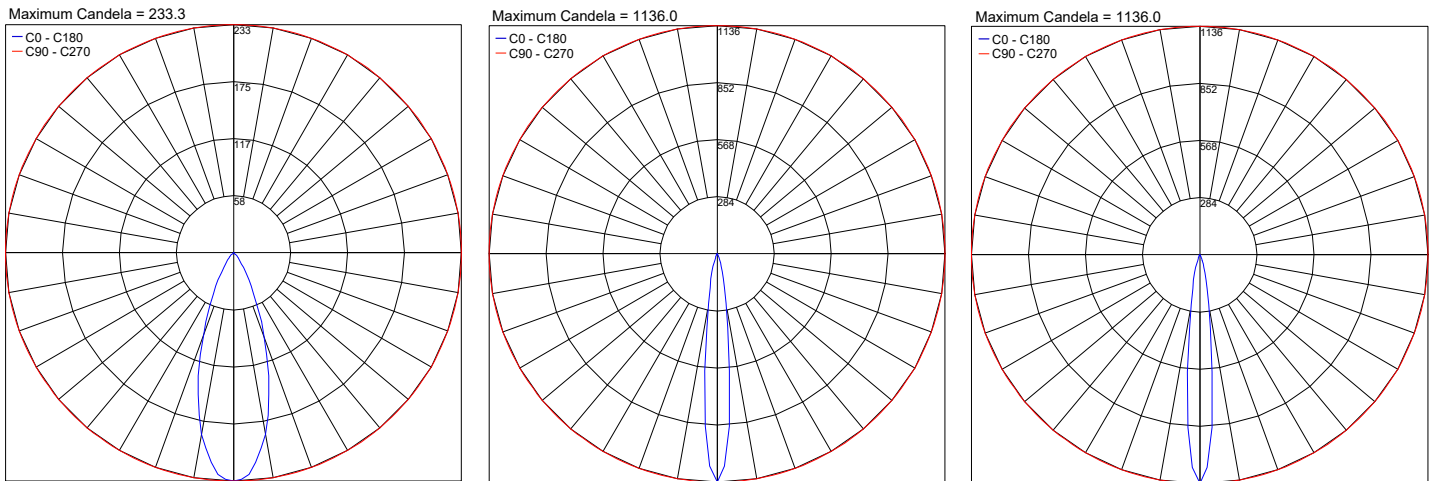

Job Name/Date:

Fixture Type Designation: