



**INSTRUCTIONS PERTAINING TO RISK OF FIRE OR INJURY TO PERSONS. READ ALL INSTRUCTIONS. IMPORTANT SAFETY INSTRUCTIONS. SAVE THESE INSTRUCTIONS.**

## **DANGER - RISK OF SHOCK - DISCONNECT POWER BEFORE INSTALLATION!**

**Please read all instructions before installation.**

- Keep these instructions for future reference.
- Must be installed by a qualified electrician in accordance with national and local standards. Designplan is not responsible for fixtures installed without regard to these standards.
- Unauthorized alterations or tampering of product voids warranty.
- The main power connection must be in accordance with local electrical codes.
- Suitable for OUTDOOR applications.



**IP66 IK09**



**MAXI**



**MEDIUM**



**MINI**



**MICRO**

**ATTENTION:** For Wall/Ceiling - It is the contractor's responsibility to caulk around all the edges between the fixture and the mounting surface to satisfy wet label requirements. Contractor **MUST** use gel-filled wire nuts.

## **Maintenance**

Scheduled maintenance must be carried out once a year on all lighting devices, regardless of appliance class and type of use. It must include the following operations:

- Periodically clean fixtures to remove dirt from gratings and screw heads.
- Check tightness of screws on various parts of the device.
- Check that all cable glands and cables are intact and tight. Check that the glass or plastic lens is intact, and replace it if broken or damaged.
- The internal components such as the ballast, driver, washers and screws must not show clear signs of oxidation or rust. Clear traces of rust and oxidation will indicate the presence of water inside the device.
- In the case of damage, the components must be replaced by original components or spare parts.

## Recommendations

- 1) The light source contained in this luminance must only be replaced by the manufacturer or its assistance service or by equally qualified personnel
- 2) Use the cables, connectors and quality materials for electrical wiring;
- 3) Products with IP66 degree make the wiring / connections with accessories provide the same degree IP of the selected product (available in the catalog);
- 4) In the case of installations outside is not recommended to install the power supplies in the formwork and / or in the junction box without adequate protection
- 5) Honey-comb louvre must be installed directly from the manufacturer . Please mention it during the order
- 6) The terminal block / connector for connecting to the power supply is not included, installation may require qualified personnel

## Choice of installation location

The unit should be positioned so that when in use is not subject to direct radiation from the sun or other heat sources . High temperatures reduce the life and efficiency of the components or the LED module .

## Note on corrosion protection

For installation and maintenance be especially careful not to damage the coating powder . Damage combined action of water could cause corro-sion.

-In the case of damage to the external flexible cable, it must be replaced by the manufacturer, or its assistance service, or equivalent qualified personnel in order to avoid dangers

## Photobiological risk: RG1 (low risk)

Installation:

1. Loose the three grub screw(using the tool included in the package) and remove the fixing plate (pic.1)
2. Prepare holes in corrispondance of the feeding point and fix the plate tighten the screws of the fischer plugs (non included in the package) (pic.2)
3. Make the adeguate electrical connection
4. Fix the luminaire to the ceiling tighten the grub screws using the tool included in the package

CYLINDER  
MICRO

CYLINDER  
MINI

CYLINDER  
MEDIUM

CYLINDER  
MAXI

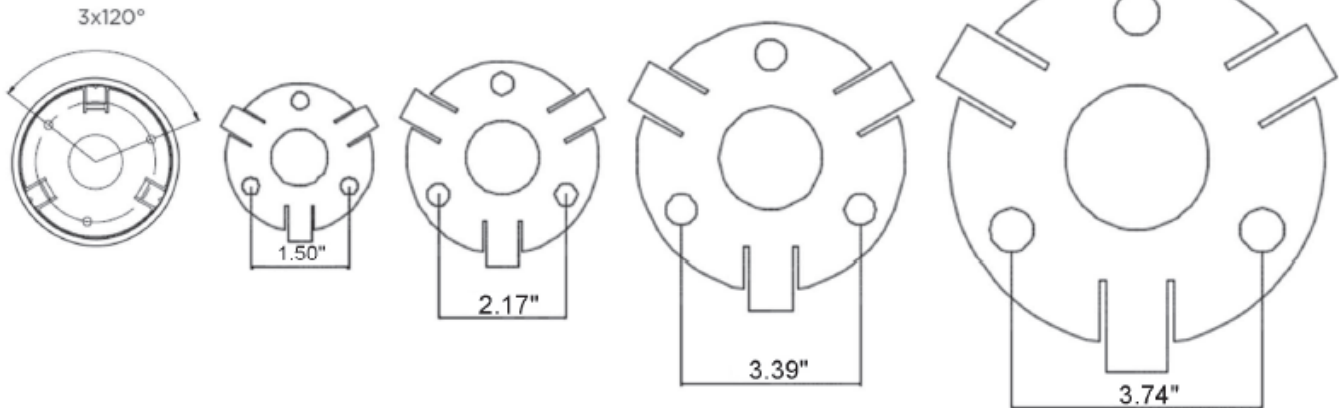

①

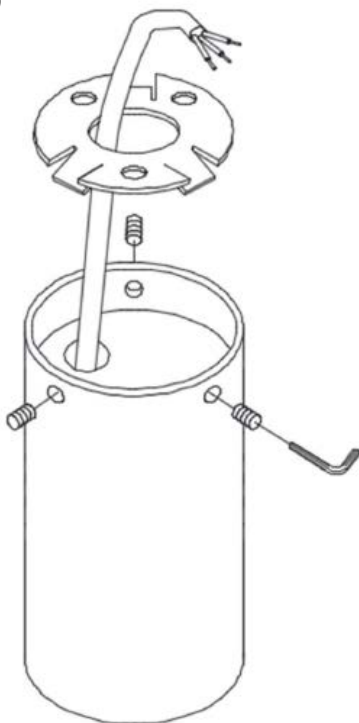

②

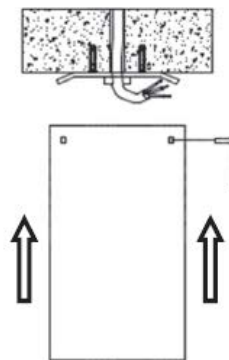

Use gel-filled waterproof wire-nuts for wire connections.

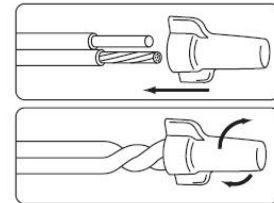

- It is the contractor's responsibility to install Remote Driver in a suitable electrical enclosure.
- It is the contractor's responsibility to caulk around the edges between the fixture and the mounting surface, to satisfy wet label requirements.

## ACCESSORIES

### HONEYCOMB LOUVRE

- AC090 CYLINDER MICRO
- AC091 CYLINDER MINI
- AC092 CYLINDER MEDIUM
- AC093 CYLINDER MAXI

