

# N-INSIDE

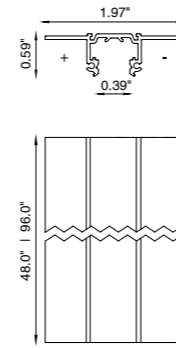

## LIGHT MODULES



L1 NANO 48V THE TUBE NANO 48V U1 NANO 48V



X1 NANO 48V Y1 NANO 48V Z1 NANO 48V

A lighting system for interiors for recessed installation. The track and structures can be managed by remote DALI and 0-10V systems. The profile is available in 48.0" and 96.0" long, extruded in black aluminum and fitted with 48V leads.

In turn, the 48V N-INSIDE is completed with all the Buzzi & Buzzi lighting products fitted with connections with integrated electronics. The use of NON SELV or U-OUT > 60VDC power supplies, drivers and components is strictly forbidden.

Is recommended the usage of an opto-insulated repeater DALI to convert FELV into SELV (code: BUT048 A 00078 00).

## CODE COMPOSITION

BUT048 T 05 B1 0 _ 1	length	07	48.0"
		08	96.0"

example of code composition BUT048 T 05 B1 007 1

## TECHNICAL FEATURES

Code	<b>BUT048 T 05 XX</b>
Type	Low voltage track
Material	Aluminum
Finishing	Black
Weight	-
Mounting	Recessed
IP rating	-
Control gear	Remote power supply (not included)
Dimensions	A: 48.0"   96.0"
Cut out for plasterboard	0.83" x A
Voltage connection	48 VDC
Circuits	2 x ±10 A · 48 VDC 1 x ±10 A · 48 VDC + D+/D
Note	The supply connectors, plugs and further fixture accessories must be ordered separately.  Any 90° connector must be ordered separately to ensure electric continuity in the corners.  Light points cannot be installed in the corners.



79 Trenton Avenue  
Frenchtown, NJ 08825

www.designplan.com

Tel: (908) 996-7710  
Fax: (908) 996-7042

POWER HEAD



CODE COMPOSITION

BUT048 A 00095 B1

TECHNICAL FEATURES

Code	<b>BUT048 A</b> 00095 B1
Type	Non-polarised power head
Material	Polyamide body
Finishing	Black RAL 9005 ■
Fixing	Plug-in
Voltage connection	10 A max · 48 VDC
Note	-

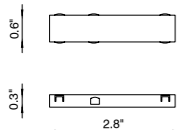

THROUGH JOINT



CODE COMPOSITION

BUT048 A 00064 B1

TECHNICAL FEATURES

Code	<b>BUT048 A</b> 00064 B1
Type	Non-polarised through joint
Material	Polyamide body
Finishing	Black RAL 9005 ■
Fixing	Plug-in
Voltage connection	10 A max · 48 VDC
Note	Used to connect two tracks and to guarantee the supply of current.

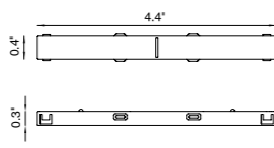

90° CORNER JOINT



CODE COMPOSITION

BUT048 A 00065 B1

TECHNICAL FEATURES

Code	<b>BUT048 A</b> 00065 B1
Type	Non-polarised 90° corner joint
Material	Polyamide body
Finishing	Black RAL 9005 ■
Fixing	Plug-in
Voltage connection	10 A max · 48 VDC
Note	Used to connect two tracks joined at 90° and to guarantee that current reaches the corners.  Light points cannot be installed in the corners.

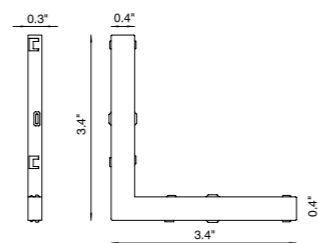

CEILING-WALL 90° CORNER JOINT



CODE COMPOSITION

BUT048 A 00066 B1

TECHNICAL FEATURES

Code	<b>BUT048 A</b> 00066 B1
Type	Non-polarised 90° ceiling-wall corner joint
Material	Polyamide body
Finishing	Black RAL 9005 ■
Fixing	Plug-in
Voltage connection	10 A max · 48 VDC
Note	Non-polarized angle for ceiling-to-wall connection, used to connect two tracks joined to 90°.  Light points cannot be installed in the corners.

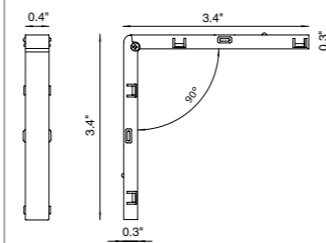

FLEXIBLE JOINT



CODE COMPOSITION

BUT048 A 00067 B1

TECHNICAL FEATURES

Code	<b>BUT048 A</b> 00067 B1
Type	Flexible joint
Material	Polyamide body
Finishing	Black RAL 9005 ■
Fixing	Plug-in
Voltage connection	10 A max · 48 VDC
Note	Used to connect two tracks installed on different surfaces (ceiling-wall) or to create different angles from 90° and to guarantee power supply.  Light points cannot be installed in the corners.

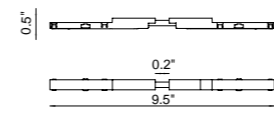

CUTTER

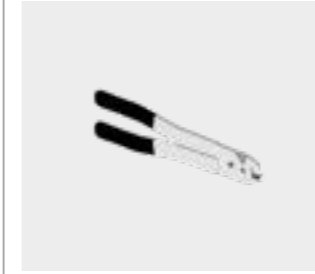

CODE COMPOSITION

BUTRK 00000 42

TECHNICAL FEATURES

Code	<b>BUTRK</b> 00000 42
Type	Conductor cutting pliers
Material	-
Finishing	-
Fixing	-
Note	The 48.0" / 96.0" long tracks are supplied with copper wires already tested with respect to the aluminum in order to prevent the copper terminals from coming into contact with each other, in the case of double power supply, or, to prevent them from touching each other, if closure plugs are used. If it should be necessary to shorten the length of the track during installation, use the special cutting nippers taking care to pull out the four wires by at least 0.2" to guarantee correct electric distances.

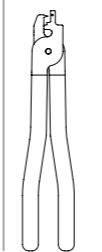

CLOSURE PLUG



CODE COMPOSITION

BUT048 A 00062 B1

TECHNICAL FEATURES

Code	<b>BUT048 A</b> 00062 B1
Type	Closure plug
Material	Polyamide body
Finishing	Black RAL 9005 ■
Fixing	By screws (included)
Note	-

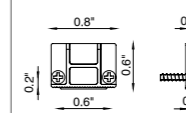

CLOSING COVER



CODE COMPOSITION

BUT048 A 00089 B1

TECHNICAL FEATURES

Code	<b>BUT048 A</b> 00089 B1
Type	Aesthetic closing cover
Material	PMMA
Finishing	Black RAL 9005 ■
Fixing	-
Note	Cover installable at the bottom between the various spotlights, to hide the inside of the track and to allow aesthetic continuity.  Cover length: 118.1"

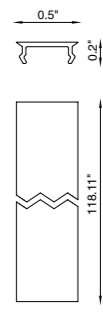

**OPTO-INSULATED  
REPEATER DALI**



CODE COMPOSITION

**BUT048 A** 00078 00

TECHNICAL FEATURES

<b>Code</b>	<b>BUT048 A</b> 00078 00
<b>Type</b>	DALI signal repeater and regenerator
<b>Material</b>	-
<b>Finishing</b>	-
<b>Fixing</b>	-
<b>Insulation class</b>	-
<b>Voltage connection</b>	48 VDC
<b>Max wattage</b>	-
<b>Note</b>	The device makes the <b>DALI FELV</b> signal compatible with the Buzzi & Buzzi 48V track system, making it <b>SELV</b> .

