

FOCAL D50, D70

5W, Remote 12VDC

designplan®

installation instructions



INSTRUCTIONS PERTAINING TO RISK OF FIRE OR INJURY TO PERSONS. READ ALL INSTRUCTIONS. IMPORTANT SAFETY INSTRUCTIONS. SAVE THESE INSTRUCTIONS.

DANGER - RISK OF SHOCK - DISCONNECT POWER BEFORE INSTALLATION! Please read all instructions before installation.

- Keep these instructions for future reference.
- Must be installed by a qualified electrician in accordance with national and local standards. Designplan is not responsible for fixtures installed without regard to these standards.
- Unauthorized alterations or tampering of product voids warranty.
- The main power connection must be in accordance with local electrical codes.
- Suitable for INDOOR applications.
- DO NOT INSTALL INSULATION WITHIN 3.0" (76 mm) OF ANY PART OF THE LUMINAIRE.



ATTENTION: For In-Grade - It is the contractor's responsibility to seal the conduit with "Great Stuff" aerosol seal that prevents water and moisture penetration for ultimate protection. Contractor **MUST** use gel-filled wire nuts.

Maintenance

Scheduled maintenance must be carried out once a year on all lighting devices, regardless of appliance class and type of use. It must include the following operations:

- Periodically clean fixtures to remove dirt from gratings and screw heads.
- Check tightness of screws on various parts of the device.
- Check that all cable glands and cables are intact and tight. Check that the glass or plastic lens is intact, and replace it if broken or damaged.
- The internal components such as the ballast, driver, washers and screws must not show clear signs of oxidation or rust. Clear traces of rust and oxidation will indicate the presence of water inside the device.
- In the case of damage, the components must be replaced by original components or spare parts.

INSTALLATION AND WIRING

LENS VERSION INSTALLATION:

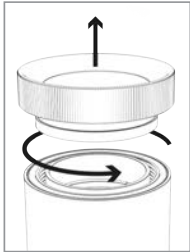

Unscrew the ring nut



Insert bulb MR11 into GU4 lamp holder, using internal bulb support

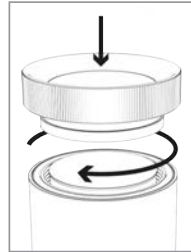

Screw the ring nut

HEAD INCLINATION ADJUSTMENT:

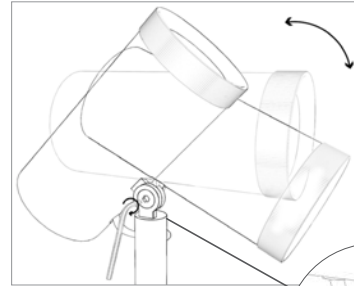

Adjust and lock the device head using a 4 mm Allen key



DEVICE INSTALLATION:

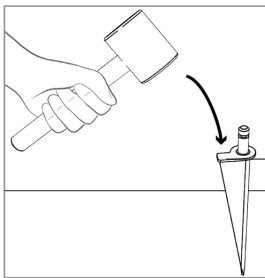

Use rubber mallet and strike in the highlighted area
Do not hit the highlighted area if the device body is installed in the spike

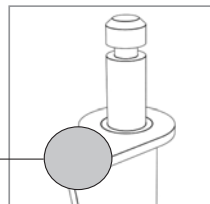

OK

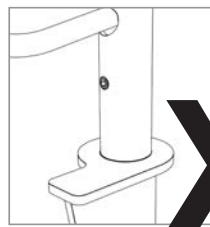

X NO

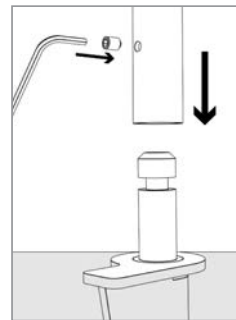

Insert the body of the luminaire into the grounded stake and place the dowel in the body

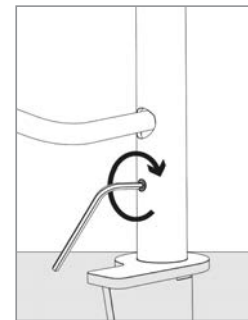

Lock the device body using a 2 mm Allen key

EXTRACTION DEVICE:

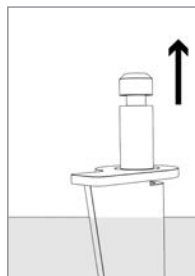
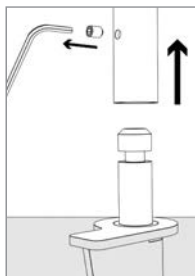
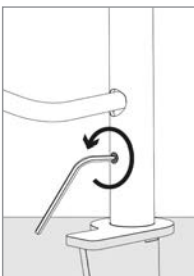

Before proceeding with the extraction of the device, unscrew the grub screw and pull the body separately from the spike

CABLE WIRING:

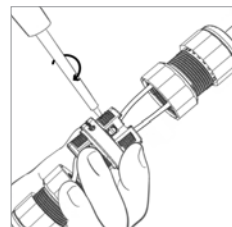

Fasten cables to the connector

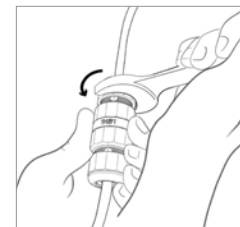

Lock the fixing nuts

Suggested cable cross section - max. (flexible cable) 0,5 sq mm - 4,0 sq mm Cable diameter min. - max. 0.276"- 0.472" dia.

