

# FOCAL D-50

Focal is a IP66-rated LED floodlight with locking ring, parallel lines, and a head axial rotation of 180°, that is perfectly suited for illuminating architectural details and natural elements such as shrubs and planted areas. It is available in 2 head sizes, 3 heights, and in 3 standard Hard Coat Treatment finishes.



Fixture Dimensions - See page 2

## TECHNICAL DATA

<b>Wattage / Input</b>	5W LED or GU4 (Lamp by others)
<b>Power Supply</b>	Remote 12VDC Constant Voltage
<b>Dimming</b>	See Power Supplies on Page 2
<b>Construction</b>	Body: AISI 316L Stainless Steel Lens: Extra-clear Tempered Glass 0.16" Thick
<b>CCT</b>	2700K, 3000K or GU4 Lamp by others
<b>BUG Rating</b>	B1-U1-G0 (6°, 10°x35°, 15°, 25°) B0-U1-G0 (35°)
<b>CRI</b>	>80
<b>Delivered Lumens</b>	550 lm (3000K) or Determined by Lamp
<b>Efficacy</b>	110 lm/W (3000K) or Determined by Lamp
<b>Optics</b>	Multilens: 6°, 15°, 25°, 38°, 10°x 35°, Wide or Determined by Lamp
<b>Hard Coat Finishes</b>	Inox Natural, Inox Graphite, Inox Bronze
<b>Fixture Dimensions</b>	Ø2.2" x 7.9", 15.8", 31.5" h
<b>IP Rating</b>	IP66
<b>Impact Resistance</b>	IK08
<b>Warranty</b>	10 Years Against Corrosion 5 Years on Electrical Components

**Hard Coating Treatment** is the surface treatment of all the products by Stral Lighting. It is not a skin of color, but instead is a process that allows for the color to be absorbed all the way through. If a product is scratched, the color beneath is the same as the color on the surface. It guarantees a high superficial resistance to corrosion and atmospheric agents, as well as making the products anti-fingerprint and anti-stain. Available in three finishes Inox Natural, Inox Graphite and Inox Bronze.

## ORDERING INFORMATION

Example: SPT5015034BF.US. Power Supplies / Accessories sold separately.

				.US
<b>Model No.</b>	<b>Height</b>	<b>Finishes</b>	<b>Fixing</b>	
SPT501504 - GU4 Bulb (Bulb Sold Separately)	2 - 7.87" 4 - 15.75"	N - Inox Natural G - Inox Graphite B - Inox Bronze	F - On Mounting Plate S - On Spike (included)	.US
SPT501502 - 5W LED (2700K)	8 - 31.50"			
SPT501503 - 5W LED (3000K)				

Job Name/Date:

Fixture Type Designation:

## FIXTURE DIMENSIONS

FOCAL D-50

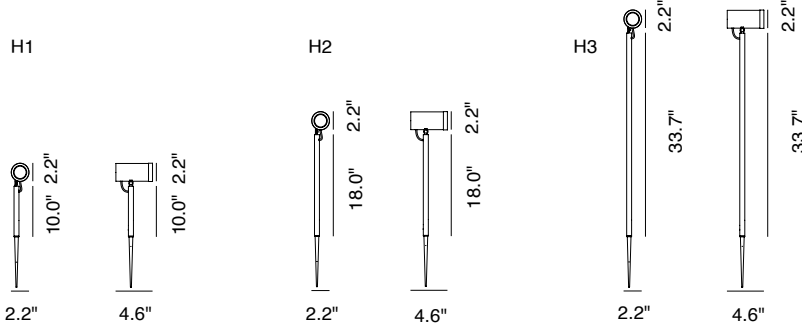

## FINISHES



## SUGGESTED POWER SUPPLIES

12VDC

Part Number	Description	Input/Output	# of Fixtures	
			D-50	D-70
<a href="#">PPLT00654</a>	0-10V Dimming	120-277VAC to 12VDC, 50W, Class 2	1-13	1-8
<a href="#">PPLT00506</a>	Non-Dim	120-277VAC to 12VDC, 60W, Class 2, DAMP	1-16	1-9
<a href="#">PPLT00721</a>	ELV/TRIAC & 0-10V to 0.1%	120-277VAC to 12VDC, 100W, Class 2, WET/DAMP	1-26	1-16

For other power supply options consult factory.

## ACCESSORIES



**PT40002**  
Mortar Cap  
Ø4.33"

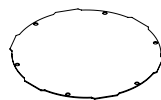

**PT40003**  
Bottom Cap  
Ø6.30"



**PT69001**  
Spike 1  
Ø0.79" x 1.97" w x 9.45" h

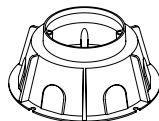

**PT52123**  
Casing  
Ø7.87" x 7.87" w x 3.15" h

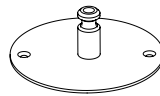

**PT68100**  
Casing Flange 1  
Ø4.33" x 1.57" h

**PT68101**  
Casing Flange 2  
Ø4.33" x 1.57" h

Job Name/Date:

Fixture Type Designation:

## PHOTOMETRIC DATA

Multilens includes the below optics at 2700K

Maximum Candela = 3172.5

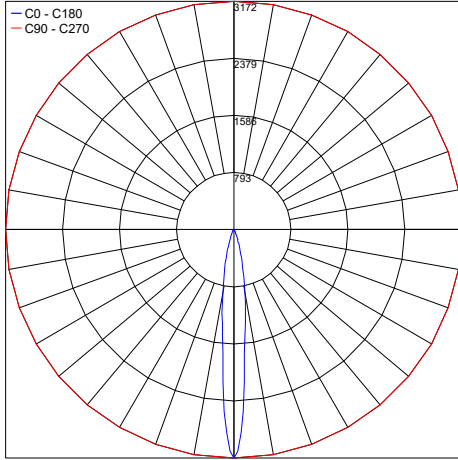

Maximum Candela = 3082.4

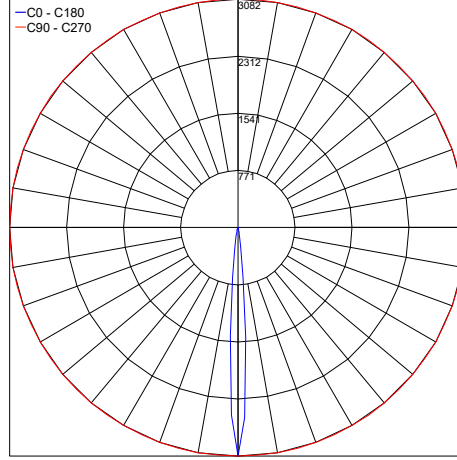

Maximum Candela = 2595.9

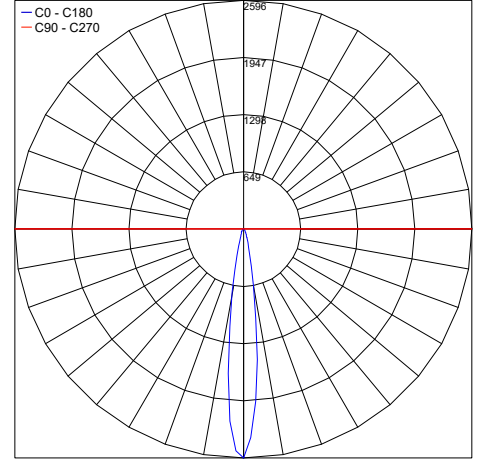

Maximum Candela = 1081.0

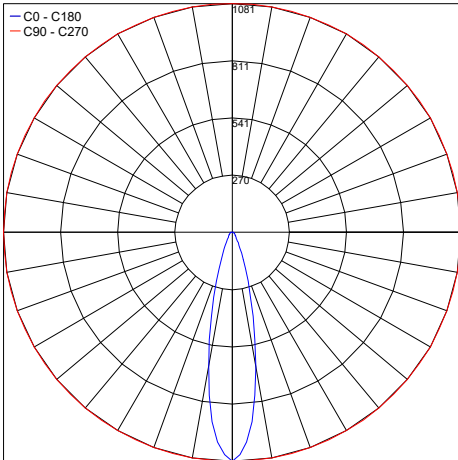

Maximum Candela = 525.5

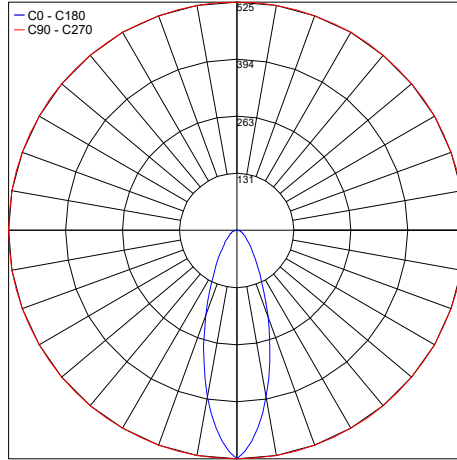

Job Name/Date:

Fixture Type Designation: