

# SOLISIA WALL 130

SOLISIA WALL 130 is a round, wall mounted LED luminaire made of Accoya®, a sustainable, highly durable wood treated with Acetylation treatment. It is available with 8W, 3000K and diffuse optics. 25 year warranty on Accoya® Wood - 5 year warranty on lighting element.



## TECHNICAL DATA

|                           |   |
|---------------------------|---|
| <b>Wattage</b>            | 8W  |
| <b>Power Supply</b>       | Remote 24VDC, not included. See page 2.                           |
| <b>Construction</b>       | Body: Accoya® Wood and Inox AISI 316L<br>Lens: Opal Polycarbonate |
| <b>CCT</b>                | 2700K, 3000K  |
| <b>BUG Rating</b>         | Coming Soon   |
| <b>CRI</b>                | >90   |
| <b>Delivered Lumens</b>   | 470 lm (3000K)  |
| <b>Efficacy</b>           | 59 lm/W   |
| <b>Optics</b>             | Diffuse   |
| <b>Finishes</b>           | Accoya® - Acetylation treatment                                   |
| <b>Fixture Dimensions</b> | Ø5.12" x 1.18" h  |
| <b>Lumen Maintenance</b>  | L70 >50,000hrs (Ta 40°C)  |
| <b>Color Consistency</b>  | 3-Step MacAdam  |
| <b>IP Rating</b>          | IP65  |
| <b>Impact Resistance</b>  | IK08  |

Fixture Dimensions

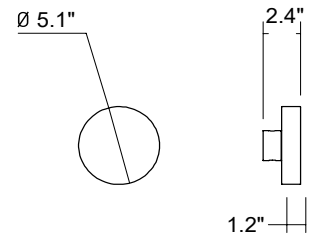

## ORDERING INFORMATION

Example: LNSO70PARDHB7Z3.US. Accessories / Power Supplies ordered separately.

| LNSO      | 70PAR | D           |                        | B7Z3          | US |
|-----------|-------|-------------|------------------------|---------------|----|
| Model No. | Size  | Optics      | CCT                    | Power         |    |
| LNSO      | 70PAR | D - Diffuse | Y - 2700K<br>H - 3000K | B7Z3 - Remote | US |

Job Name/Date:

Fixture Type Designation:

## SUGGESTED POWER SUPPLIES

24VDC

| Part Number               | Description   | Input/Output                            | # of Fixtures |
|---------------------------|---|---|---------------|
| <a href="#">PPLT00149</a> | Non-Dim   | 120VAC to 24VDC, 10W, Class 2, IP65     | 1-1           |
| <a href="#">PPLT00632</a> | 0-10V Dimming (Dim to Off)                              | 120-277VAC to 24VDC, 12W, Class 2       | 1-1           |
| <a href="#">PPLT00155</a> | Non-Dim   | 120VAC to 24VDC, 30W, Class 2           | 1-3           |
| <a href="#">PPLT00586</a> | Non-Dim   | 120-277VAC to 24VDC, 40W, Class 2       | 1-4           |
| <a href="#">PPLT00709</a> | ELV / TRIAC & 0-10V Dimming                             | 120-277VAC to 24VDC, 96W, Class 2, DAMP | 1-9           |
| <a href="#">PPLT00543</a> | 0-10V Dimming to 15% (-40°C / -40°F cold weather start) | 120-277VAC to 24VDC, 100W, Class 2      | 1-10          |

### Suggested Lutron Compatible

| Part Number               | Option         | Lutron SKU | Dim Range | Description  | Input/Output                      | # of Fixtures |
|---------------------------|----------------|------------|-----------|--|-----------------------------------|---------------|
| <a href="#">PPLT00273</a> | L3DAE / L3DA3W | L3DA       | 100%-1%   | Hi-Lume™ 1% EcoSystem™ or 1% 3-Wire LED Driver       | 120-277VAC to 24VDC, 40W, Class 2 | 1-4           |
| <a href="#">PPLT00530</a> | L3D0           | L3D0       | 100%-0.1% | Hi-Lume™ Premier 0.1% or Ecosystem 3-Wire LED Driver | 120-277VAC to 24VDC, 96W, Class 2 | 1-9           |

For other power supply options consult factory.

## ACCESSORIES - Installation

(included)

Single Connection IP68

## PHOTOMETRIC DATA - Coming Soon

Note: All photometric data is 3000K

Job Name/Date:

Fixture Type Designation: