

SOLISIA WALL 200

SOLISIA WALL 200 is a round, wall mounted LED luminaire made of Accoya®, a sustainable, highly durable wood treated with Acetylation treatment. It is available with 12W, 3000K and diffuse optics. 25 year warranty on Accoya® Wood - 5 year warranty on lighting element.



TECHNICAL DATA

Wattage	12W
Power Supply	Remote 24VDC, not included. See page 2.
Construction	Body: Accoya® Wood and Inox AISI 316L Lens: Opal Polycarbonate
CCT	3000K
BUG Rating	Coming Soon
CRI	>90
Delivered Lumens	1098 lm
Efficacy	91.5 lm/W
Optics	Diffuse
Finishes	Accoya® - Acetylation treatment
Fixture Dimensions	Ø7.87" x 1.18" h
Lumen Maintenance	L70 >50,000hrs (Ta 40°C)
Color Consistency	3-Step MacAdam
IP Rating	IP65
Impact Resistance	IK08

Fixture Dimensions

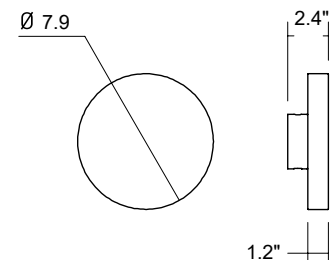

ORDERING INFORMATION

Example: LNSO80055DHB7Z3.US. Accessories / Power Supplies ordered separately.

LNSO	80PAR	D	HB7Z3	US
Model No.	Size	Optics	Power	
LNSO	80PAR	D - Diffuse	HB7Z3	US

Job Name/Date:

Fixture Type Designation:

SUGGESTED POWER SUPPLIES

24VDC

Part Number	Description	Input/Output	# of Fixtures
PPLT00680	ELV / TRIAC & 0-10V Dimming (100 to 0%)	120-277VAC to 24VDC, 20W, Class 2, IP66	1-1
PPLT00155	Non-Dim	120VAC to 24VDC, 30W, Class 2	1-2
PPLT00157	Non-Dim	120VAC to 24VDC, 60W, Class 2	1-4
PPLT00627	ELV / TRIAC & 0-10V Dimming (100 to 0%)	120-277VAC to 24VDC, 96W, Class 2, IP67	1-6
PPLT00158	Non-Dim	120VAC to 24VDC, 100W, Class 2	1-6
PPLT00543	0-10V Dimming to 15% (-40°C / -40°F cold weather start)	120-277VAC to 24VDC, 100W, Class 2	1-6

For other power supply options consult factory.

ACCESSORIES - Installation

(included)

Single Connection IP68

PHOTOMETRIC DATA - Coming Soon

Note: All photometric data is 3000K

Job Name/Date:

Fixture Type Designation: