

SOLISIA WALL 200

SOLISIA WALL 200 is a round, wall mounted LED luminaire made of Accoya®, a sustainable, highly durable wood treated with Acetylation treatment. It is available with 12W, 3000K and diffuse optics. 25 year warranty on Accoya® Wood - 5 year warranty on lighting element.



TECHNICAL DATA

| | |
|---------------------------|---|
| Wattage | 12W |
| Power Supply | Remote 24VDC, not included. See page 2. |
| Construction | Body: Accoya® Wood and Inox AISI 316L Lens: Opal Polycarbonate |
| CCT | 3000K |
| CRI | >90 |
| Delivered Lumens | 1098 lm |
| Efficacy | 91.5 lm/W |
| Optics | Diffuse |
| Finishes | Accoya® - Acetylation treatment |
| Fixture Dimensions | Ø7.87" x 1.18" h |
| Lumen Maintenance | L70 >50,000hrs (Ta 40°C) |
| Color Consistency | 3-Step MacAdam |
| IP Rating | IP65 |
| Impact Resistance | IK08 |

Fixture Dimensions

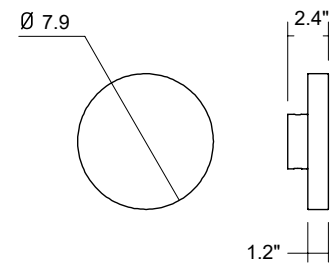

ORDERING INFORMATION

Example: LNSO80055DHB7Z3.US. Accessories / Power Supplies ordered separately.

| | | | | |
|------------------|-------------|---------------|--------------|----|
| LNSO | 80PAR | D | HB7Z3 | US |
| Model No. | Size | Optics | Power | |
| LNSO | 80PAR | D - Diffuse | HB7Z3 | US |

Job Name/Date:

Fixture Type Designation:

SUGGESTED POWER SUPPLIES

24VDC

| Part Number | Description | Input/Output | # of Fixtures |
|---------------------------|---|---|---------------|
| PPLT00680 | ELV / TRIAC & 0-10V Dimming (100 to 0%) | 120-277VAC to 24VDC, 20W, Class 2, IP66 | 1-1 |
| PPLT00155 | Non-Dim | 120VAC to 24VDC, 30W, Class 2 | 1-2 |
| PPLT00586 | Non-Dim | 120-277VAC to 24VDC, 40W, Class 2 | 1-2 |
| PPLT00709 | ELV / TRIAC & 0-10V Dimming | 120-277VAC to 24VDC, 96W, Class 2, DAMP | 1-6 |
| PPLT00543 | 0-10V Dimming to 15% (-40°C / -40°F cold weather start) | 120-277VAC to 24VDC, 100W, Class 2 | 1-6 |

Suggested Lutron Compatible

| Part Number | Option | Lutron SKU | Dim Range | Description | Input/Output | # of Fixtures |
|---------------------------|----------------|------------|-----------|--|-----------------------------------|---------------|
| PPLT00273 | L3DAE / L3DA3W | L3DA | 100%-1% | Hi-Lume™ 1% EcoSystem™ or 1% 3-Wire LED Driver | 120-277VAC to 24VDC, 40W, Class 2 | 1-2 |
| PPLT00530 | L3D0 | L3D0 | 100%-0.1% | Hi-Lume™ Premier 0.1% or Ecosystem 3-Wire LED Driver | 120-277VAC to 24VDC, 96W, Class 2 | 1-6 |

For other power supply options consult factory.

ACCESSORIES - Installation

(included)

Single Connection IP68

Job Name/Date:

Fixture Type Designation:

PHOTOMETRIC DATA

Note: All photometric data is 3000K

Maximum Candela = 352.2

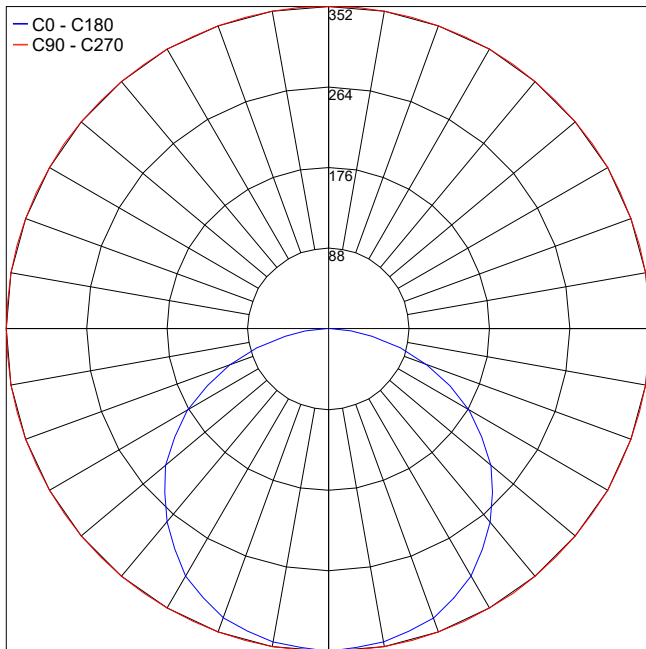

PHOTOMETRIC FILENAME : SOLISIA_SO80XXXDHB7Z3.IES

Job Name/Date:

Fixture Type Designation: