

# SOLISIA WALL 200

SOLISIA WALL 200 is a round, wall mounted LED luminaire made of Accoya®, a sustainable, highly durable wood treated with Acetylation treatment. It is available with 12W, 3000K and diffuse optics. 25 year warranty on Accoya® Wood - 5 year warranty on lighting element.



## TECHNICAL DATA

<b>Wattage</b>	12W
<b>Power Supply</b>	Remote 24VDC, not included. See page 2.
<b>Construction</b>	Body: Accoya® Wood and Inox AISI 316L Lens: Opal Polycarbonate
<b>CCT</b>	2700K, 3000K
<b>CRI</b>	>90
<b>Delivered Lumens</b>	1098 lm (3000K)
<b>Efficacy</b>	91.5 lm/W
<b>Optics</b>	Diffuse
<b>Finishes</b>	Accoya® - Acetylation treatment
<b>Fixture Dimensions</b>	Ø7.87" x 1.18" h
<b>Lumen Maintenance</b>	L70 >50,000hrs (Ta 40°C)
<b>Color Consistency</b>	3-Step MacAdam
<b>IP Rating</b>	IP65
<b>Impact Resistance</b>	IK08

Fixture Dimensions

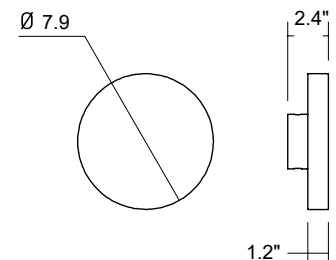

## ORDERING INFORMATION

Example: LNSO80PARDHB7Z3.US. Accessories / Power Supplies ordered separately.

LNSO	80PAR	D		B7Z3	US
<b>Model No.</b>	<b>Size</b>	<b>Optics</b>	<b>CCT</b>	<b>Power</b>	
LNSO	80PAR	D - Diffuse	Y - 2700K H - 3000K	B7Z3 - Remote	US

Job Name/Date:

Fixture Type Designation:

## SUGGESTED POWER SUPPLIES

24VDC

Part Number	Description	Input/Output	# of Fixtures
<a href="#">PPLT00680</a>	ELV / TRIAC & 0-10V Dimming (100 to 0%)	120-277VAC to 24VDC, 20W, Class 2, IP66	1-1
<a href="#">PPLT00155</a>	Non-Dim	120VAC to 24VDC, 30W, Class 2	1-2
<a href="#">PPLT00586</a>	Non-Dim	120-277VAC to 24VDC, 40W, Class 2	1-2
<a href="#">PPLT00709</a>	ELV / TRIAC & 0-10V Dimming	120-277VAC to 24VDC, 96W, Class 2, DAMP	1-6
<a href="#">PPLT00543</a>	0-10V Dimming to 15% (-40°C / -40°F cold weather start)	120-277VAC to 24VDC, 100W, Class 2	1-6

## Suggested Lutron Compatible

Part Number	Option	Lutron SKU	Dim Range	Description	Input/Output	# of Fixtures
<a href="#">PPLT00273</a>	L3DAE / L3DA3W	L3DA	100%-1%	Hi-Lume™ 1% EcoSystem™ or 1% 3-Wire LED Driver	120-277VAC to 24VDC, 40W, Class 2	1-2
<a href="#">PPLT00530</a>	L3D0	L3D0	100%-0.1%	Hi-Lume™ Premier 0.1% or Ecosystem 3-Wire LED Driver	120-277VAC to 24VDC, 96W, Class 2	1-6

For other power supply options consult factory.

## ACCESSORIES - Installation

(included)

### Single Connection IP68

## PHOTOMETRIC DATA

Note: All photometric data is 3000K

Maximum Candela = 352.2

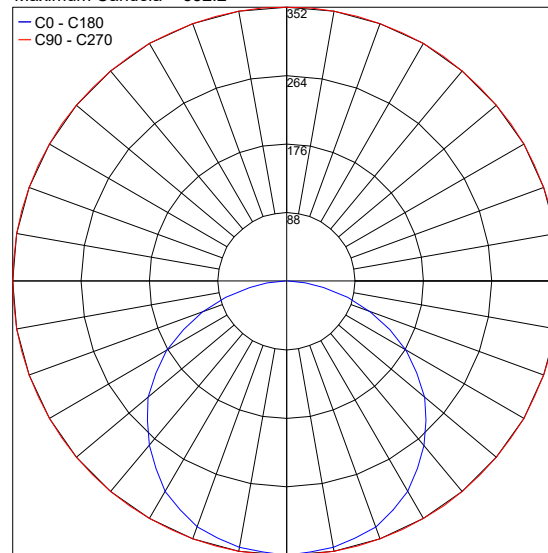

PHOTOMETRIC FILENAME : SOLISIA\_SO80XXXDHB7Z3.IES

Job Name/Date:

Fixture Type Designation: