



INSTRUCTIONS PERTAINING TO RISK OF FIRE OR INJURY TO PERSONS. READ ALL INSTRUCTIONS. IMPORTANT SAFETY INSTRUCTIONS. SAVE THESE INSTRUCTIONS.

DANGER - RISK OF SHOCK - DISCONNECT POWER BEFORE INSTALLATION! Please read all instructions before installation.

- Keep these instructions for future reference.
- Must be installed by a qualified electrician in accordance with national and local standards. Designplan is not responsible for fixtures installed without regard to these standards.
- Unauthorized alterations or tampering of product voids warranty.
- The main power connection must be in accordance with local electrical codes.
- Suitable for OUTDOOR applications.



IP67 IK10

Electrical Connections:

- LED lights must be **connected in parallel** respecting polarities.
- **CHOOSE POWER SUPPLY ACCORDINGLY.** Please consider the voltage through which fixtures are fed as well as the max power consumption.
- **Connect power only if all the fixtures are connected.**
- The power supplies **MUST** be installed in aerated rooms, far from heat sources. Overworking or lack of air circulation will not permit natural dissipation.
- Use only Class 2 type electronic power supply.
- Never use switches on secondary circuit.

ATTENTION: For Wall/Ceiling - It is the contractor's responsibility to caulk around all the edges between the fixture and the mounting surface to satisfy wet label requirements. Contractor **MUST** use gel-filled wire nuts.

Maintenance

Scheduled maintenance must be carried out once a year on all lighting devices, regardless of appliance class and type of use. It must include the following operations:

- Periodically clean fixtures to remove dirt from gratings and screw heads.
- Check tightness of screws on various parts of the device.
- Check that all cable glands and cables are intact and tight. Check that the glass or plastic lens is intact, and replace it if broken or damaged.
- The internal components such as the ballast, driver, washers and screws must not show clear signs of oxidation or rust. Clear traces of rust and oxidation will indicate the presence of water inside the device.
- In the case of damage, the components must be replaced by original components or spare parts.

FOG 1 300 / 600 / 900 FLOODLIGHT

12W, 24W, 34W, REMOTE 24VDC

designplan®

installation instructions

FIXTURE DIMENSION

Ceiling or Wall

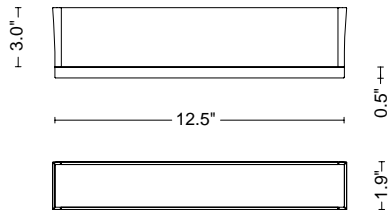

Projector

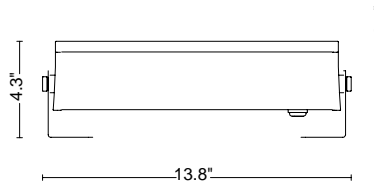

Recessed

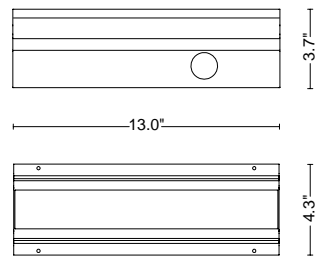

FOG 1 300

Ceiling or Wall

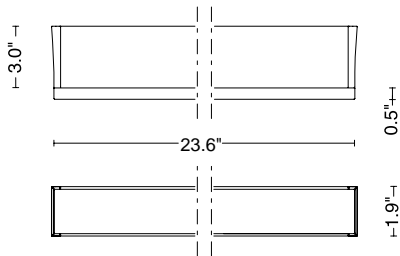

Projector

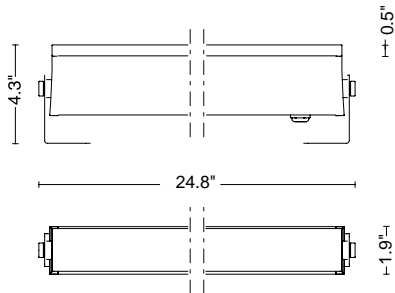

Recessed

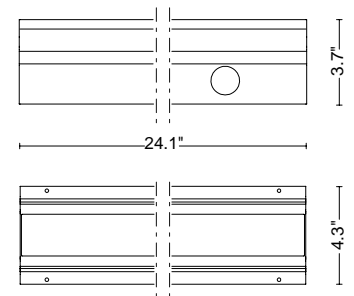

FOG 1 600

Ceiling or Wall

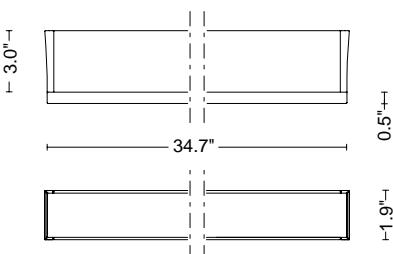

Projector

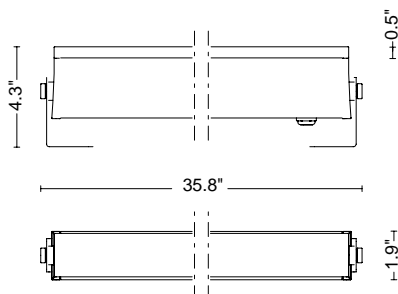

Recessed

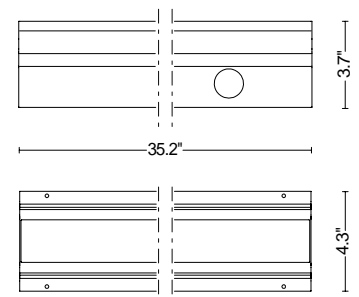

FOG 1 900

FOG 1 300 / 600 / 900 FLOODLIGHT

12W, 24W, 34W, REMOTE 24VDC

designplan®

installation instructions

FIXTURE DIMENSION

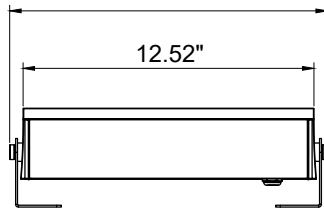

FOG 1 300

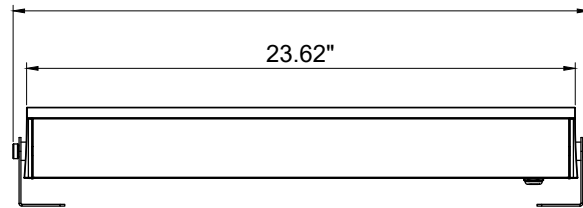

FOG 1 600

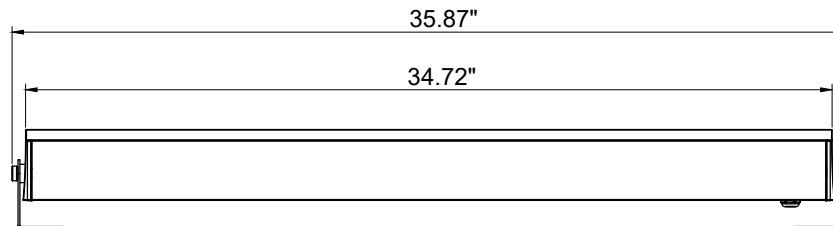

FOG 1 900

RECESSED INSTALLATION OPTIONS

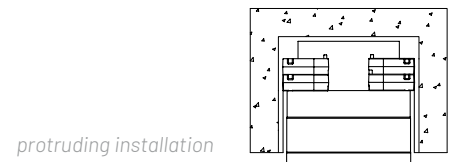
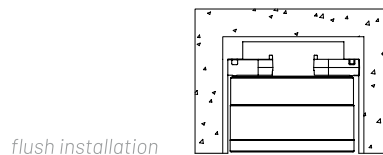
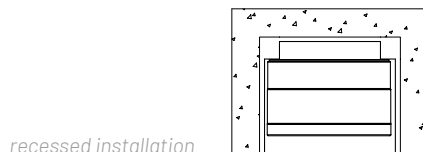

ACCESSORIES - Included

CEILING / WALL LAMP

05RN-F - 1.64' (0.5 m) length cable
Single connection IP68

PROJECTOR

05RN-F - 3.28' (1 m) length cable
Single connection IP68
Fixing kit short (2.95")

00KEYFGL.150_ - Fixing kit medium (5.91")

00KEYFGL.250_ - Fixing kit long (9.84")

RECESSED

05RN-F - 1.64' (0.5 m) length cable
Single connection IP68

Also Available

00EY/FGL3.STD - Housing box

FOG 1 300 / 600 / 900 FLOODLIGHT

12W, 24W, 34W, REMOTE 24VDC

designplan®

installation instructions

FIXTURE INSTALLATION

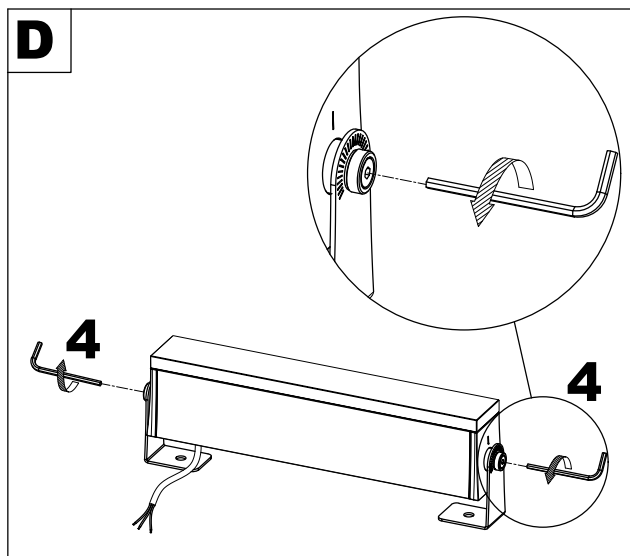
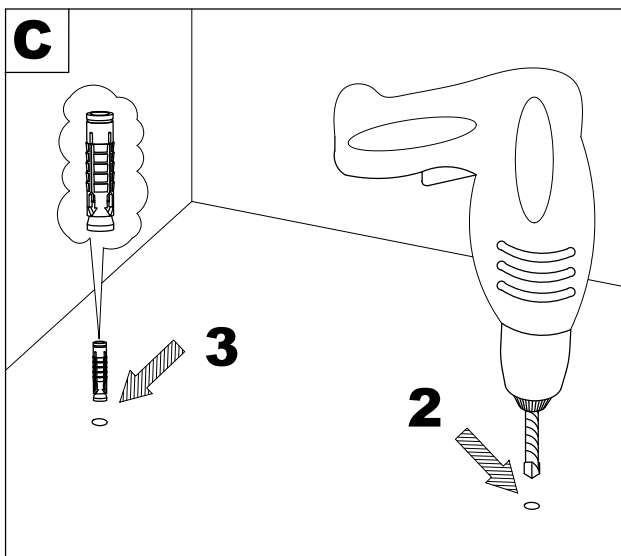
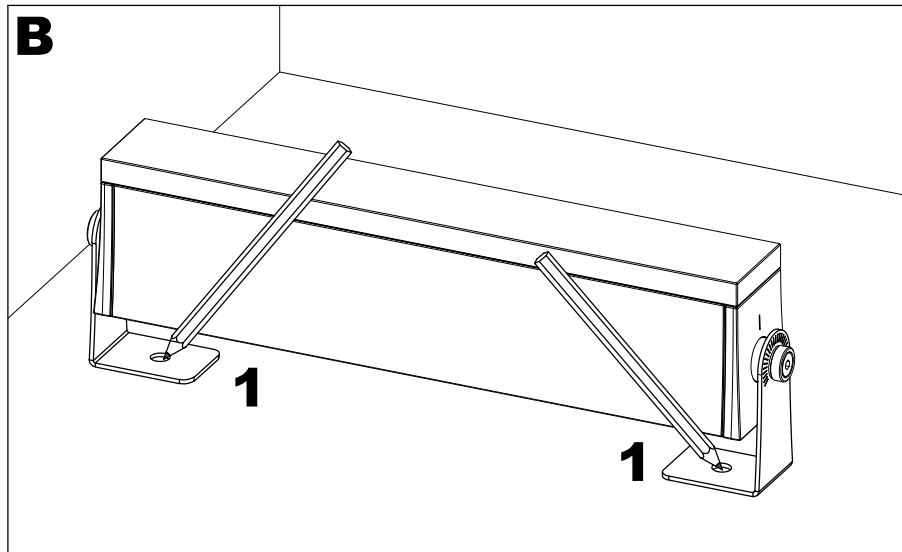
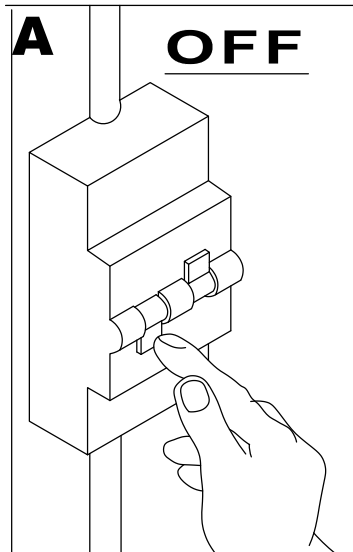
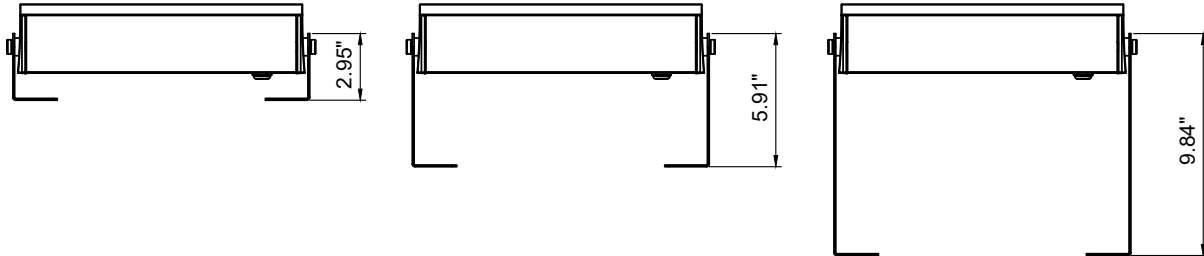

FOG 1 300 / 600 / 900 FLOODLIGHT

12W, 24W, 34W, REMOTE 24VDC

designplan®

installation instructions

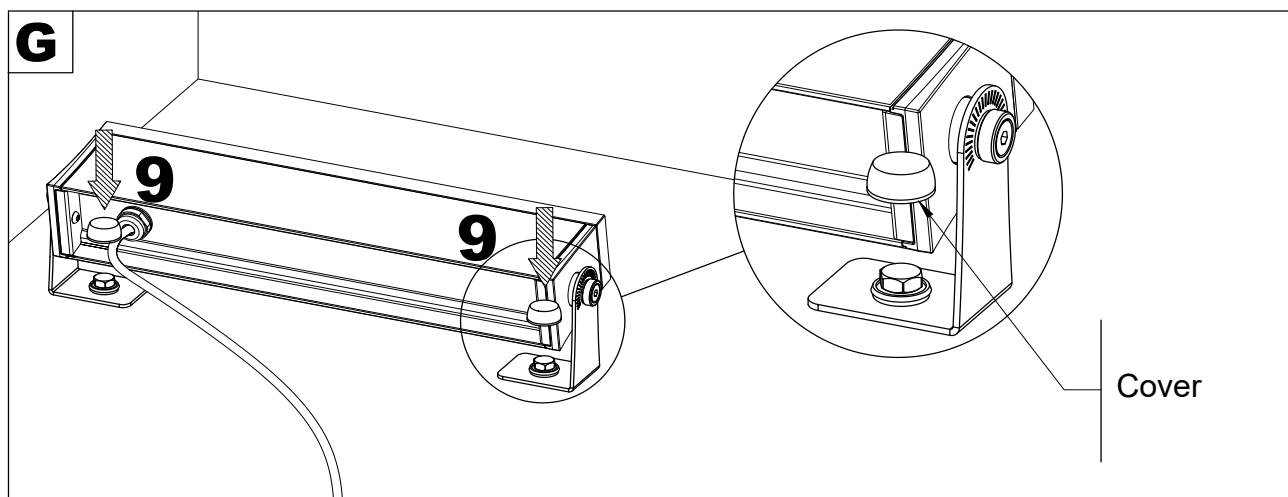
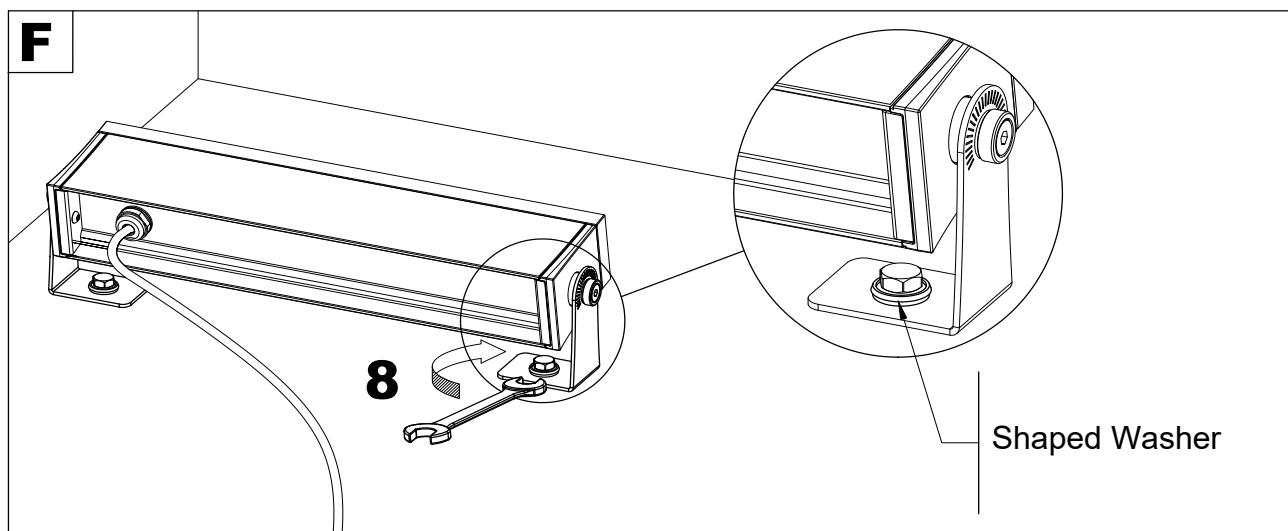
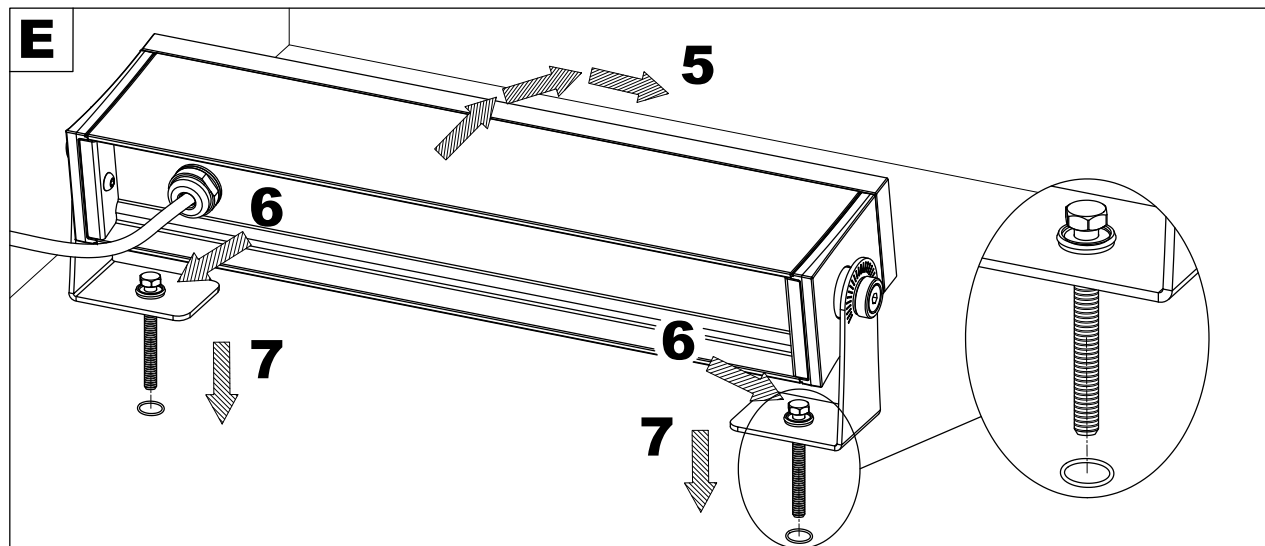

FOG 1 300 / 600 / 900 FLOODLIGHT

12W, 24W, 34W, REMOTE 24VDC

designplan®

installation instructions

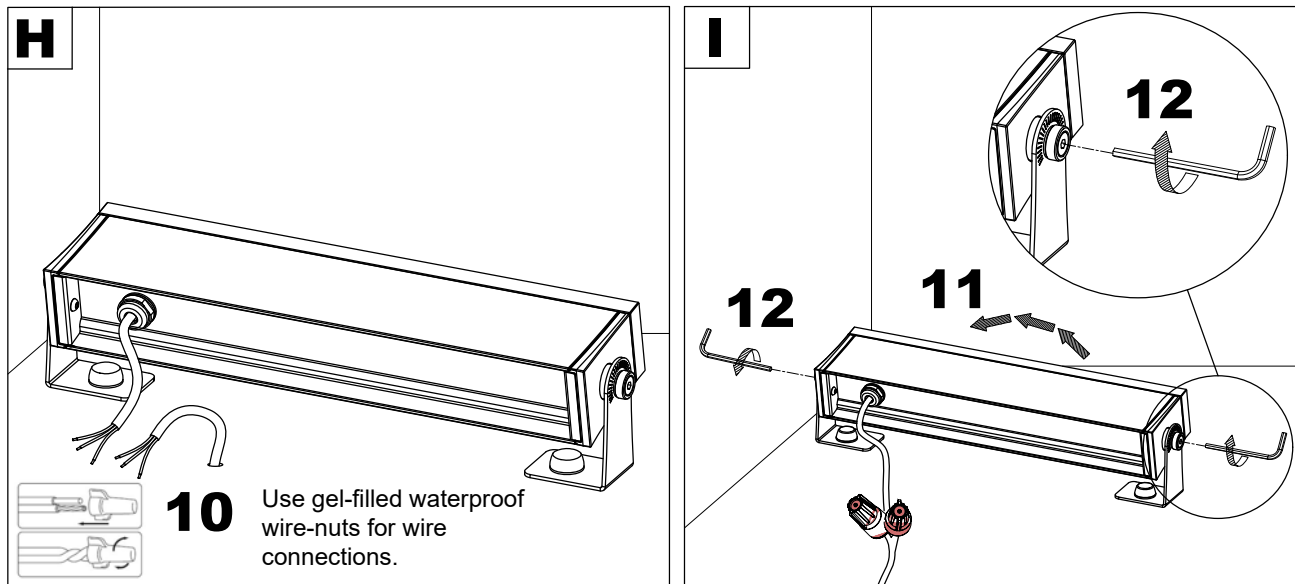

- It is the contractor's responsibility to caulk around the edges between the fixture and the mounting surface, to satisfy wet label requirements.

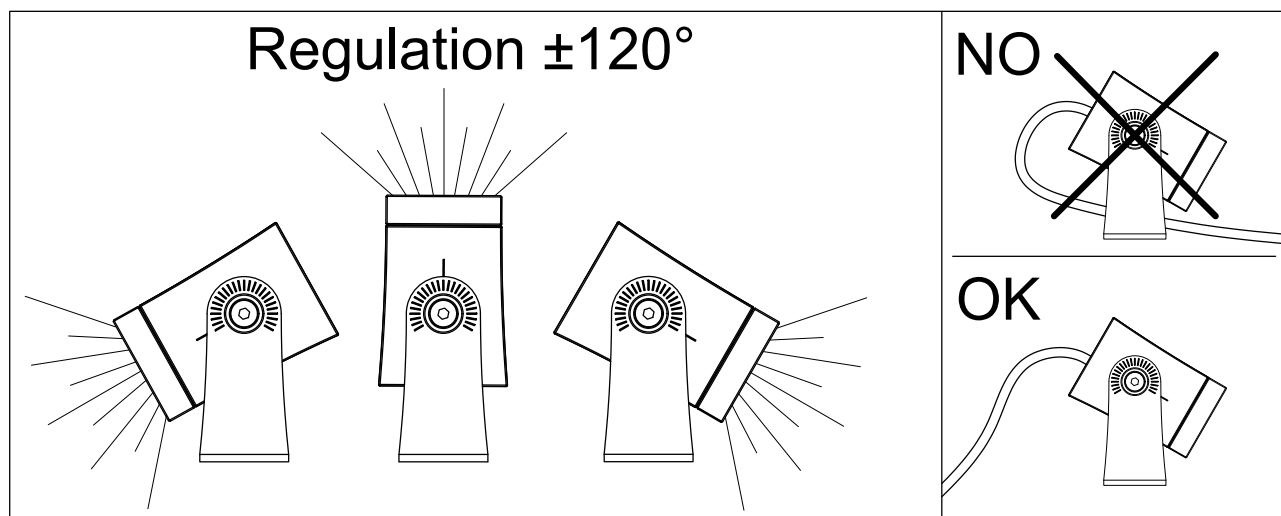

FGLxPRxDxx10x

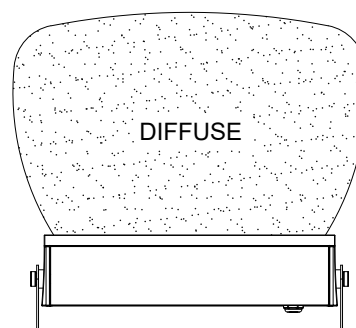

FOG 1 300 / 600 / 900 FLOODLIGHT

12W, 24W, 34W, REMOTE 24VDC



bracket installation instructions

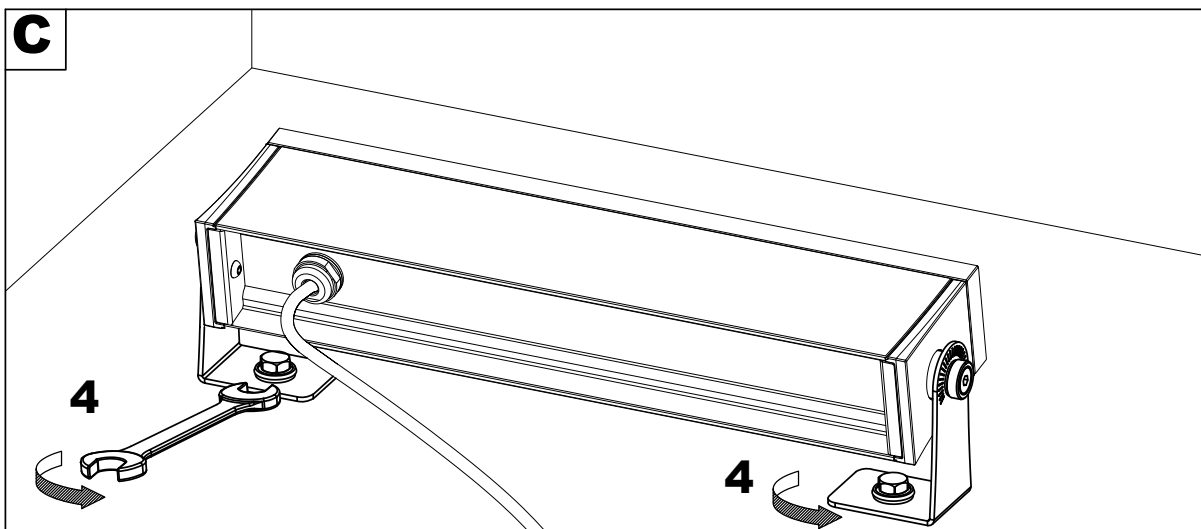
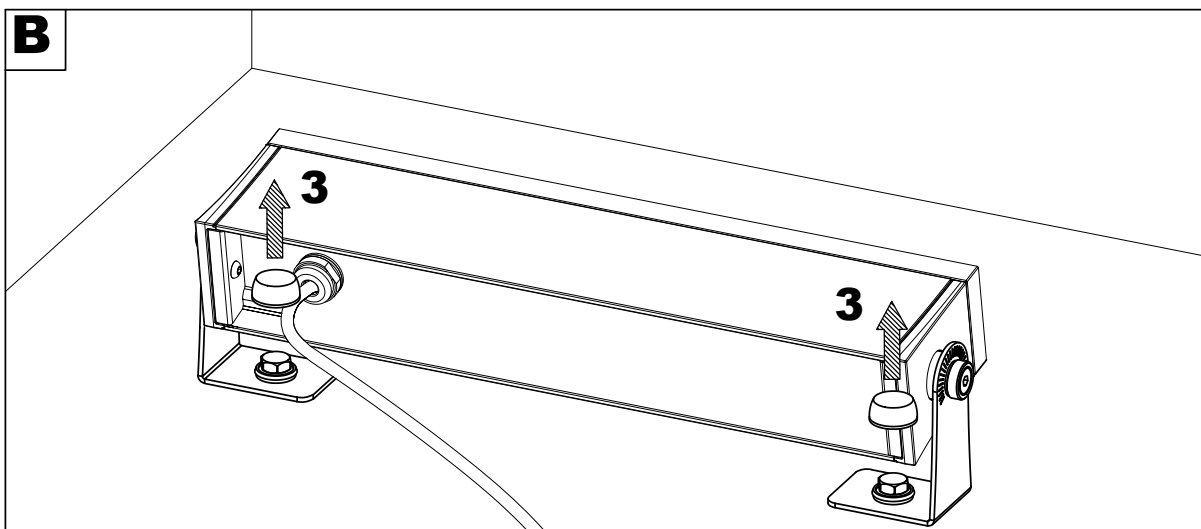
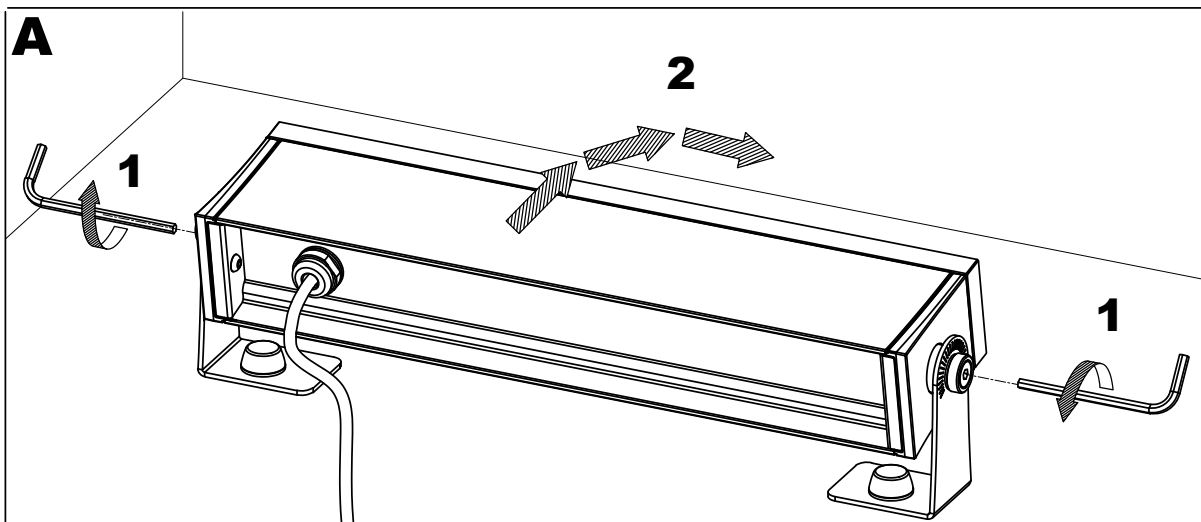

FOG 1 300 / 600 / 900 FLOODLIGHT



12W, 24W, 34W, REMOTE 24VDC

bracket installation instructions

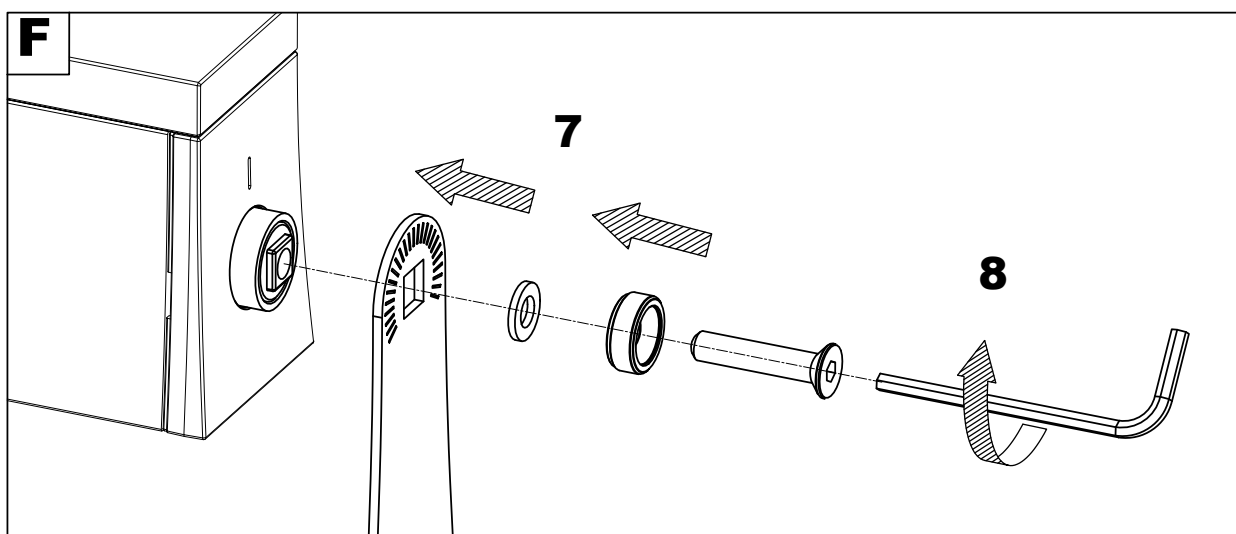
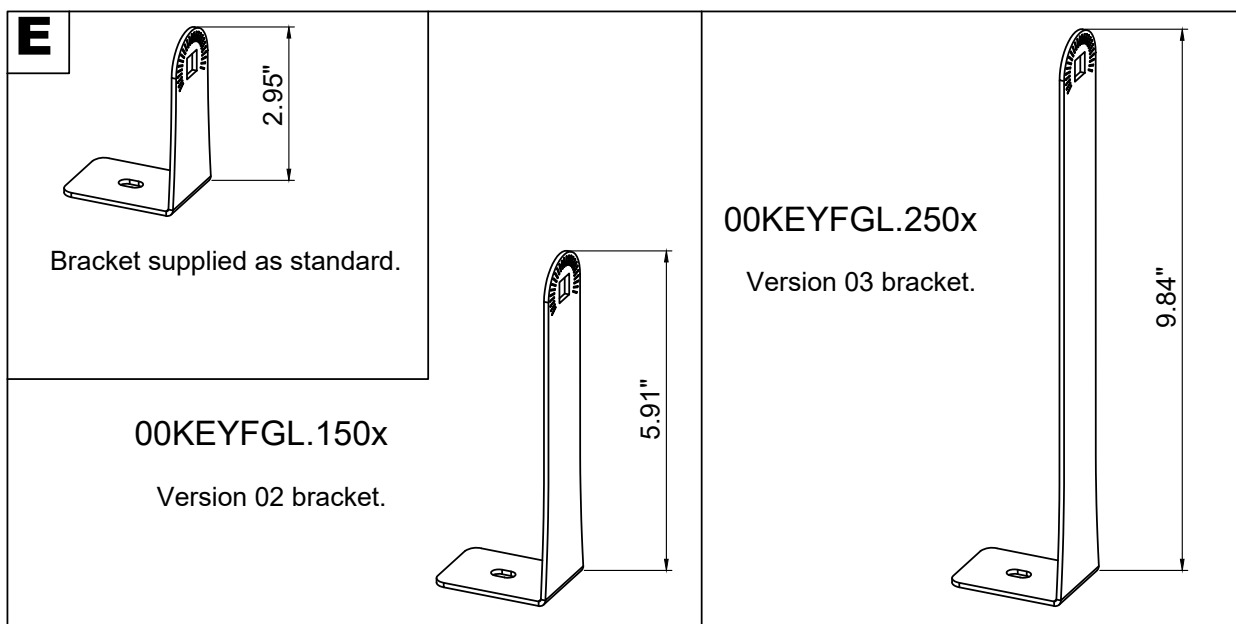
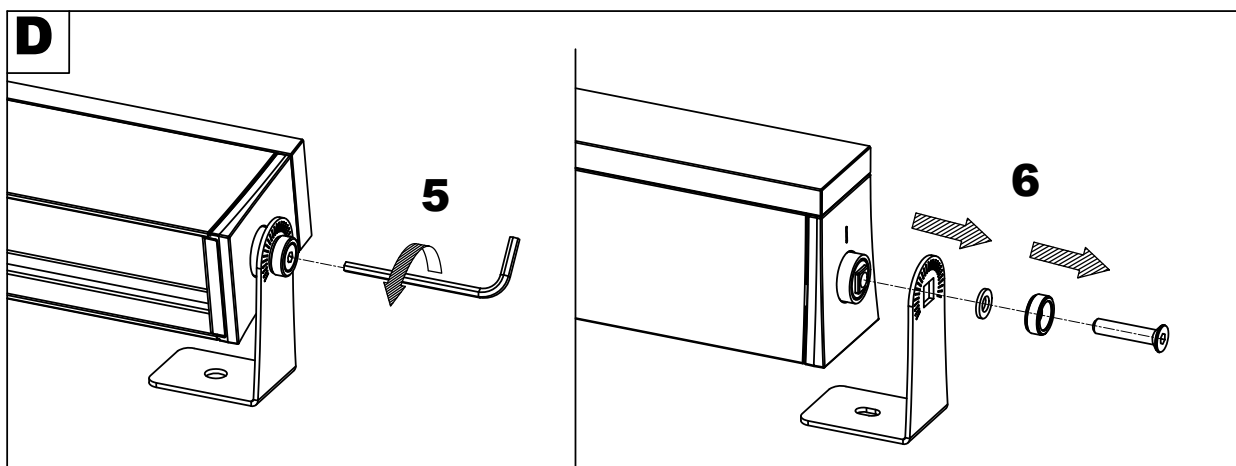

FOG 1 300 / 600 / 900 FLOODLIGHT

12W, 24W, 34W, REMOTE 24VDC



bracket installation instructions

