

NOVA

Registered Design

The Infinite
Possibilities

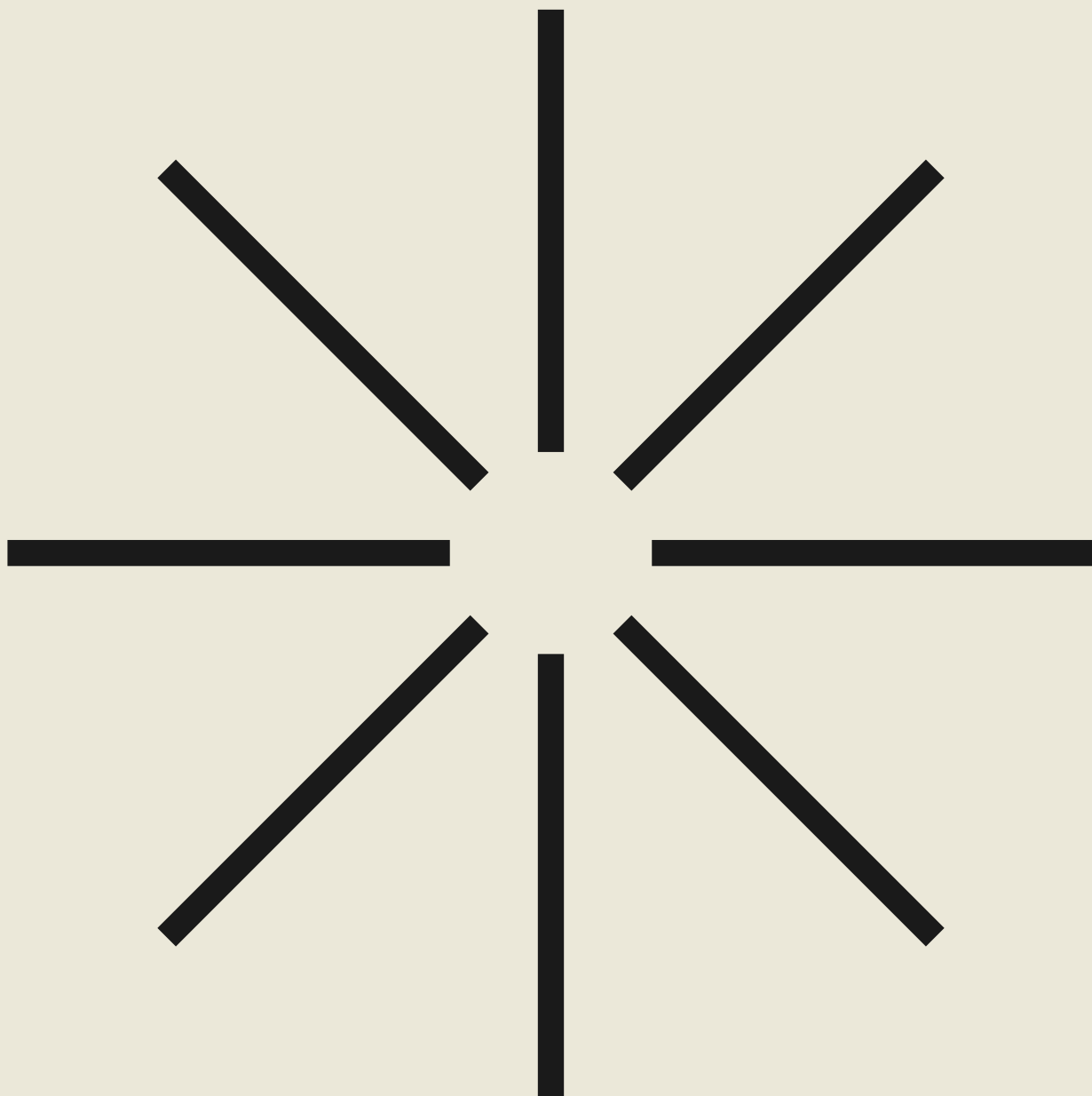

FRANCESCONI
ARCHITECTURAL LIGHT

designplan®

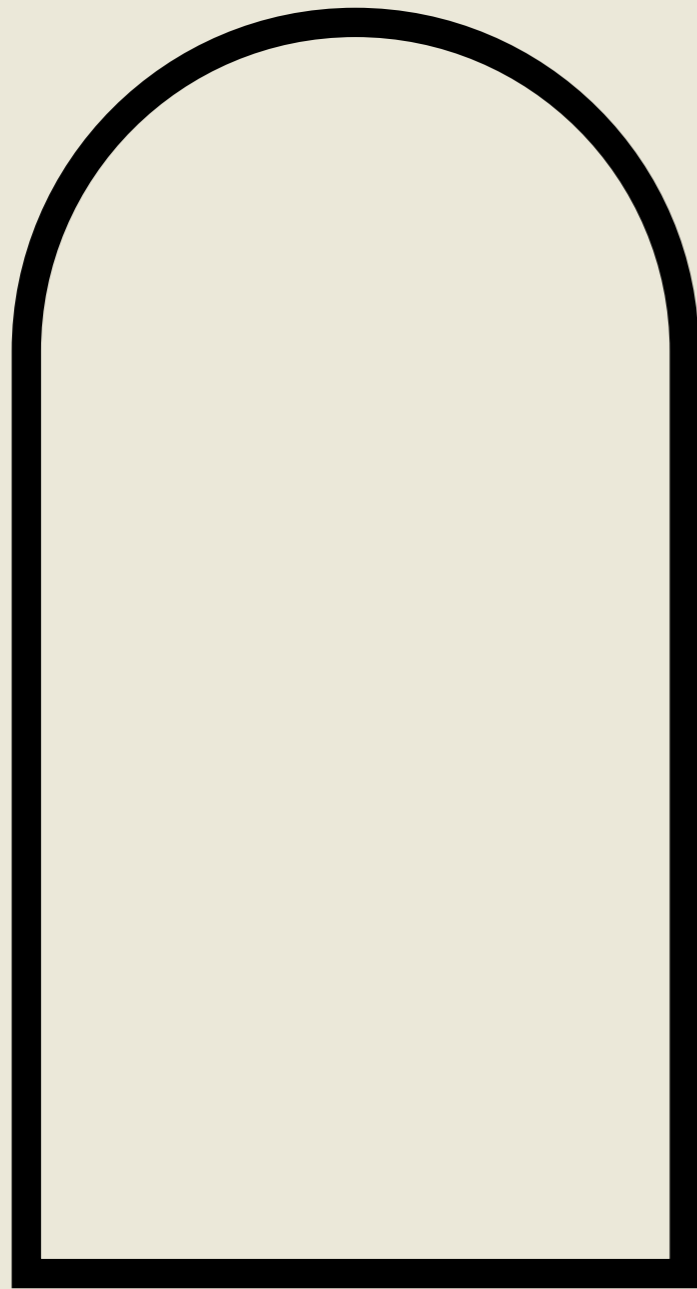

The Infinite possibilities

Design and functionality, indoor and outdoor, ambience and performance. Nova is a new generation of lamp for contemporary living. Architecturally inspired by the arch shape, Nova is a lighting technology that comes in different lengths, sizes and types. Nova has many different installation methods, allowing it to light-up any space with stylistic coherence.

Nova.

A new era begins.

An evolved product.

2

Nova has a versatility of applications that embraces all residential needs. From bollard lights to wall lights and more, Nova covers every outdoor function for a complete, dynamic, truly innovative and one-of-a-kind project.



3

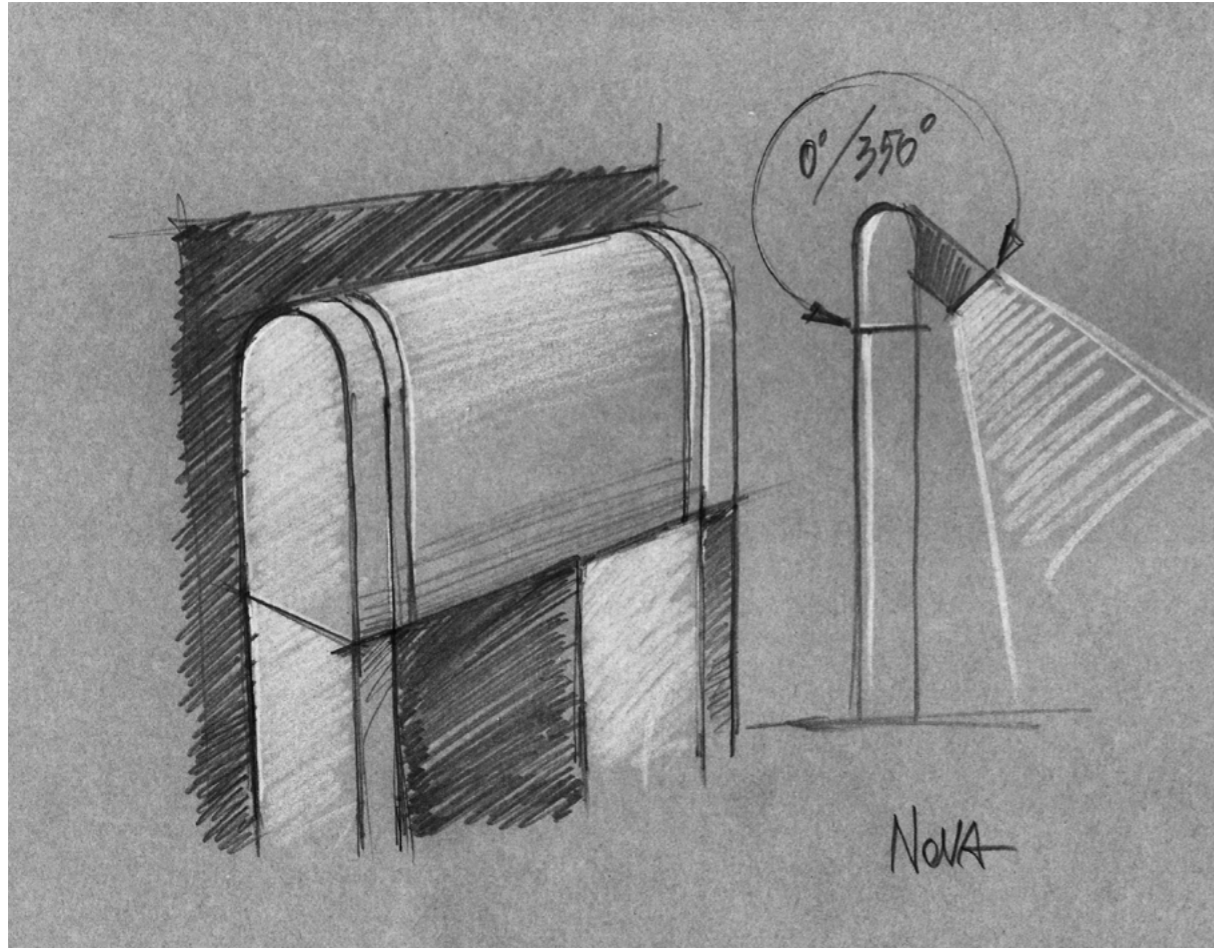

4

“Light is dynamic movement. Nova was born from the idea that light tells a different and unique story in every environment. Light elegantly adds movement to a world of static objects”.

G. M. Scutellà
Designer



5



6

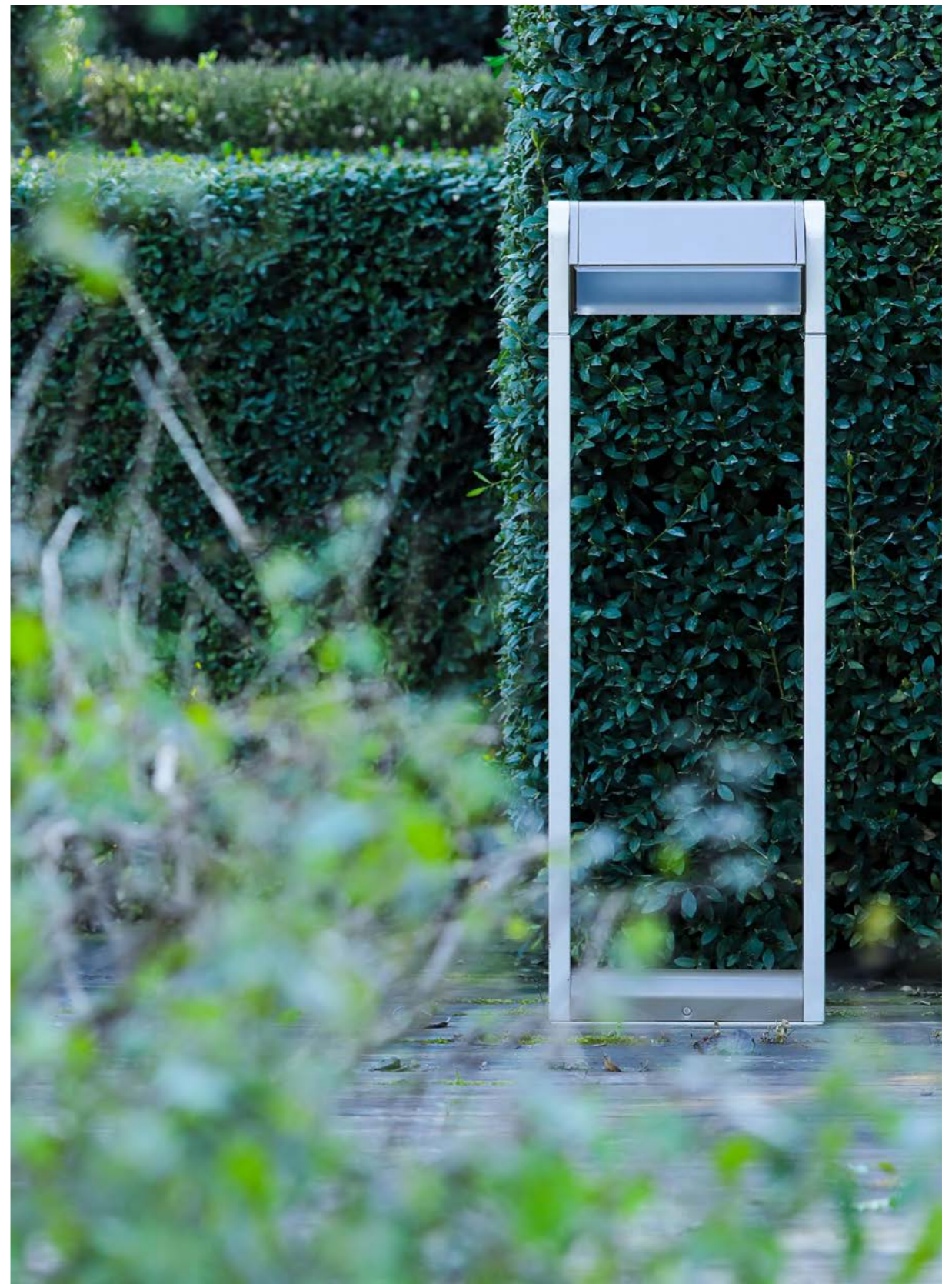

7

Put yourself in charge.



8

Nova has a light fixture that rotates from 0 to 355 degrees (up to 190 degrees for wall sconces). Maximum Adjustability to fulfill multiple needs from a single point. From the facade of a building to a single portion of driveway or pedestrian path: There is complete flexibility when it comes to light direction.



9

Minimal style to fit to every environment.

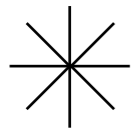

Nova is the coolest solution when adding light and style to any living context, both indoors and outdoors. From historic buildings to contemporary architecture, its minimal style is ideal for any space.





Two-Toned, A Unique Look.

14

Nova stands out thanks to its two different colors that clearly identify the structure, function, and movement of the product. The paintwork can be customized with colors that guarantee a 'wow' effect.

Anthracite
Grey aluminum



Titanium
Bronze

15

Sheer elegance with hidden cables and screws.

Nova keeps a secret: the total absence of visible cables and screws, which hides passionate technical and aesthetic work. All to restore the charm of a pure and basic design in an extremely solid structure. “How did they build this product?”, you may ask. Magic.



Beauty is nothing without power.

Nova combines a unique aesthetic with high performance technical engineering. Two motorizations – MidPower for lenses with diffused lighting effects and Power Led for lenses with concentrated lighting effects – which offer the best light intensity options in the most demanding spaces.

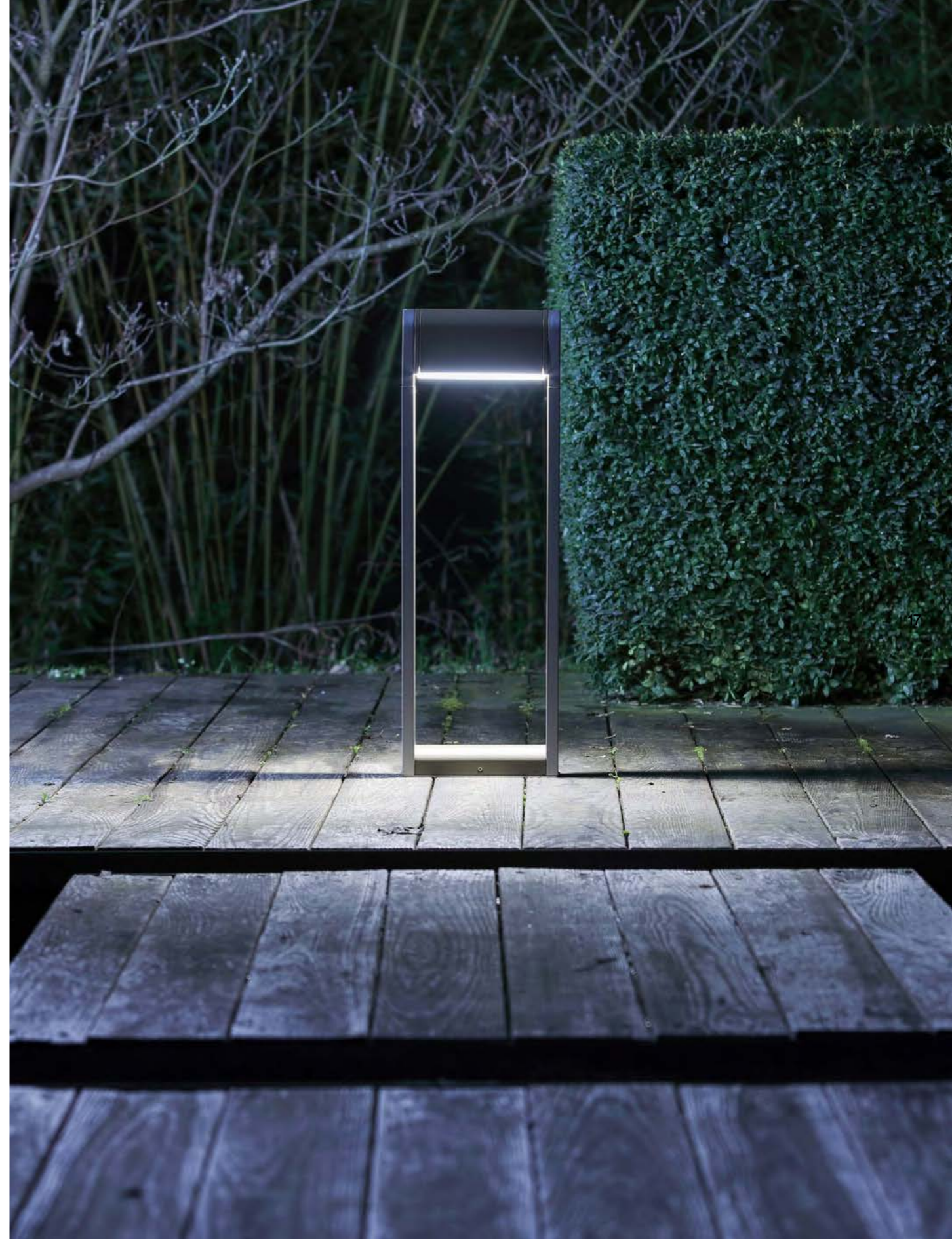

NOVA Collection

Registered design

6060T5 aluminum housing.
High resistance double painting process (UNI ISO9227:2012 saline test compliant).
A4 stainless steel sealing allen screws.
Extra clear tempered glass lens.
Silicon gasket.
Single cable input, pre-assembled with neoprene cable and IP68 water-stop fast connector.
Compliant EN60598-1 and related annex.

Fixed applique

Transparent glass thickness 0.20".
Fixing base in aluminum 6060T5.

18

Adjustable applique

Transparent glass thickness 0.20".
Fixing base in stainless steel 430.

Recessed - Trimless

Transparent glass thickness 0.20".
Recessing box in stainless steel 430.

Adjustable bollard

Sand blasted tempered glass lens with thickness 0.31".
Fixing base in stainless steel 430.

Adjustable spotlight

Support in aluminum 6060T5.
Fixing base in stainless steel 430.

Adjustable spotlight for pole

Fixing support in aluminum 6082

Fixed applique

Wall



Performance data

	MIDPOWER	POWERLED	MIDPOWER	POWERLED
Power	5.5	5.2	7.5	11.0
Output lumen 3000K	425 (.13)	540 (.01)	645 (.13)	1080 (.01)
Output lumen 4000K	450 (.13)	580 (.01)	685 (.13)	1160 (.01)
L90 lifetime Ta35°C(HRS)	41.000 hrs	38.000 hrs	41.000 hrs	38.000 hrs

Build data

	MIDPOWER	POWERLED	MIDPOWER	POWERLED
Class	I	I	I	I
Voltage	xxx 50-60Hz	xxx 50-60Hz	xxx 50-60Hz	xxx 50-60Hz
Power supply	Included ON-OFF	Included ON-OFF	Included ON-OFF	Included ON-OFF
External cable	Single input 3-poles neoprene	Single input 3-poles neoprene	Single input 3-poles neoprene	Single input 3-poles neoprene
Protection rating	IP65	IP65	IP65	IP65

Dimensions

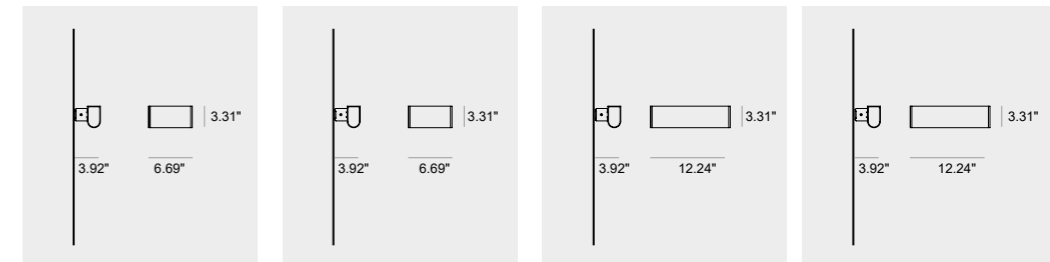

● Finish

	MIDPOWER	POWERLED	MIDPOWER	POWERLED
_1	Anthracite	Anthracite	Anthracite	Anthracite
_4	Grey (RAL 9006)	Grey (RAL 9006)	Grey (RAL 9006)	Grey (RAL 9006)
_P	Bronze	Bronze	Bronze	Bronze

■ CCT

	MIDPOWER	POWERLED	MIDPOWER	POWERLED
_2	2700°K - CRI >80	2700°K - CRI >80	2700°K - CRI >80	2700°K - CRI >80
_3	3000°K - CRI >80	3000°K - CRI >80	3000°K - CRI >80	3000°K - CRI >80
_4	4000°K - CRI >80	4000°K - CRI >80	4000°K - CRI >80	4000°K - CRI >80

▲ Beam

	MIDPOWER	POWERLED	MIDPOWER	POWERLED
_13	38°	10°	38°	10°
_23	90°	38°	90°	38°
_06	Asymmetric	Elliptical 10x40°	Asymmetric	Elliptical 10x40°

Code composition

	MIDPOWER	POWERLED	MIDPOWER	POWERLED
33201	● ■ ▲	● ■ ▲	● ■ ▲	● ■ ▲
33212	● ■ ▲	● ■ ▲	● ■ ▲	● ■ ▲
33202	● ■ ▲	● ■ ▲	● ■ ▲	● ■ ▲
33213	● ■ ▲	● ■ ▲	● ■ ▲	● ■ ▲

19

Adjustable applique

Wall



Performance data

Power	7.5	11.0	15.0	20.0
Output lumen 3000K	645 (.13)	1080 (.01)	1295 (.13)	2170 (.01)
Output lumen 4000K	685 (.13)	1160 (.01)	1375 (.13)	2330 (.01)
L90 lifetime Ta35°C(HRS)	41.000 hrs	38.000 hrs	41.000 hrs	38.000 hrs

Build data

Class	I	I	I	I
Voltage	xxx 50-60Hz	xxx 50-60Hz	xxx 50-60Hz	xxx 50-60Hz
Power supply	Included ON-OFF	Included ON-OFF	Included ON-OFF	Included ON-OFF
External cable	Single input 3-poles neoprene	Single input 3-poles neoprene	Single input 3-poles neoprene	Single input 3-poles neoprene
Protection rating	IP65	IP65	IP65	IP65

Dimensions

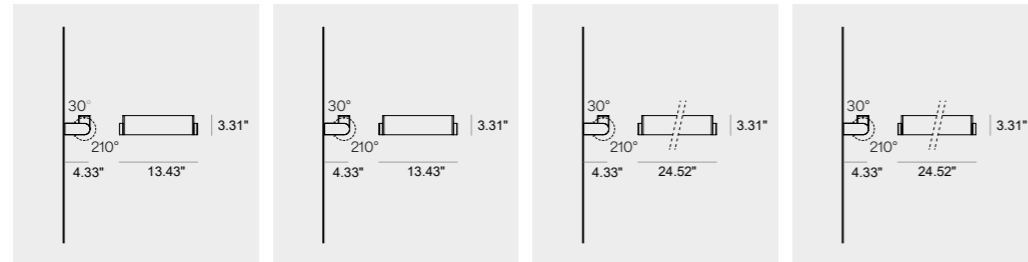

● Finish	_N Anthracite + Grey	_N Anthracite + Grey	_N Anthracite + Grey	_N Anthracite + Grey
	_O Titanium + Bronze	_O Titanium + Bronze	_O Titanium + Bronze	_O Titanium + Bronze

■ CCT	_2 2700°K - CRI >80	_2 2700°K - CRI >80	_2 2700°K - CRI >80	_2 2700°K - CRI >80
	_3 3000°K - CRI >80	_3 3000°K - CRI >80	_3 3000°K - CRI >80	_3 3000°K - CRI >80
	_4 4000°K - CRI >80	_4 4000°K - CRI >80	_4 4000°K - CRI >80	_4 4000°K - CRI >80

▲ Beam	_13 38°	_01 10°	_13 38°	_01 10°
	_23 90°	_13 38°	_23 90°	_13 38°
	_06 Asymmetric	_38 Elliptical 10x40°	_06 Asymmetric	_38 Elliptical 10x40°

Code composition	33215	33228	33216	33229
	● ■ ▲	● ■ ▲	● ■ ▲	● ■ ▲

Adjustable applique

Wall



Performance data

Power	21.0	29.0	28.0	38.0
Output lumen 3000K	1945 (.13)	3250 (.01)	2595 (.13)	4340 (.01)
Output lumen 4000K	2060 (.13)	3495 (.01)	2753 (.13)	4465 (.01)
L90 lifetime Ta35°C(HRS)	41.000 hrs	38.000 hrs	41.000 hrs	38.000 hrs

Build data

Class	I	I	I	I
Voltage	xxx 50-60Hz	xxx 50-60Hz	xxx 50-60Hz	xxx 50-60Hz
Power supply	Included ON-OFF	Included ON-OFF	Included ON-OFF	Included ON-OFF
External cable	Single input 3-poles neoprene	Single input 3-poles neoprene	Single input 3-poles neoprene	Single input 3-poles neoprene
Protection rating	IP65	IP65	IP65	IP65

Dimensions

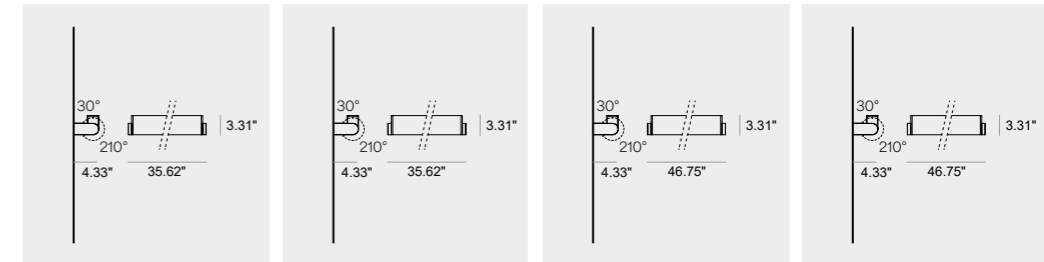

● Finish	_N Anthracite + Grey	_N Anthracite + Grey	_N Anthracite + Grey	_N Anthracite + Grey
	_O Titanium + Bronze	_O Titanium + Bronze	_O Titanium + Bronze	_O Titanium + Bronze

■ CCT	_2 2700°K - CRI >80	_2 2700°K - CRI >80	_2 2700°K - CRI >80	_2 2700°K - CRI >80
	_3 3000°K - CRI >80	_3 3000°K - CRI >80	_3 3000°K - CRI >80	_3 3000°K - CRI >80
	_4 4000°K - CRI >80	_4 4000°K - CRI >80	_4 4000°K - CRI >80	_4 4000°K - CRI >80

▲ Beam	_13 38°	_01 10°	_13 38°	_01 10°
	_23 90°	_13 38°	_23 90°	_13 38°
	_06 Asymmetric	_38 Elliptical 10x40°	_06 Asymmetric	_38 Elliptical 10x40°

Code composition	33217	33230	33218	33231
	● ■ ▲	● ■ ▲	● ■ ▲	● ■ ▲

Recessed - Trimless

Floor

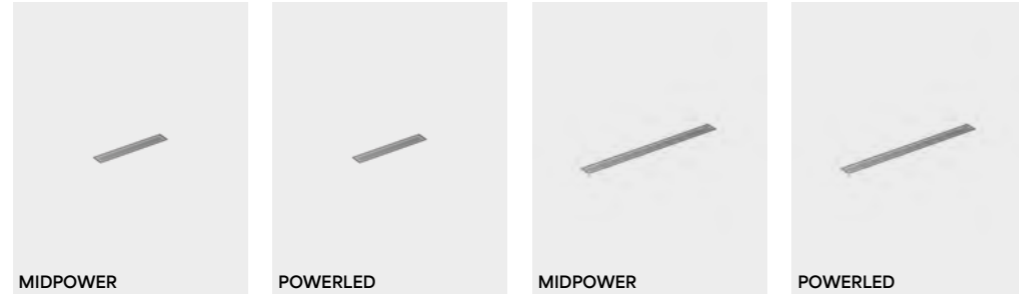

Performance data

Power	7.5	11.0	15.0	20.0
Output lumen 3000K	645 (.13)	1080 (.01)	1295 (.13)	2170 (.01)
Output lumen 4000K	685 (.13)	1160 (.01)	1375 (.13)	2330 (.01)
L90 lifetime Ta35°C(HRS)	41.000 hrs	38.000 hrs	41.000 hrs	38.000 hrs

Build data

Class	I	I	I	I
Voltage	xxx 50-60Hz	xxx 50-60Hz	xxx 50-60Hz	xxx 50-60Hz
Power supply	Included ON-OFF	Included ON-OFF	Included ON-OFF	Included ON-OFF
External cable	Single input 3-poles neoprene	Single input 3-poles neoprene	Single input 3-poles neoprene	Single input 3-poles neoprene
Protection rating	IP67 - Max load 2205 lbs	IP67 - Max load 2205 lbs	IP67 - Max load 2205 lbs	IP67 - Max load 2205 lbs

Dimensions

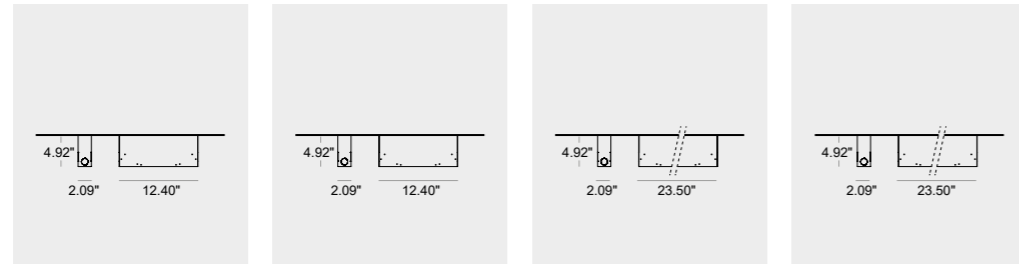

● Finish

_09 Total Glass

■ CCT

_2 2700°K - CRI >80
 _3 3000°K - CRI >80
 _4 4000°K - CRI >80

▲ Beam

_13 38°
 _23 90°
 _06 Asymmetric
 _01 10°
 _13 38°
 _23 90°
 _38 Elliptical 10x40°

Code composition

13201 13211 13202 13212

Recessed - Trimless

Floor

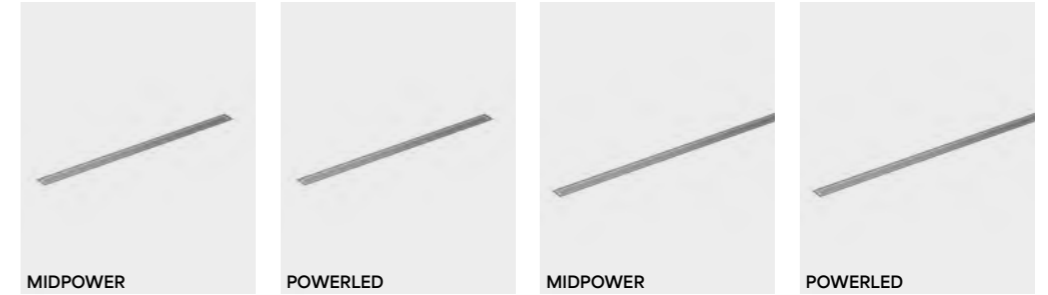

Performance data

Power	21.0	29.0	28.0	38.0
Output lumen 3000K	1945 (.13)	3250 (.01)	2595 (.13)	4340 (.01)
Output lumen 4000K	2060 (.13)	3495 (.01)	2753 (.13)	4665 (.01)
L90 lifetime Ta35°C(HRS)	41.000 hrs	38.000 hrs	41.000 hrs	38.000 hrs

Build data

Class	I	I	I	I
Voltage	xxx 50-60Hz	xxx 50-60Hz	xxx 50-60Hz	220-240V 50-60Hz
Power supply	Included ON-OFF	Included ON-OFF	Included ON-OFF	Included ON-OFF
External cable	Single input 3-poles neoprene	Single input 3-poles neoprene	Single input 3-poles neoprene	Single input 3-poles neoprene
Protection rating	IP67 - Max load 1000 KGS	IP67 - Max load 1000 KGS	IP67 - Max load 1000 KGS	IP67 - Max load 1000 KGS

Dimensions

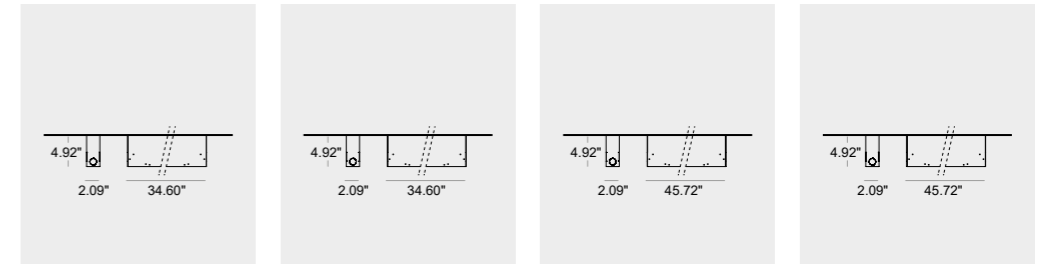

● Finish

_09 Total Glass

■ CCT

_2 2700°K - CRI >80
 _3 3000°K - CRI >80
 _4 4000°K - CRI >80

▲ Beam

_13 38°
 _23 90°
 _06 Asymmetric
 _01 10°
 _13 38°
 _23 90°
 _38 Elliptical 10x40°

Code composition

13203 13213 13204 13214

Adjustable bollard

Floor



Performance data

Power	5.5	5.5
Output lumen 3000K	275	275
Output lumen 4000K	295	295
L90 lifetime Ta35°C(HRS)	41.000 hrs	41.000 hrs

Build data

Class	I	I
Voltage	xxx 50-60Hz	xxx 50-60Hz
Power supply	Included ON-OFF	Included ON-OFF
External cable	Single input 3-poles neoprene	Single input 3-poles neoprene
Protection rating	IP65	IP65

Dimensions

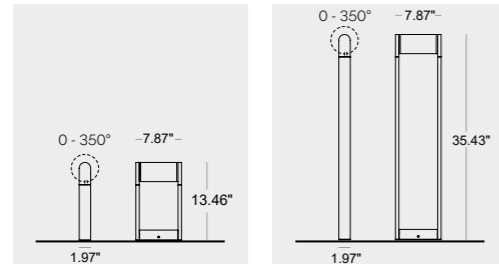

Accessories

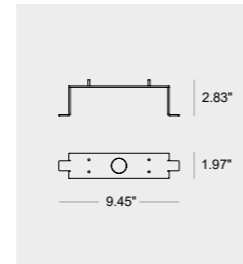

Coach plate
A1804

● Finish	_N Anthracite + Grey	_N Anthracite + Grey
	_O Titanium + Bronze	_O Titanium + Bronze

■ CCT	_2 2700°K - CRI >80	_2 2700°K - CRI >80
	_3 3000°K - CRI >80	_3 3000°K - CRI >80
	_4 4000°K - CRI >80	_4 4000°K - CRI >80

▲ Beam	_05 Diffused	_05 Diffused
---------------	--------------	--------------

Code composition 63201
● ■ ▲

Adjustable spotlight

Floor



Performance data

Power	5.0	5.0
Output lumen 3000K	540 (.01)	540 (.01)
Output lumen 4000K	580 (.01)	580 (.01)
L90 lifetime Ta35°C(HRS)	38.000 hrs	38.000 hrs

Build data

Class	I	I
Voltage	xxx 50-60Hz	xxx 50-60Hz
Power supply	Included ON-OFF	Included ON-OFF
External cable	Single input 3-poles neoprene	Single input 3-poles neoprene
Protection rating	IP65	IP65
Emission	Adjustable	Adjustable

Dimensions

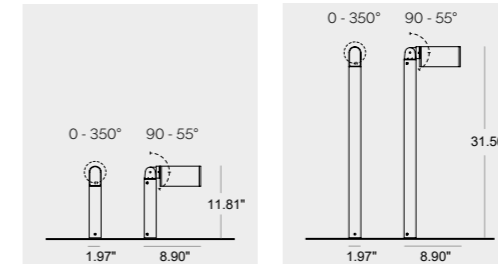

Accessories

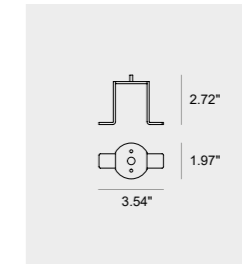

Coach plate
A1805

● Finish	_N Anthracite + Grey	_N Anthracite + Grey
	_O Titanium + Bronze	_O Titanium + Bronze

■ CCT	_2 2700°K - CRI >80	_2 2700°K - CRI >80
	_3 3000°K - CRI >80	_3 3000°K - CRI >80
	_4 4000°K - CRI >80	_4 4000°K - CRI >80

▲ Beam	_01 10°	_01 10°
	_13 38°	_13 38°
	_38 Elliptical 10x40°	_38 Elliptical 10x40°

Code composition 43201
● ■ ▲

Adjustable spotlight for pole

Pole



Performance data

Power	5.0
Output lumen 3000K	540 (.01)
Output lumen 4000K	580 (.01)
L90 lifetime Ta35°C(HRS)	38.000 hrs

Build data

Class	I
Voltage	xxx 50-60Hz
Power supply	Included ON-OFF
External cable	Single input 3-poles neoprene
Protection rating	IP65
Emission	Adjustable

Dimensions

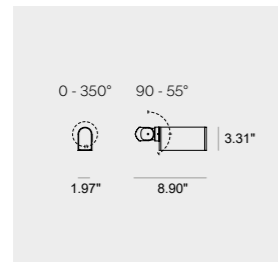

● Finish	_N Anthracite + Grey
	_O Titanium + Bronze

■ CCT	_2 2700°K - CRI >80
	_3 3000°K - CRI >80
	_4 4000°K - CRI >80

▲ Beam	_01 10°
	_13 38°
	_38 Elliptical 10x40°

Code composition 43212



Technical data

WALL SURFACE

Ground distance 13.12'

RECESSED FLOOR

Wall distance 1.31'

Wall distance 0.66'



SPOTLIGHT

Ground distance 0.98'

POWERLED

10°



38°



10x40°



Ground distance 2.62'

POWERLED

10°



38°



10x40°



BOLLARD

Ground distance 0.98'
Ground distance 2.95'

MIDPOWER

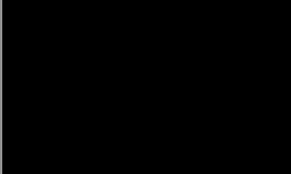

SPOTLIGHT FOR POLE

Ground distance 11.48'

POWERLED

10°



38°



10x40°



Giuseppe Maurizio Scutellà

An industrial designer attentive and sensitive to the most significant and heterogeneous design and artistic currents, he combines within his proposal a dual soul: technical and artistic. Free to use 'Form Follows Function' or 'Function Follows Form' depending on the theme addressed, he has a significant technical background. At the Light&Building in Frankfurt 2022, he presents the Architectural/Outdoor 'NOVA' lighting collection with Francesconi architectural Light.

Characteristics of the mentioned products, technical and photometric details and dimensional features are not binding. Without any prior notice, our company retains the right to perform any modification deemed necessary to our needs. Any commercial name, brand, graphic design or logo hereby represented is sole property of the rightful owners, and is used solely for the sake of comprehension. Reproduction, even partial, of this catalogue is strictly forbidden.

FRANCESCONI

Graphic design and Art direction
OSMO Design Studio

Copywriting
Paolo Mensitieri

UNI ISO 9001:2015 CERTIFICATION

© Francesconi 2023 tutti i diritti riservati

FRANCESCONI

ARCHITECTURAL LIGHT

“To celebrate our 70th birthday, we felt the need to introduce a strong, distinguishing element. An original, distinctive shape, capable of conveying emotions. In this sense, Nova is truly a new beginning for us”

Filippo Badinelli

CEO Francesconi Light