

EGO / EGO MAXI Recessed

EGO and EGO MAXI Recessed are round in-grade uplights in 2 sizes, with a marine grade stainless steel 316L housing (galvanized treatment on request) making it suitable for a variety of outdoor installations. They are available in 3 color temperatures and 4 optics options.



EGO



EGO MAXI

Fixture Dimensions - see page 2



TECHNICAL DATA

Wattage	9W (EGO - 200mA), 12W (EGO MAXI - TBD)
Power Supply	Remote, not included - See page 2
Construction	Housing: Marine Grade Stainless Steel 316L Lens: Extra Clear Tempered Glass
CCT	2700K, 3000K, 4000K
BUG Rating	B0-U5-G0 (EGO 12°, 38° - 3000K) B0-U4-G0 (EGO 24°, Wall Washer - 3000K) B0-U5-G0 (EGO MAXI 12°, 24°, 38°)
CRI	>80
Delivered Lumens	1134 lm (EGO - 3000K) 1430 lm (EGO MAXI - 3000K)
Efficacy	126 lm/W (EGO) 119.2 lm/W (EGO MAXI)
Optics	12°, 24° 38°, Wall Wash (Not available on MAXI)
Finishes	Stainless Steel ASIS 316L
Lumen Maintenance	55,000 hrs (Ta 35°C)
Fixture Dimensions	Ø5.20" x 4.76" (EGO) Ø8.03" x 6.06" (EGO MAXI)
IP Rating	IP67
Impact Resistance	IK08

ORDERING INFORMATION

Example: F10401.6.3.12.US. Power Supplies ordered separately.

	6			.US
Model No.	Finish	CCT	Optics	
F10401 - EGO	6 - ASIS 316L Stainless Steel	2 - 2700K	11 - 12° Spot	.US
F10423 - EGO MAXI		3 - 3000K	12 - 24° Medium	
		4 - 4000K	13 - 38° Wide	
		07 - Wall Washer	<i>WW (07) not available on EGO MAXI</i>	

Job Name/Date:

Fixture Type Designation:

FIXTURE DIMENSIONS

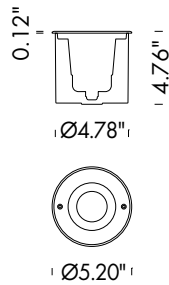

EGO

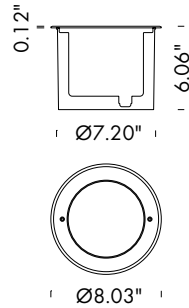

EGO MAXI

SUGGESTED POWER SUPPLIES

200mA - for EGO 9W version (F10401)

Part Number	Description	Input/Output	# of Fixtures
PPLT00465-P	0-10V Dimming to 1.0%	120-277VAC to 200mA, 20W, Class 2, DAMP	1-1
PPLT00309-P	0-10V Dimming to 0.1%	120-277VAC to 200mA, 50W, Class 2, DAMP	1-1
PPLT00538-P	0-10V Dimming to 0.1%	120-277VAC to 200mA, 100W, Class 2	1-4

For other power supply options consult factory.

SUGGESTED POWER SUPPLIES for EGO MAXI 12W version (F10423)

Consult Factory

Job Name/Date:

Fixture Type Designation:

PHOTOMETRIC DATA

Note all Photometry is 3000K

12°

Maximum Candela = 6052.3

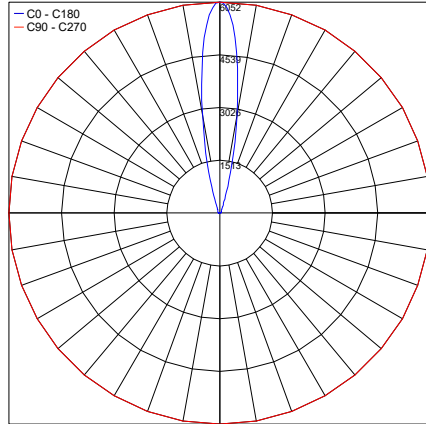

PHOTOMETRIC FILENAME : EGO RECESSED 30K 12° - 10401.X.3.11.IES

24°

Maximum Candela = 2302.3

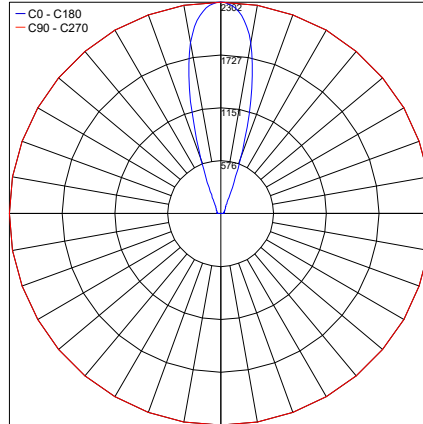

PHOTOMETRIC FILENAME : EGO RECESSED 30K 24° - 10401.X.3.12.IES

38°

Maximum Candela = 1967.6

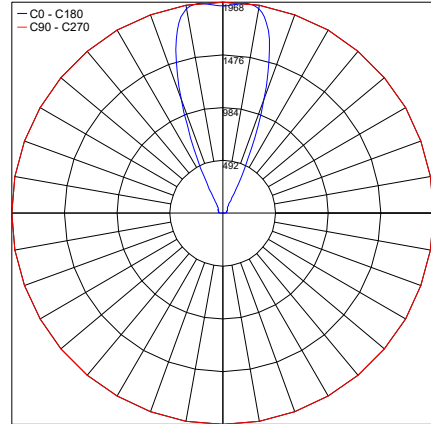

PHOTOMETRIC FILENAME : EGO RECESSED 30K 38° - 10401.X.3.13.IES

Wall Washer

Maximum Candela = 652.6

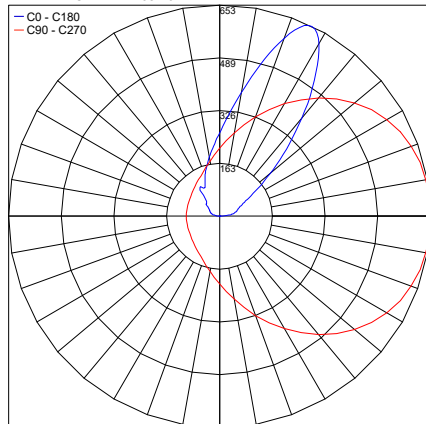

PHOTOMETRIC FILENAME : EGO RECESSED 30K WALL WASHER - 10401.X.3.07.IES

12°

Maximum Candela = 7555.1

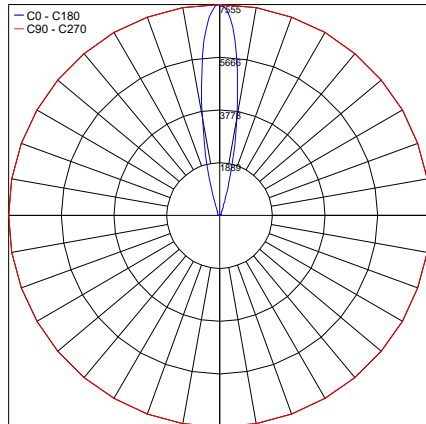

PHOTOMETRIC FILENAME : EGO MAXI FLOOD 30K 12° - 40423.X.3.11.IES

24°

Maximum Candela = 2900.9

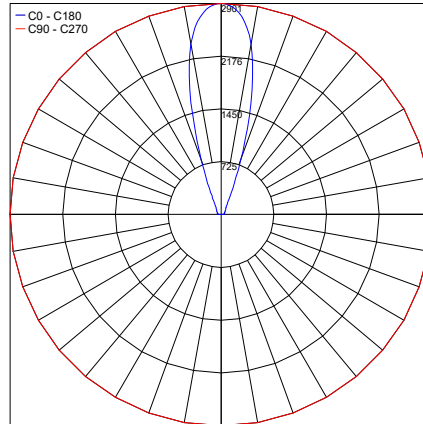

PHOTOMETRIC FILENAME : EGO MAXI FLOOD 30K 24° - 40423.X.3.12.IES

38°

Maximum Candela = 2479.1

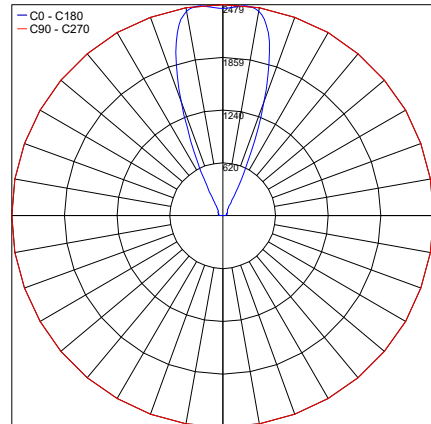

PHOTOMETRIC FILENAME : EGO MAXI FLOOD 30K 38° - 40423.X.3.13.IES

Job Name/Date:

Fixture Type Designation: