

Oris IP65 is a recessed luminaire made of Coral Waterout® for installation in walls or ceilings inside spas, wellness clubs or moist environments as well as outdoor areas. It has an aperture of Ø7.9" with a wide 40° beam and 3000K as standard.



## TECHNICAL DATA

<b>Wattage / Input</b>	40W (1050mA - BU5381) 2 x 6.5W (350mA - BU5388)
<b>Power Supply</b>	Remote, not included. See page 2.
<b>Construction</b>	Body: Coral Waterout®
<b>CCT</b>	3000K (2700K, 4000K on request)
<b>CRI</b>	>90
<b>BUG Rating</b>	B1-U0-G0
<b>LED Lumens</b>	2589 lm (3000K)
<b>Efficacy</b>	64.7 lm/W (3000K)
<b>Optics</b>	40° Wide Beam
<b>Finishes</b>	Unfinished
<b>Fixture Dimensions</b>	Ø10.2" x 6.3" h
<b>Cut-Out Dimensions</b>	Ø10.7"
<b>Aperture</b>	Ø7.9"
<b>Fixture Weight</b>	8.8 lbs
<b>IP Rating</b>	IP65

The body is made of Coral WaterOut® a unique patented composite material highly resistant to water penetration - made from modifying the structure of Coral®. This water-repellant effect remains unchanged over time as it is not a matter of a superficial finish, but rather a structural feature of the material itself.

This material is therefore ideally suited to IP65/IP44-rated recessed lighting, suitable for use in external environments, and ideal for light systems in spas, wellness clubs, massage centres, swimming-pools, bathrooms, and all other locations where water and humidity restrict the choice of technical lighting.

Fixture Dimensions

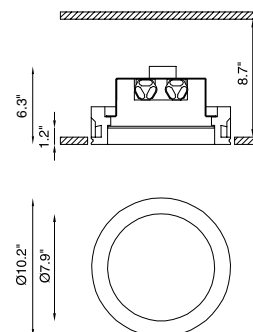

## ORDERING INFORMATION

Example: BU5388.27.CW.US. Accessories / Power Supplies ordered separately.

		<b>CW</b>	<b>US</b>
<b>Model No.</b>	<b>CCT</b>	<b>Finish</b>	
<b>BU5381</b> (40W)	<b>30</b> - 3000K (standard)	<b>CW</b> - Coral Waterout®	<b>US</b>
<b>BU5388</b> (2 x 6.5W)	<b>27</b> - 2700K (on request)		
	<b>40</b> - 4000K (on request)		

Job Name/Date:

Fixture Type Designation:

**SUGGESTED POWER SUPPLIES**

1050mA - 40W

Part Number	Description	Input/Output	# of Fixtures - 40W
<a href="#">PPLT00467-P</a>	0-10V Dimming to 1.0%	120-277VAC to 1050mA, 50W, Class 2, DAMP	1-1
<a href="#">PPLT00679</a>	0-10V Dimming to 10%	120-277VAC to 1050mA, 100W, Class 2	2-2

**SUGGESTED POWER SUPPLIES**

350mA - 2x6.5W

Part Number	Description	Input/Output	# of Fixtures - 2x6.5W
<a href="#">PPLT00468</a>	Phase Dim (120V only)	120VAC to 350mA, 14W, Class 2	1-1
<a href="#">PPLT00480-P</a>	0-10V Dimming to 1.0%	120-277VAC to 350mA, 30W, Class 2, DAMP	1-2
<a href="#">PPLT00263</a>	Leading / Trailing Edge Dimming to 10% (120V only)	120-277VAC to 350mA, 32W, Class 2	1-1
<a href="#">PPLT00467-P</a>	0-10V Dimming to 1.0%	120-277VAC to 350mA, 50W, Class 2, DAMP	1-2
<a href="#">PPLT00561-P</a>	0-10V Dimming to 0.1%	120-277VAC to 350mA, 100W, Class 2	1-2

**Suggested Lutron Compatible**

Part Number	Option	Lutron SKU	Dim Range	Description	Input/Output	# of Fixtures
<a href="#">PPLT00516</a>	L3DAE / L3DA3W	L3DA	100%-1%	Hi-Lume™ 1% EcoSystem™ or 1% 3-Wire LED Driver	120-277VAC to 350mA, 13W, Class 2	1-1

*For other power supply options consult factory.***PHOTOMETRIC DATA***Note: All Photometry is 3000K*

Maximum Candela = 3936.7

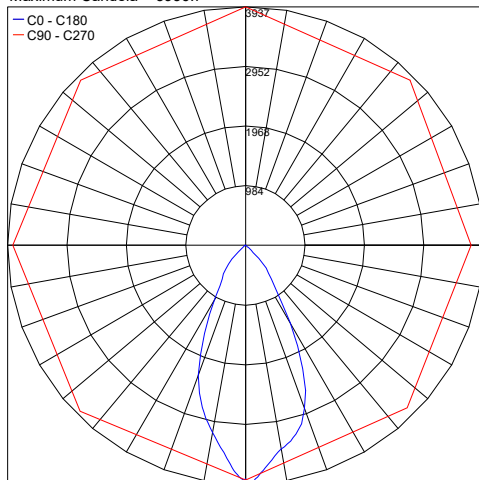
**ACCESSORIES****Installation****BR5388LT**

Back Box

*Job Name/Date:**Fixture Type Designation:*