



INSTRUCTIONS PERTAINING TO RISK OF FIRE OR INJURY TO PERSONS. READ ALL INSTRUCTIONS. IMPORTANT SAFETY INSTRUCTIONS. SAVE THESE INSTRUCTIONS.

DANGER - RISK OF SHOCK - DISCONNECT POWER BEFORE INSTALLATION! Please read all instructions before installation.

- Keep these instructions for future reference.
- Must be installed by a qualified electrician in accordance with national and local standards. Designplan is not responsible for fixtures installed without regard to these standards.
- Unauthorized alterations or tampering of product voids warranty.
- The main power connection must be in accordance with local electrical codes.
- Suitable for OUTDOOR applications.



IP66 IK08

ATTENTION: For In-Grade - It is the contractor's responsibility to seal the conduit with "Great Stuff" aerosol seal that prevents water and moisture penetration for ultimate protection. Contractor **MUST** use gel-filled wire nuts.

Maintenance

Scheduled maintenance must be carried out once a year on all lighting devices, regardless of appliance class and type of use. It must include the following operations:

- Periodically clean fixtures to remove dirt from gratings and screw heads.
- Check tightness of screws on various parts of the device.
- Check that all cable glands and cables are intact and tight. Check that the glass or plastic lens is intact, and replace it if broken or damaged.
- The internal components such as the ballast, driver, washers and screws must not show clear signs of oxidation or rust. Clear traces of rust and oxidation will indicate the presence of water inside the device.
- In the case of damage, the components must be replaced by original components or spare parts.

THE LIGHT SOURCE CONTAINED IN THIS LUMINAIRE SHALL ONLY BE REPLACED BY MANUFACTURERE OR A SIMILAR QUALIFIED PERSON

THIS PRODUCT CONTAINS A LIGHT SOURCE CLASS OF ENERGY EFFICIENCY <X>

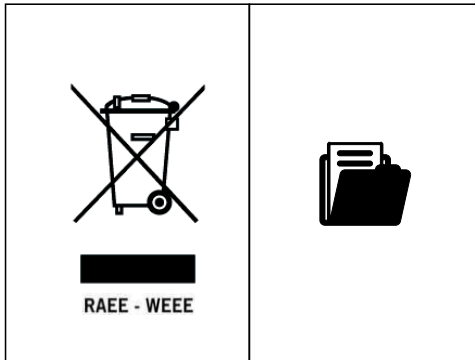

In respect and compliance to environmental standard, at the end of life do not dispose of as standard waste. This must be taken to one of the authorised collection points. To retain instruction.

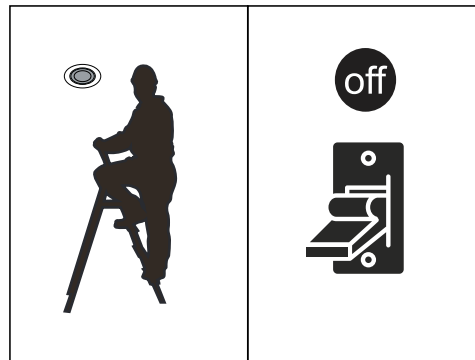

Installation must be carried out by qualified person in compliance with the regulations in force. Before to proceed with installation to disconnect the power.

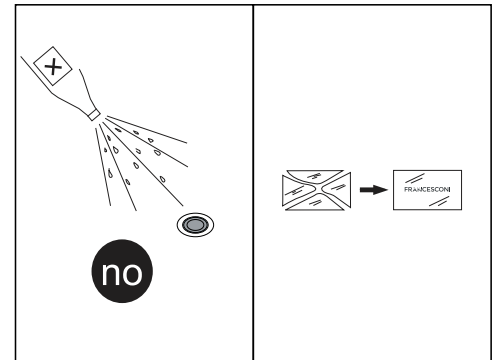

Keep away from aggressive chemical elements (fertilizer, weed-killer)> In case of break of the glass to replace it with Francesconi part only

All luminaries have to undergo regular maintenance (CEI 64-8 standards) according to the following steps:

- clear periodically the luminaries to avoid dirty deposit
- check the fastening of the screws
- inspect cables and cable glands for any possible damage
- check the fastening of cable glands
- check if seals are working order
- defect or damaged must be replaced before switching the luminance on. Use original spare parts only
- it is important to carry out luminance maintenance at each bulb substitution or at least once per year
- any improper use installation, any tampering, any unauthorized modification of the luminance causes the immediate expiry of any claim against the manufacture
- should Francesconi allow the return of a luminance for technical inspection or tests, they must be returned with a piece of wiring cable (7.87") connected to the luminance and complete with the connection made by the installer

HOW TO INSTALL THE LUMINAIRE

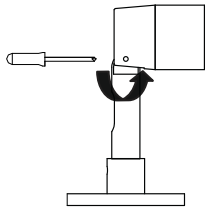

UNSCREW THE GRUB SET
PRESENT ON THE HEAT SINK
OF THE PRODUCT

1

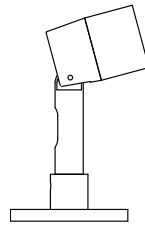

ORIENT THE PRODUCT AND
CLOSE THE PREVIOUSLY
UNSCREWED GRUB

2

FIX THE BASE WITH SPECIAL
SCREWS AND FISCHER
(NOT PROVIDED)

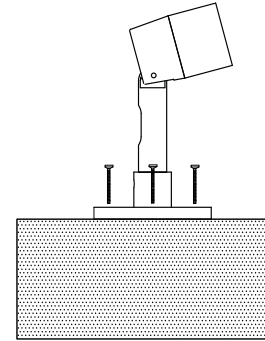

3

IP 67
CONNECTION!

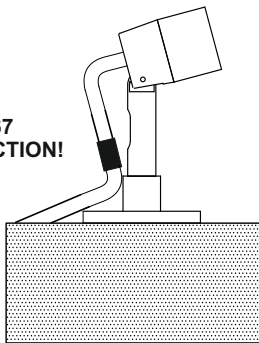

4

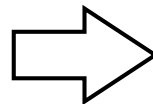

120V !

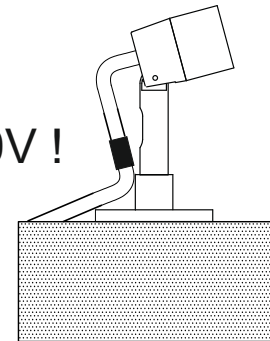

5

