

Klimpt is an LED bollard with a 4.5" square head suitable for outdoor installation. It is offered in 2 heights – 2-foot or 3-foot – with 3 static white color temperatures, 3 optics options, and 5 standard finishes. Dark Sky compliant.



## TECHNICAL DATA

<b>Wattage</b>	20W
<b>Power Supply</b>	Integral 120VAC
<b>Dimming</b>	0-10V Dimming
<b>Construction</b>	Body: Aluminum Lens: Clear
<b>CCT</b>	2700K, 3000K, 4000K
<b>BUG Rating</b>	B1-U0-G0 (3000K - All Optics)
<b>CRI</b>	>90
<b>Delivered Lumens</b>	1428 lm (24°, 3000K) 1356 lm (36°, 3000K) 1565 lm (Asym, 3000K) Dark Sky compliant
<b>Efficacy</b>	71.4 lm/W (24°, 3000K) 67.8 lm/W (36°, 3000K) 78.3 lm/W (Asym, 3000K)
<b>Optics</b>	24°, 36°, Asymmetric
<b>Finishes</b>	5 Standard - See page 2 Custom RAL on request
<b>Fixture Dimensions</b>	Pole: 2.56" l x 2.20" w x 24.0" or 36.0" h Head: 4.48" x 4.48" x 1.42" h
<b>IP Rating</b>	IP65

Fixture Dimensions

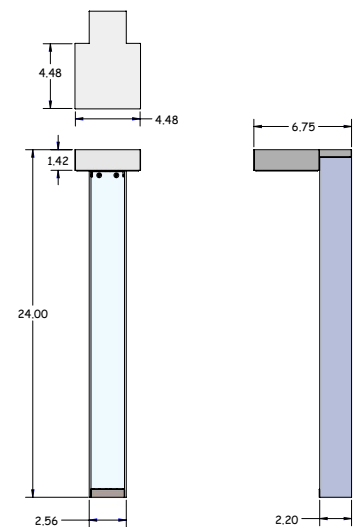

## ORDERING INFORMATION

Example: KLI-L-1-30-01-11-C-0. Accessories ordered separately.

CLI-L	-		-		-		-	C	-	0
Model No.	Height	CCT	Optics	Finish	Dimming	Options				
KLI-L	1 - 24" (2 ft)	27 - 2700K	01 - 24°	11 - White Suede	C - Integral 120VAC 0-10V Dimming	0 - None				
	2 - 36" (3 ft)	30 - 3000K	02 - 36°	02 - Black Suede						
		40 - 4000K	03 - Asymmetric	03 - Gray 18 - Textured Bronze TS - Silver C - Custom						

Job Name/Date:

Fixture Type Designation:

## ACCESSORIES - Installation

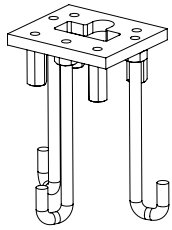

**AM-00010**  
Mounting Base  
Assembly

## FINISHES

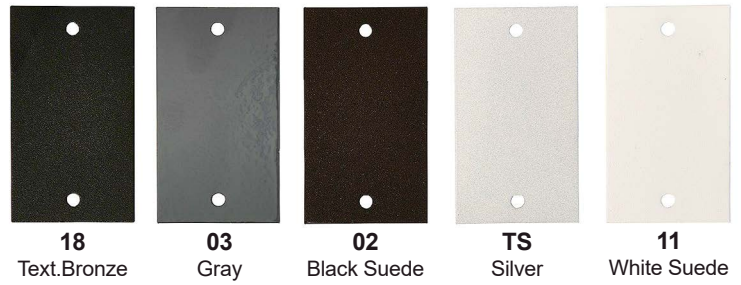

## PHOTOMETRICS

Note: All photometry is 3000K

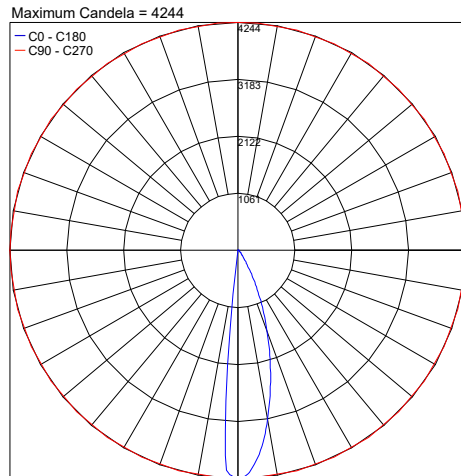

PHOTOMETRIC FILENAME : KLIMPT-KAHLO BOLLARD 24FT 30K 24°.IES

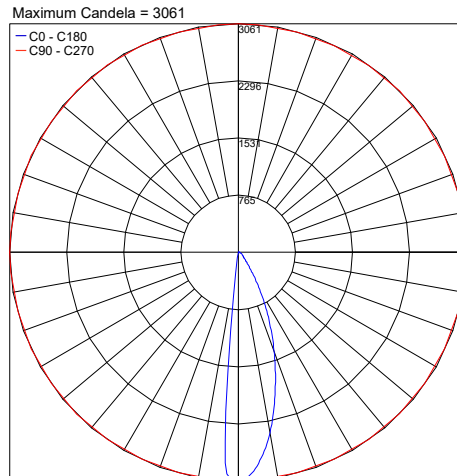

PHOTOMETRIC FILENAME : KLIMPT-KAHLO BOLLARD 24FT 30K 36°.IES

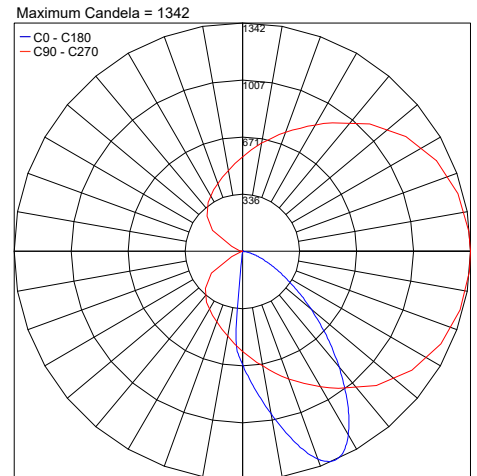

PHOTOMETRIC FILENAME : KLIMPT-KAHLO BOLLARD 24FT 30K ASYM. IES

Job Name/Date:

Fixture Type Designation: