



INSTRUCTIONS PERTAINING TO RISK OF FIRE OR INJURY TO PERSONS. READ ALL INSTRUCTIONS. IMPORTANT SAFETY INSTRUCTIONS. SAVE THESE INSTRUCTIONS.

DANGER - RISK OF SHOCK - DISCONNECT POWER BEFORE INSTALLATION! Please read all instructions before installation.

- Keep these instructions for future reference.
- Must be installed by a qualified electrician in accordance with national and local standards. Designplan is not responsible for fixtures installed without regard to these standards.
- Unauthorized alterations or tampering of product voids warranty.
- The main power connection must be in accordance with local electrical codes.
- Suitable for OUTDOOR applications.



IP66 IK10

Maintenance

Scheduled maintenance must be carried out once a year on all lighting devices, regardless of appliance class and type of use. It must include the following operations:

- Periodically clean fixtures to remove dirt from gratings and screw heads.
- Check tightness of screws on various parts of the device.
- Check that all cable glands and cables are intact and tight. Check that the glass or plastic lens is intact, and replace it if broken or damaged.
- The internal components such as the ballast, driver, washers and screws must not show clear signs of oxidation or rust. Clear traces of rust and oxidation will indicate the presence of water inside the device.
- In the case of damage, the components must be replaced by original components or spare parts.

CUP POLE - HEAD ONLY

15.6W(180°), 14.9W(360°), INTEGRAL 120VAC

installation instructions

FIXTURE DIMENSION



INSTALLATION

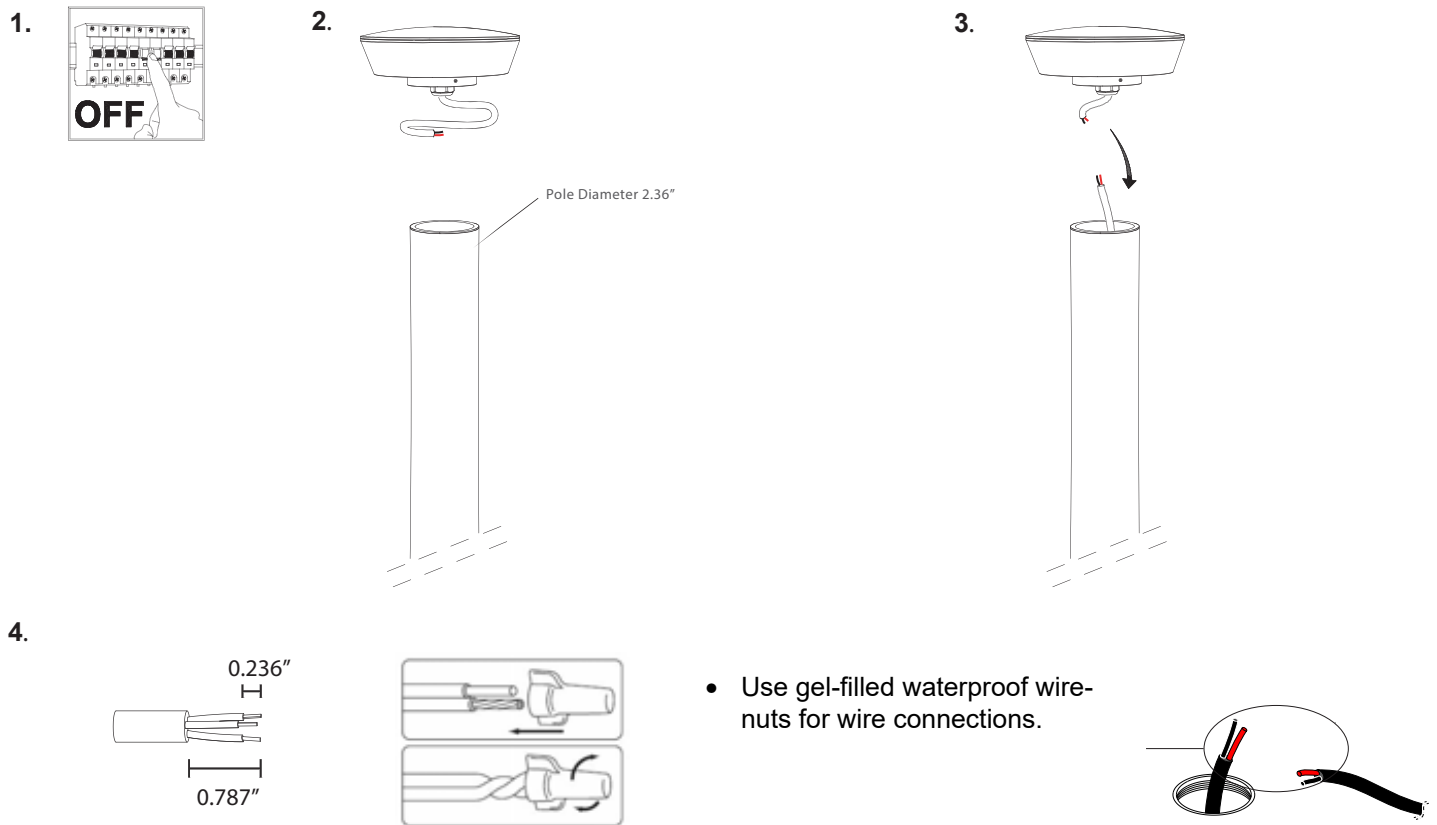

- It is the contractor's responsibility to caulk around the edges between the fixture and the mounting surface, to satisfy wet label requirements.
- It is the contractor's responsibility to install Remote Driver in a suitable electrical enclosure.

CUP POLE - HEAD ONLY

15.6W(180°), 14.9W(360°), INTEGRAL 120VAC

installation instructions

5.

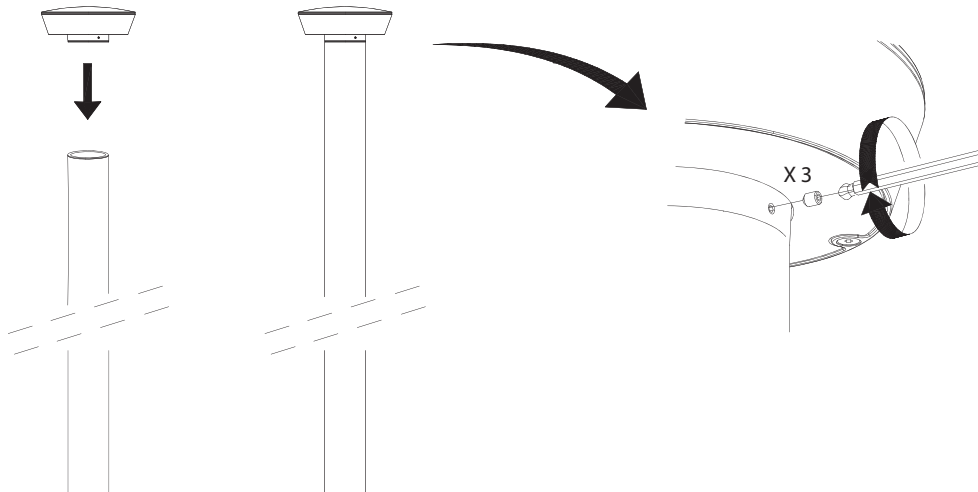

6.

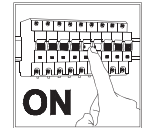

GENERAL MAINTENANCE RECOMMENDATIONS

A scheduled maintenance programme must be carried out on the installation and the fitting regardless of their IP rating or application - these must include the following operations:

- Clean the fittings from dirt that may be deposited on the protection.
- Check the glass or plastic screen for damage and replace if required.

In case of damage the components must be replaced by original components and spare parts before using the fitting.

We also recommend to check the fitting once a year.

The appliance must not be modified in any way. Any modification may make the appliance dangerous.

All parts of products must not be in contact with aggressive chemical elements (ex. fertilisers, herbicides, lime).

The respect of these instructions is very important for the fitting and for the electrical system.