

FLEA MAXI C

FLEA is a family of IP67-rated round or square recessed wall / in-grade or downlights available in static white, RGBW, and and underwater version (IP68). FLEA MAXI C is a Ø3.2" in-grade uplight offered in mono or duo light emission, diffused optics and 3 standard finishes.



FLEA-FLEA MAXI C 1x180°



FLEA-FLEA MAXI C 2x120°

Fixture Dimensions - See page 2

TECHNICAL DATA

Wattage	6.5W
Power Supply	Remote 24VDC, not included. See page 2
Construction	Housing: Anticorodal Aluminum Lens: Extra Clear Tempered Glass
CCT	2700K, 3000K, 4000K
BUG Rating	B0-U3-G1 (3000K)
CRI	>80
Delivered Lumens	151 lm (3000K, 1x180°) 179 lm (3000K, 2x120°)
Efficacy	23.2 lm/W (3000K, 1x180°) 27.5 lm/W (3000K, 2x120°)
Optics	1x180°, 2x120°
Finishes	Anodized Matte Black, Anodized Aluminum, AISI 316L Steel
Lumen Maintenance	90,000 hrs, L90 (Ta 35°C)
Fixture Dimensions	See page 2
IP Rating	IP67
Impact Resistance	IK10
Walk Over Rating	Up to 3307 lbs

ORDERING INFORMATION

Example: F10167.3.2.05.US. Power Supplies / Accessories ordered separately.

			05	US
Model No.	Finish	CCT	Optics	
F10179 - Single, 1x180°	3 - Anodized Matte Black	2 - 2700K	05 - Diffuse	US
F10180 - Double, 2x120°	5 - Anodized Aluminum	3 - 3000K		
	6 - AISI 316L Steel	4 - 4000K		

Job Name/Date:

Fixture Type Designation:

FIXTURE DIMENSIONS

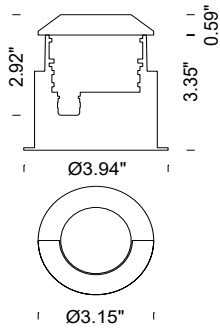

FLEA MAXI C

SUGGESTED POWER SUPPLIES - 24VDC

Part Number	Description	Input/Output	# of Fixtures	
			MONO	DUO
PPLT00680	ELV / TRIAC & 0-10V Dimming (100 to 0%)	120-277VAC to 24VDC, 20W, Class 2, IP66	1-1	1-1
PPLT00690	ELV / TRIAC & 0-10V Dimming	120-277VAC to 24VDC, 40W, Class 2, IP67	1-3	1-3
PPLT00691	Non-Dim	120-277VAC to 24VDC, 60W, Class 2, IP67	1-5	1-5
PPLT00543	0-10V Dimming to 15% (-40°C / -40°F cold weather start)	120-277VAC to 24VDC, 100W, Class 2	1-9	1-9

Suggested Lutron Compatible

Part Number	Option	Lutron SKU	Dim Range	Description	Input/Output	# of Fixtures	
						MONO	DUO
PPLT00273	L3DAE / L3DA3W	L3DA	100%-1%	Hi-Lume™ 1% EcoSystem™ or 1% 3-Wire LED Driver	120-277VAC to 24VDC, 40W, Class 2	1-3	1-3
PPLT00530	L3DAE / L3DA3W	L3DA	100%-1%	Hi-Lume™ 1% EcoSystem™ or 1% 3-Wire LED Driver	120-277VAC to 24VDC, 96W, Class 2	1-9	1-9

For other power supply options consult factory.

PHOTOMETRIC DATA - Note: All photometry is 3000K

MONO

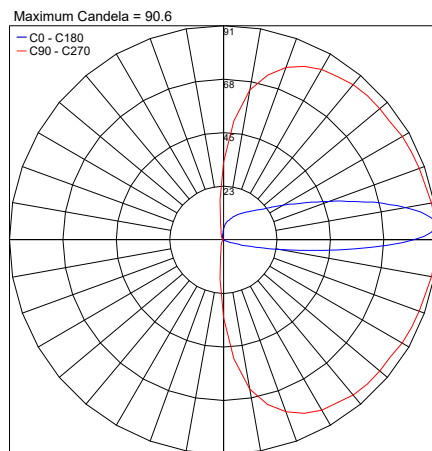

PHOTOMETRIC FILENAME : FLEA MAXI C MONO 30K DIFFUSE-10179.X.3.05.IES

DUO

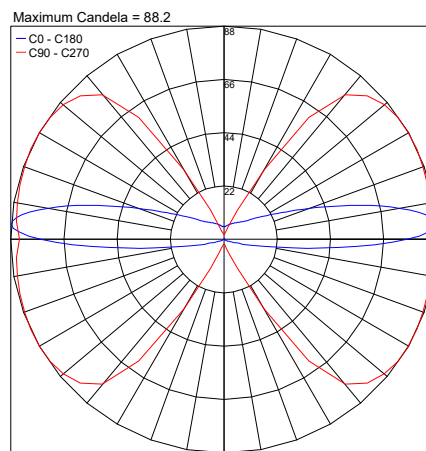

PHOTOMETRIC FILENAME : FLEA MAXI C DUO 30K DIFFUSE-10180.X.3.05.IES

Job Name/Date:

Fixture Type Designation: