

FLEA MINI UNDERWATER RGBW

FLEA is a family of IP67-rated round or square recessed wall / in-grade or downlights available in static white, RGBW, and and underwater version (IP68). FLEA MINI Underwater RGBW is IP68-rated, and offered round (Ø1.4") or as a floodlight (Ø1.1") with RGBW light, 2 optics options, and made of ASIS 316L Stainless Steel.



FLEA MINI Underwater Round RGBW



FLEA MINI Underwater Spot RGBW

Fixture Dimensions - See page 2

TECHNICAL DATA

Wattage	5W
Power Supply	Remote Fountain/Pool Approved 24VDC Power Supply, not included. See page 2.
Construction	Housing: Anticorodal Aluminum Lens: Extra Clear Tempered Glass
CCT	RGBW
BUG Rating	—
Delivered Lumens	174 lm: (R) 25 lm, (G) 52 lm, (B) 13 lm, (W) 84 lm (6500K)
Efficacy	34.8 lm/W: (R) 5 lm/W lm, (G) 10.4 lm/W, (B) 2.6 lm/W, (W) 16.8 lm (6500K)
Optics	30°, Diffuse
Finishes	AISI 316L Stainless Steel
Lumen Maintenance	90,000 hrs, L90 (Ta 35°C)
Fixture Dimensions	See page 2
IP Rating	IP68 (9.84 ft)
Impact Resistance	—

ORDERING INFORMATION

Example: F50104.6.5.02.US. Power Supplies / Accessories ordered separately.

	6	5		US
Model No.	Finish	CCT	Optics	
F50104 - Round	6 - AISI 316L Stainless Steel	5 - RGB+W	02 - Medium 30°	US
F50133 - Spotlight			05 - Diffused	

Job Name/Date:

Fixture Type Designation:

FIXTURE DIMENSIONS

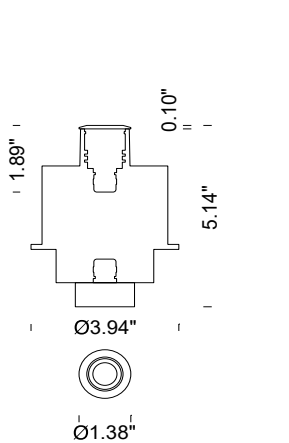

FLEA MINI Underwater Round

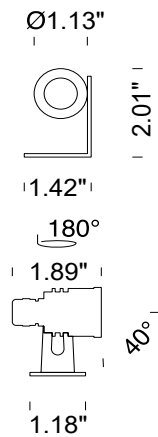

FLEA MINI Underwater Spot

SUGGESTED POWER SUPPLIES

24VDC

Part Number	Description	Input/Output	# of Fixtures
FPV-100EL0024	DMX / RDM (Field Addressable) / DALI	120-277VAC to 24VDC, 100W, Class 2, NEMA 4	1-16

For other power supply options consult factory.

Job Name/Date:

Fixture Type Designation: